

01 Existing First Floor Plan
3402 1:100

0 1 5
Scale 1:100 m

Areas of shading indicates existing floor coverings where it is not possible to inspect the existing boards.

Existing floorboards are square edged oak and average 170mm in width. Existing boards are nailed to joists beneath.

The visible area of the existing floor has evidence of some woodworm as well as cut and split boards through the integration of items such as services.

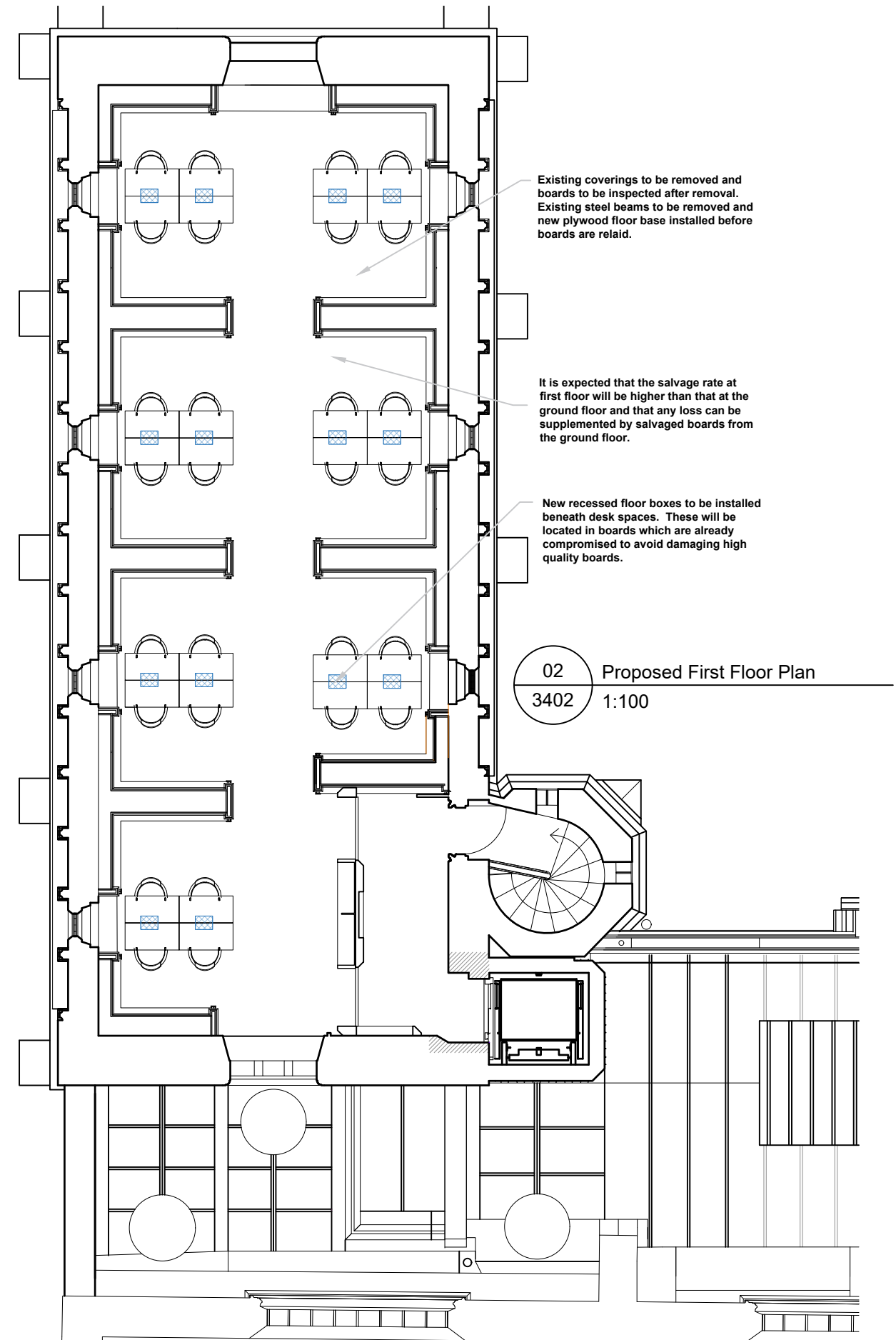

02 Proposed First Floor Plan
3402 1:100

Existing coverings to be removed and boards to be inspected after removal. Existing steel beams to be removed and new plywood floor base installed before boards are relaid.

It is expected that the salvage rate at first floor will be higher than that at the ground floor and that any loss can be supplemented by salvaged boards from the ground floor.

New recessed floor boxes to be installed beneath desk spaces. These will be located in boards which are already compromised to avoid damaging high quality boards.

- Notes
1. Any dwg format drawing is to be read in conjunction with and at the scale of the accompanying pdf.
 2. Where colours other than black or grey are used, the drawing must be plotted in colour.
 3. For status 'C' (Construction) drawings all dimensions are to be checked on site by the contractor, scaling is for Local Authority purposes only.
 4. Unless otherwise indicated, all dimensions are in millimeters.
 5. All information on this drawing is to be read in conjunction with the relevant Donald Insall Associates specification and trade contractors' drawings and information by specialists.
 6. In the event of any discrepancy, please contact us immediately.
 7. This drawing may contain survey information by others and is to be used solely for the purposes for which it was issued.
 8. These are uncontrolled documents issued for information purposes only. If you have any queries regarding the drawings, please contact DIA immediately.
 9. Please note DIA cannot be held responsible for any errors arising from changes made to an uncontrolled dwg file.

Drawing Status

F	Feasibility
S	Sketch Design
P	Planning
B	Building Control
D	Design Development
M	Measurement
T	Tender
C	Construction
R	Record

Rev	Date	Dwn	Auth	Revision
0	27.01.2021	LSB	-	Initial Issue

Rev	Date	Dwn	Auth	Revision

Donald Insall Associates
Chartered Architects and Historic Building Consultants

1 Harington Place
Bath BA1 1HF
(+44) 01225 469 898
bath@insall-architects.co.uk

Exeter College Library, Oxford

Project	EXCO.01	No	3402
Scale (A3)	1:100	Status	P
		Revision	0

Existing and Proposed First Floor Plans - Floor Proposals