

NEW DORMER FACE & CHEEKS TO BE LEAD WEATHER PROOFING ON UNDERLAY; 9mm OSB; 50x100mm C24 TIMBER STUDWORK. FIT 75mm KINGSPAN KOOLTHERM K7 BETWEEN STUDWORK MAINTAINING A 25mm AIR GAP; VAPOUR CONTROL LAYER FIXED TO FACE OF STUDWORK; SKIM COATED 12.5mm PLASTERBOARD.

NEW DORMER ROOF TO BE LEAD WEATHER PROOFING ON UNDERLAY; 9mm OSB; TIMBER FIRRING STRIPS; 50x125mm C24 RAFTERS AT 400mm CTS. FIT 75mm KINGSPAN KOOLTHERM K7 BETWEEN RAFTERS LEAVING A 50mm AIR GAP AND 32.5mm KINGSPAN KOOLTHERM K118 INSULATED PLASTERBOARD WITH TAPED JOINTS FIXED BENEATH JOISTS. FINISH WITH LIGHTWEIGHT SKIM. PROVIDE VENTILATORS AS REQUIRED.

ENLARGE EXISTING DORMER. FIT NEW TIMBER CASEMENT WINDOW WITH SLIM DOUBLE GLAZING

REPAIR/REPLACE LEADWORK BEHIND PARAPET WALL.

REPLACE WINDOW WITH NEW TIMBER CASEMENT UNIT WITH SLIM DOUBLE GLAZING.

PROVIDE EXTRACTOR FAN TO ENSUITE & TAKE EXHAUST TO EXTERNAL.

FREESTANDING BATH WITH TAPS MOUNTED ON BATH, EXPOSED PIPEWORK

HALF STUDWALL TO ACCOMMODATE SHOWER CONTROLS

NEW PARTITION WALLS TO BE 50x100mm TIMBER STUDS WITH SKIM COATED 12.5mm PLASTERBOARD FACING. FIT INSULATION TO VOIDS.

REMOVE EXISTING CUPBOARD & FORM SMALLER ONE.

1x FLUSH FIT ROOFLIGHT CR09-2 (717x1028mm)

1x FLUSH FIT ROOFLIGHT CR09-2 (717x1028mm)

NOTE PLEASE SEE STRUCTURAL ENGINEERS DETAILS FOR ROOF WORKS.

INSULATION SHOULD BE PROVIDED BETWEEN RAFTERS/UNDERNEATH. PLEASE CONTACT US WHEN EXTENT OF WORKS IS KNOWN.

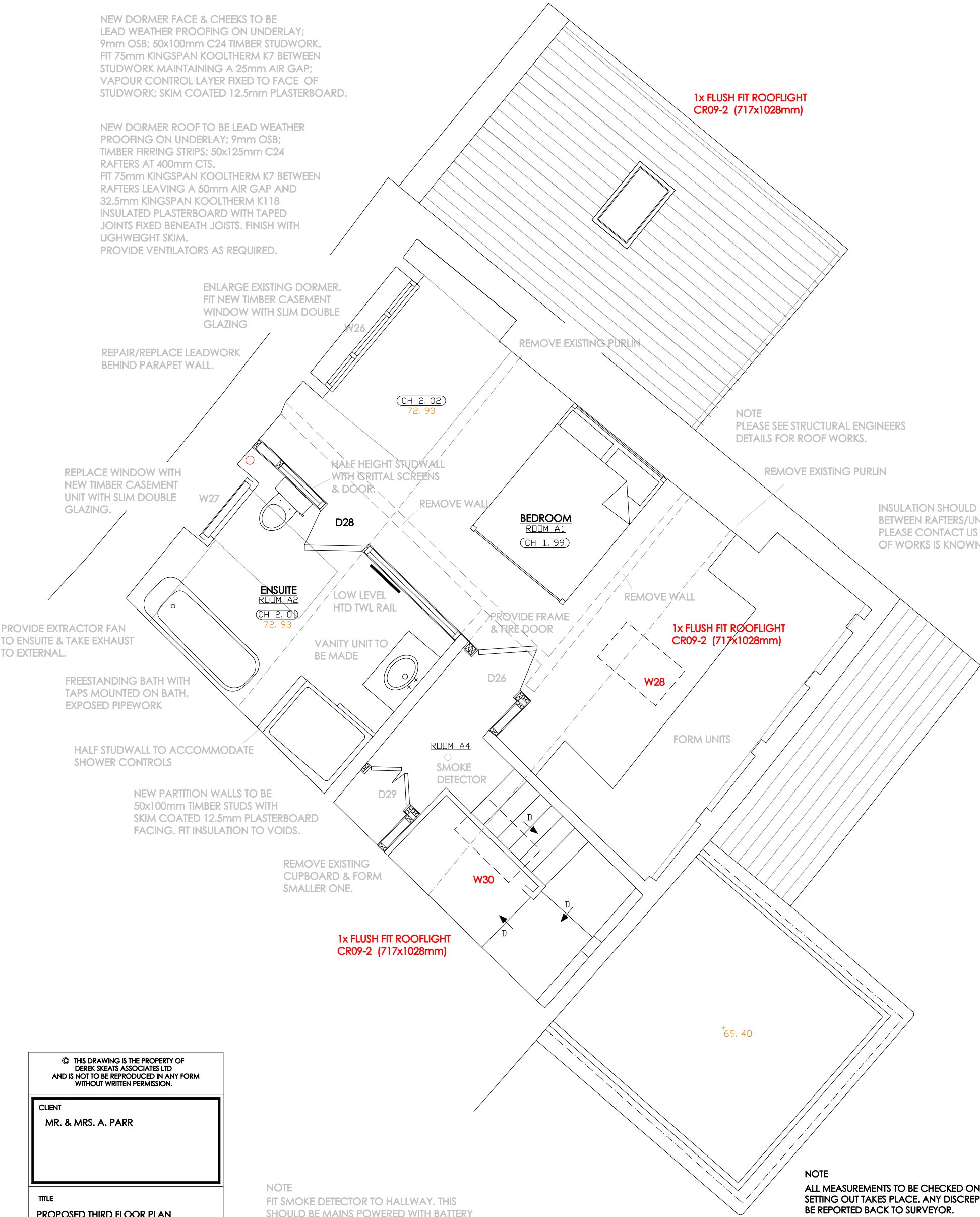

NOTE
FIT SMOKE DETECTOR TO HALLWAY. THIS SHOULD BE MAINS POWERED WITH BATTERY BACK UP AND INTERLINKED WITH THE OTHER DETECTORS.
PLEASE READ IN CONJUNCTION WITH SPECIALIST COMPANIES REPORTS SUCH AS STRUCTURAL ENGINEER, JOINERY COMPANY, STONEMASON AND DAMPROOFING COMPANY.

NOTE
WORKS NOTED IN LIGHT GREY HAVE BEEN APPROVED 20/02846/LBC
WORKS NOTED IN RED ARE THOSE REQUIRING LISTED BUILDING CONSENT

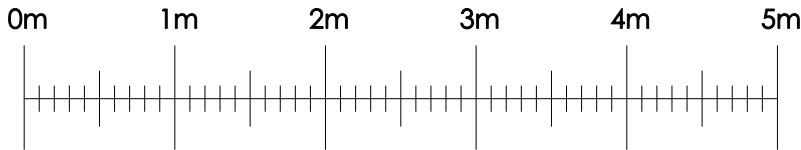

NOTE
ALL MEASUREMENTS TO BE CHECKED ON SITE BEFORE SETTING OUT TAKES PLACE. ANY DISCREPANCIES TO BE REPORTED BACK TO SURVEYOR.
PLEASE READ THIS DRAWING ALONG WITH FOLLOWING:
- PROJECT MANAGERS DETAILS
- APPROVED PLANNING DRAWINGS
- PLANNING CONDITIONS
- BUILDING REGULATIONS SCHEDULE
- BUILDING REGULATIONS APPROVED DOCUMENTS
- BUILDING REGULATIONS CONDITIONS
- STRUCTURAL ENGINEERS DETAILS
- OTHER SPECIALIST COMPANIES DETAILS
ANY DISCREPANCIES TO BE REPORTED BACK TO THE PROJECT MANAGER
THE BUILDER SHOULD SATISFY THEMSELVES THAT THEY HAVE READ AND UNDERSTOOD ALL ASPECTS OF THE WORK TO BE UNDERTAKEN.
ALL PLUMBING TO APPROVED DOCUMENT G.
GAS INSTALLATION TO BE UNDERTAKEN BY GAS SAFE ENGINEER.
ELECTRICAL WORK TO BE CARRIED OUT BY REGISTERED MEMBER OF COMPETENT PERSONS SCHEME & RECORDED.
ENCASE STEEL BEAMS IN FIRELINE OR SIMILAR IN ORDER TO PROVIDE 30 MINUTE FIRE RESISTANCE.
THE MECHANICAL VENTILATION TO BE COMMISSIONED, TESTED AND MAINTAINED IN ACCORDANCE WITH THE DOMESTIC VENTILATION COMPLIANCE GUIDE.
WHERE FIRE DOORS ARE NOTED, CONTRACTOR TO PROVIDE TEST EVIDENCE BY MEANS OF EXPOSURE TO A FIRE FROM BOTH SIDES OF THE DOOR SET.

© THIS DRAWING IS THE PROPERTY OF DEREK SKEATS ASSOCIATES LTD AND IS NOT TO BE REPRODUCED IN ANY FORM WITHOUT WRITTEN PERMISSION.

CLIENT
MR. & MRS. A. PARR

TITLE
PROPOSED THIRD FLOOR PLAN
34 PARK TOWN
OXFORD
OX2 6SJ

SCALE
1:50 - A3 SHEET

DATE
09/02/2021

DRAWN BY
NES

DRAWING NUMBER
2020-09-02 PTF Ver.12A

DEREK SKEATS ASSOCIATES LTD

ARCHITECTURAL ENGINEERING

Grassington House, 142 Gidley Way,
Horspath, Oxon. OX33 1TD

Tel: 07703 292982

E-mail: noelskeats@btinternet.com