

ground floor plan

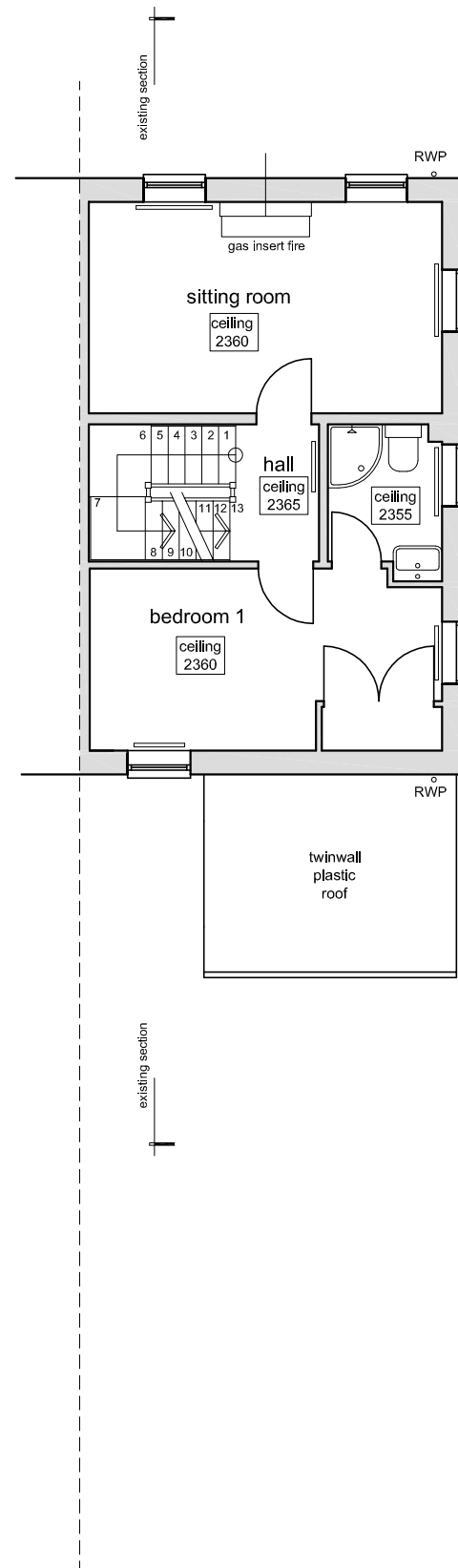

first floor plan

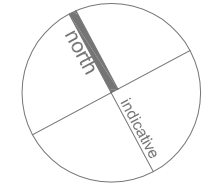

# Lightbox Architects

1 Kings Meadow  
Osney Mead  
Oxford  
OX2 0DP  
t 07901 521084  
lightboxarchitects.com

title  
extension and alteration to  
23 Terrett Avenue  
Sandhills  
Oxford  
OX3 8FE  
for Matthijs Branderhorst and  
Angela Brueggemann

drawing  
existing ground and first floor plans

drawing number  
**TER23 010**

scale at A3 1:100      date October 2020      drawn by jmac

**RECORD DRAWING**



Terrett Avenue