

0 2 4 6 8 10 12 14 16 18 20
Metres at 1:200

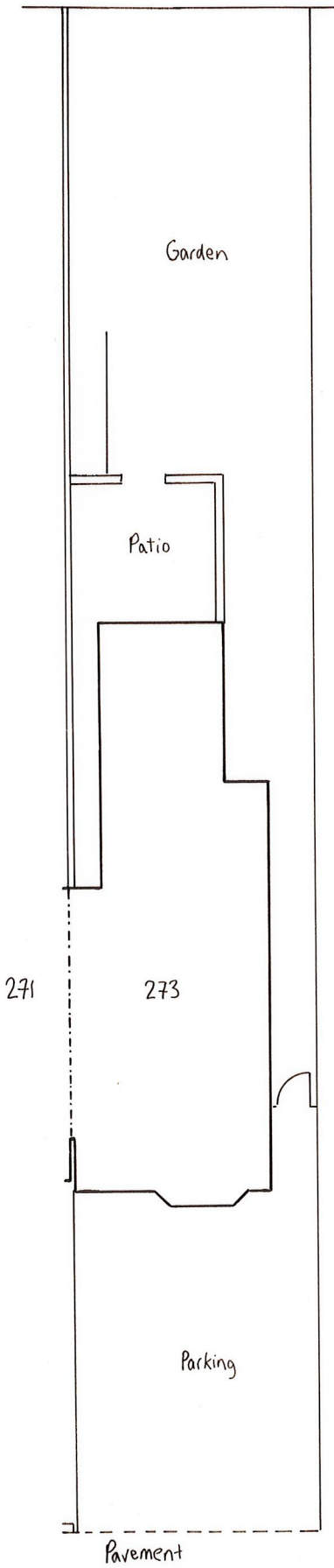

EXISTING 1:200 BLOCK PLAN

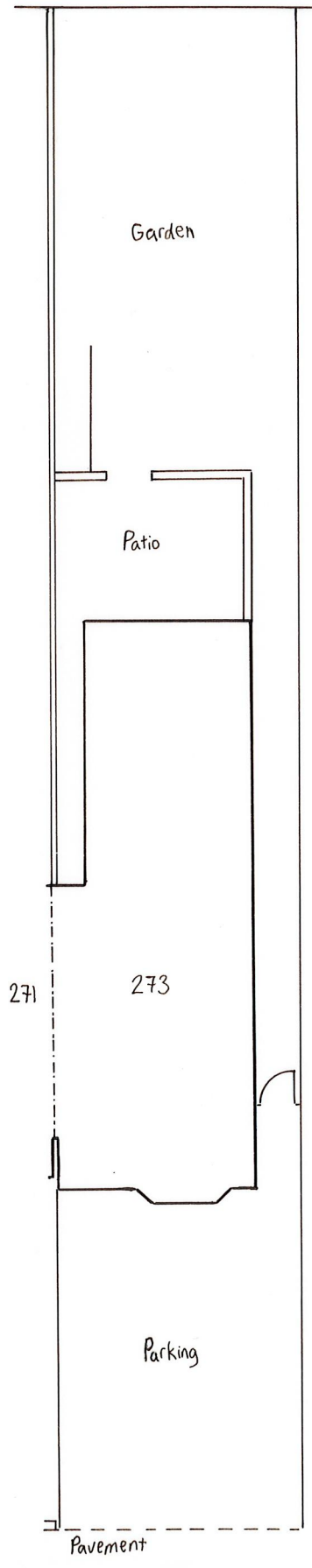

PROPOSED 1:200 BLOCK PLAN

Digby Architectural

www.digbyarchitectural.co.uk
Robert Tomlinson BA (Hons) Arch / Dip Arch / Dip U.D.

ADDRESS: 4 Broughton Close, Old Marston, Oxford, OX3 0RQ

TEL NOS: 01865 761707 or 07979756918

EMAIL: info@digbyarchitectural.co.uk

CLIENT:

MRS. BALA PATEL

PROJECT: REAR EXTENSION AT NO. 273
LONDON ROAD, HEADINGTON

DRAWING: EXISTING AND PROPOSED
BLOCK/ SITE PLANS

DATE: FEB. 2021 SCALE: 1:200 @ A4

DRAWING NO.: 273LRH:P03 REVISION: