

SECTION 1.1

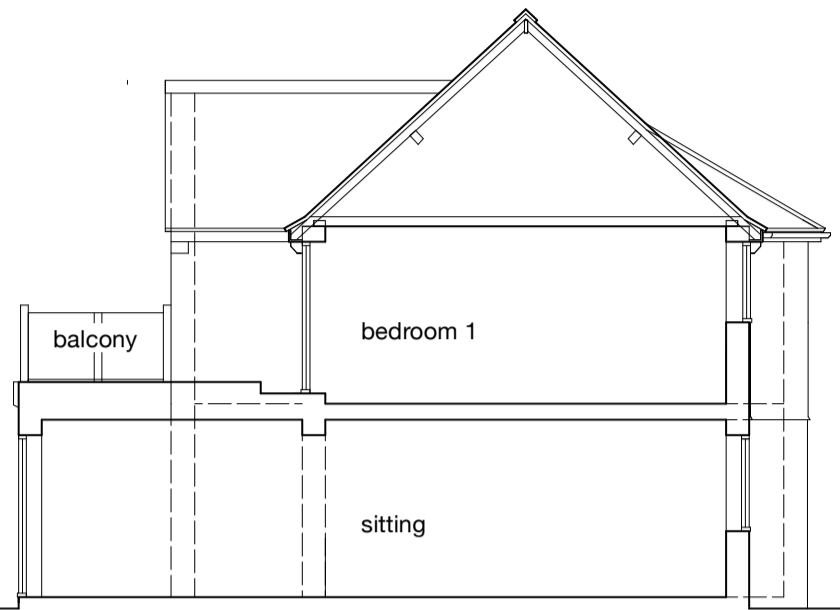

SECTION 2-2

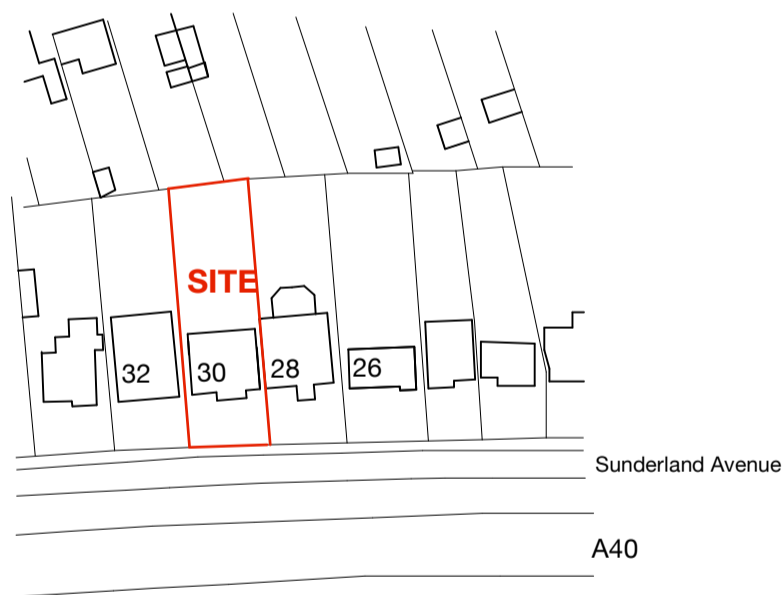
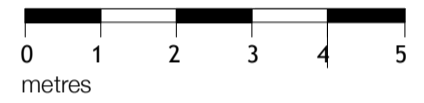

LOCATION PLAN 1-1250

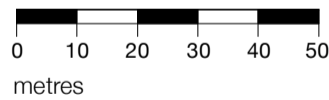

NORTH

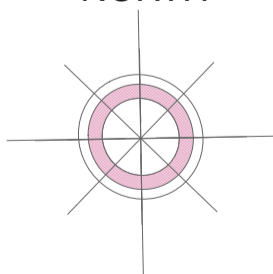

**JONATHAN MARK DENNIS ARCHITECTS**  
 67 STAUNTON ROAD, HEADINGTON  
 OXFORD OX3 7TL  
 t. 01865 764449  
 f. 01865 764449  
 e. jondennis@freedom255.com

Project  
**30 SUNDERLAND AVENUE**  
**OXFORD OX2 8DX**

Drawing  
**SURVEY AS EXISTING**  
**SECTIONS, LOCATION**

Scale	Date	Drawn
1:100 @ A3	27.01.2021	
Job no	Drg No	
<b>377</b>	<b>X 3</b>	
A3 planning drawing		