

GROUND FLOOR PLAN

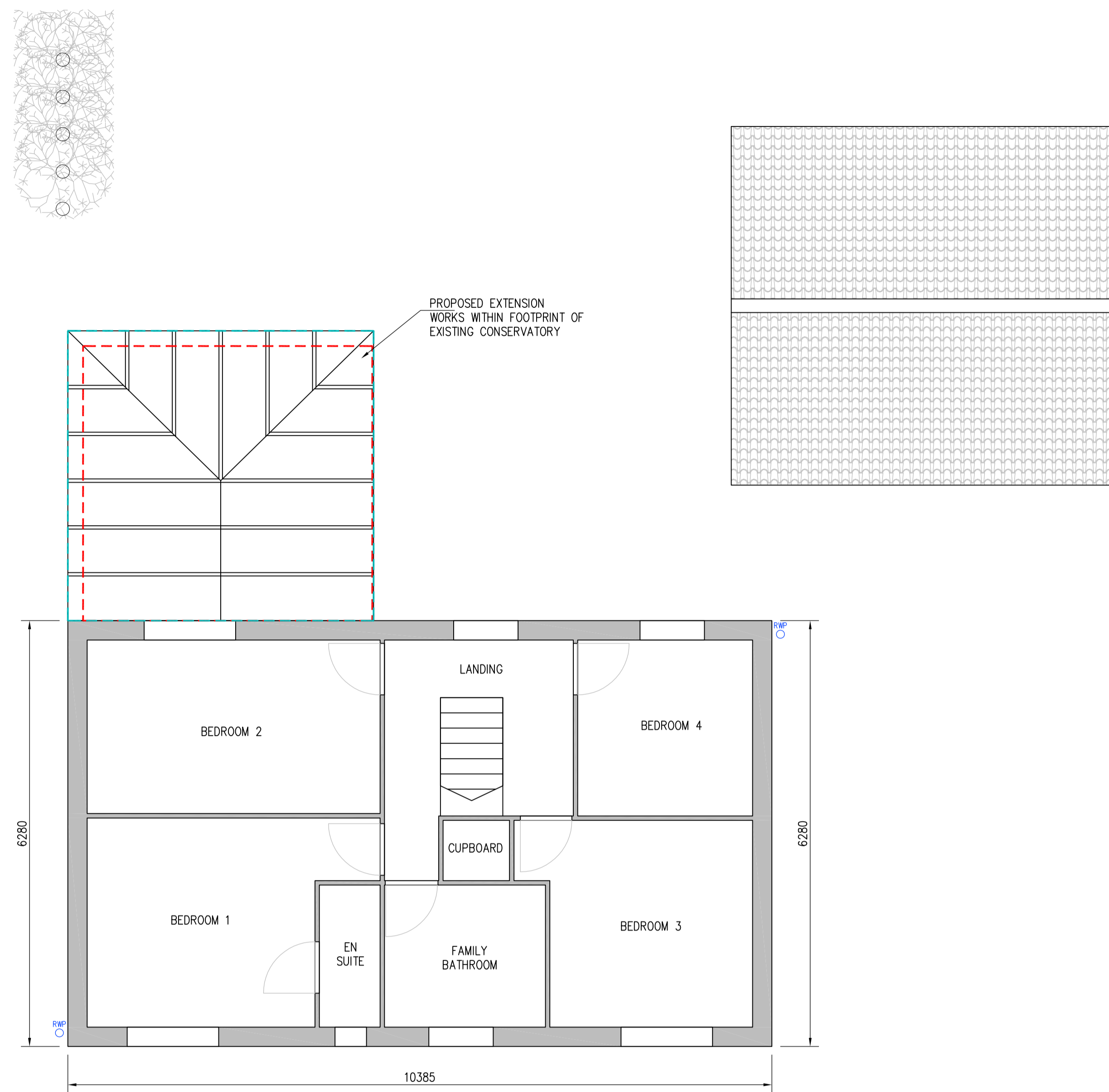
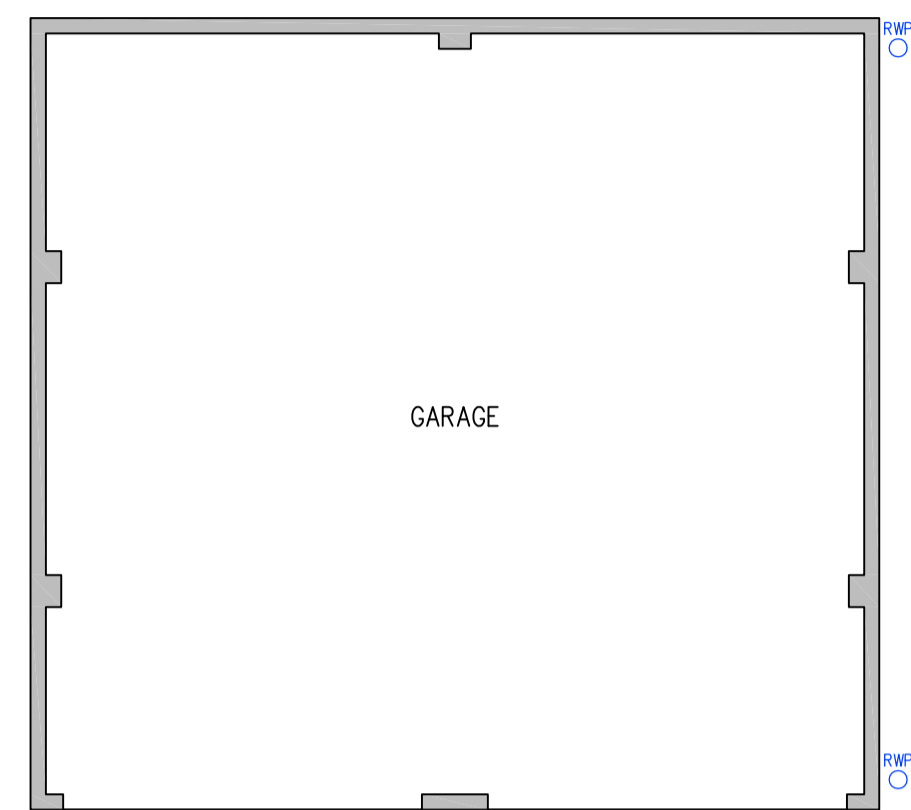

FIRST FLOOR PLAN

EXISTING HOUSE IS OF TRADITIONAL BRICK AND BLOCK CONSTRUCTION, WITH SOLID CONCRETE FLOORS

PROPOSED EXTENSION TO BE OF BRICK AND BLOCK CONSTRUCTION, AS EXISTING

ALL MATERIALS TO MATCH EXISTING – BRICK, CONCRETE ROOF TILES, UPVC WINDOWS/DOORS

NEW CAVITY WALL AND ROOF CONSTRUCTION TO BE FULLY INSULATED, AND ALL WINDOWS AND DOORS TO BE DOUBLE GLAZED

NO SIGNIFICANT PLUMBING OR DRAINAGE WORKS REQUIRED – RADIATORS ONLY

BRICK DETAIL AROUND WINDOWS AND DOORS TO BE ADOPTED FOR EXTENSION

OUTLINE OF EXISTING STRUCTURE TO BE DEMOLISHED

OUTLINE OF NEW STRUCTURE TO BE BUILT

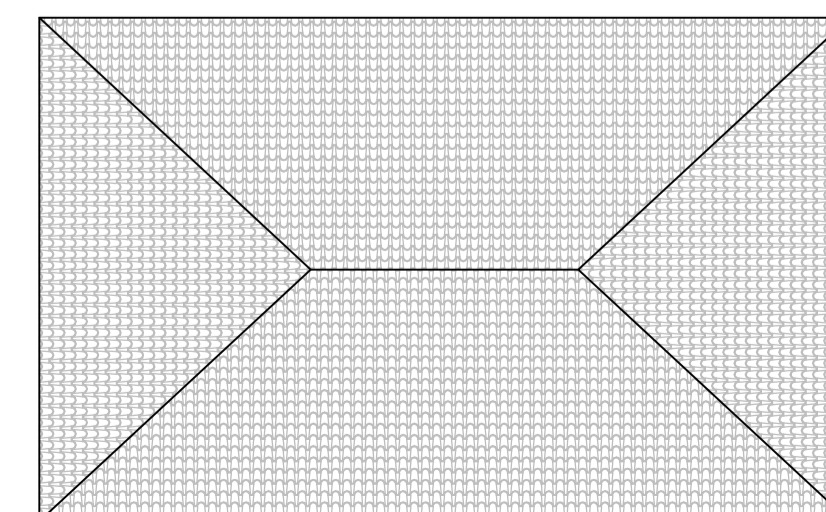

**ROOF PLAN
(1:100)**

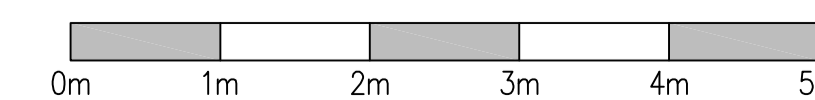
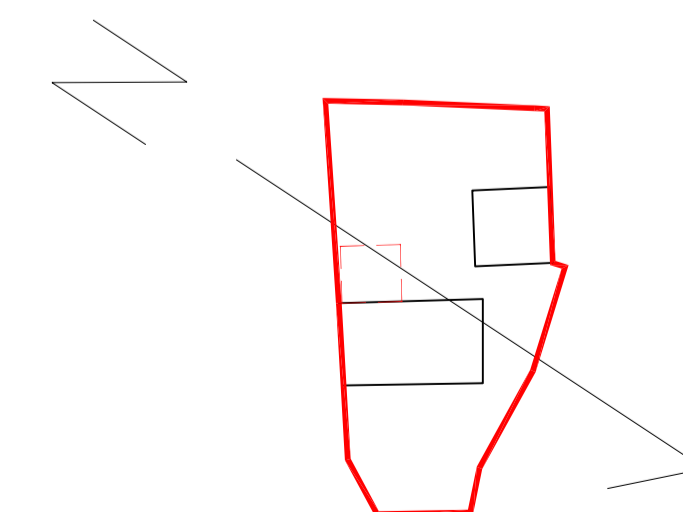

PROPOSED NEW TWO STOREY REAR EXTENSION IN PLACE OF EXISTING CONSERVATORY

10 APPLETON COURT,
BISHOPTHORPE

MR AND MRS WALKER

PLANS – EXISTING

DRAWING NR: ADW-002

SCALE: 1:50 @ A1

REVISION: A

DATE: FEB 2021