

This drawing is copyright and the property of Scanlans Consulting. It is to be used for the project and site only. It is not to be reproduced, stored in a retrieval system, or transmitted in any form or by any means, electronic, mechanical, photocopying, recording, or by any information storage and retrieval system, without the prior written permission of Scanlans Consulting. Copyright is reserved. © Scanlans Consulting. All rights reserved. No part of this drawing may be reproduced, stored in a retrieval system, or transmitted in any form or by any means, electronic, mechanical, photocopying, recording, or by any information storage and retrieval system, without the prior written permission of Scanlans Consulting. It is essential that the drawing is read in conjunction with the specification and all works identified included for.

1. Ditching Began. Carefully put down returned original beams and remove redundant fixings.
2. New Ceiling (Blue Lines) Install two layers of plaster board to ceiling. The plaster board is to be installed in a staggered fashion to ensure the structural columns are exposed in their full height and highlight them as an original feature.
3. Historic Sprinkler System (Green Lines) Retain and rewire existing sprinkler system (insurance requirement)

LEGEND

- 2400mm x 1200mm x 125mm fire proof plasterboard sheets.
- Existing Sprinkler system
- Ditching Columns
- Existing drainage connections

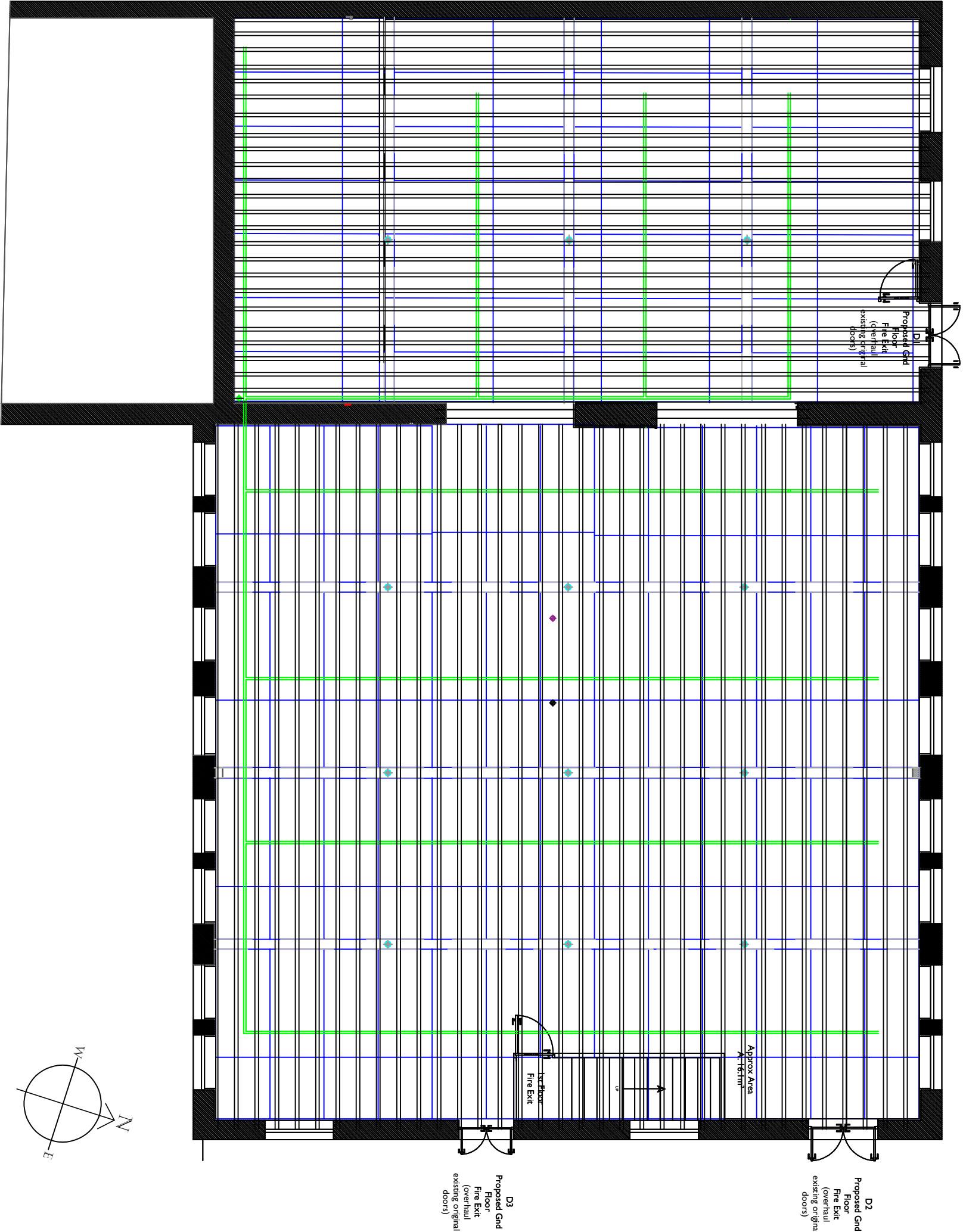

Revision	Comments	Dates
Client		Date 12/11/2024
M. One Studios		Drawn P.K.
Project North Block, Chatham Mill		Approved ??
Application No - 128758/FO/2020 & 128759/LO/2020		Scale 1:100@A3
Drawing title		Job No. 10029
As Proposed Ceiling Plan		Dwg No. 11

Scanlans
Project Consulting
Scanlans Consulting Surveyors LLP
3rd Floor, Boulton House,
17-21 Chorlton Street, Manchester, M1 3HY
www.scanlans.com/urbanSurveyors.com