

Produced on 05 March 2021 from the Ordnance Survey National Geographic Database and incorporating surveyed revision available at this date.  
 This map shows the area bounded by 279708 693732, 279850 693732, 279708 693874, 279708 693732  
 Reproduction in whole or part is prohibited without the prior permission of Ordnance Survey.  
 Crown copyright 2021. Supplied by copla ltd trading as UKPlanningMaps.com a licensed Ordnance Survey partner (100054135).  
 Data licence expires 05 March 2022. Unique plan reference: v2c/586620/795312



MRS MILLAR

**PROPOSED INTERNAL ALTERATIONS  
 AT FLAT 9  
 FORTH PLACE,  
 STIRLING**

LOCATION PLAN

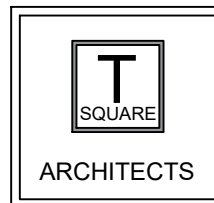

Architecture - Design - Planning

39 Allanvale Road  
 Bridge of Allan  
 Stirling  
 FK9 4PA

Mob: 07596906412

E-mail: daire.gibbons@tsquare-architects.co.uk Web: www.tsquare-architects.co.uk

scale	1:1250	date	10.02.21	drawn:	CG	status:	LBC
proj no.	2021-853		Dwg no.	T-101		-	