

- Notes
1. Drawings are property of T Square—Architects and should not be reproduced without written consent.
  2. Do not scale from drawings.

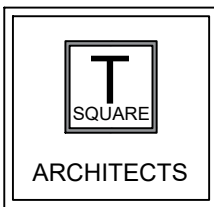

scale in meters

MRS MILLAR  
**PROPOSED INTERNAL ALTERATIONS  
 AT FLAT 9  
 FORTH PLACE,  
 STIRLING**



Architecture - Design - Planning  
 39 Allanvale Road  
 Bridge of Allan  
 Stirling  
 FK9 4PA  
 Mob: 07596906412  
 E-mail: claire.gibbons@tsquare-architects.co.uk Web: www.tsquare-architects.co.uk

EXISTING ELEVATIONS  
 PROPOSED ELEVATIONS

scale 1:100	date 10.02.21	drawn: CG	status: LBC
proj no. 2021-853	Dwg no. T-301		-