



**UK
Planning
Maps**

01856 898 022
www.UKPlanningMaps.com



Produced on 05 March 2021 from the Ordnance Survey National Geographic Database and incorporating surveyed revision available at this date.
This map shows the area bounded by 279708 693732, 279850 693732, 279850 693874, 279708 693874, 279708 693732
Reproduction in whole or part is prohibited without the prior permission of Ordnance Survey.
Crown copyright 2021. Supplied by copla ltd trading as UKPlanningMaps.com a licensed Ordnance Survey partner (100054135).
Data licence expires 05 March 2022. Unique plan reference: v2c/586620/795312



MRS MILLAR

**PROPOSED INTERNAL ALTERATIONS
AT FLAT 11
FORTH PLACE,
STIRLING**

LOCATION PLAN

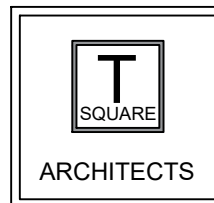

Architecture - Design - Planning

39 Allanvale Road
Bridge of Allan
Stirling
FK9 4PA

Mob: 07596906412

E-mail: daire.gibbons@tsquare-architects.co.uk Web: www.tsquarearchitects.weebly.com

scale 1:1250	date 10.02.21	drawn: CG	status: LBC
proj no. 2021-853	Dwg no. T-101		