

# TREE PLAN

## HILLSIDE 1 THE BARRACKS

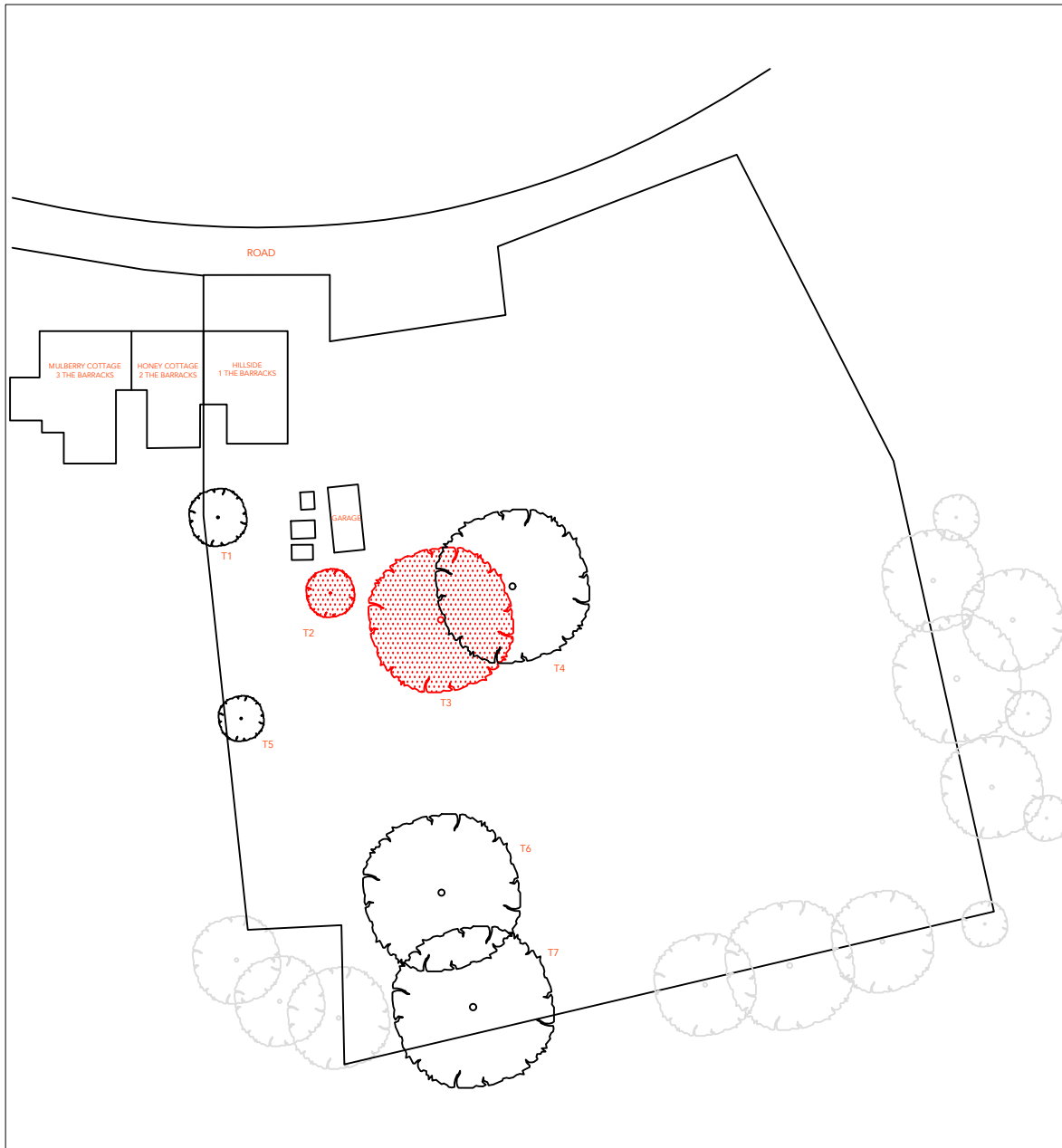

TREE SCHEDULE			
TREE ID	SPECIES	PROPOSED WORK	REASONS
T1	YEW	NONE	
T2	CHERRY	FELL	REMOVING AS TREE IS DYING AND HAS CANKERS. AND TO INCREASE LIGHT INTO GARDEN.
T3	ASH	FELL	TREE IS EXCEPTIONALLY CLOSE TO ADJACENT TREE. BOTH TREES HAVE MULTIPLE TRUNKS AND THE CANOPIES OVERCROWDED PREVENTING GROWTH ON SIDE. REMOVING TO IMPROVE HEALTH OF RETAINED TREE, INCREASE LIGHT INTO GARDEN, AND PREVENT POTENTIAL DAMAGE TO ADJACENT BUILDING STRUCTURE.
T4	ASH	NONE	
T5	APPLE	NONE	
T6	ASH	NONE	
T7	ASH	NONE	