

For Town & Country Planning Purposes only

AS PROPOSED

SASH STUFF
 Thickness 60mm
 Width of stiles 60mm
 Width of top rail 60mm
 Width of bottom rail 85mm
 Width of glazing bars 44mm
 Frame ex 150 x 75mm

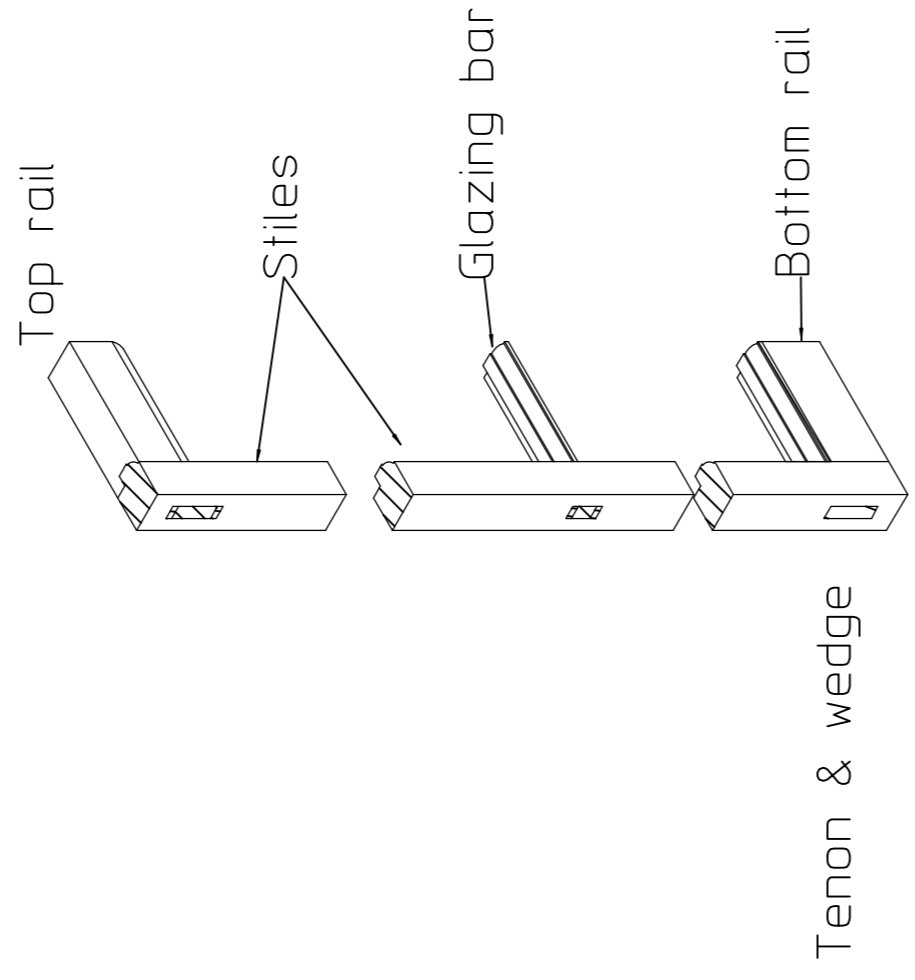

SASH JOINTS

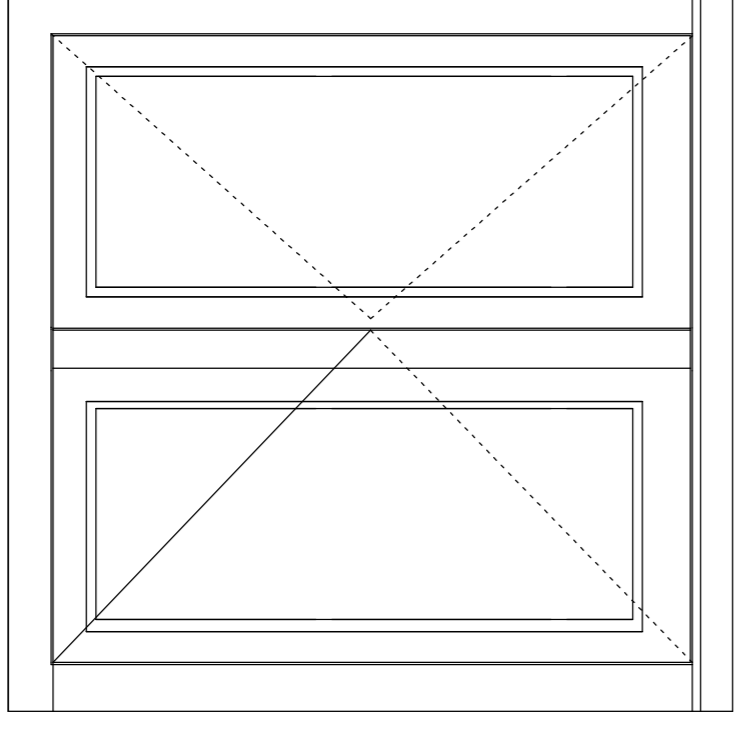

Window Furniture
 C.I. Cockspur & casement stay
 75mm C.I Butt hinges

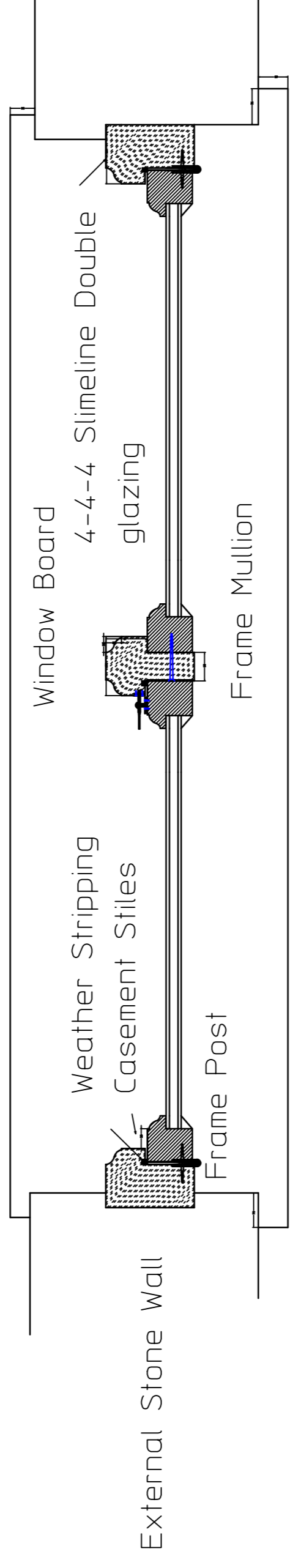

Plan of Mullioned Window

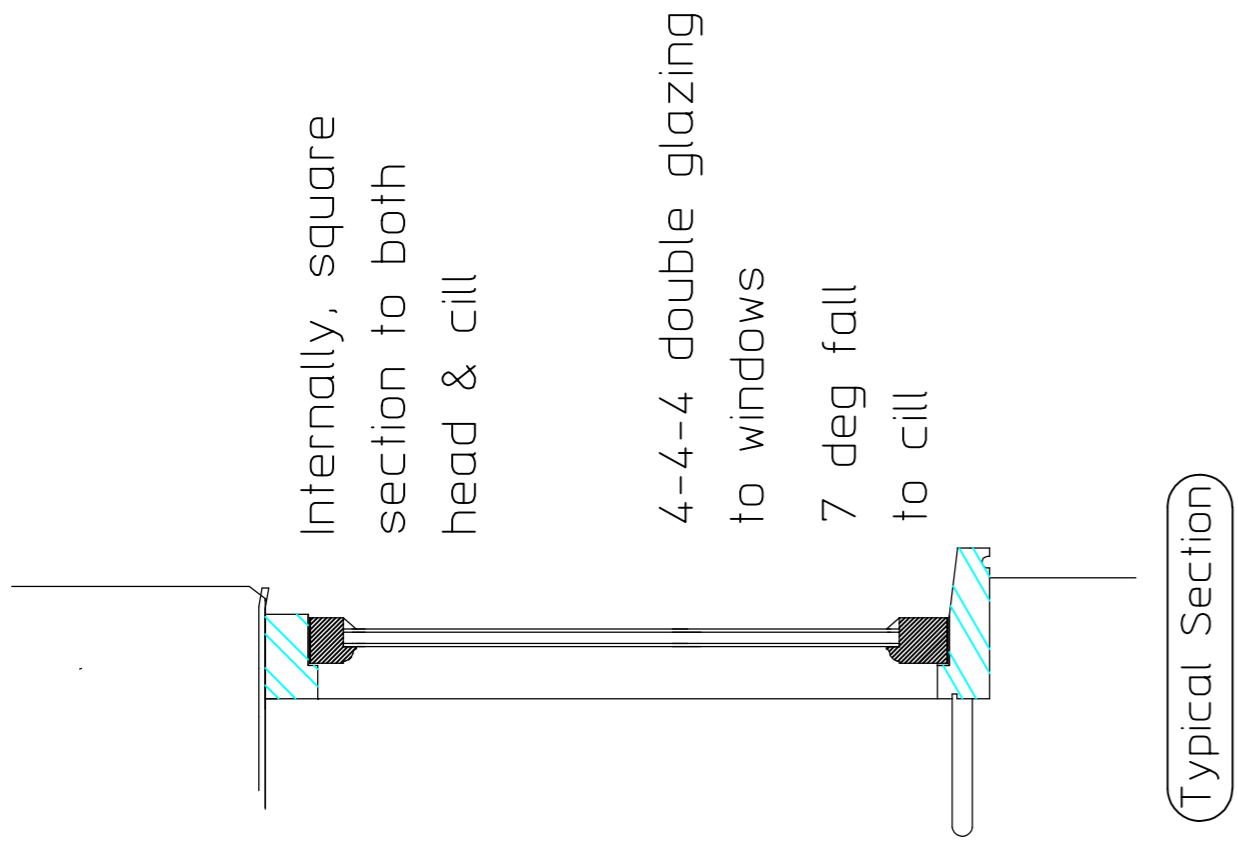

Typical Section

Lambs tongue Moulding to Sashes Mullion & Posts

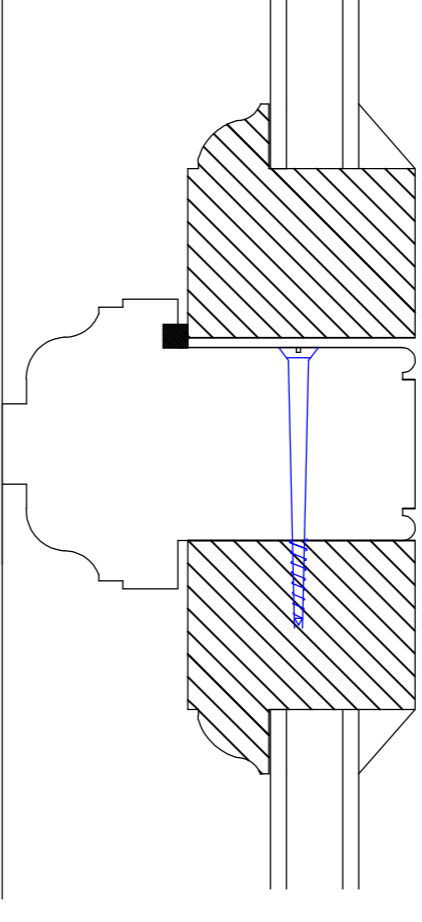

Loose mullion bolted top & bottom secured to one casement to allow egress

Half Full Size Meeting Stiles

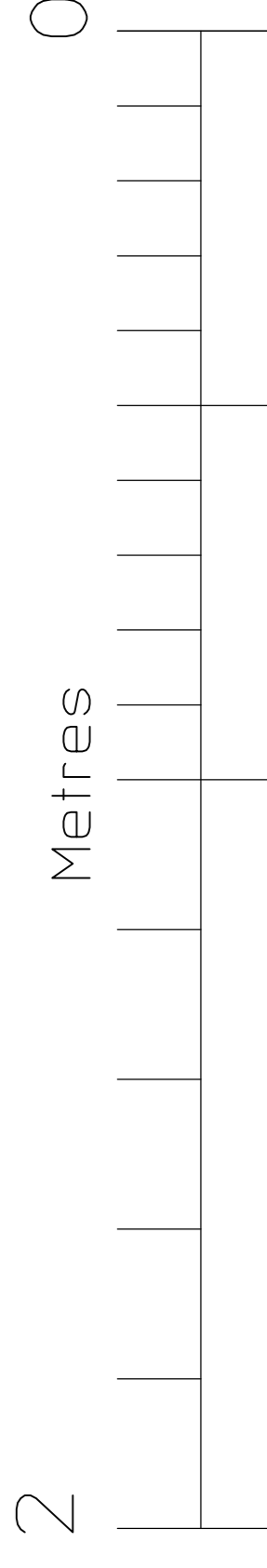

SCALE

Window to provide emergency egress
 The window should have an unobstructed openable area that is at least 0.33m² and at least 450mm high and 450mm wide. The bottom of the openable area should not be more than 1100mm above the floor.

A1 PAPER - PLOT 1 : 10
 A0 PAPER - PLOT 1 : 5

(A1)	(A1)
Ken Fowler Building Design Services	
<small>Crooklands France Lane Hawkesbury Upton Bodminon Avon GL9 1AN Telephone: 01454 23822</small>	
Client	Mr & Mrs J. Barratt
Venue	Yew Tree Cottage Hawkesbury Road Hillesley Gloucestershire GL12 7RD
Project	Replacement Windows to the Rear Elevation
Drawing	Elevations of Windows
<small>This drawing must not be scaled all dimensions and particulars to be checked on site before work commences.</small>	
<small>DATE: 4th February 2012</small>	
<small>Scale</small>	<small>1 : 10</small>
<small>DRAWN BY</small>	<small>KJF</small>
<small>Drawing No</small>	<small>244/2/2012</small>