

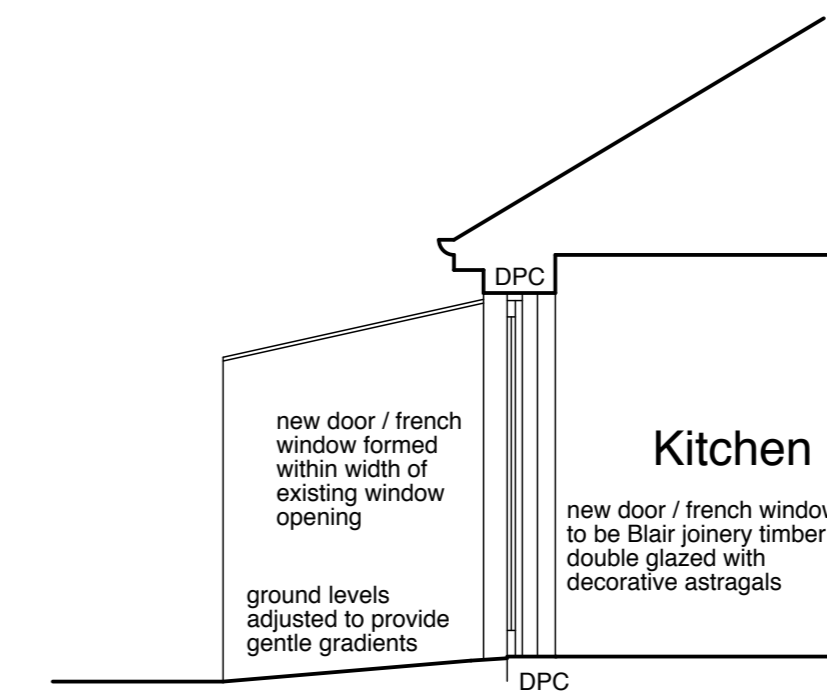

Elevation as Proposed

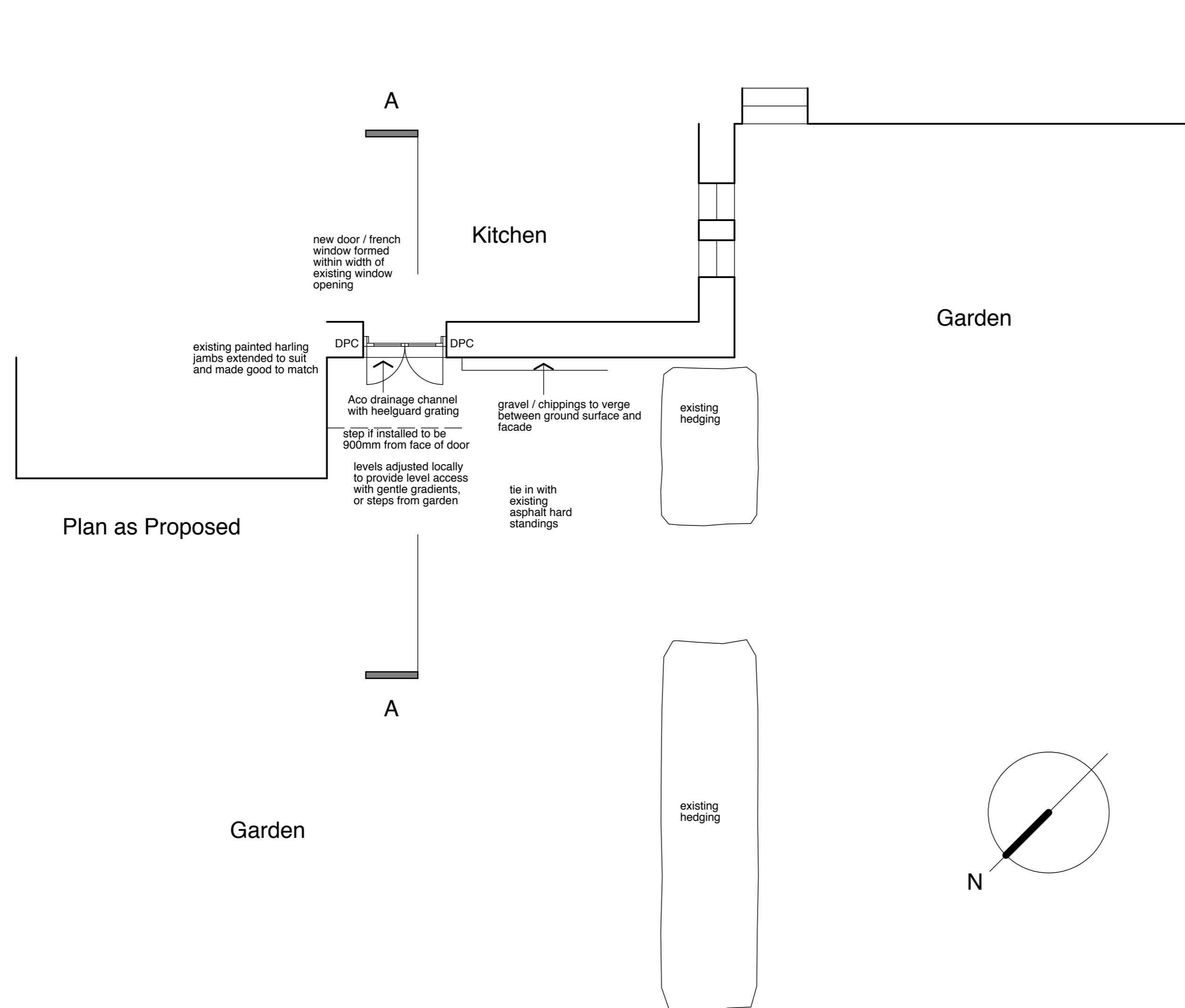

Cross-Section A-A as Proposed



Plan as Proposed

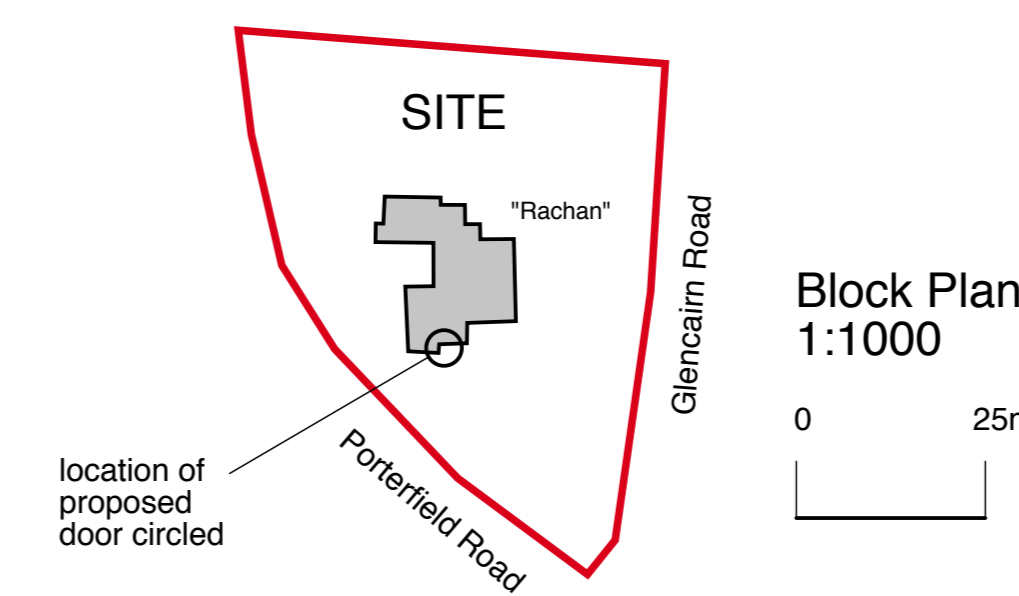

Block Plan 1:1000

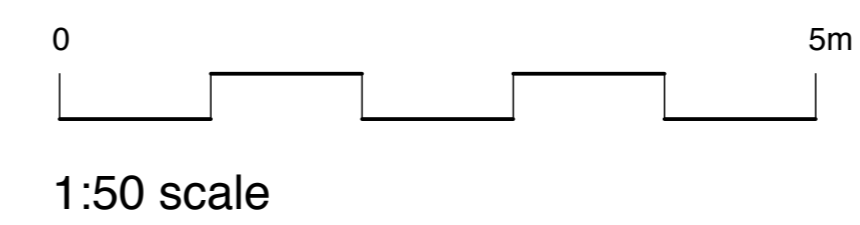

1:50 scale

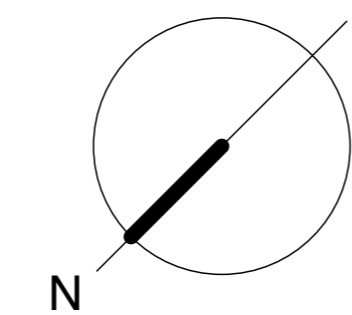

NOTES

COPYRIGHT ROBERT POTTER & PARTNERS LLP 2021

REVISIONS & ADDITIONS		DATE	BY
A	Doors to open out. Note added re external levels and Aco drain. Block Plan added.	12.03.21	RJP
B	Notes added.	16.03.21	RJP

PROJECT
Mr & Mrs K Wilson
 Proposed Door at "Rachan",
 Glencairn Road,
 Kilmacolm PA13 4PB

DRAWING TITLE
As Proposed

ROBERT POTTER & PARTNERS
 CHARTERED ARCHITECTS & PROJECT MANAGERS
 7 MILLER ROAD, AYR KAT 2AX 01292 - 261228
 51 NEWALL TERRACE, DUMFRIES DG1 1LN 01387 - 255509
 110 WEST GEORGE STREET, GLASGOW G2 1QU 0141-332 9111
 2 KINGDOM STREET, LONDON W2 6BD 020 3479 5931

SCALE	1:50	6421/02
DATE	March'21	
DRAWN BY	RJP	
CHECKED BY		REVISION
		B