

Appendix 1 Tree survey and explanatory notes

Site:
Date of Survey:
Surveyor:
Weather:

Blue Barn Farm, Elmstead Market
14/01/2021
J Choat
Damp/overcast

CHLE = over head line equipment
Estimated

Tree ref	Species	Height in m	Stem diameter in mm	BPA in M2	Radial distance required for BPA	Branch spread				Height of crown clearance in m	Age class	Ground condition	Water demand	Observations	Preliminary management recommendations	Works urgency	Estimated remaining contribution in years	Category grading
						N	E	S	W									
T1	Oak	5	420	79.8118272	5.04	3	3	3	3	0	M	Bare soil	High	Good condition. Twin stem.	None	0	20+	B1
T2	Alder	2	460	95.7379268	5.52	3	3	3	3	2	EM	Bare soil	High	Good condition. Leaning stem.	None	0	20+	C1
T3	Alder	0	350	68.8174408	4.68	3	3	3	3	2	EM	Bare soil	High	Good condition.	None	0	20+	B1
T4	Alder	8	300	60.72012	3.6	2	2	2	2	1	EM	Bare soil	High	Poor condition. Sparse crown.	Monitor next growing season, replace if necessary.	0	10+	C1
H1	Larch	1	75	2.54502	0.9	0.5	0.5	0.5	0.5	0.5	Y	Bare soil	Moderate	Recently started on south eastern aspect, could be translocated if required.	None	0	10+	C1

Explanatory Notes

Referencing

Each tree is given a unique reference number and plotted on the attached plans for clear identity. Individual trees are referenced as T1, T2 etc, Groups G1, G2 etc Hedgerows H1, H2 etc and Woodlands W1, W2 etc.

Species

All species are recorded using common names. Identification is made using experience and knowledge.

Tree dimensions

Tree height is measured and recorded in meters and taken from the base of the stem to the tip of the crown. Height is estimated using experience and knowledge.

Diameter at Breast Height (DBH) is measured at approximately 1.5m from the ground up the stem and is measured and recorded in millimetres. DBH is measured accurately using a diameter tape.

Crown spread is measured in meters from the stem to the extent of the crown spread to each compass point (NESW). Crown spread is estimated using experience and knowledge.

Crown clearance is the height from ground level to the lowest branch and is measured in meters. Crown clearance is estimated using experience and knowledge.

Age class

Age class falls in to 4 categories:

Y	Young
EM	Early Mature
M	Mature
OM	Over Mature

Observations

The biological condition of the tree is assessed and noted. Notable defects are recorded; fruiting bodies, cankers, die back, exudates, etc are recorded.

The mechanics of the tree are assessed and noted. Notable defects are recorded; buckling, rib formation, stresses, bulges, soil cracks, large cavities or wounds, tight branch junctions, etc are recorded.

Preliminary management recommendations

Tree management is recommended following the assessment of physiological and structural condition. Recommended works may include, no work required, crown reduction, crown lift, fell, crown thin, monitor etc.

Estimated remaining contribution in years

An estimate of remaining life expectancy recorded in years. Estimated remaining contribution is made using experience considering the structural and physiological condition of the tree, nuisance, previous management, etc.

Category grading and colour coding on plan

A (Green square) high quality and value

B (Blue square) moderate quality and value

C (Grey square) low quality and value

U (Red Square) those that cannot be retained as living trees

Sub categories

- 1 arboricultural values
- 2 landscape values
- 3 cultural values, including conservation

Works priority

- 1 Works required immediately to make the tree safe
- 2 Works required within 60 days
- 3 Works required as part of routine operations
- 0 no works required

Appendix 2 Tree survey and constraints plan

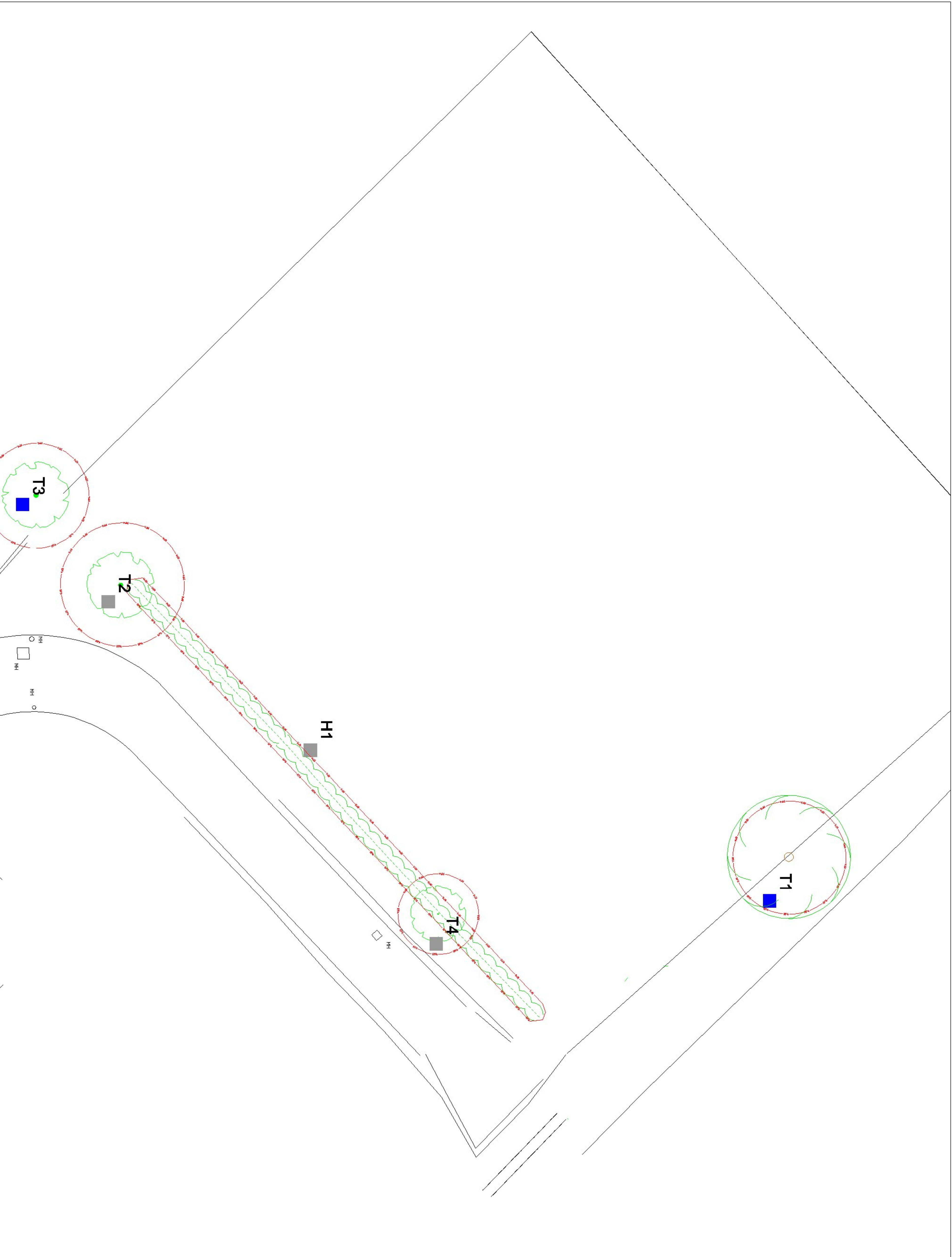

Legend:



Tree and crown spread

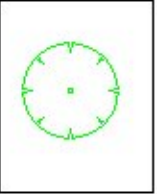

Root protection area

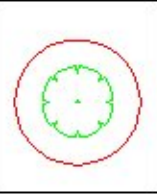

BS 5837 Retention Category A

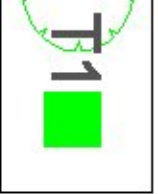

BS 5837 Retention Category B

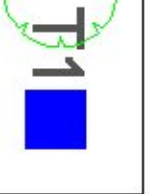

BS 5837 Retention Category C



BS 5837 Retention Category U

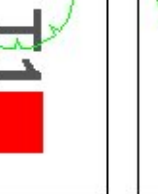

Notes:
This drawing was produced in colour, a monochrome copy should not be relied upon.

Project: Blue Barn Farm, Elmstead Market

Drawing Title:

Tree Survey and Constraints Plan

TPS

Arboricultural Consultancy

28 Fildene Road
Fildene On Sea
CO17 8BP
T 01493 811111
E info@arboricultural.co.uk
W www.arboricultural.co.uk

Date: 23rd January 2021

Scale: 1:200 @ A1

Drawing Number: TP016000016 TSCP

Appendix 3 Barrier construction profile

Permission to reproduce extracts from BS 5837:2012 is granted by the British Standards Institution (BSI). No other use of this material is permitted. The complete British Standard can be purchased from the BSI online shop: <http://shop.bsigroup.com/en/ProductDetail/?pid=000000000030213642>

Diagram 1 Weldmesh panels with block supports pegged to brace light impact

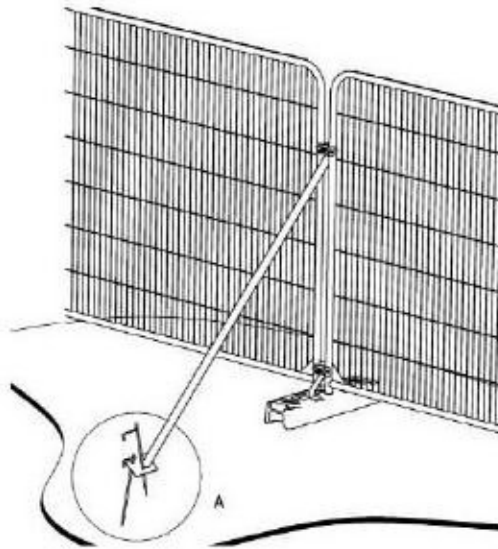

Diagram 2 Weldmesh panels with block supports and further block supports to brace intermediate impacts

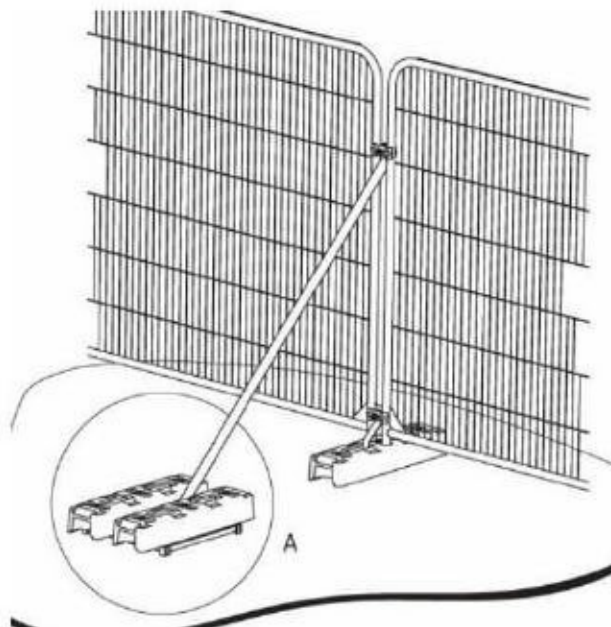
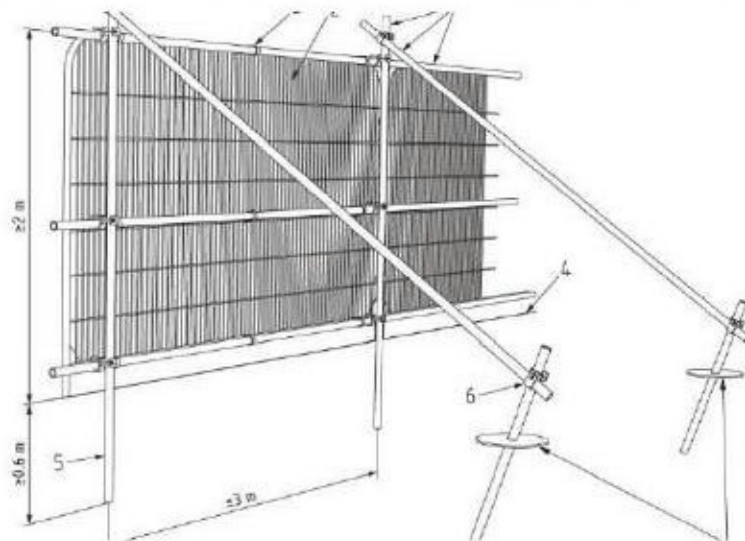

Diagram 3 Weldmesh panels with scaffold frame posts driven into the ground to brace heavy impacts



Construction Exclusion Zone

These trees have been retained and protected as part of the planning permission for this site.

Any breach of the protection will result in enforcement action from the Local Authority.

TPS

Appendix 5 Tree protection plan

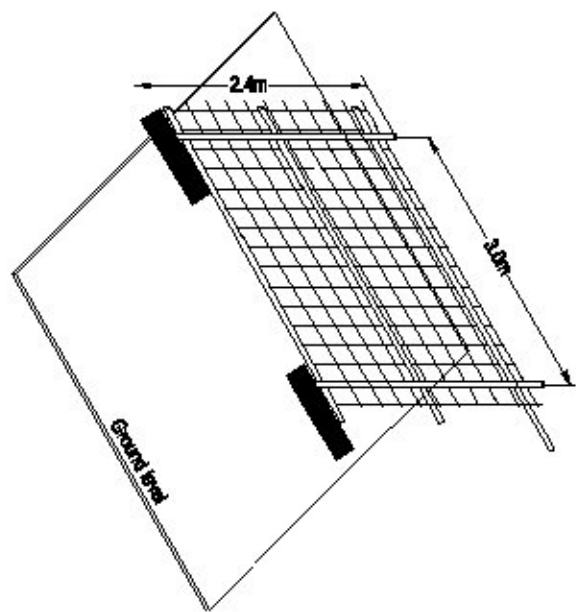

Tree Protection Barrier to BS5836: 2012
Protective barriers should be erected prior to the commencement of any site clearance, demolition or development. No storage within the construction exclusion zone (hatched areas)
The fencing should utilize a scaffold framework in accordance with the detail shown above.
Weathermesh panels should be set in rubber block supports and cable tied or clamped with sealed clamps, to the upright panel.
The fencing should be erected at or beyond the extremities of the TPA as shown on the tree protection plan and should not be moved unless agreed with the project arboriculturist and local planning authority.
Intermeshes should be placed on barriers at 1.5m in height at 8m intervals, facing outwards. Intermeshes should clearly provide details of the protection zone and correct procedures.

Weatherproof Intermesh to be placed on barriers
Construction Exclusion Zone
No access is permitted
The trees beyond this protected zone are subject to planning conditions and statutory protection
Any breach of this zone will result in enforcement action by the Local Authority

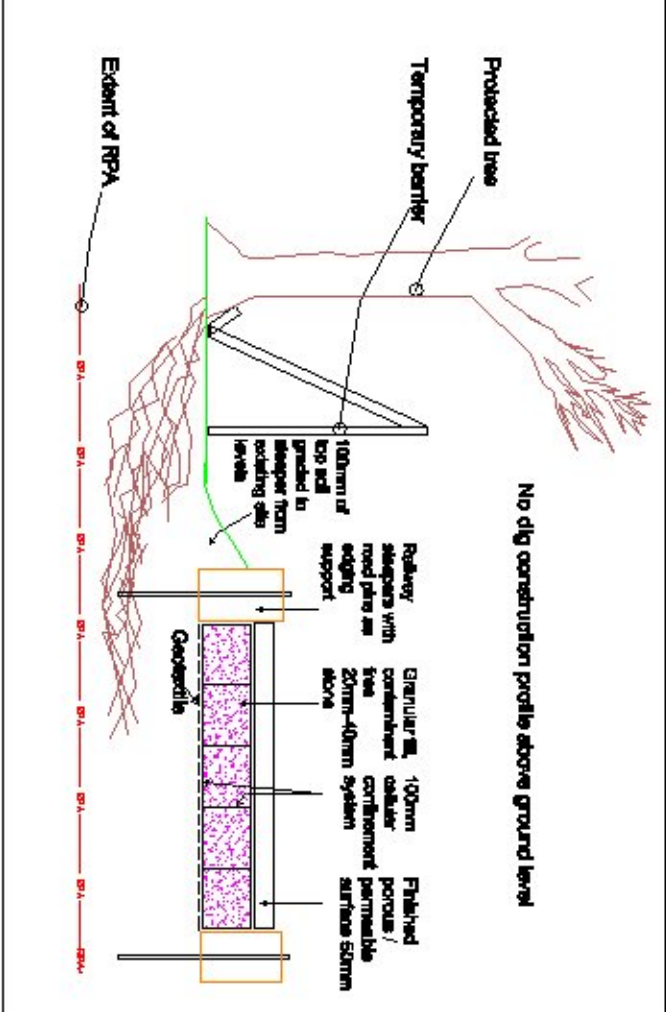

Legend:

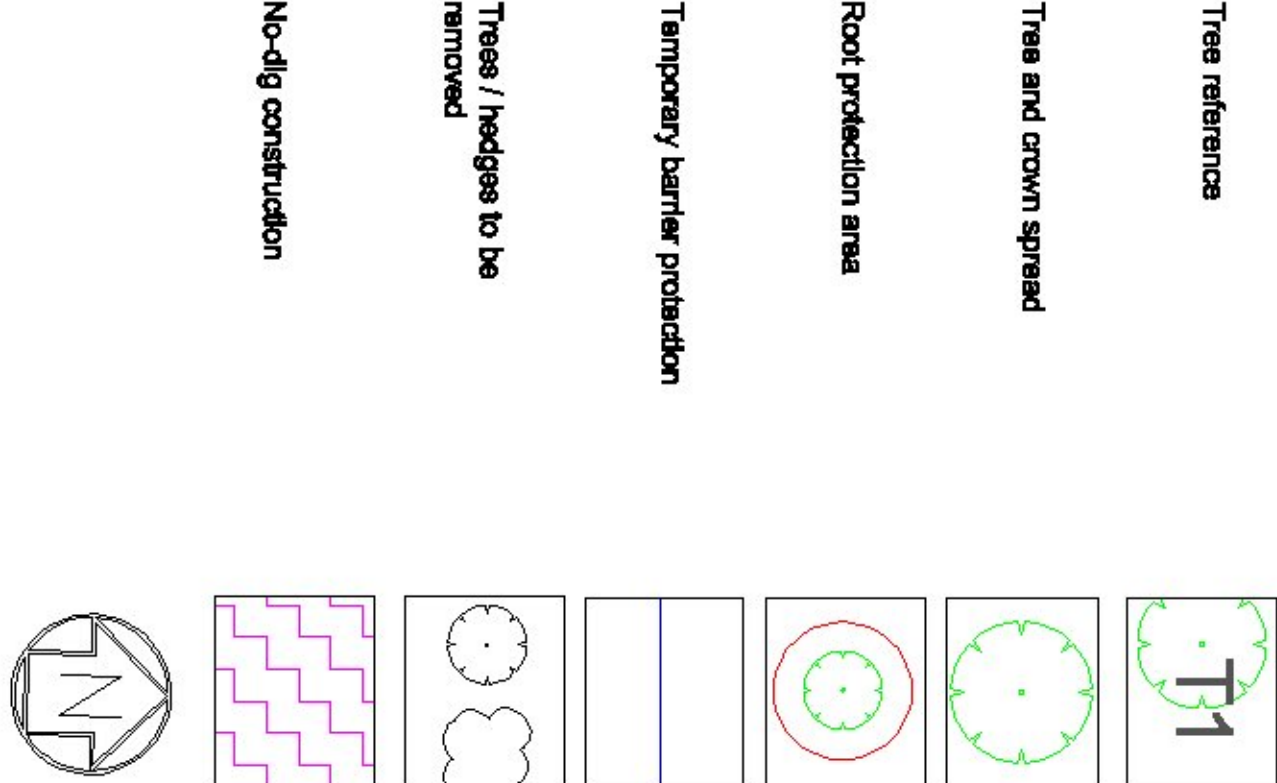

Notes:
This drawing was produced in colour, a monochrome copy should not be relied upon.

Project: Blue Barn Farm, Elmstead Market
Drawing Title: Tree Protection Plan

TPS
Arboricultural Consultancy

25 Friarage Road
Filton On Sea
Bristol
CV35 9AP
T: [REDACTED]
E: [REDACTED]
W: www.deepplanninguk.co.uk

Date: 23rd January 2021
Scale: 1:200 @ A1
Drawing Number: TPSar0000018 TPP

Appendix 6

Example of site monitoring pro forma

Tree Planning Solutions

Contract Monitoring Form

Details

Date	
Time	
Surveyor	
Client	
Site	
Ref	

Trees

Tree ref	Condition	Recommendations

Barrier

Tree ref	Barrier type	RPA radial distance as per planning permission	Actual barrier radial distance at site	Condition of barrier	Condition of signage	Comments

Tree Planning Solutions

Ground Protection

Tree ref	Type of ground protection installed	RPA distance as per planning permission	Actual distance of ground protection at site	Condition of ground protection	Comments

Additional Comments