

Traditional top hung outward opening timber framed window to match existing. Colour to match existing.

Traditional timber framed double glazed fixed pane window to match existing. Colour to match existing

Traditional side hung timber framed double glazed outward opening casement window to match existing. Colour to match existing

Existing timber window sill retained

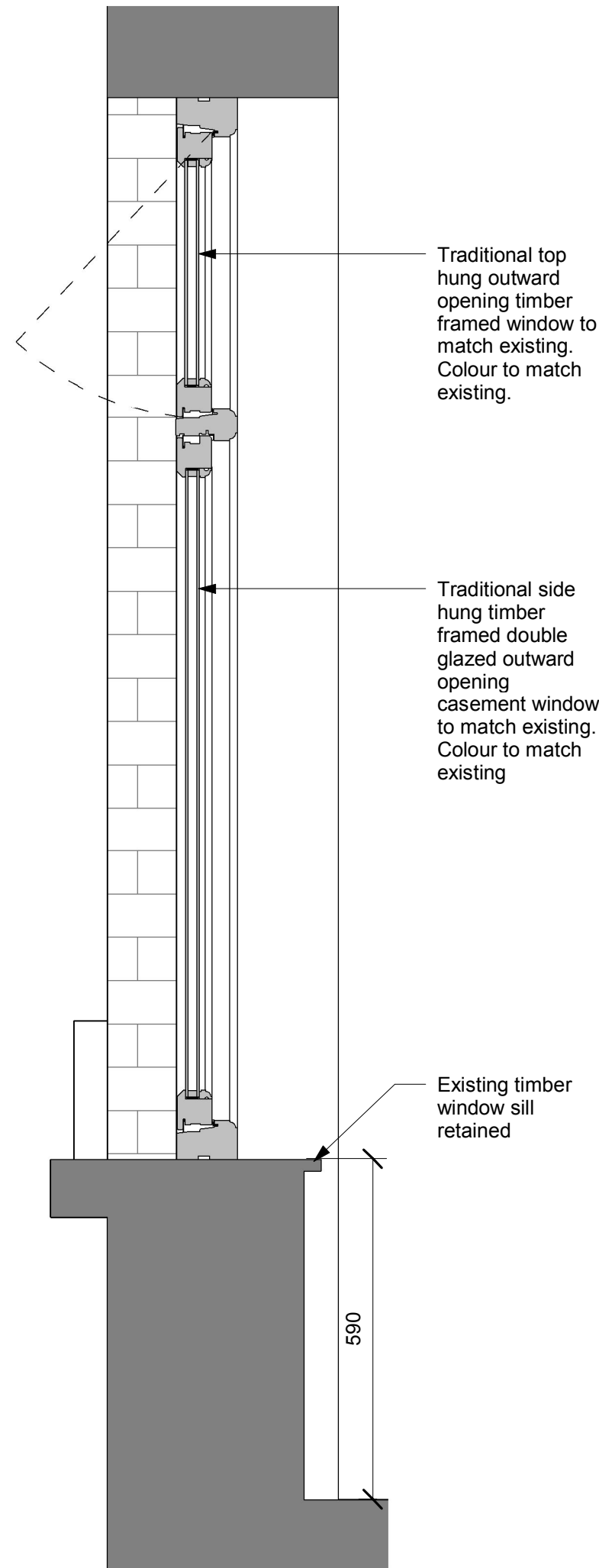

Notes

1. Do not scale this drawing.
2. All dimensions must be checked on site and any discrepancies verified with the architect.
3. Unless shown otherwise, all dimensions are to structural surfaces.
4. Drawing to be read with all other issued information. Any discrepancies to be brought to the attention of the architect.
5. This drawing is the copyright of Paul Little Architect and may not be copied, altered or reproduced in any form, or passed to a third party without license or written consent.

This is not a construction drawing, it is unsuitable for the purpose of construction and must on no account be used as such.

NOTE: WINDOWS 01 AND 02 SHARE THE SAME DIMENSIONS

1 24/02/21 ISSUED FOR PLANNING

Rev Date Description Initials

Project name

235 Sussex Gardens - Flat 5

Retrospective Planning / Listed Building Consent

Drawing number Rev

0007 - PLA - XX - XX - DR - A - 0006 1

Drawing

Proposed As Installed Window Type 01/02 Details - Lounge

Purpose of issue Date

PLANNING 02/05/21

Scale

1 : 10 @ A3

Client

Victoria Rudnik and Boris Rudnik

PLA | Paul Little Architect

paullittlearchitect.co.uk

T +44 (0)7903 624 996

1 Proposed As Installed North West Exterior Elevation - W-01 / W-02
1 : 10

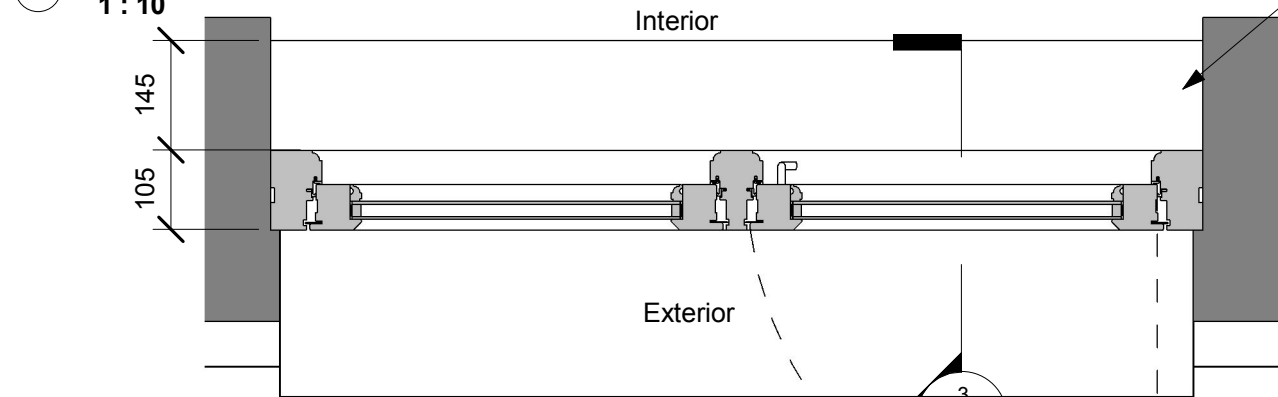

2 Proposed Window Plan Detail - W-01 / W-02
1 : 10

3 Proposed Window Section Detail - W-01 / W-02
1 : 10