

Location Plan 1:1250

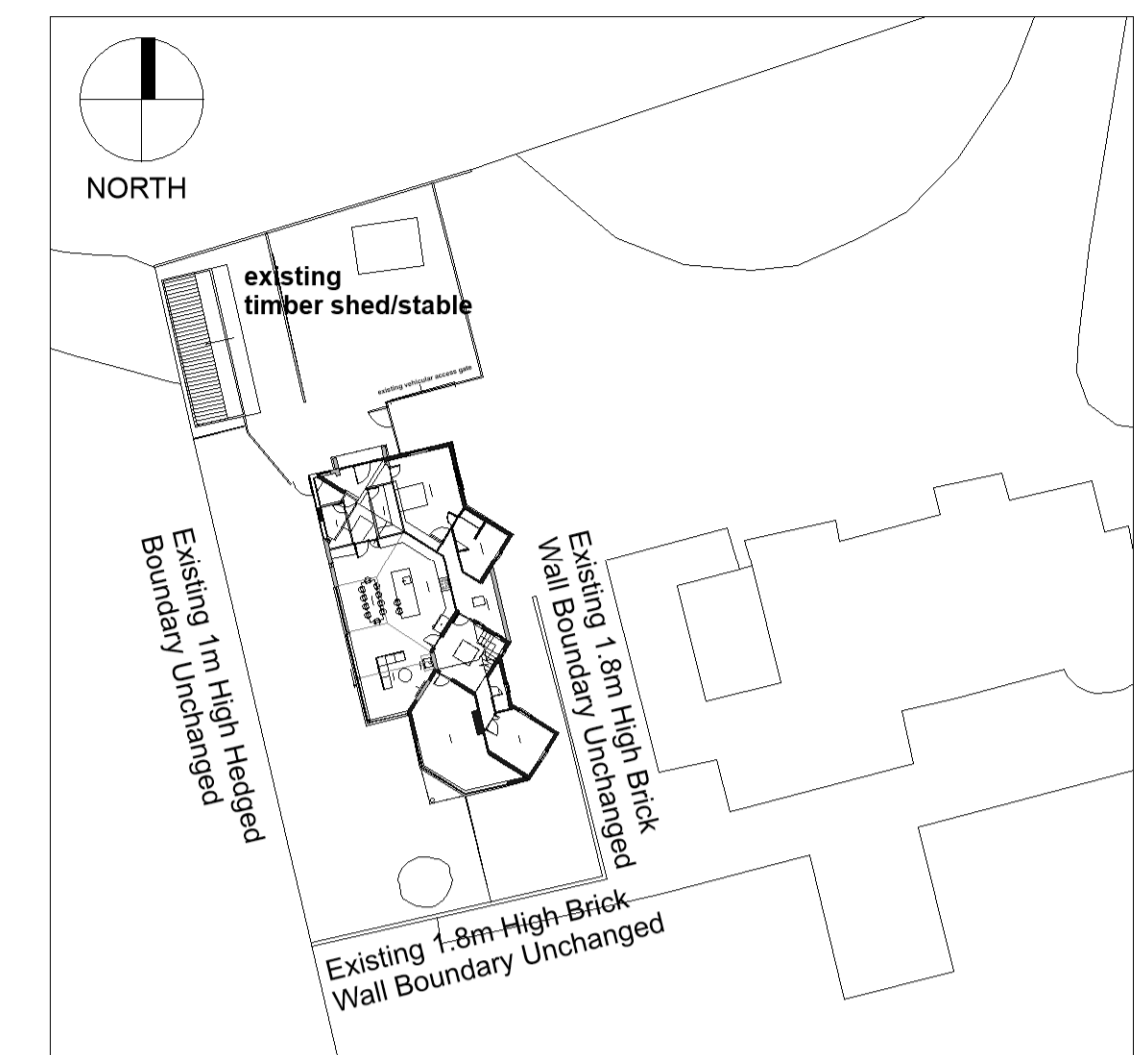

Existing Block Plan 1:500

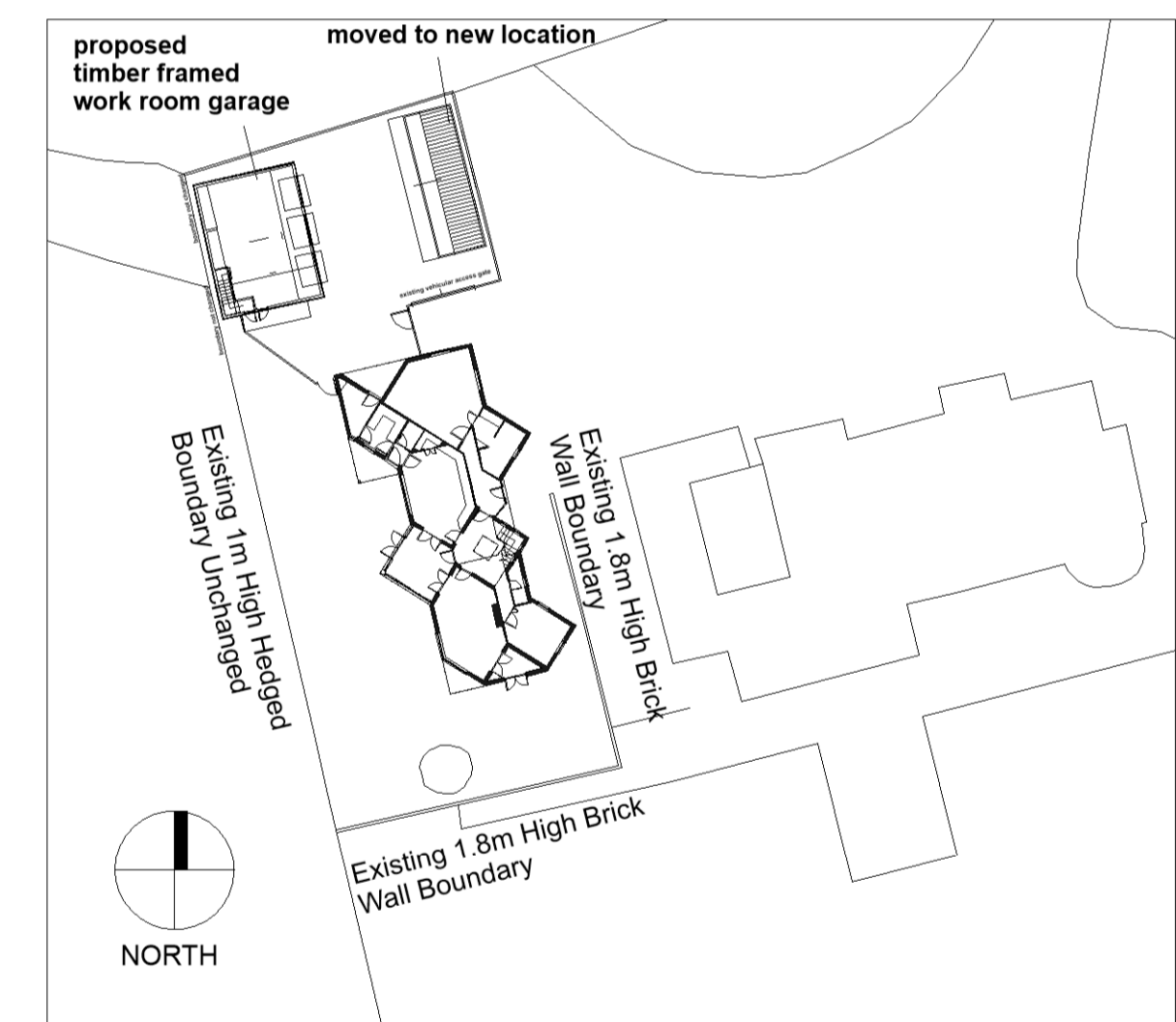

Proposed Block Plan 1:500

**Jonathan Smith Architects**

18 Cherry Tree Terrace,  
Beverley,  
East Riding of Yorkshire,  
HU17 0EN



Telephone 01482 881864  
Jonathan Smith Architects Ltd  
Registered in England & Wales Reg No. 7992963

Client's name  
Mr J Griffin

Job title  
New Work Room, Stable  
and Garage,  
The Manor House,  
Northlands,  
Walkington,  
HU17 8RU

Drawing title  
Location Plan  
Existing &  
Proposed Block Plan

Drawn  
JPS  
Job No  
2011-492  
Status  
Planning

Drawing No.  
03

Date  
16.02.21  
Scale  
1:1250  
1:500  
@A1