

GENERAL NOTES:

1. ALL CLADDING TO BE CE MARKED AND HOT-DIP GALVANISED TO BS EN 10346:2009.

2. ALL STEEL (INCLUDING PURLINS) TO BE CE MARKED AND TO EXECUTION CLASS 2 AS PER EN 1090 - 1:2009 AND HOT-DIP GALVANISED TO BS EN 10346:2009 Fe E390G-Z275.

3. DESIGN LOADS TO BS 6399-1:1997

AND BS 6399-3:1997. DEAD LOADS: SW CONSIDERED INTERNALLY WITHIN PROGRAMME

-CEILINGS AND SERVICES = kN/m²

-RAFTER CLADDINGS AND PURLINS = kN/m²

-COLUMN CLADDINGS AND RAILS = kN/m²

-SNOW LOAD = kN/m²

-LIVE LOAD = kN/m²

4. WIND LOAD ACCORDING TO BS

6399-2:1997 WITH THE FOLLOWING

PARAMETERS:

BASIC WIND SPEED = m/s

SITE ALTITUDE = m

SITE ALTITUDE FACTOR =

SEASONAL FACTOR = DIRECTION FACTOR =

SITE DISTANCE FROM SEA = Coastal

5. ALL STEEL TO HAVE YIELD STRENGTH $P_y = 450$ MPa.

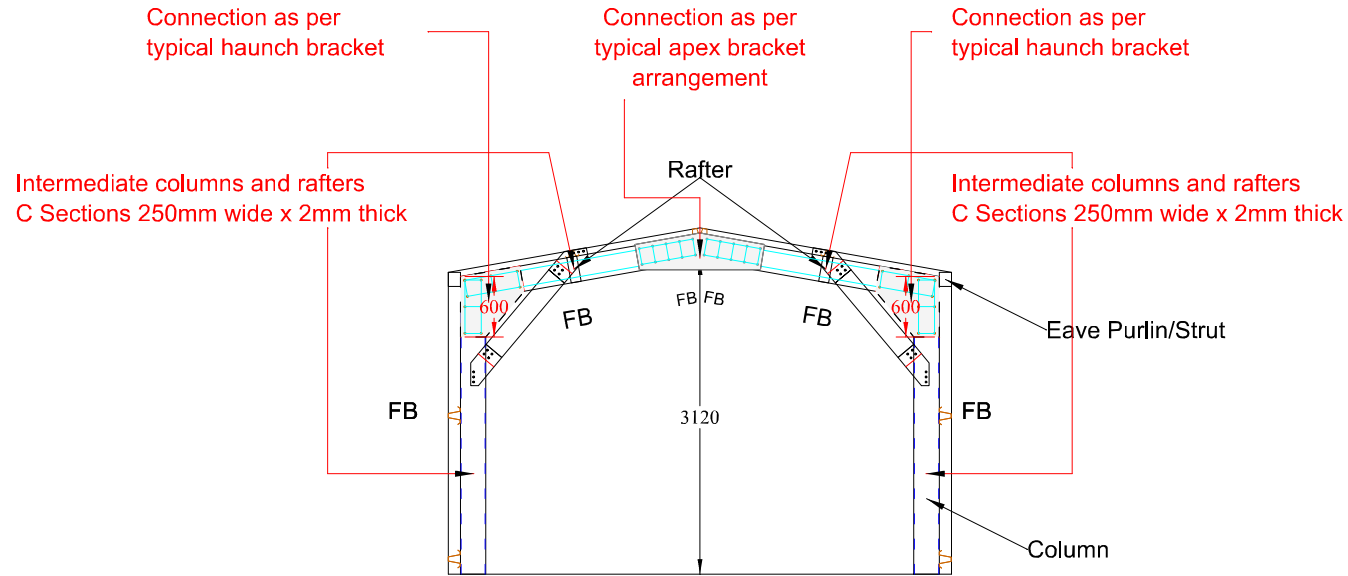

Cross Section (Scale = 1:75)



Capital Steel Limited

Web: www.capitalsteelbuildings.co.uk
Email: info@capitalsteelbuildings.co.uk

Supplied By: Grampian Steel Buildings Ltd

Phone +44 1779 480 700

Email robert@grampiansteelbuildings.co.uk

Customer: ANDY WILKIE

Peterhead AB42 3JN