

ANY DIMENSIONS SHOWN FROM EXISTING AND/OR NEW BOUNDARIES TO BUILDINGS ARE FOR PLANNING APPLICATION PURPOSES ONLY BUT CAN BE SCALED

PLANNING APPLICATION DRAWING ONLY

Roof tiles to match exstg.,
Eaves details to match exstg.,
Window details to match exstg.,
Facing brwk to match exstg.,
Rainwater goods to match exstg.,

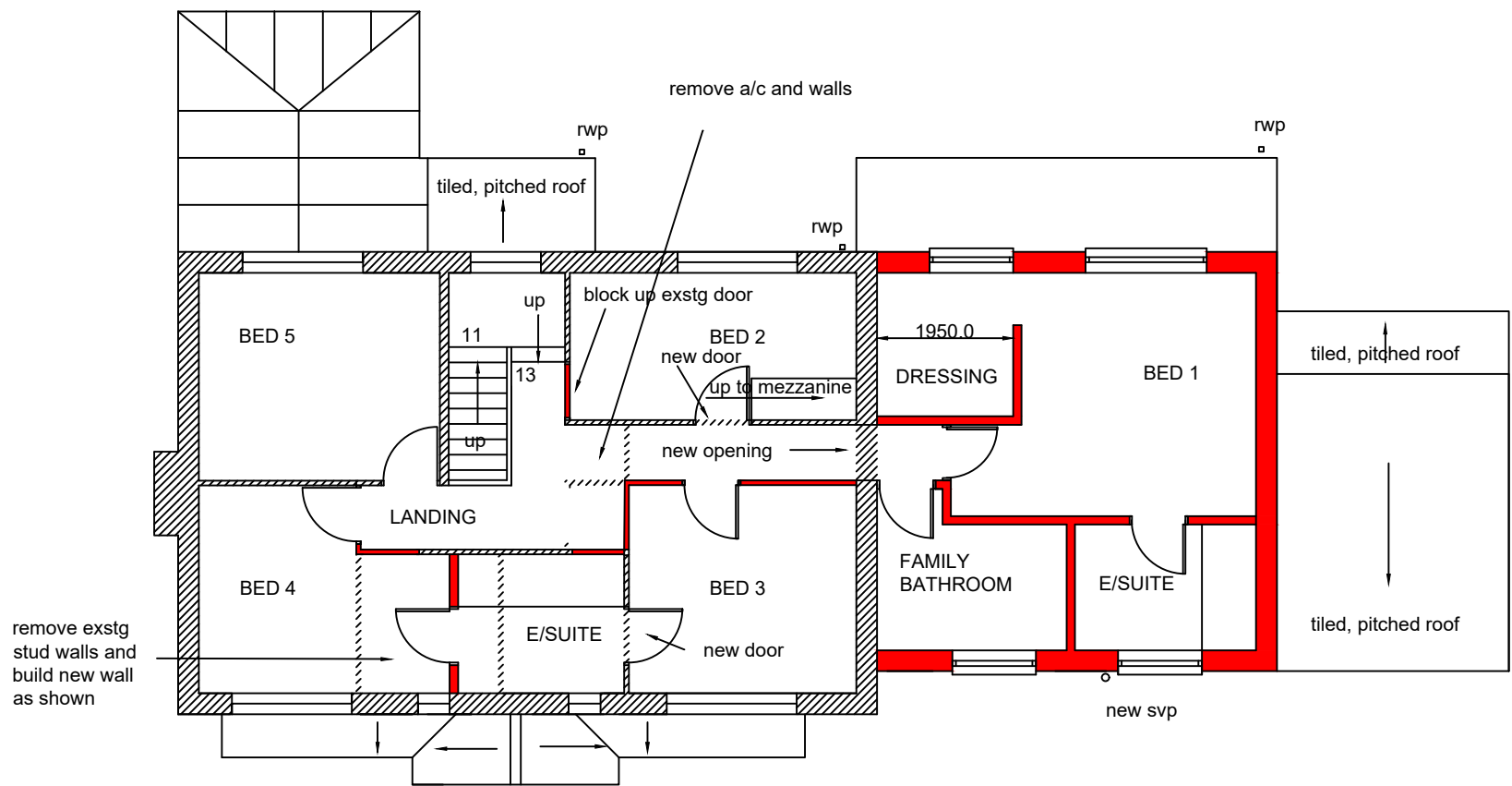

FIRST FLOOR PLAN

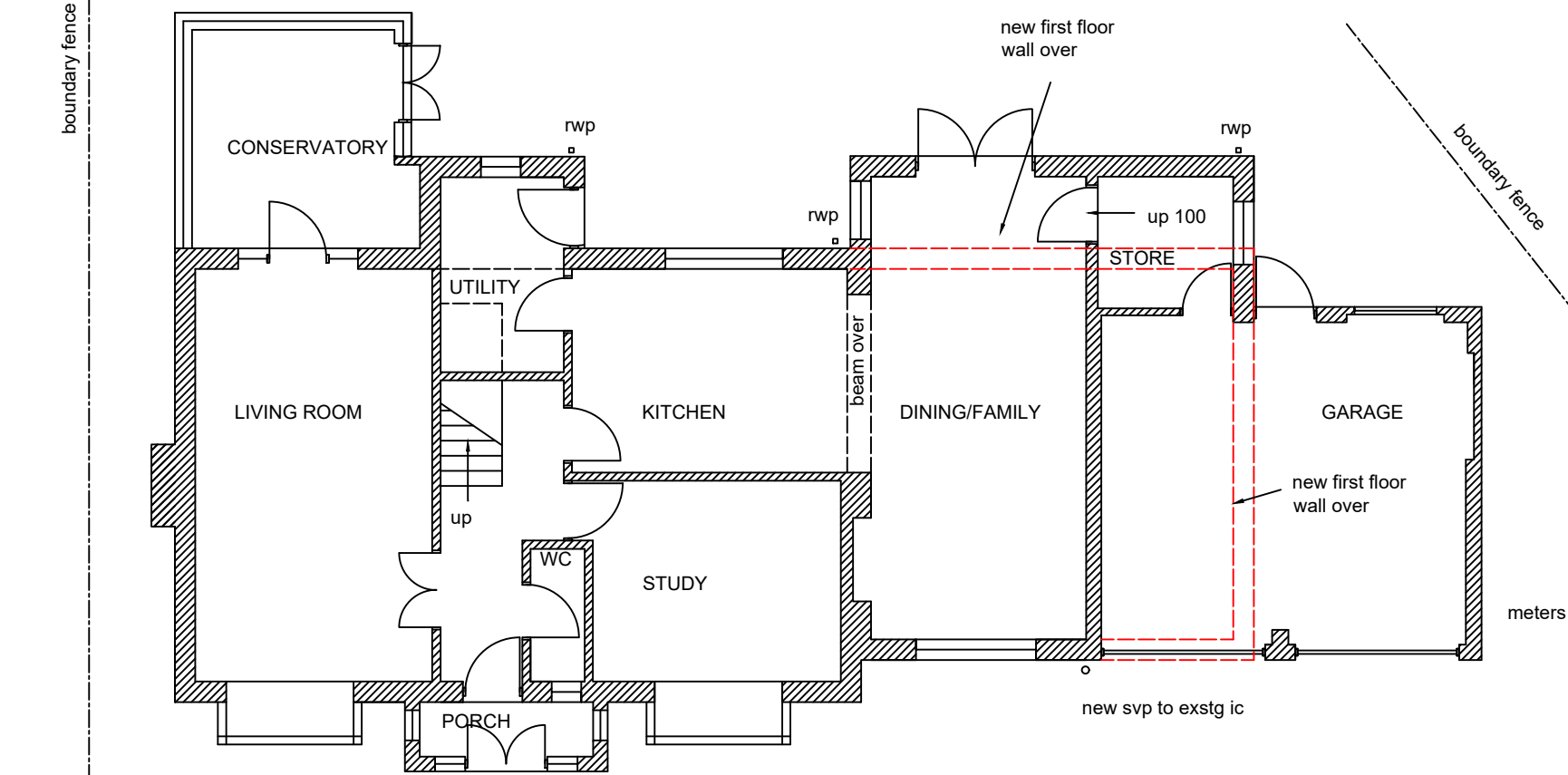

GROUND FLOOR PLAN

THE CONTRACTOR MUST CHECK ALL DIMENSIONS AND GENERAL LAYOUT BEFORE COMMENCING WORK ON-SITE. IF IN DOUBT, ASK!

THIS DRAWING MAY BE SCALED FOR PLANNING APPLICATION PURPOSES BUT NOT FOR CONSTRUCTION USE.

THE CONTRACTOR WILL ENSURE THAT ALL ELEMENTS OF THE STRUCTURE ARE SUITABLE FOR THE INTENDED PURPOSE AND FITTED/INSTALLED IN ACCORDANCE WITH THE MANUFACTURER'S INSTRUCTIONS.

WHERE POSSIBLE, ALL ELEMENTS OF THE STRUCTURE SHOULD BE MANUFACTURED TO CURRENT BRITISH AND/OR EUROPEAN STANDARDS, INCLUDING BBA.

THE CONTRACTOR WILL BE AWARE OF CURRENT HEALTH & SAFETY AT WORK/CDM LEGISLATION, AND ENSURE THAT THE SITE/PROJECT OPERATES WITHIN AND CONFORMS TO THAT LEGISLATION.

IF THE PROJECT ON THIS DRAWING WAS SUBJECT TO PLANNING APPROVAL, IT IS THE CLIENT'S RESPONSIBILITY TO ENSURE THAT ALL SAMPLES OF FACING MATERIALS SUCH AS BRICKWORK AND ROOF TILING ETC ARE EXAMINED AND APPROVED BY THE LOCAL AUTHORITY PLANNING DEPARTMENT BEFORE WORK COMMENCES ON-SITE.

COPYRIGHT ARCHITECTURAL SERVICES

PROJECT:- FIRST FLOOR SIDE EXTENSION AND INTERNAL ALTERATIONS TO FIRST FLOOR

ADDRESS:- 64 HERITAGE COURT, BOLEY PARK, LICHFIELD, STAFFS WS14 9ST

CLIENT:- MR. & MRS. D. PREECE

Drwg. No:- 1537.4A(proposed plans)

Date:- January 2021

Scale/s:- 1/100

Amendments:-

A rear facing store window removed from gf plan; Mar 21

Architectural Services

Heather Bank, Huntsman's Hill,
Upper Longdon, Staffs WS15 1QE

Telephone 01543 491205
Mobile 07854 143976

e-mail davidarchservs@gmail.com

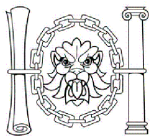

**Chartered Institute of
Architectural Technologists**

Sole practitioner:- David Yarnall, MCIAT
Chartered Architectural Technologist
Member of the Chartered Institute of Architectural Technologists