

BS 5837: TREE CATEGORY GUIDE

Category U: Unsuitable for retention, trees with less than 10 years life expectancy.

Category A: high quality trees, able to make a substantial contribution for at least 40 years, normally retained unless there is an over-riding reason for removal and appropriate mitigation.

Category B: moderate quality trees, able to make a significant contribution for at least 20 years, normally retained.

Category B/C: an intermediate category between categories B and C (not specifically described in BS5837). Trees, which should be retained wherever possible, providing retention does not significantly constrain the layout.

Category C: low quality, in adequate condition to remain for at least 10 years, or young trees <150mm stem diameter. Trees which can be removed to allow the desired layout or new planting.

BS58837 Shade Area - area in which shading of living accommodation may affect sustainability of trees. Keep living accommodation out of these areas.

Construction Exclusion Zone - area in which no excavation or changes in levels should be permitted. Limited hard surfacing, (covering up to 20% of the Root Protection Area) may be possible if No-Dig construction is used.

ADVISORY:
THE ENTIRE GARDEN AREA IS OVERGROWN WITH HORSETAIL.
HORSETAIL (EQUISETUM SP.) IS AN INVASIVE, DEEP ROOTED, PERNICIOUS WEED WHICH WILL NEED SPECIALIST HELP TO ERADICATE. USE OF HERBICIDES MUST BE CAREFULLY CONTROLLED TO PREVENT POTENTIAL ADVERSE IMPACT ON UNDERLYING TREE ROOTS. IF NOT CONTROLLED IT CAN CAUSE STRUCTURAL DAMAGE TO HARD SURFACES.

Possible Overlooking Property

APPENDIX A

Key

- Category U
- Category A
- Category B
- Category C
- Crown spread: retained trees
- Trees For Removal
- Root Protection Area
- Construction Exclusion Zone
- BS 5837 Shade Area

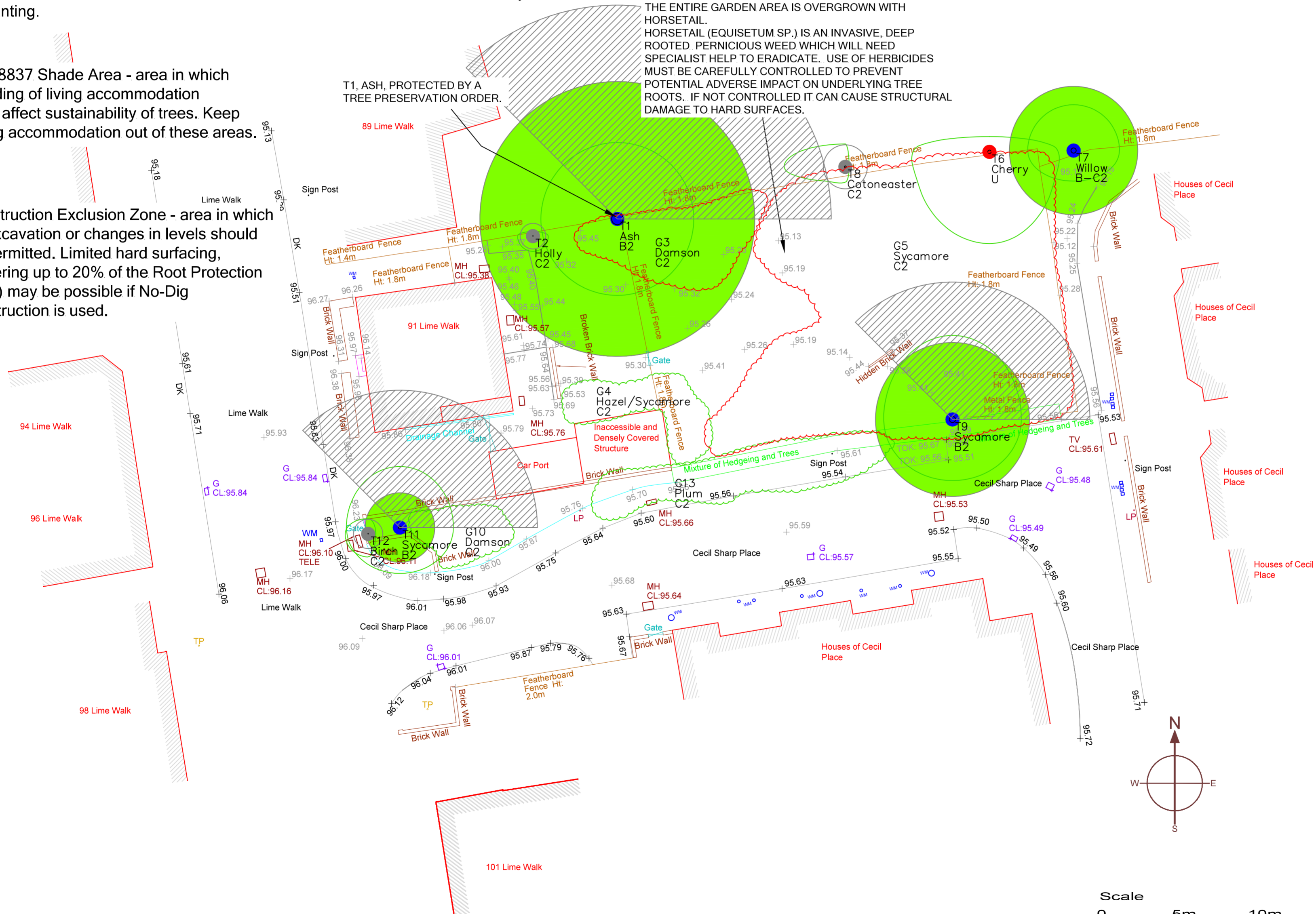

SJ Stephens Associates
Savernake Barn, Stokke Common
Great Bedwyn
Marlborough
Wiltshire SN8 3LL
01672 871862
www.sjstephens.co.uk

JOB TITLE
91 LIME WALK
OX3 7AD

DRAWING TITLE
TREE CONSTRAINTS PLAN

DRAWING NUMBER	REV
1564-01	

REVISIONS

SCALE	DATE	DRAWN BY
1:200 at A2	AUG 20	C Fforde