

WEST ELEVATION - AS PROPOSED 1:50 @A1

WEST ELEVATION - AS PROPOSED 1:50 @A1

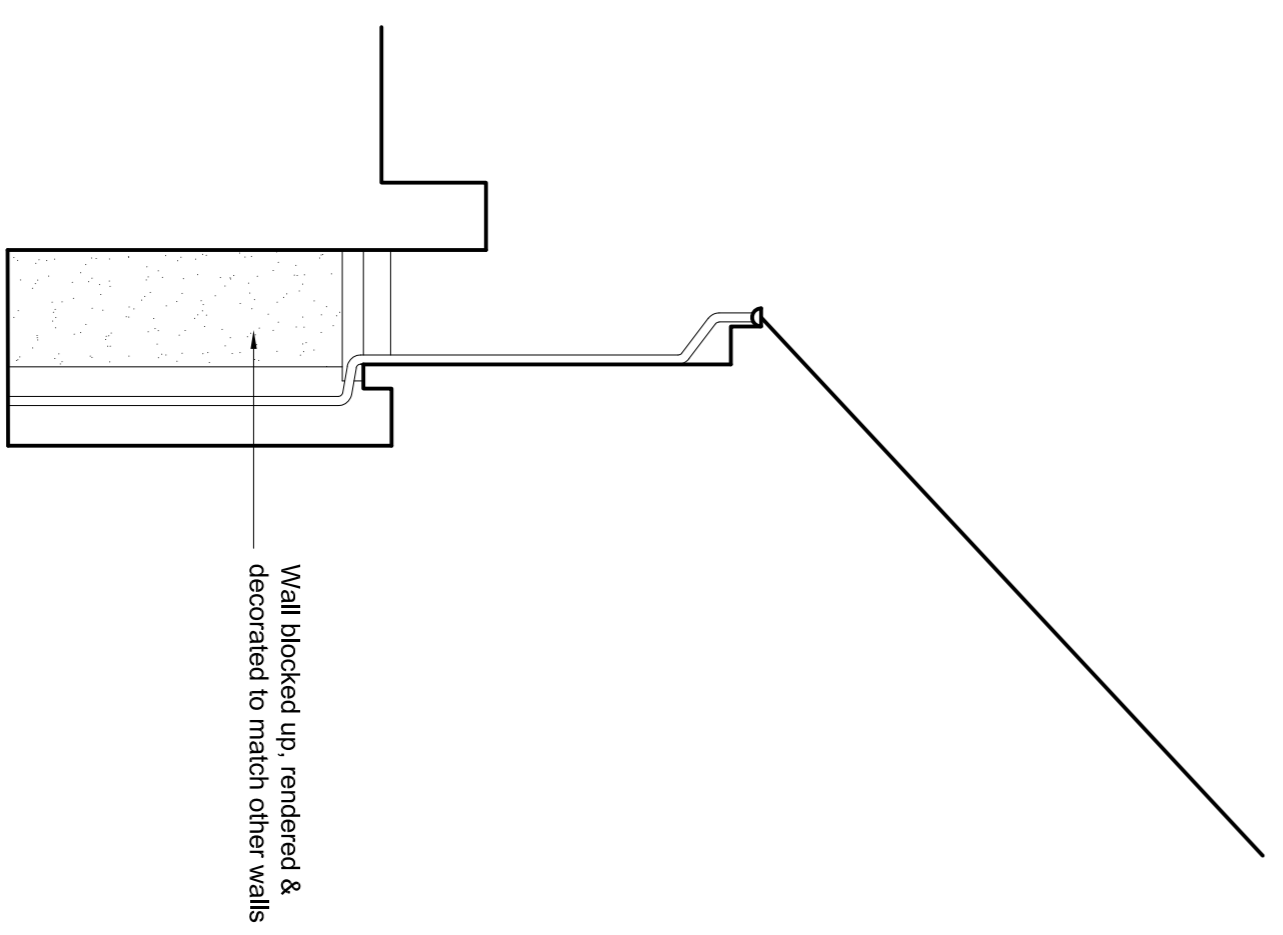

PART SOUTH ELEVATION - AS PROPOSED 1:50 @A1

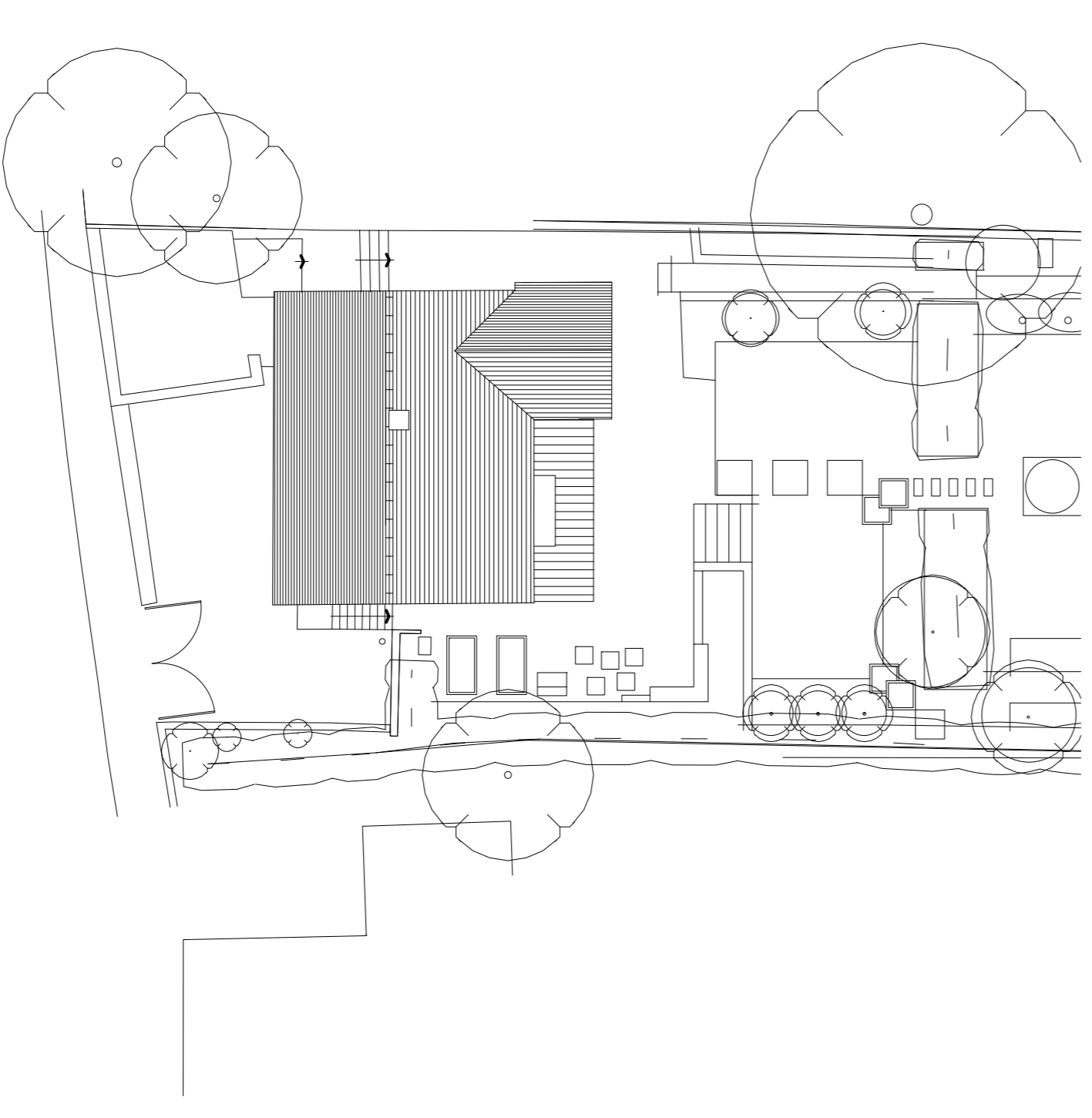
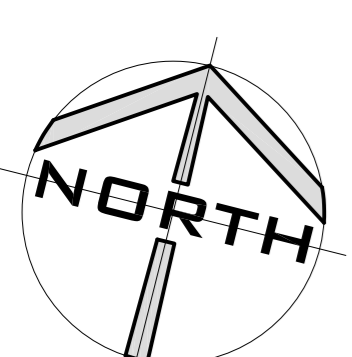
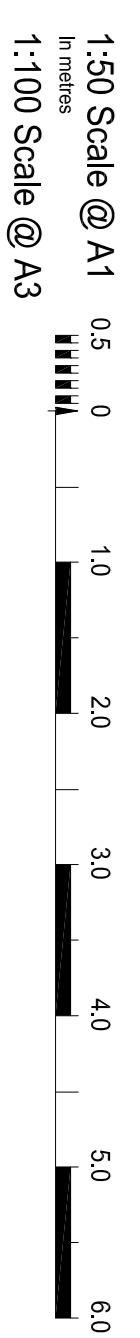

PROJECT Alterations and Extension to 11 Mill Lane, Ilfley Oxford OX4 4EJ		CLIENT Mr P & Mrs E Anderson	
ARCHITECT Pendery Architecture & Heritage Ltd 23 Orchard Road, Hook Norton, Banbury, Oxon, OX15 5JX d.pendery@pendery.com 07482 55757		TITLE West & Part South Elevation - As Proposed	
LAYER AS SHOWN	DATE Feb/21	SCALE AS SHOWN	NO. 2020/15