

1. This drawing has been prepared in accordance with the scope of RPS's appointment with its client and is subject to the terms and conditions of that appointment. RPS accepts no liability for any use of this document other than by its client and only for the purposes for which it was prepared and provided.
2. If received electronically it is the recipient's responsibility to print to correct scale. Only written dimensions should be used.
3. This drawing should be read in conjunction with all other relevant drawings and specifications.

10m SCALE 1:500

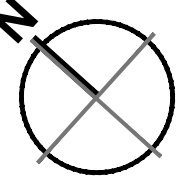

UTILITY KEY	
---	FLOOD DRAINAGE
---	CONTAMINATED SURFACE DRAINAGE
---	SURFACE DRAINAGE
---	COMBINED DRAINAGE

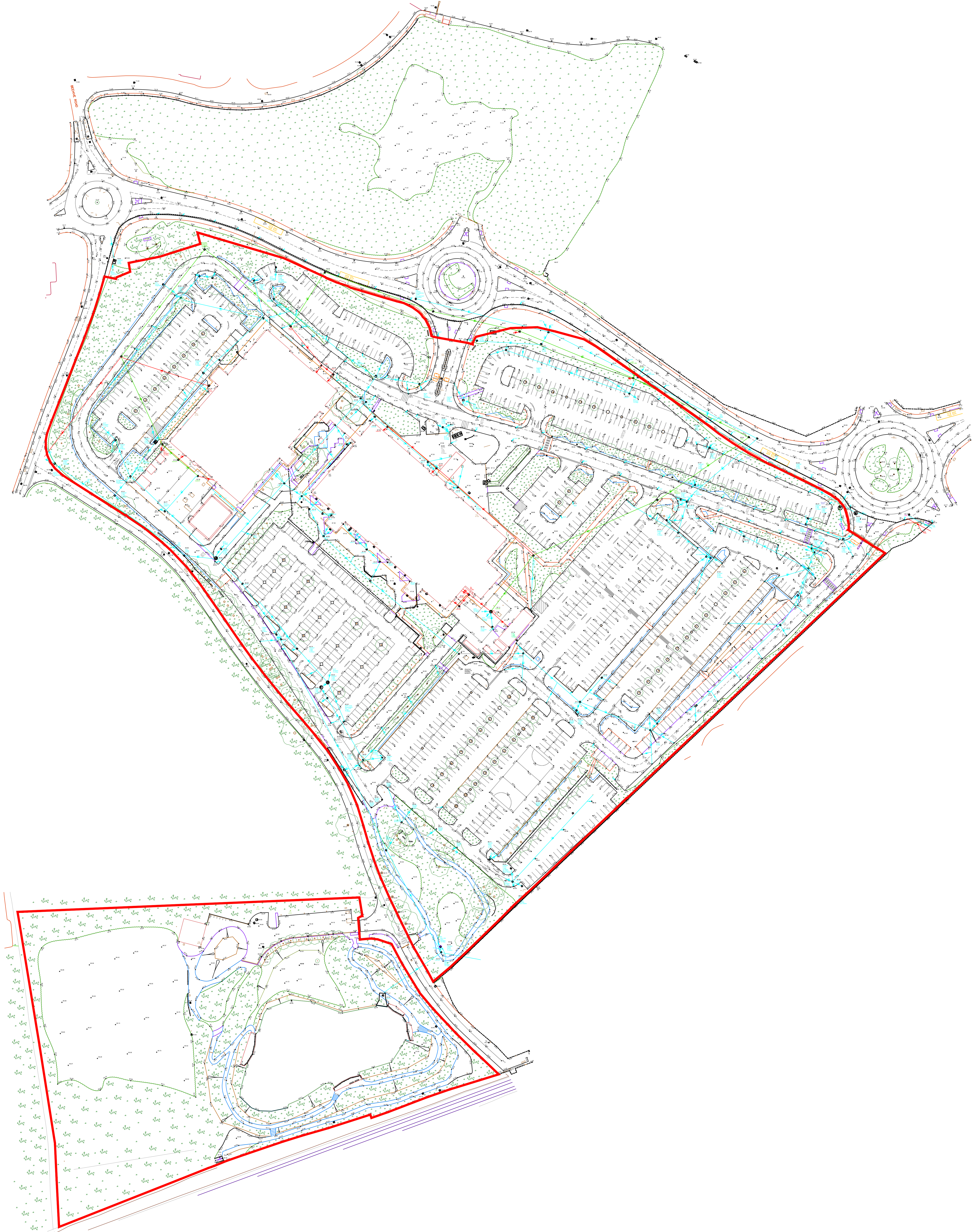

P01	Planning Issue	RB	JDC	17.02.21
Rev	Description	By	Oct	Date



Sherwood House, Sherwood Avenue,
Newark, Nottinghamshire, NG24 1QQ
T: 01636 655 700 E: rpsnewark@rpsgroup.com

Client

Project Bracknell Data Centre

Title Existing Drainage & Levels

RPS Project Number	Scale @ A0	Date Created
NK02035B	1:750	17.02.2021
Task Team Manager	Information Author	Task Information Manager
MRH	MH	JDC

Status

S1 (Suitable for Information)

Document Number	Revision
20305B-RPS-00-XX-DR-C-9610	P01

Project Code - Originator - Zone - Level - Type - Role - Drawing Number

rpsgroup.com