

3 Burrows Cross House
Application for discharge of Planning Conditions

Planning approval: 20/P/01801

Date of Decision: 21/12/20

Proposal: Proposed erection of a single storey rear extension comprising an entrance hall with covered porch and roof light.

Location: 3 Burrows Cross House, Burrows Cross, Shere, Guildford GU5 9QF

For: Mr and Mrs Matthews

Condition 3 -The proposed external facing and roofing material.

- Bricks: To match existing bay, handmade red bricks, Charwood 'Henly mix' Imperial sized, laid in English Bond with snapped headers. (see photo 1).
- Garden wall elevation: reclaimed bricks to best match existing to boundary wall (photo 2)
- Sandstone coping stone at the junction between the timber upper section and brick dwarf walls. This is to match both the original main entrance and No 4 porch details. (See photo 3 & 4).
- Oak Posts: Vertical oak posts, to match No 4 porch details (see photo 4).
- Roof: Cold rolled lead flat roof to match joined and matched to existing bay window roof. (see photo 5).
- Roof Skylight: Low profile non opening skylight. Frame powder coated dark grey. (See Picture)

Condition 4 – Proposed Joinery

- Architrave/cornice profile of eaves, windows (depth of reveal, method of opening, details of heads, cills and lintels): See drawing; 'Assorted Sketch Details of Bay & oriel Window. Joinery Details', as existing adjacent bay window, for full details, from kitchen extension drawings, dated 2009. Scale 1/5 FS.
- Window frame: Existing window to be altered and reused, therefore no new fenestration detail is being proposed. (see photo 6) Also drawing 'Glass @ Burrows Cross House'.
- Door and Frame: To be solid oak with oakframes.

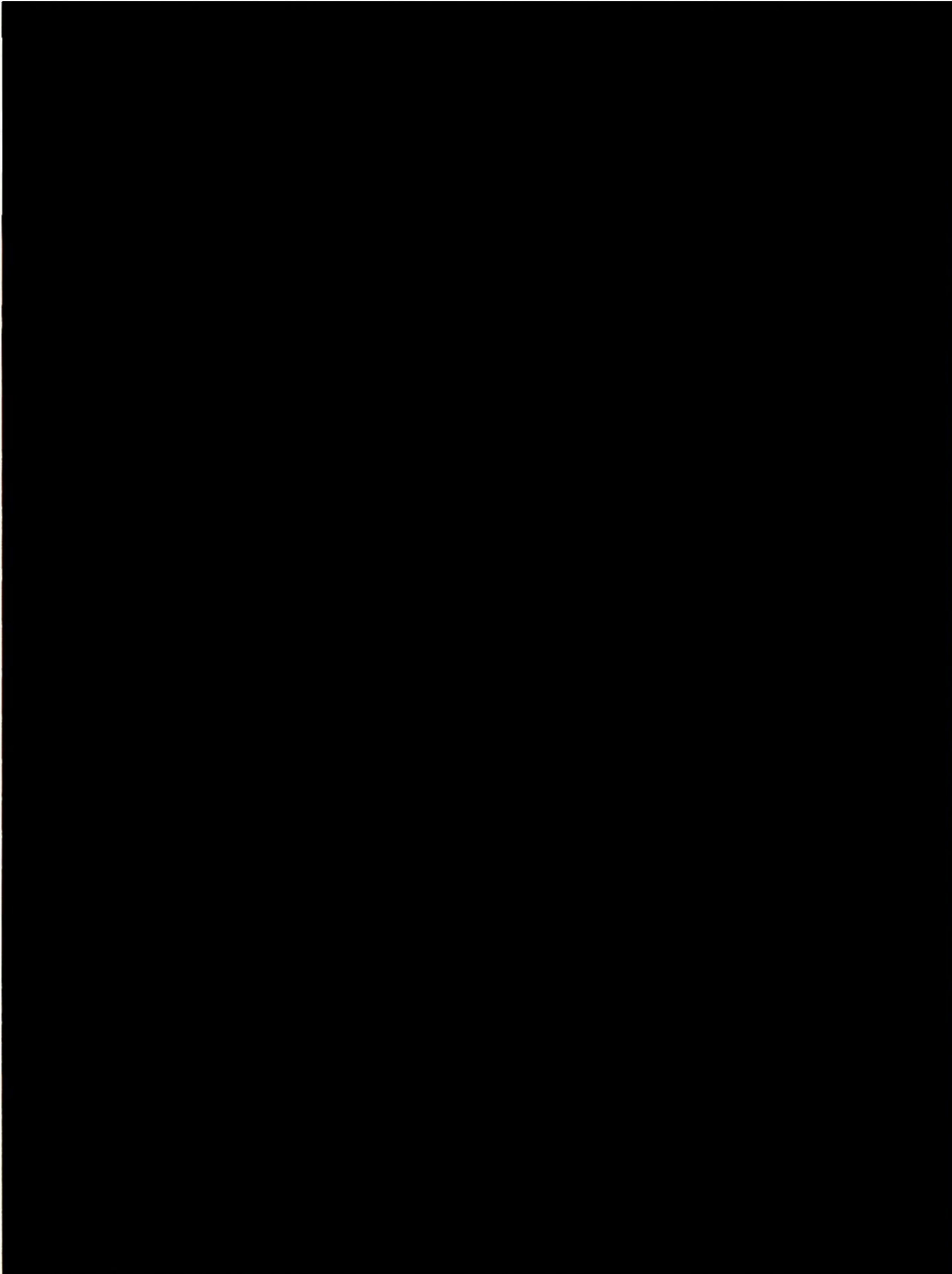

Photo 1 existing bay to show brickwork

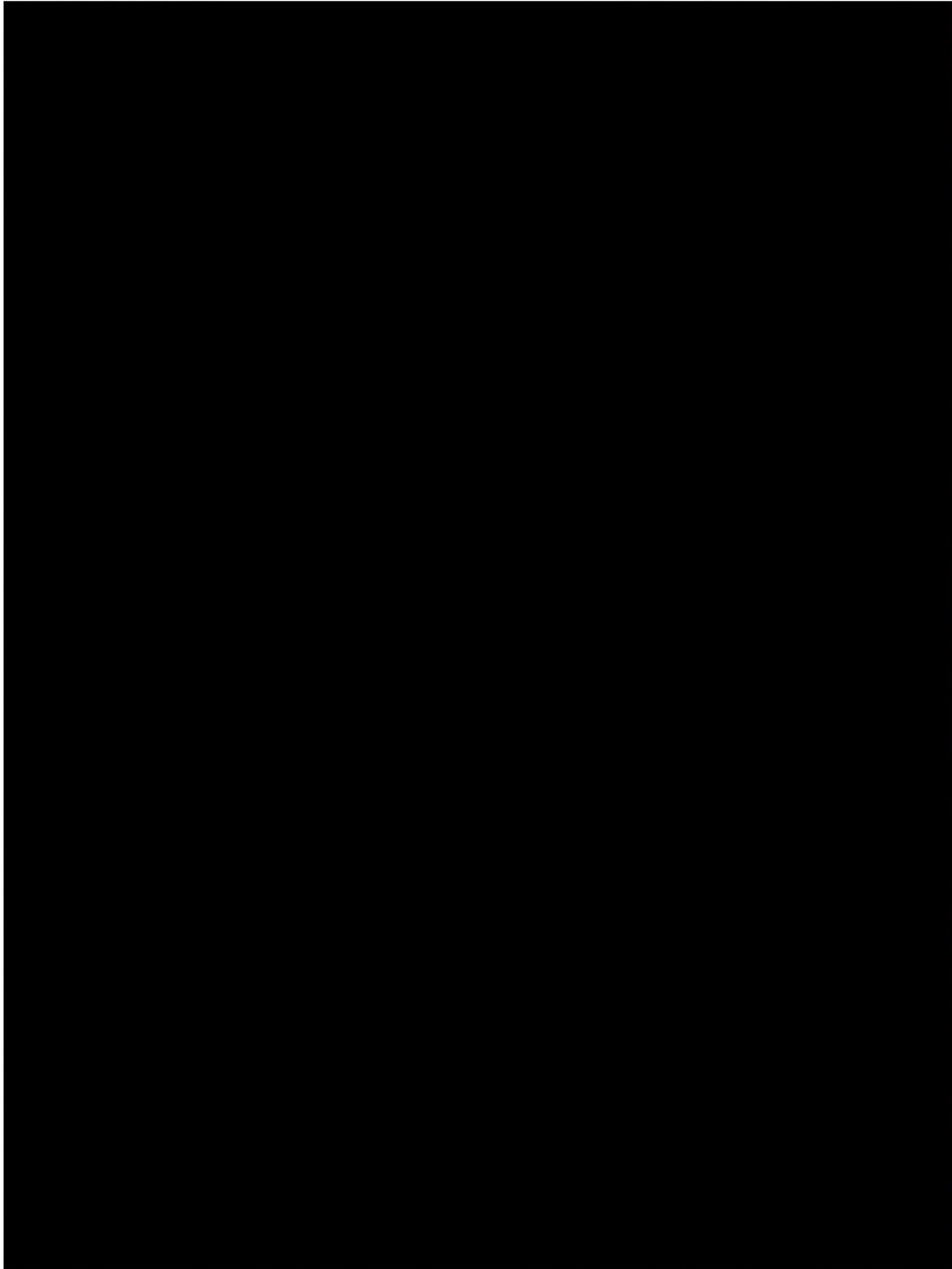

Photo 2 Garden wall to neighbours property

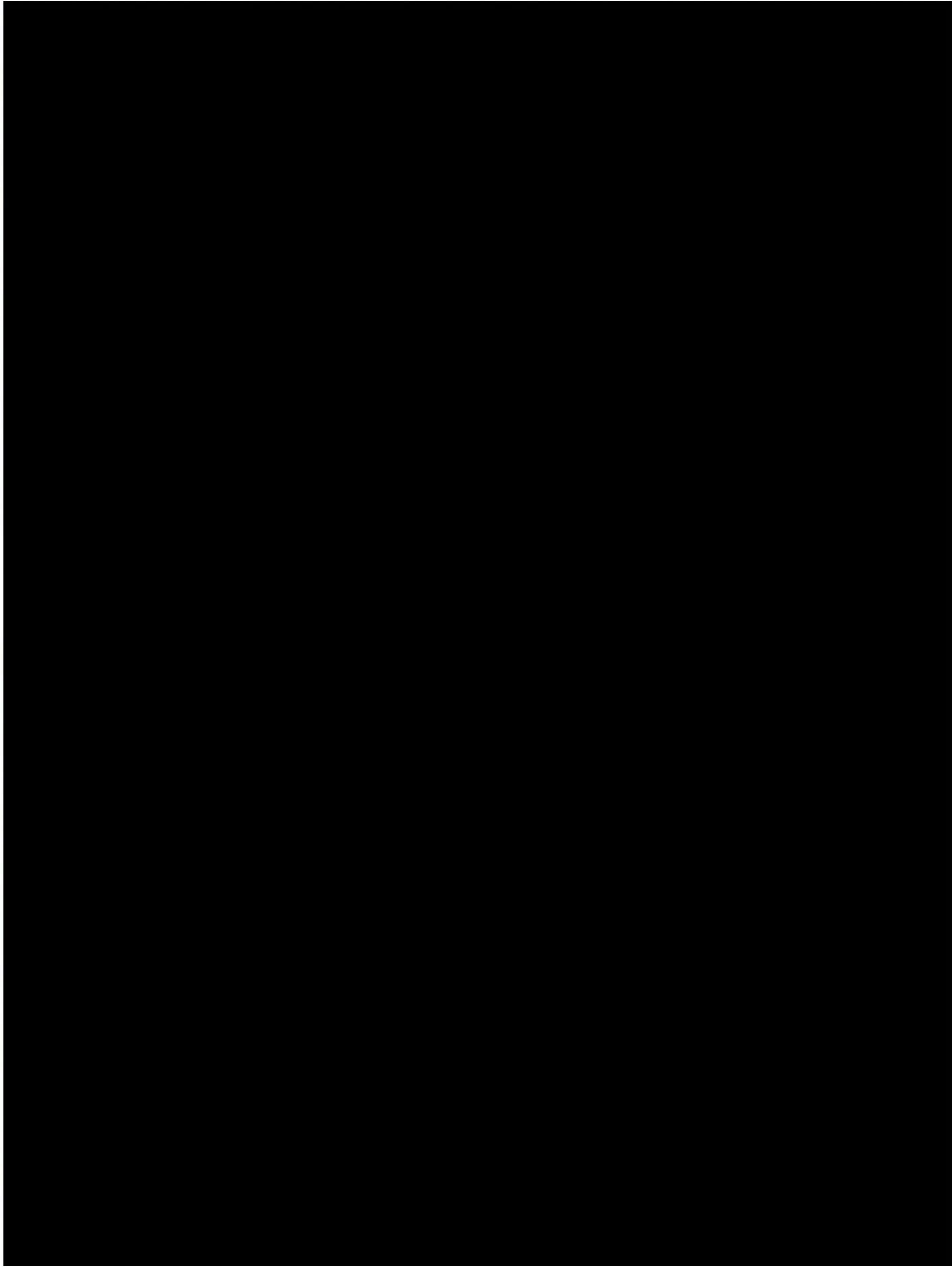

Photo 3 Original main entrance to house

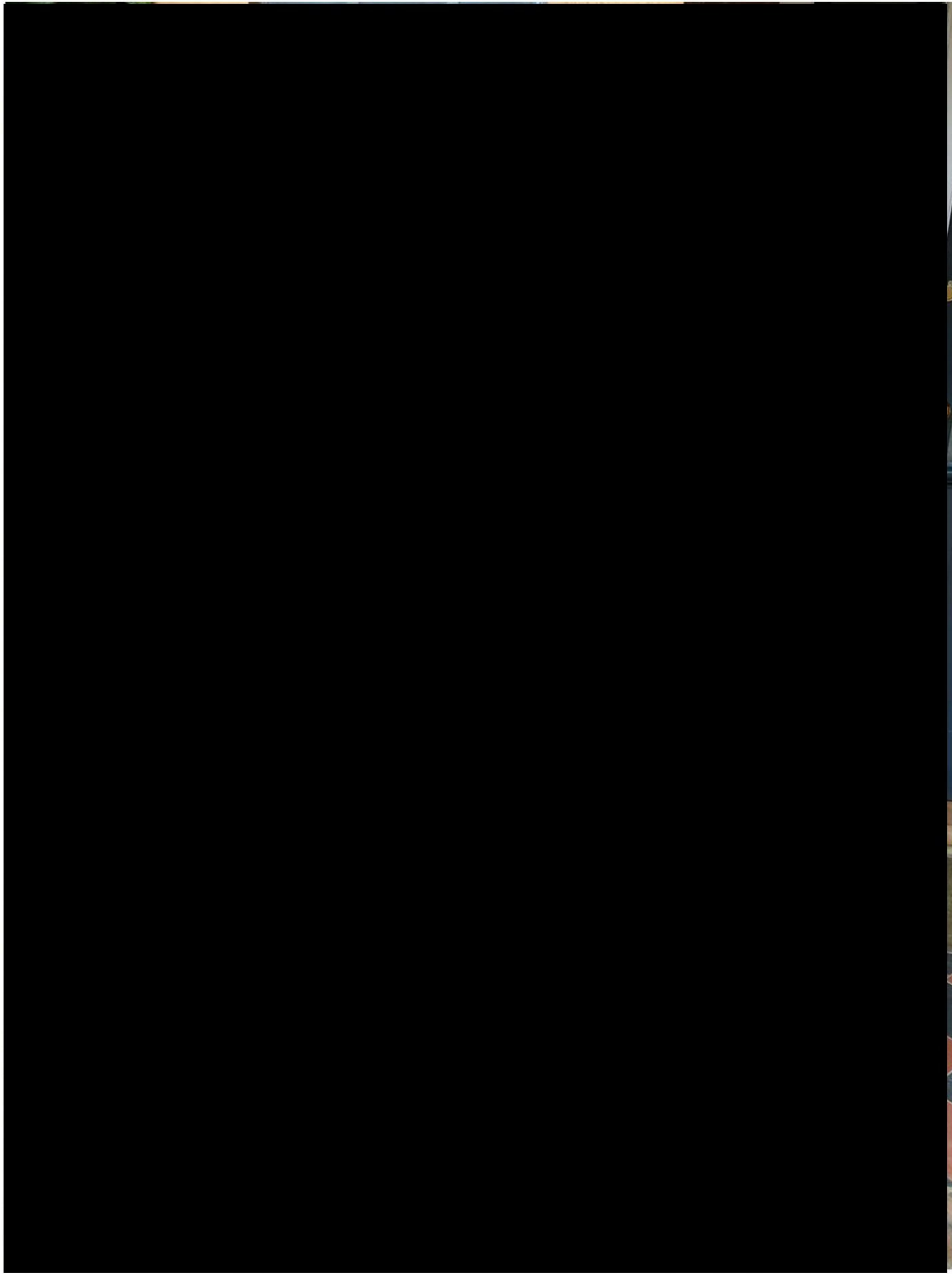

Photo 4 No 4 porch to show capstone detail

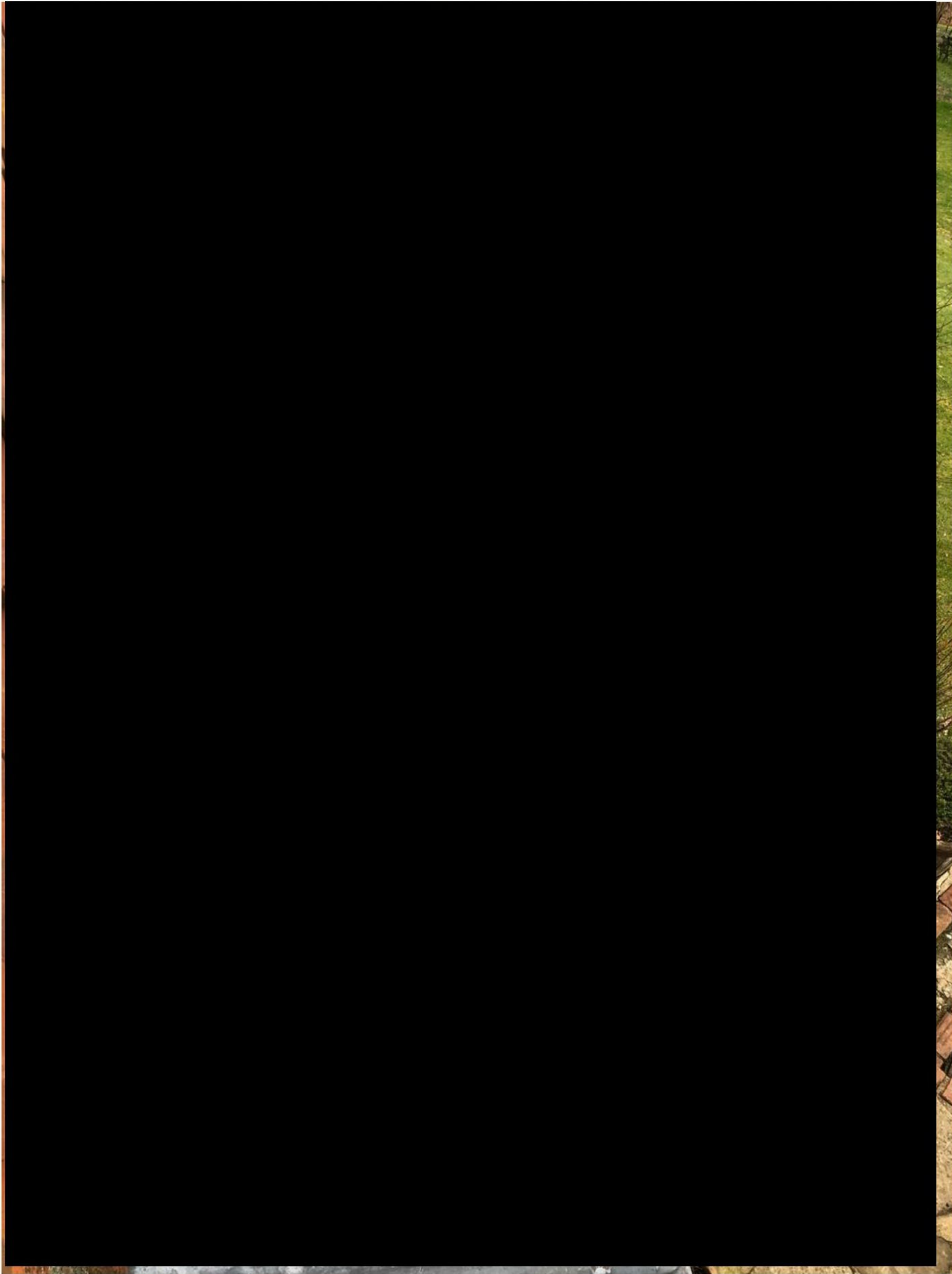

Photo 5 Existing lead roof to be extended over new porch

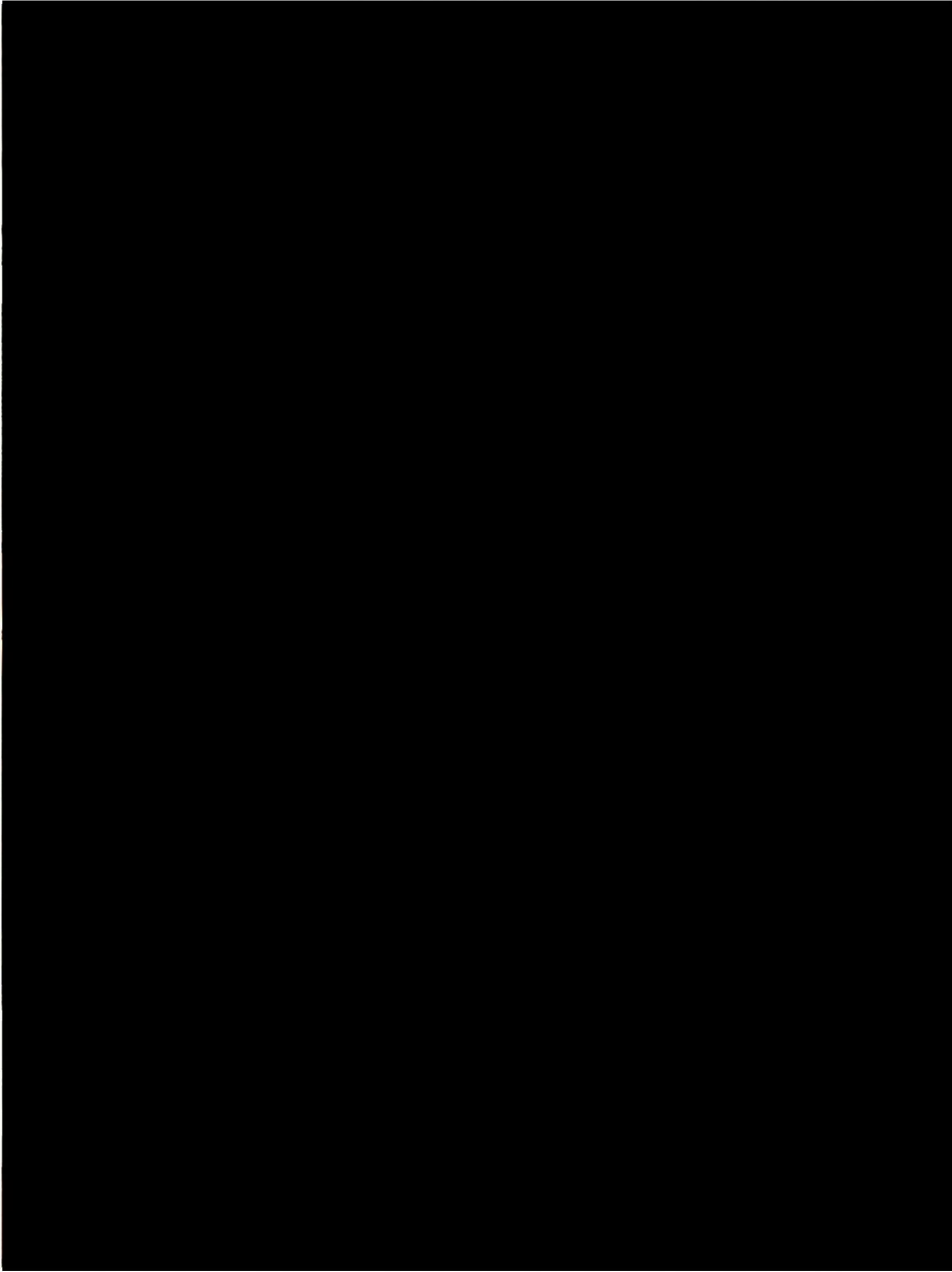
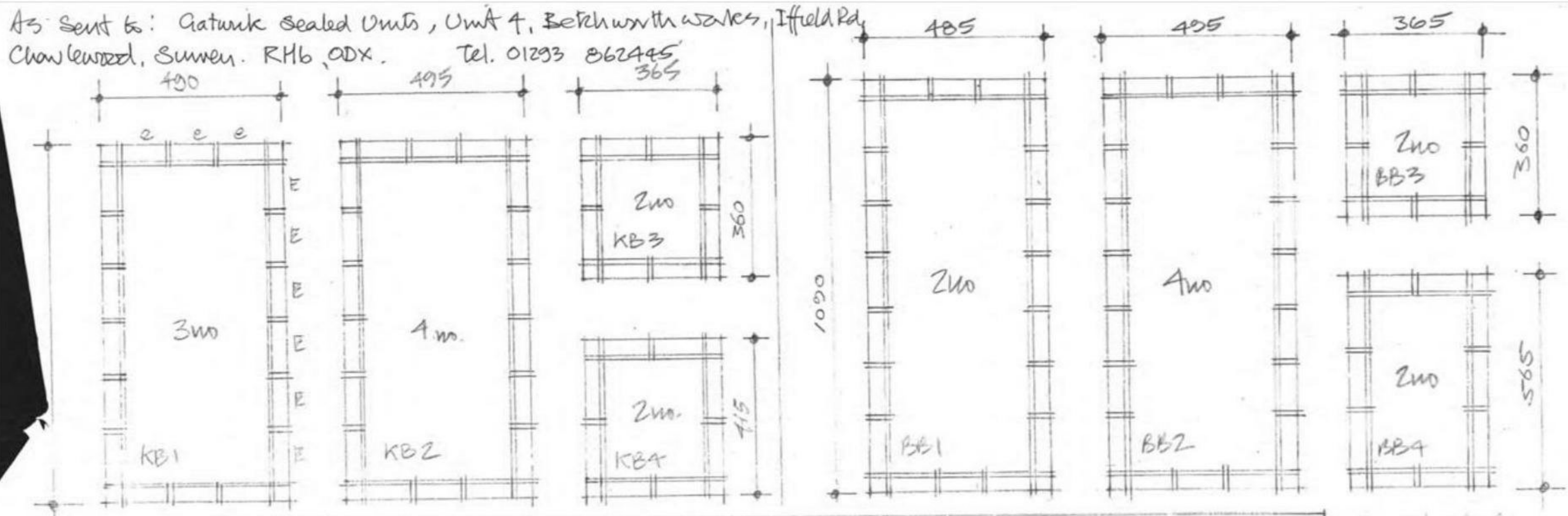
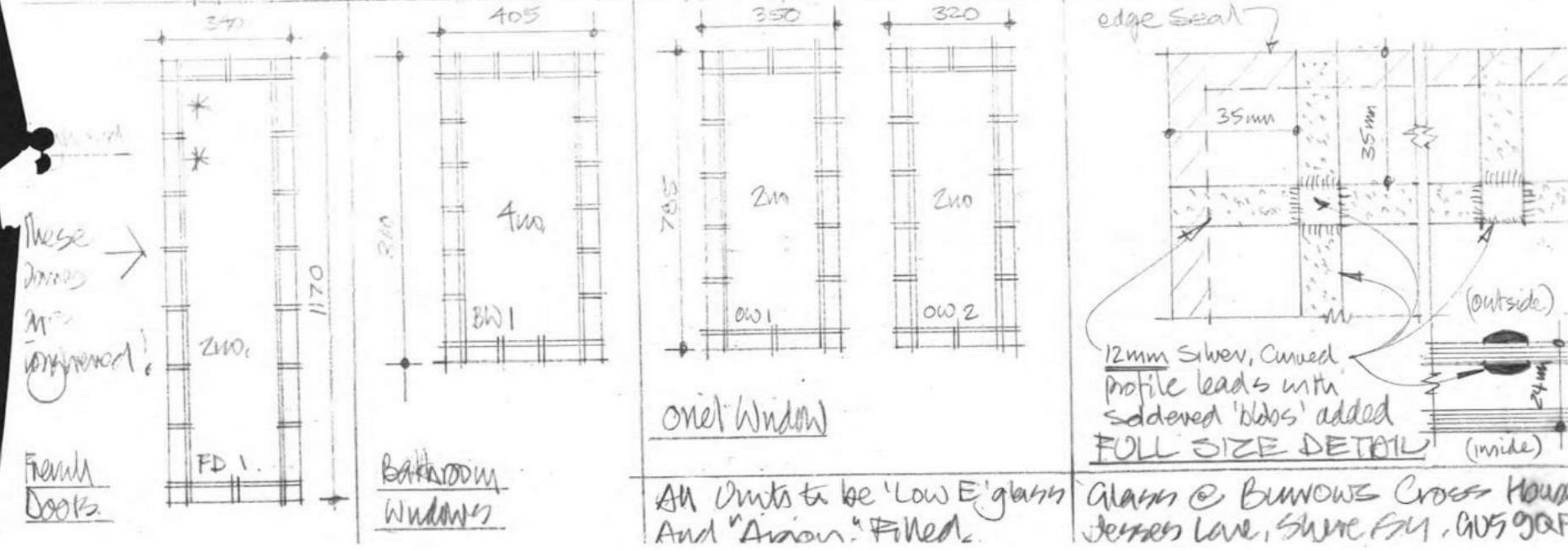

Photo 6 Existing window and frame to be reused in new position

As sent to: Gatumik sealed units, UWA 4, Betchworth Works, Iffield Rd, Chawleywood, Sumner. RH6, ODX. Tel. 01293 862445



Kitchen Bay. NB: DIMENSIONS SHOWN ARE ACTUAL UNIT SIZES. 5mm TOLERANCE ALREADY ALLOWED. Breakfast Bay.



Drawing 'Glass @ Burrows Cross House

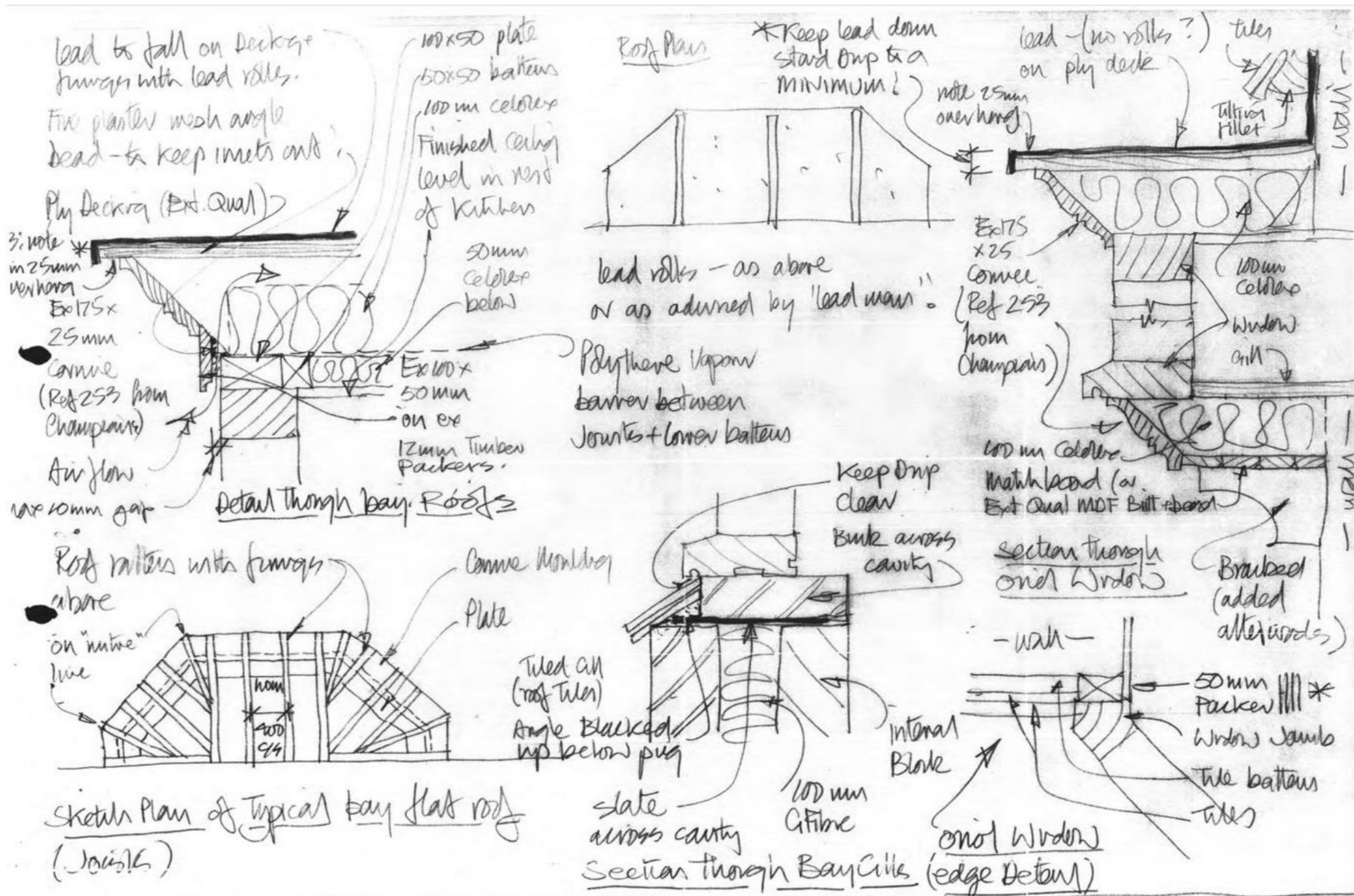

Drawing, Sketch detail of bay window.

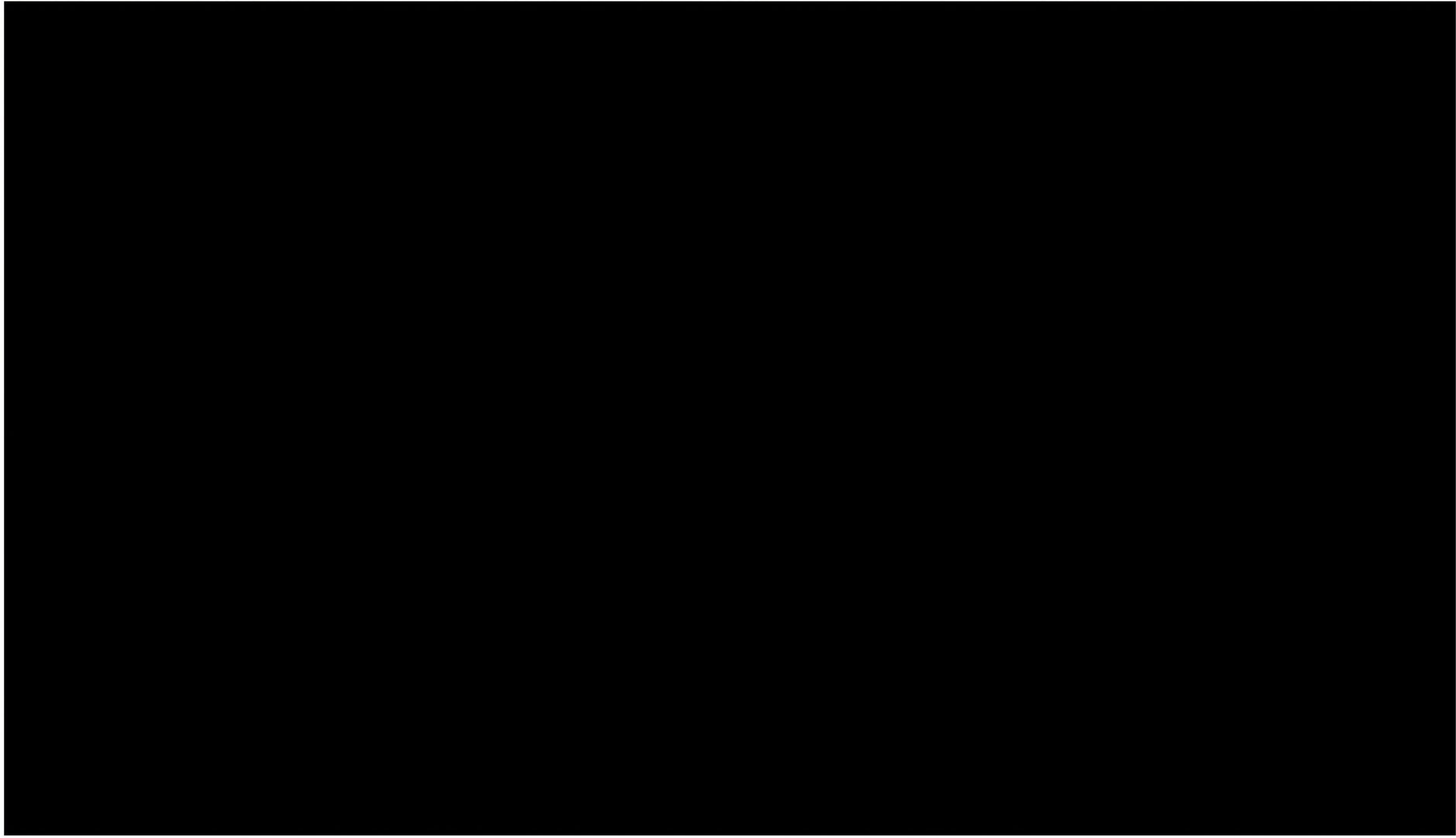

Proposed roof light, low profile non opening