

Species	Height	Girth	Pot Size	Specification	Density	Number
Prunus padus	175-200cm	8-10cm	bare-root	Feather :5 brks :2x	Counted	1No.
Sorbus aucuparia	250-300cm	8-10cm	bare-root	Standard :Clear Stem 175-200 :3 brks :2x	Counted	2No.
Sorbus glutinosa	175-200cm		bare-root	Feather :5 brks :2x	Counted	2No.
Sorbus aucuparia	175-200cm		bare-root	Feather :5 brks :2x	Counted	2No.
Betula pendula	175-200cm		bare-root	Feather :5 brks :2x	Counted	2No.
Betula pendula	250-300cm	8-10cm	Rootballed	Standard :Clear Stem 175-200 :6 brks :2x	Counted	2No.
Prunus avium	250-300cm	8-10cm	bare-root	Standard :Clear Stem 175-200 :3 brks :2x	Counted	2No.

Species	Height	Pot Size	Specification	Density	Number
Corylus avellana	40-60cm	200cc	Cell grown transplants	Counted	8No.
Rosa canina	40-60cm	200cc	Cell grown transplants	Counted	6No.
Salix aurita	40-60cm	200cc	Cell grown transplants	Counted	7No.

LANDSCAPE NOTES

All areas to be soft landscaped to be litter picked and all site debris / stones etc to be removed from site. All subsoil areas to be thoroughly de-compacted to ensure that they are free draining prior to placing topsoil for shrub planting, tree pits and hedging trenches.

Standard trees to be pit planted into pre-prepared tree pits 1000 x 1000 x 450mm deep with base of pits broken up for a further 75mm*. Bare-root and rootballed trees to have Rootgrow Mycorrhiza powder mixed into backfill mixture (70ml per pit) during planting. Pits backfilled with premium grade topsoil mixed with a 35mm deep layer of PAS 100 compost.

Standard trees to be single staked with 50mm machine rounded stakes driven vertically into tree pit and finished off 500mm above ground level. Stakes to be set to accommodate Holdfast HS40 spacer sleeves attached to Holdfast HW40 38mm heavy duty belting. Ties to be set 50mm below top of stake and nailed to stakes with galvanised nails.

Feathered trees to be pit planted into pre-prepared tree pits 750 x 750 x 450mm deep with base broken up for a further 75mm*. Bare root trees and transplants to be root-dipped with Rootgrow Mycorrhiza prior to planting.

Feathered trees to be single staked with a 50mm diameter machine rounded stake driven vertically into tree pit and finished 500mm above ground level. Trees to be secured with Holdfast HW25 belting nailed to stakes (50mm below top of stake) and a Holdfast HB2 rubber block.

All trees planted in grassed areas to be supplied with 'Arbortech- Strimmer guards' attached to base of trees (to protect from strimmer damage.)

All trees in grassed areas to have 1.2m diameter cleared earth circle formed around trees. Bark mulch cleared circle with 50mm depth of composted bark mulch.

Cell grown transplants to be pit planted into 200 x 200 x 200mm deep pits. Supply and spread a 35mm deep layer of PAS 100 soil improver over shrub pits and work into pit soil during planting. Cell grown shrub transplants to be protected with Tubex Mesh Tree Guards, 60cm high x 80-110mm diameter secured by 2no. ratchet ties attached to 25 x 25mm timber stakes driven into soil.

All trees planted in grassed areas to be supplied with 'Arbortech- Strimmer guards' attached to base of trees (to protect from strimmer damage.)

All trees in grassed areas to have 1.2m diameter cleared earth circle formed around trees. Bark mulch cleared circle with 50mm depth of composted bark mulch.

Cell grown shrub transplants to be protected with Tubex Mesh Tree Guards, 60cm high x 80-110mm diameter secured by 2no. ratchet ties attached to 25 x 25mm timber stakes driven into soil.

Any failures in planting within the first five years after planting to be replaced with plants of similar species / size (in the next following planting season).

Refer to Landscape Maintenance schedule for details of proposed maintenance regime for the first five years after planting.

- * Tree pits to be excavated out within the site capping layers to avoid any disturbance to the Warning Membrane and existing soils below. Where soil depths are in-sufficient request additional soil depths to be provided by the Main Contractor / Client.

SEEDING / TURFED AREAS

All subsoil areas to be thoroughly de-compacted to ensure that they are free draining prior to spreading of approved topsoil 150mm deep for mown grass areas.

All areas to be grass seeded to be litter picked and all site debris / stones over 50mm to be removed from site. Areas to be cultivated and any stones over 35mm removed. Supply and spread a pre-seeding fertiliser 6:9:6 mix @ 70g/m2 spread over topsoiled areas. Supply and sow grass seed in 2 pass technique using R M Welsh T7 Low fertility and Limited topsoil mix @ 50g/m2.

Suds basin slopes to be subsoiled, de-compacted and 150mm depth of topsoil spread over area. Suds basin slopes to be cultivated, stone picked and sown with a Scotia seeds 'Wet meadow Mix' (with no fertiliser application) @ 15g /m2.

Front gardens to have subsoil decompacted with excavator bucket prior to topping up of subsoil to give 300mm depth and then 150mm deep premium grade topsoil spread over areas. Supply and lay 'Scotlawn Silver Gracie' or equivalent quality turf to front gardens.

Rear gardens to have subsoil decompacted with excavator bucket prior to topping up of subsoil to give 300mm depth and then 150mm deep premium grade topsoil spread over areas. Rear gardens to be cultivated, stone picked and any stones over 35mm removed. Supply and spread a pre-seeding fertiliser 6:9:6 @ 70g/m2 over topsoiled areas. Supply and sow grass seed in a 2 pass technique using R M Welsh T7 low fertility and Limited topsoil mix @ 50g/m2.

NOTES

Landscape proposals prepared to suit the McColm Engineer's drainage system. (3846.JKM-005 Rev G)

Refer to Landscape Maintenance Schedule for details of proposed maintenance works to be undertaken for the first five years after planting.

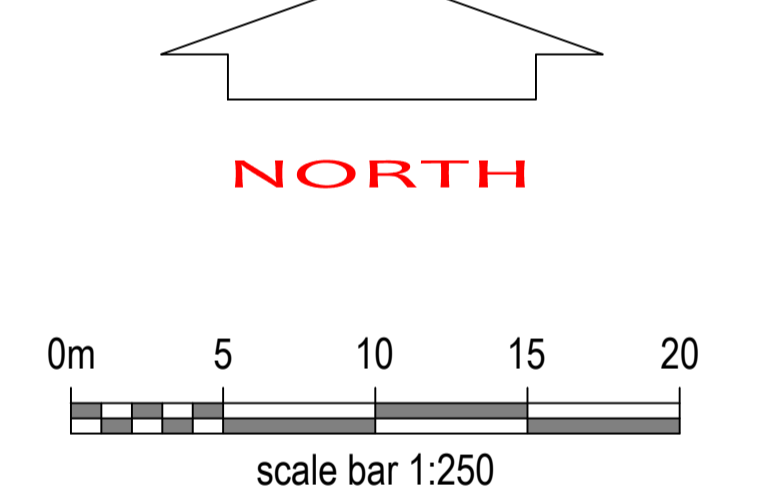

REVISIONS

A:	18.03.21 Landscape proposals revised to Client's requirements. KW
B:	22.03.21 Landscape proposals revised to Client's comments. KW
C:	22.03.21 Landscape proposals updated with plant names, numbers and a planting schedule. Landscape maintenance schedule prepared for planning issue. KW

KEITH L WOOD LANDSCAPE DESIGN

1, Old Branziet Cottage, Balmore, By Torrance, Glasgow, G64 4AH.
Tel: 01360 620358 Mob: 07584 054586
email: keith.l.wood@btopenworld.com
www.keithwoodlandscapedesign.scot

Project Title: RESIDENTIAL DEVELOPMENT AT 1 RECREATION ROAD, CUMNOCK, KA18 1SH

CLIENT: GLENCAIRN ESTATES LTD

DRAWING TITLE: LANDSCAPE PROPOSALS

PLANNING

Scale	1:250@ A1	Date	12.03.21
Drawn	k wood	Approved	
Drawing No.	GERR SL-01	Rev.	C

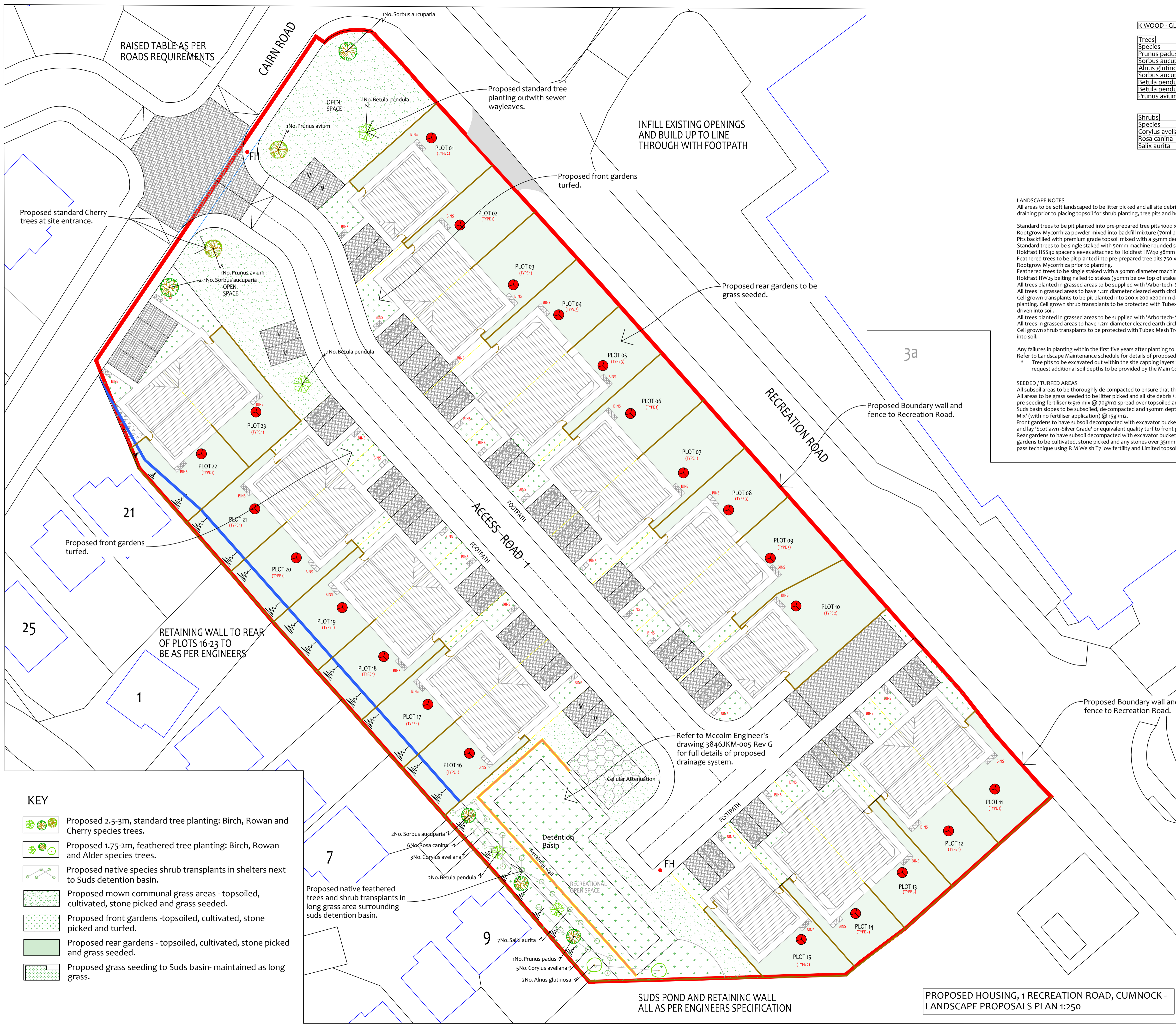

KEY

	Proposed 2.5-3m, standard tree planting: Birch, Rowan and Cherry species trees.
	Proposed 1.75-2m, feathered tree planting: Birch, Rowan and Alder species trees.
	Proposed native species shrub transplants in shelters next to Suds detention basin.
	Proposed mown communal grass areas - topsoiled, cultivated, stone picked and grass seeded.
	Proposed front gardens -topsoiled, cultivated, stone picked and turfed.
	Proposed rear gardens - topsoiled, cultivated, stone picked and grass seeded.
	Proposed grass seeding to Suds basin- maintained as long grass.

SUDS POND AND RETAINING WALL ALL AS PER ENGINEERS SPECIFICATION

PROPOSED HOUSING, 1 RECREATION ROAD, CUMNOCK - LANDSCAPE PROPOSALS PLAN 1:250