

**robertson design practice,**  
 st. vincent's lodge, middlepenny road, langbank.  
 tel. 01475 540554  
 e-mail robertsondesign@hotmail.com

client: Mr. + Mrs. A. McCready  
 project: Proposed domestic store/garage, North Denniston, Bridge of Weir Road, Kilmacollm.  
 title: Location plan.  
 job no. 1818 dfg. no. 10 scale: 1:12500/1250 drawn: PKR date: 25/03/21

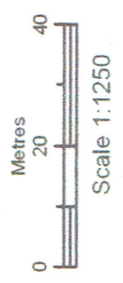
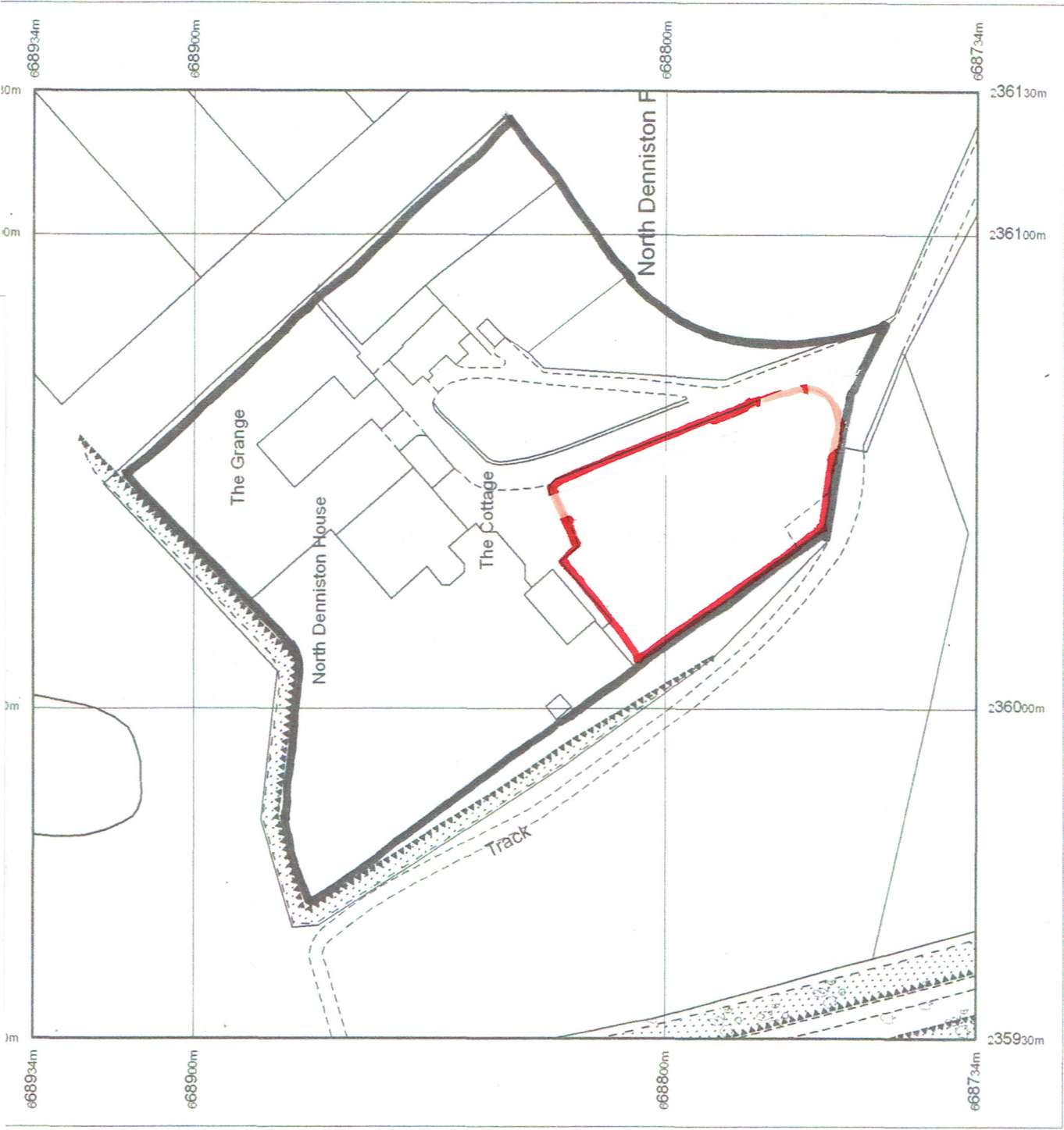

Supplied by: [www.ukmapcentre.com](http://www.ukmapcentre.com)  
 Serial number: 02424100  
 Centre coordinates: 236030.5 668834  
 Further information can be found on the  
 OS Sitemap Information leaflet or the  
 Ordnance Survey web site:  
[www.ordnancesurvey.co.uk](http://www.ordnancesurvey.co.uk)

Produced 27.04.2011 from the Ordnance Survey National Geographic Database and incorporating surveyed revision available at this date. © Crown Copyright 2011.  
 Reproduction in whole or part is prohibited without the prior permission of Ordnance Survey.  
 Ordnance Survey, the OS Symbol and OS Sitemap are registered trademarks of Ordnance Survey, the national mapping agency of Great Britain.  
 The representation of a road, track or path is no evidence of a right of way.  
 The representation of features as lines is no evidence of a property boundary.  
 Part or all of this OS Sitemap is enlarged from mapping produced at one or more of the following scales: 1:1250, 1:2500, 1:10000.

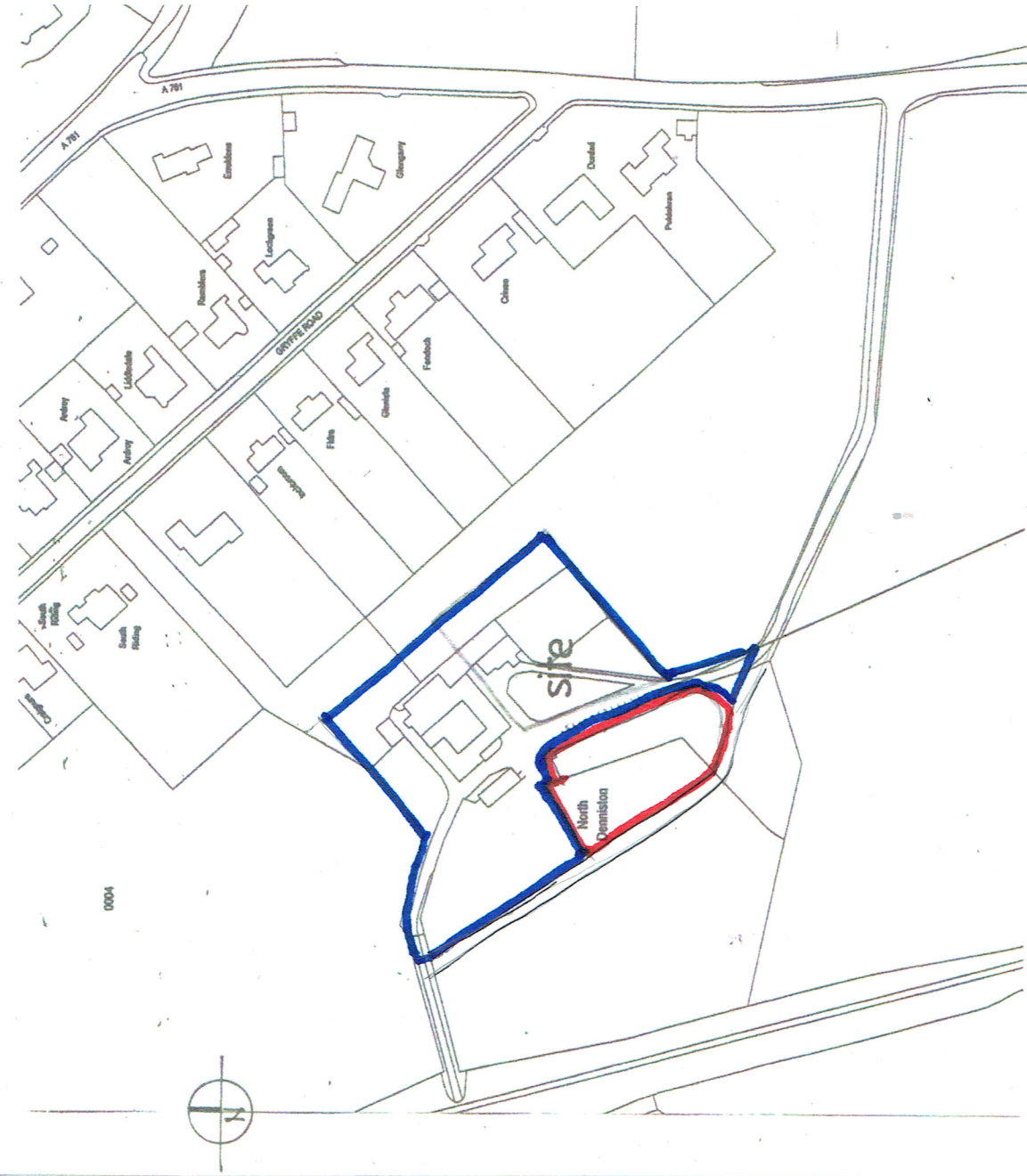

Location plan 1:2500

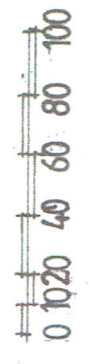

O.S. COPYRIGHT  
 LICENCE:  
 LATITUDE SOUTHAMPTON  
 REF 01513208