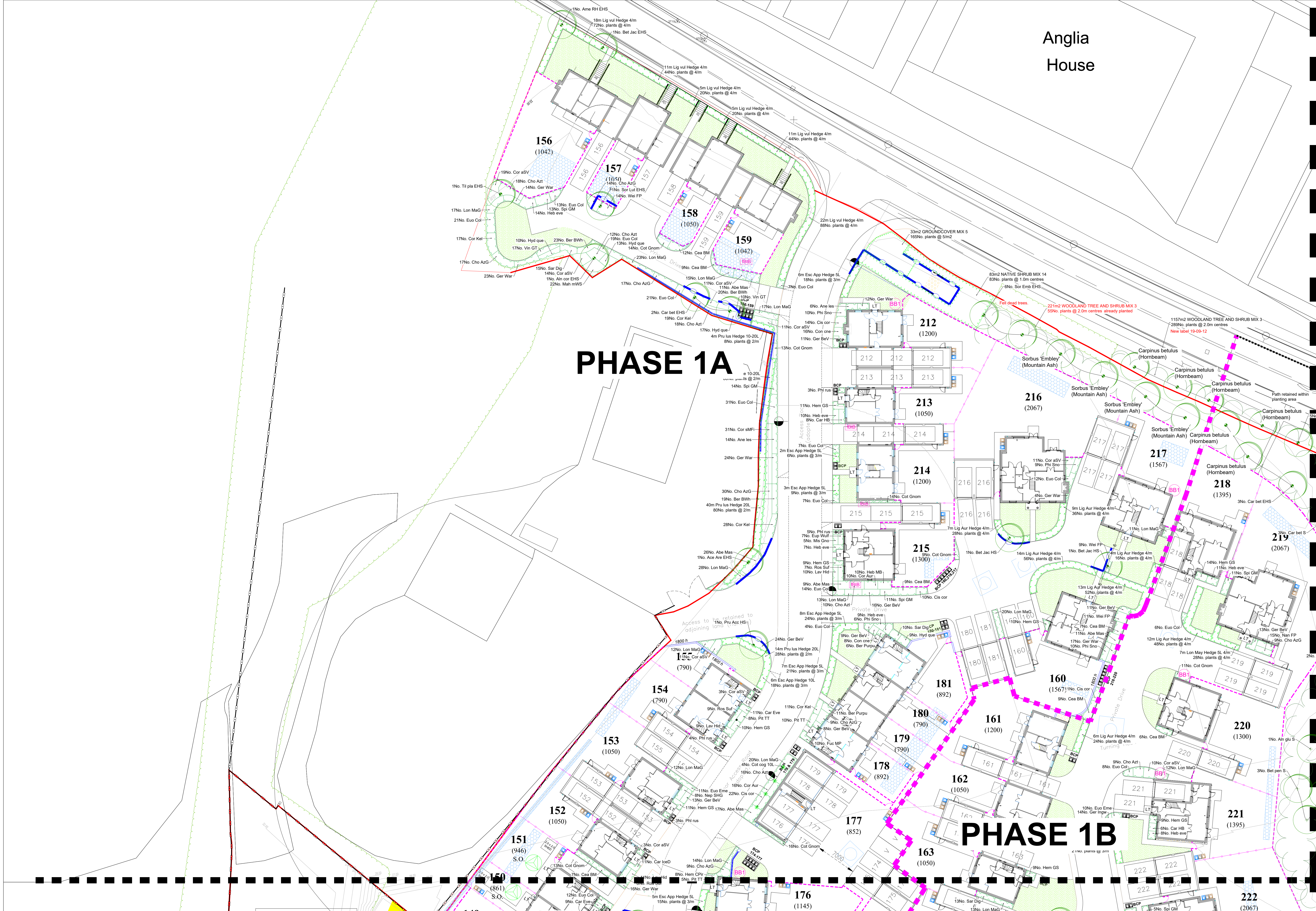

Anglia
House

[illegible]

EXTRACT FROM LANDSCAPE SPECIFICATION REPORT

VALIDATION

The Landscape Architect may inspect the works, without notice, at any point during the project to ensure all soiling and planting specifications are complied with, to the required standards. Any works found to be substandard or at odds to the specification shall be made good, and/or replaced by the contractor at his own expense, unless proof of Landscape Architect substitution or variation approval can be provided.

refer to ELD drgs HOPK 428/16 - 001 for Key Plan and 002 to 008 Concept Layouts, ELD Drgs 010 to 017 for Detailed Landscape Proposals, ELD Drg 009 for the Drainage Overlay Layout, Drg 018 Schedules & Drg 020 for Management Areas. Also refer to the ELD Specification report for planting and maintenance requirements and Landscape Management Plan.

B. These landscape proposals have been cross referenced against DRAINAGE locations only. All other services and utilities to be checked to identify any potential conflicts. Client/engineer to review and advise accordingly.

ALL DIMENSIONS TO BE CHECKED ON SITE. TO BE READ WITH ALL CONTRACT DOCUMENTATION. ANY DISCREPANCIES TO BE REPORTED TO THE CONTRACT ADMINISTRATOR. DO NOT SCALE FROM THIS DRAWING.

Elwood Landscape Design 2021

24-08-18	LW	Minor amendments to accord with latest layout (External Works v11) received 10.08.18
16-01-18	RE	Boundary footpaths amended
12-01-18	LW	Amended to show 1.5m svis plays at the end of all hedges on public highways
18-12-17	LW	Amended to accord with client pdf comments re footpaths in POS and revised drainage and lighting layout 29.11.17
21-11-17	LW	Amended to accord with drainage and lighting layout, received 17.11.17
27-09-17	LW	1No. reptile hibernacula added to eastern POS. 1No. bird box added to pidge on plot. All as per ecologist recommendations, received 26.09.17
15-09-17	LW/RE	Set up for DLP. Amended to new Layout HH v5. Drg numbers re-ordered.
	Date	Initials Details

E·L·D
ELWOOD LANDSCAPE DESIGN
CHARTERED LANDSCAPE ARCHITECTS

Suffolk Office:
The Barn, Cherry Tree Farm, Mendlesham
Green, Stowmarket, Suffolk IP14 5RQ.
Tel: 01449 768828 E: team@e-i-d.co.uk

Cambridgeshire Office:
The Nursery, Market Street, Fordham,
Cambridgeshire, CB7 5LQ.
Tel: 01638 721066 E: team@e-i-d.co.uk

IENT: OPKINS HOMES.	PROJECT: IPSWICH ROAD, NEEDHAM MARKET.
------------------------	--

FIG TITLE:
DETAILED LANDSCAPE PROPOSALS (1 OF 9). PHASE 1A

250 @ A0		23RD MARCH 2017.	
DRAWN BY: U	CHECKED BY: DE	DRAWING NO: H00K 428/16 010	REV. D

[illegible]

83n2 NATIVE SHRUB MIX 14 planted @ 1.0m centres

10%	8No.	Cornus sanguinea
20%	17No.	Cornus sibirica
15%	12No.	Corylus avellana
10%	8No.	Eucymnus europaeus
5%	4No.	Ilex aquifolium
15%	12No.	Viburnum opulus
10%	8No.	Viburnum lantana
15%	12No.	Ribes sanguineum

Individual varieties to be planted in groups of approximately 15-35.

NOTES AND ABBREVIATIONS:

C = Container (or pot) grown, followed by size of the container (or pot)

EHS = Extra Heavy Standard 14-16cm girth

FORM = Shape of tree as supplied by the nursery

HABIT = Juvenile habit or plant shape as supplied by the nursery

HS = Heavy Standard 12-14cm girth

QTY = Quantity

S = Standard 8-10cm girth

SIZE = Height or Spread of juvenile plant

SM = Semi-Mature 16-18cm girth plus

Std = (clear stem) Standard.

STOCK = Root condition/protection method eg Bare root

- Refer to specification for further information

- All plants to be completely hardened off

- Substitutions to be agreed with Landscape Architect

Plant Schedule generated by "Oscapex" software 12/09/2019

SCHEDULE OF QUANTITIES: PHASE 1A

SOFT LANDSCAPE TO GENERAL AREAS:

95042	3mg. Clover St.
31742	Grass-Turf
31742	Emergate ELL, 'Flowering Laan' mix
1382	Planting-Crosscover mixes
7298	Planting-edges
15542	Planting-sensitive mixes
61742	Planting-shrubs and herbaceous
11542	Planting-woodland
4042	Shrub - Specimen SL
2262	Tree - ERS
1762	Tree - HS
1762	Tree - S
3862	Tree - SH

HARD LANDSCAPE TO GENERAL AREAS:

7962	BREEM - Est Box - PLAT
13462	BREEM - Bif Box - PLAT
13462	BREEM - Invertebrate habitat
54	Gravel Timber
1462	Gravel over geotextile geombrane
1434	Tree root barrier 2m deep

P.	21-03-09.	I.W.	Details of planting, fencing and footpaths to all POS areas amended to client comments.
N.	26.01.21	I.W.	Phase 3 housing layout amended to accord with new layout (HH Ext Works v25), received 21.01.21.
M.	05-06-20	RE.	Bench types on drugKey corrected.
L.	13-10-19	RE.	Woodland added to highway edge B1113 - Ph1A schedules.
L.	21-02-19	RE.	Ilgent drainage imported to HH v15, rec 19-01-07.
J.	04-12-18	I.W.	Minor amends to accord with latest layout (External Works v14), received 29-11-18. LEAP safety mauls to replace matting.
H.	15-11-18	I.W.	Minor amends to accord with latest layout (External Works v14), received 25-10-18. Latest Drainage/lighting drawing added, received 14.11.18.
G.	13-10-18	RE.	Minor amends to accord with latest layout (External Works v13), received 13-10-18. Planting removed from bank plots 222-239. Pond section added.

ALL DIMENSIONS TO BE CHECKED ON SITE. TO BE READ WITH ALL CONTRACT DOCUMENTS TO AVOID ANY DISCREPANCIES TO BE REPORTED TO THE CONTRACT ADMINISTRATOR. DO NOT SCALE FOR THIS DRAWING.			
© Elwood Landscape Design 2021			
F.	24-08-18 L.W.	Minor amends to check with latest layout (External Works v11), received 10.08.18.	
E.	16-01-18 RE.	Boundary footpaths amended.	
D.	12-01-18 L.W.	Amended to show 1.5m vs plays at the end of all hedges on public highways.	
C.	18-12-17 L.W.	Amended to check with client pdf comments re footpaths in POS and revised drainage and lighting layout 29.11.17.	
B.	21-11-17 L.W.	Amended to check with drainage and lighting layout, received 17.11.17.	
A.	27-09-17 L.W.	1No. reptile hibernacula added to eastern POS. 1No. bird box added to edge to pond. All as per ecological recommendations, received 26.09.17.	
15-09-17 L.W/RE.		Set up for P/L. Amended to new Layout HH v5. Draw numbers re-ordered.	
Rev:	Date:	Initials:	Details:

E · L · D

ELWOOD LANDSCAPE DESIGN

CHARTERED LANDSCAPE ARCHITECTS

Suffolk Office:
 The Barn, Cherry Tree Farm, Mendlesham
 Oron, Stowmarket, Suffolk, IP14 5RD
 Tel: 01438 768838 E: team@el-d.co.uk

Cambridgeshire Office:
 The Nursery, Market Street, Fildisham,
 Cambridgeshire, CB2 5LQ
 Tel: 01438 721066 E: team@el-d.co.uk

☒ **CLIENT:**
HOPKINS HOMES.

☐ **ISSUED BY:**
PROJECT:
IPSWICH MARCH, NEEDHAM
MARKET.

DWG TITLE:
DETAILED LANDSCAPE PROPOSALS (0 of 9), PHASE 1A

SCALE:
1:250 @ A0

DRAWN BY:
UW

DATE:
23RD MARCH 2017.

DRAWING NO:
010

REV:
0