

1:100

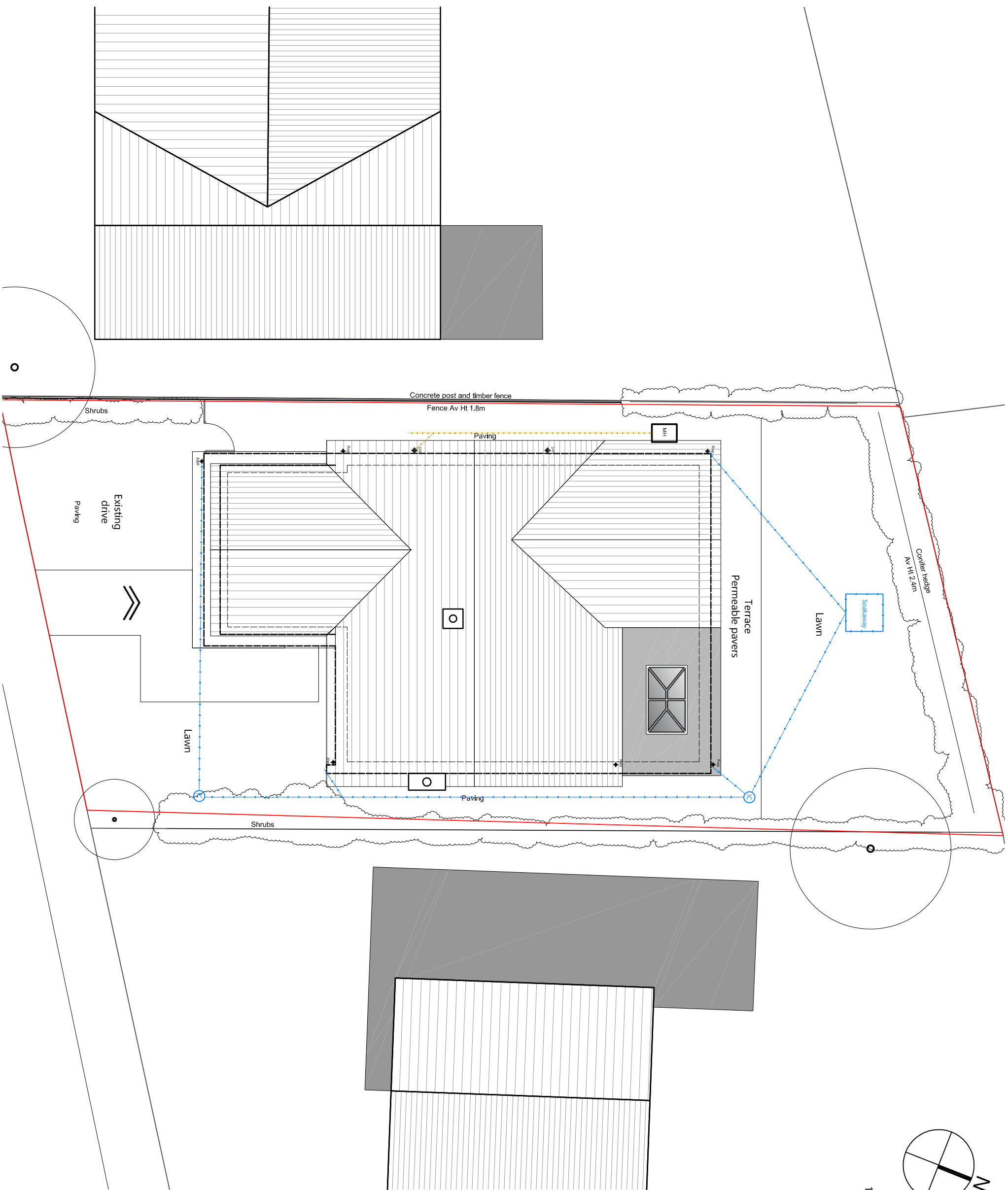

**Notes:**  
 The contractor is responsible for checking dimensions, any discrepancies to be determined by the architect before proceeding with the works.  
 No dimensions to be scaled from drawing, figured dimensions to be worked to in all cases.  
 All materials used and work undertaken to be in accordance with relevant British Standards, Codes of Practice and the Building Regulations with subsequent amendments.  
 The contents of this drawing are the property of Mike Firing Chartered Architects and must not be reproduced without their expressed written consent.

Key	
	Existing wall construction
	Proposed wall construction
	Existing wall removed
	Boundary line
	New structure to structural engineer's details
	Surface water drainage
	Foul water drainage
	Existing tree to be rained
(All boundary treatment to remain as existing)	



<b>Revision/Note</b>	<b>Date</b>
<b>Project:</b> 3 Sandyridge, Nether Poppleton, YO26 6LU	
<b>Title:</b> Proposed Site Plan	
<b>Client:</b> Mr Dan and Mrs Lucy Balnes	
<b>Scale:</b> 1:100 @ A3	<b>Date:</b> March 2021
<b>Drawn By:</b> AAN	<b>Drawing Number:</b> 1031.P105
	<b>Revision:</b>



**Firing Associates**  
 Chartered Architects  
 'Spanning The Breath Of Architecture'  
 1 EVANS BUSINESS CENTRE  
 ROSE AVENUE  
 NETHER POPPLETON  
 YORK  
 YO26 6NR  
 T: 01904 788098  
 E: mike@firingarchitects.co.uk  
 www.firingarchitects.co.uk