



BLOCK PLAN - EXISTING  
3 ARNHILL ROAD GRETTON



(489719, 294177)

(489813, 294177)

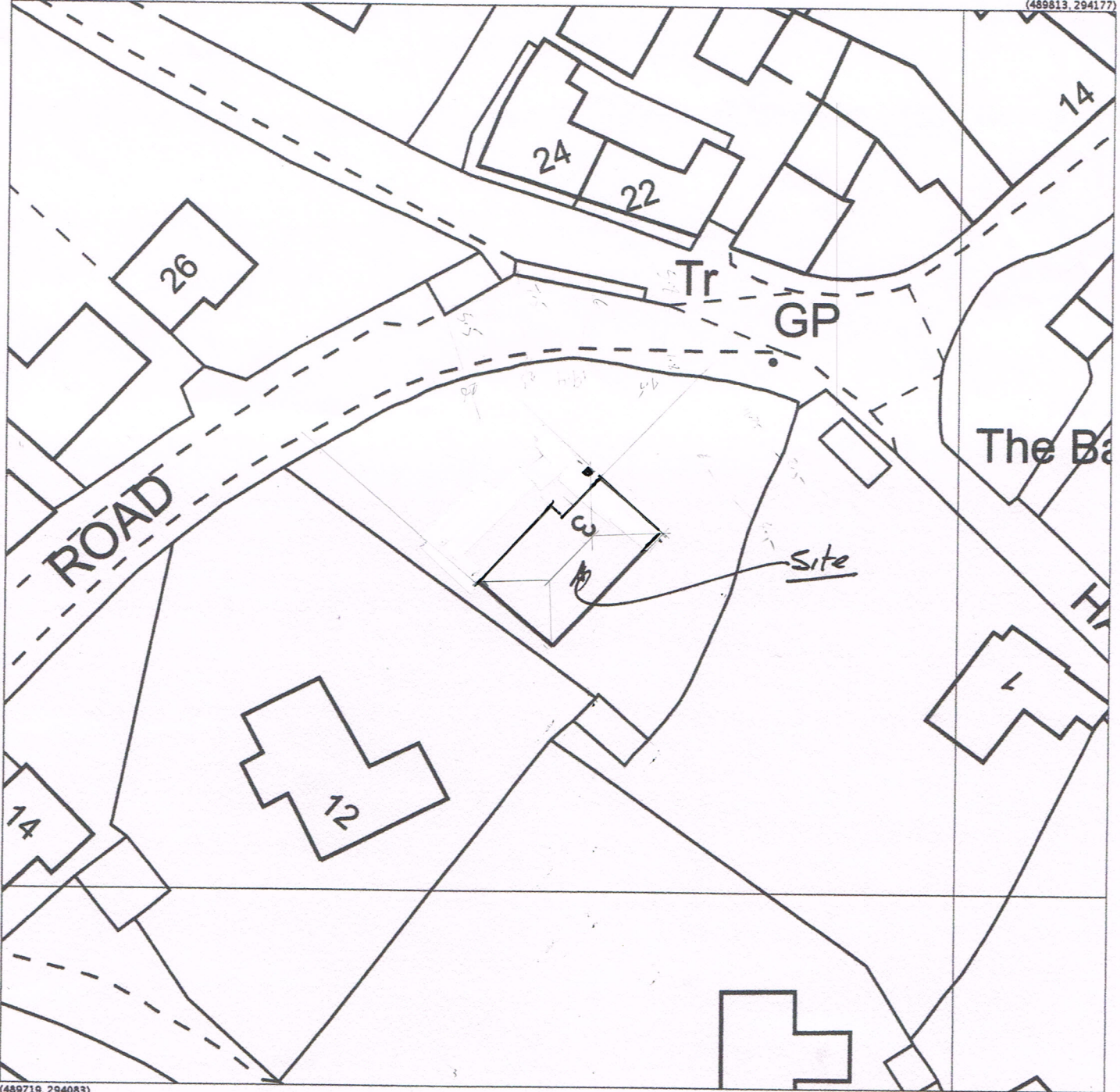

(489719, 294083)

(489813, 294083)

Produced 29 May 2014 from the Ordnance Survey National Geographic Database and incorporating surveyed revision available at this date. Reproduction in whole or part is prohibited without the prior permission of Ordnance Survey. © Crown Copyright 2014.

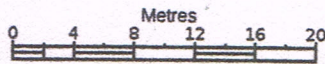

1:500



3, Arnhill Rd, Gretton, Corby  
 NN17 3DN

Ordnance Survey and the OS Symbol are registered trademarks of Ordnance Survey, the national mapping agency of Great Britain.

Supplied by: Latitude Mapping Ltd  
 Reference: OI717701  
 Centre coordinates: 489766 294130

The representation of a road, track or path is no evidence of a right of way. The representation of features as lines is no evidence of a property boundary.