

NOTES

- 1) This drawing has been produced/issued for the specific use as stated in the drawing status below. The drawing should only be used therefore for matters concerning the identified use.
- 2) Until technical approval, consents and/or licensing has been obtained from the relevant authority, it should be understood that all drawings issued are preliminary and NOT for construction. Should the contractor commence site work prior to such approval being given, it is entirely at their own risk.
- 3) All dimensions and/or levels to be checked on site prior to works proceeding.

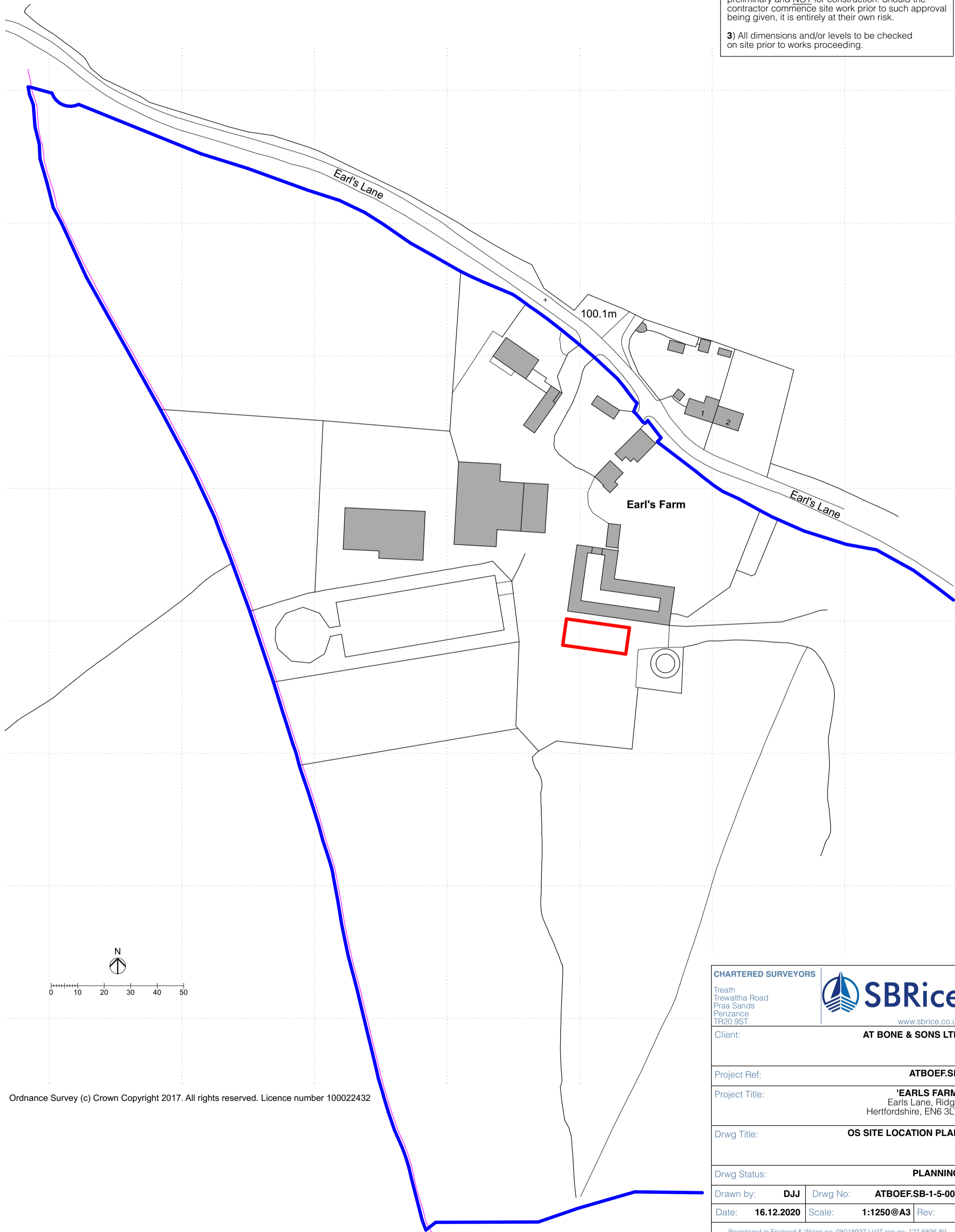

Ordnance Survey (c) Crown Copyright 2017. All rights reserved. Licence number 100022432

CHARTERED SURVEYORS		 www.sbrice.co.uk
Treath Trewaltha Road Praa Sands Penzance TR20 9ST		
Client:		AT BONE & SONS LTD
Project Ref:		ATBOEF.SB
Project Title:		'EARLS FARM' Earls Lane, Ridge Hertfordshire, EN6 3LT.
Drwg Title:		OS SITE LOCATION PLAN
Drwg Status:		PLANNING
Drawn by:	DJJ	Drwg No: ATBOEF.SB-1-5-001
Date:	16.12.2020	Scale: 1:1250@A3 Rev:
Registered in England & Wales no: 08018937 VAT reg no: 127 6836 89		
© this drawing and details depicted are the copyright of SBRice Ltd and may not be reproduced in any form except by written permission.		