

existing plan

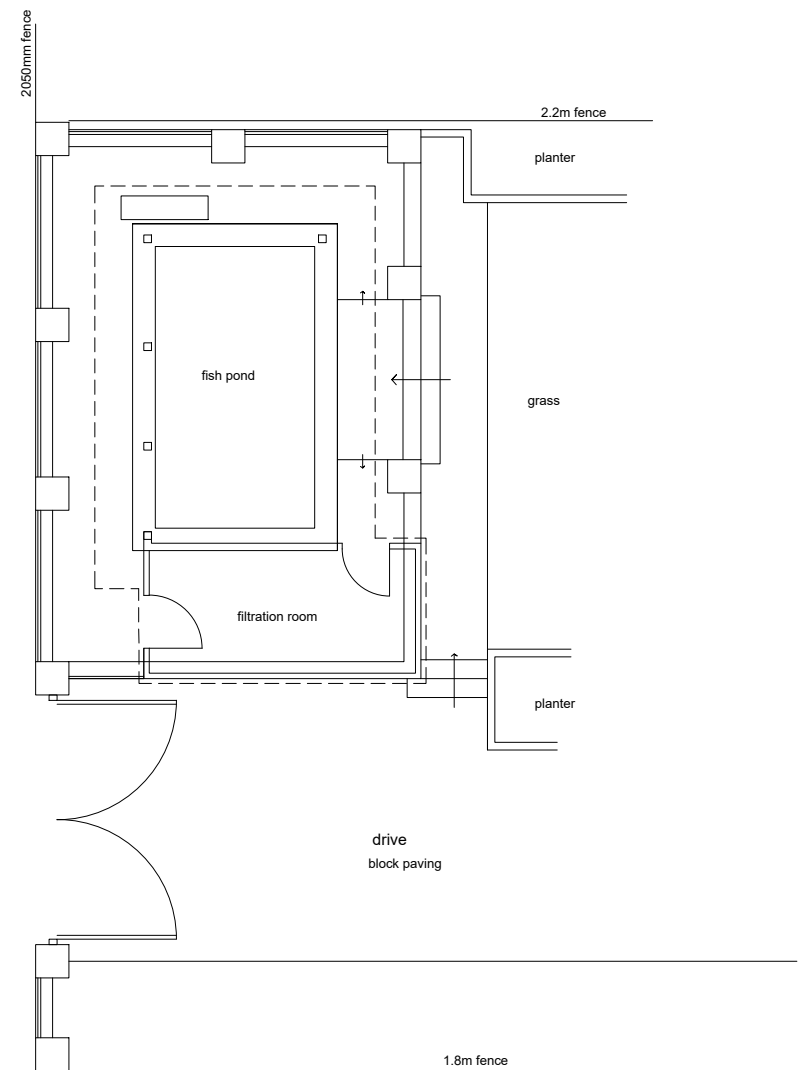

proposed plan

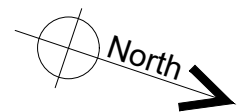
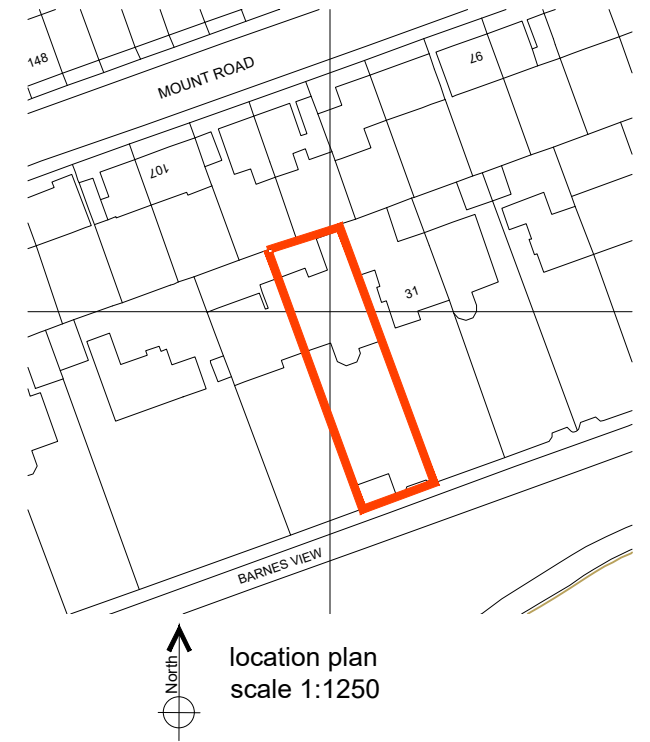

cummings

Architects Limited

17 Killingworth Drive • Sunderland • SR4 8QQ • Tel: 07985442755
e-mail: info@cummingsarchitects.co.uk

PROJECT
32 Barnes View, Sunderland,
SR4 7QA

DRAWING TITLE
existing and proposed plan

DATE	SCALE	JOB NO.	DRAWING NO.	REV.
24.03.21	100@ A3	21048	01	*

Drawing and design copyright of Cummings Architects Limited. Cummings Architects LTD. accepts no liability to third parties arising out of the unlawful reproduction or use of this drawing.
Dimensions to be confirmed on site before work commences & ordering of materials. Any discrepancies must be reported to Architect before any work is undertaken. This drawing is to be read in conjunction with relevant consultants information and specifications.