

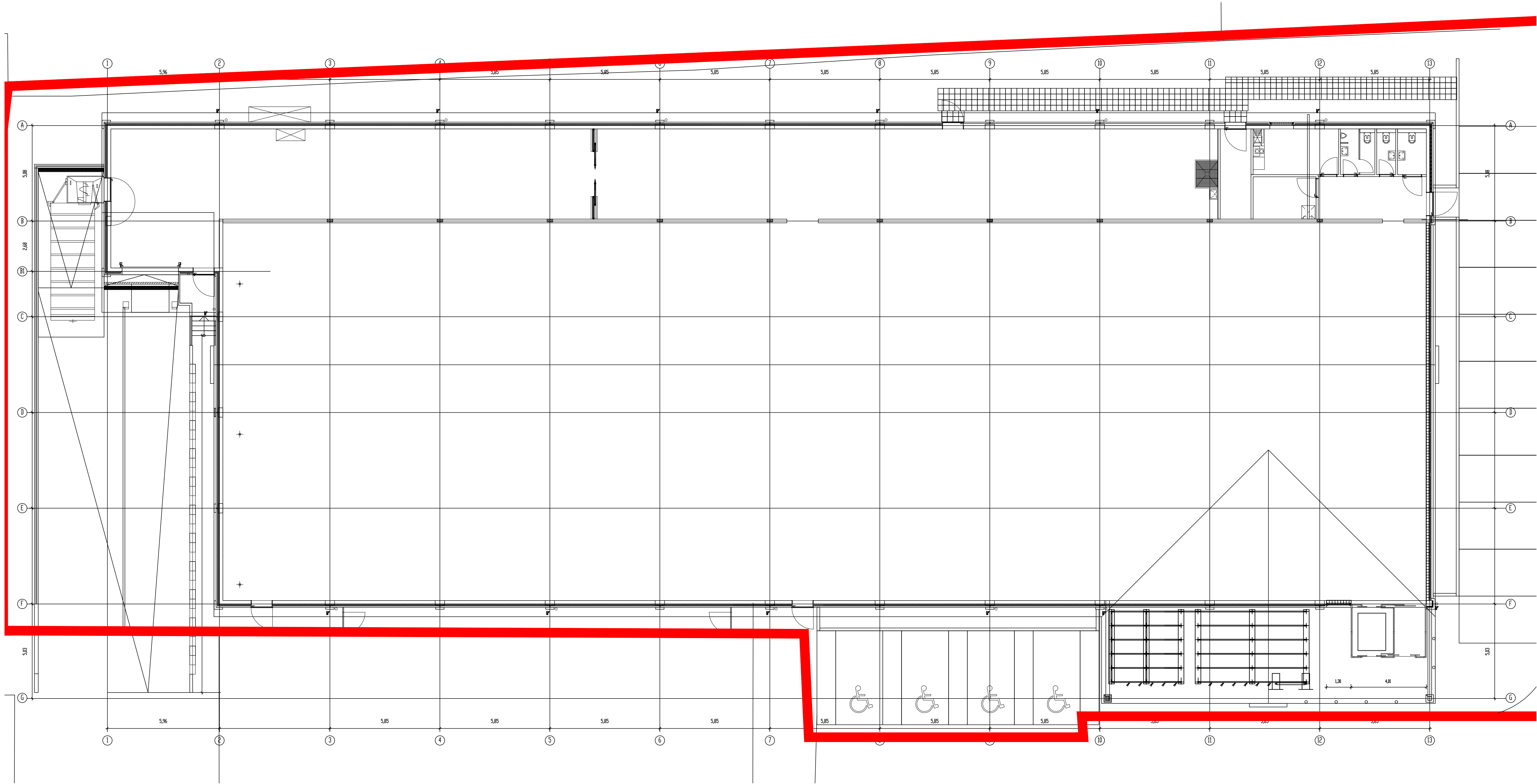

2. All sizes to be checked on site prior to construction.  
3. This drawing is the copyright of the author.

SITE BOUNDARY - 1.31 Ac / 0.53 Hect



EXISTING FLOOR PLAN | 1:100

**smith design associates**  
www.smithdesign.co.uk

Chartered Architects  
16 Lynedoch Crescent, Glasgow G3 6EQ  
client Lidl GmbH UK 0141 353 3501

project Proposed Retail Unit Extension  
Harbour Road, FRASERBURGH

drawing Existing Floor Plan original size A1

scale 1:100 drawn RP

date 14.01.21 checked -

status PLANNING passed -

job no. drawing no. revision  
G2910-51 AL(0)004 -

