

**IMPORTANT**  
 © This drawing is copyright and remains the property of this practice  
 Do not scale this drawing  
 All dimensions to be checked on site  
 Positions of existing services to be confirmed prior to proceeding

**REVISION STATUS**  
 S Information issued for feasibility or scheme design  
 T Information issued for tender purposes only  
 C Information issued for Construction  
 NB: Only those drawings containing a C revision to be used for construction

**NOTES**

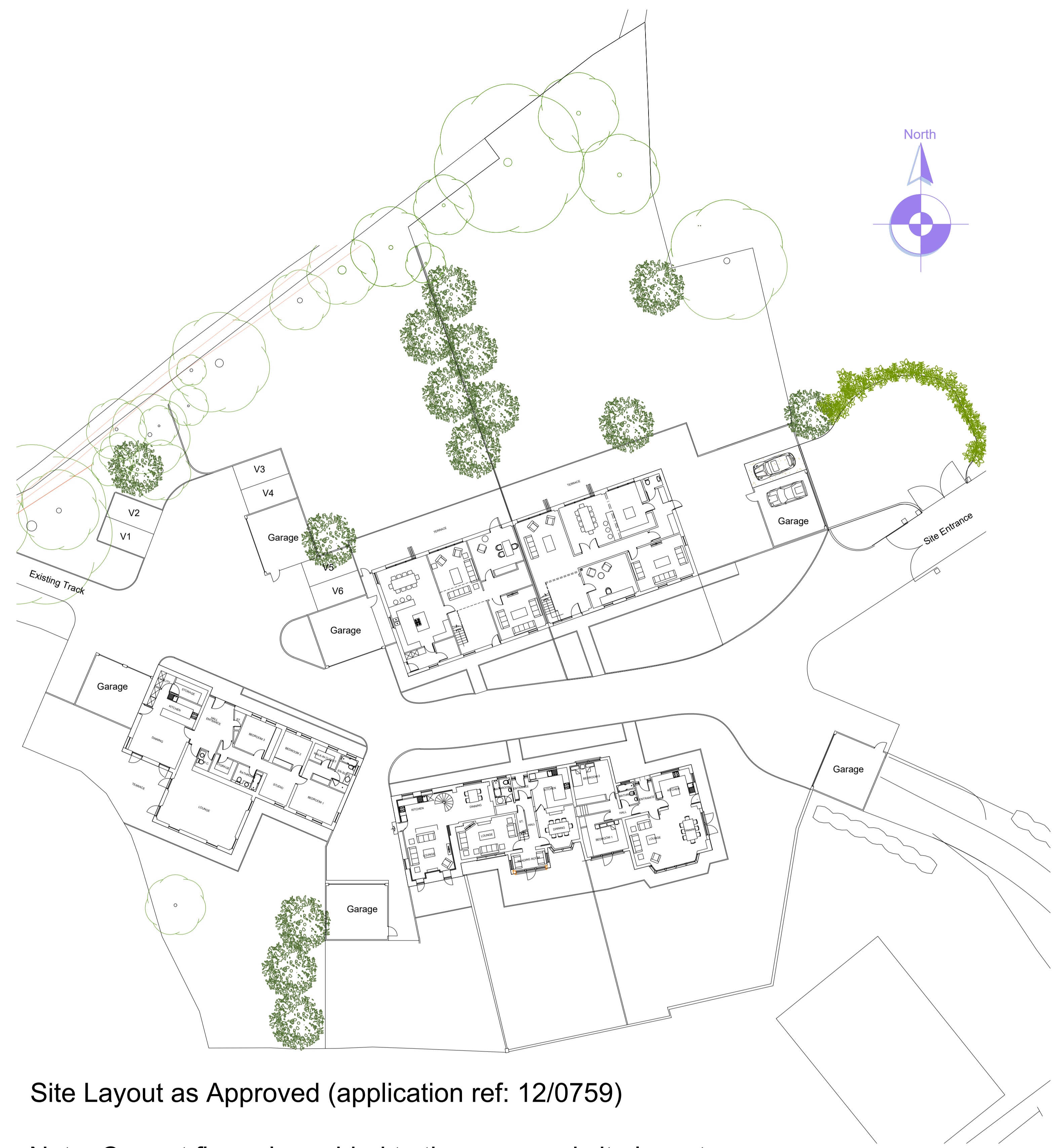

Site Layout as Approved (application ref: 12/0759)

Note: Correct floor plan added to the approved site layout as per amended floor plan ref: 08-1328-P15-E, a superceded layout is still illustrated on the approved site layout ref: 08-1328-P10-D

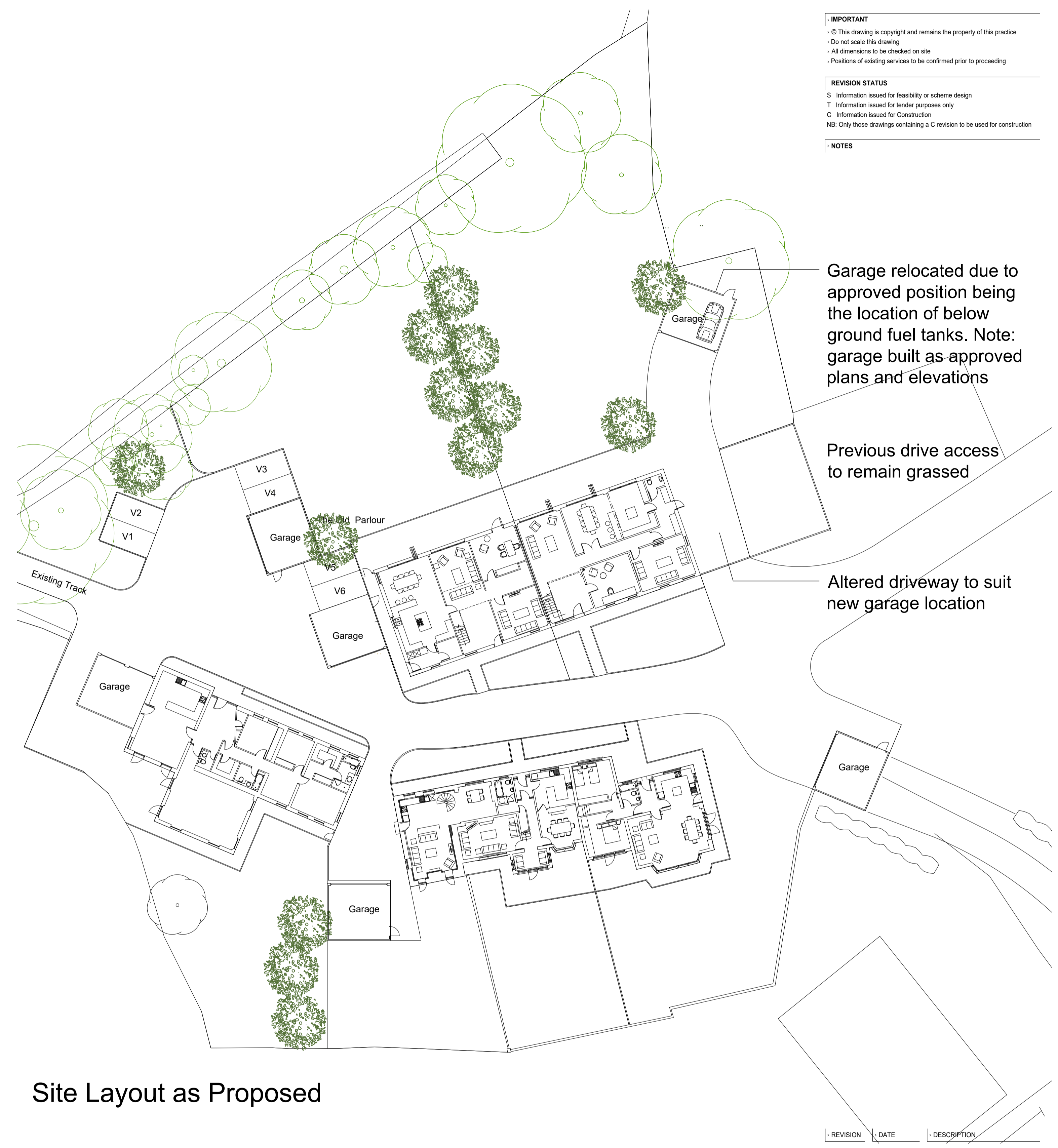

Site Layout as Proposed

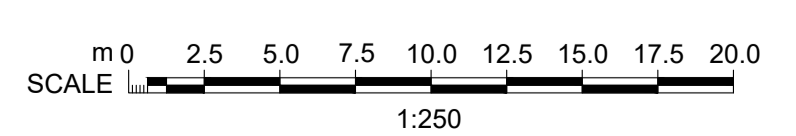

REVISION	DATE	DESCRIPTION

CLIENT  
R Group

PROJECT  
Great Carr Side Farm

DRAWING TITLE  
Approved Site Layout & Alternative Proposed Layout

SCALE	DATE	DRAWN	CHECKED
1@250@A1	Apr '21	PRH	PRH

DRG NO.  
EAD\_130\_01

Evolve Architectural Design Ltd  
 2 St Matthews School House  
 Stanhill Lane  
 Oswaldtwistle  
 Accrington  
 Lancashire BB5 4PZ  
 T 01254 469702  
 M 07957 592102  
 E paul@evolvead.co.uk  
 www.evolvead.co.uk