

BLOCK PLAN- STORAGE UNIT

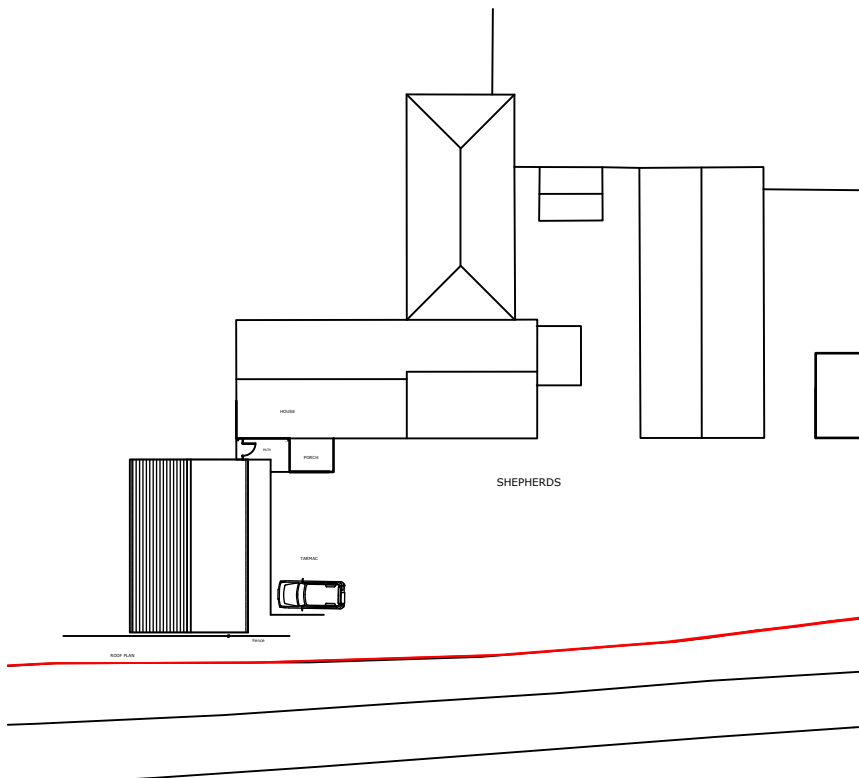

BLOCK PLAN - CARTLODGE



3 Balkerne House, Balkerne Passag
Colchester, Essex, CO1 1PA
tel. 01206 544939
fax. 01206 760688
email@hpd-architects.co.uk
www.hpd-architects.co.uk

PRELIMINARY

project and client

Proposed Extension at
Shepherds,
Rectory Road,
Middleton,
Essex,
CO10 7LN

Mr. I. Harvey

drawing title

Block Plans

scale	date
1:500	March 2021
@ A4	

ref.	no.
MT1	02