

NOTES:

1. GENERALLY, TO CLEAR AREA ON GROUND FLOOR REMOVE ANY OBVIOUS NON-STRUCTURAL ITEMS. IN LIFT AREA, A FURTHER INSPECTION WILL BE REQUIRED BUT DO NOT REMOVE ANY STEELWORK OR MASONRY WALLS. AN INFILL GROUND FLOOR WILL BE REQUIRED
2. IN BASEMENT IN AREA 'ABCD' OF SOFFIT TO GROUND FLOOR THERE IS SOME LOOSE TIMBER PIECES ABOVE WHICH IT APPEARS THERE IS INCLINED LOST SHUTTERING AS IF TO A CONCRETED STAR FLIGHT. PHYSICALLY INVESTIGATE FURTHER TO ESTABLISH WHETHER EXISTING STEPS, QUARTER LANDING AND TOP LANDING (WC) CAN BE REMOVED AND RECONSTRUCTED AT SHOP GROUND FLOOR LEVEL

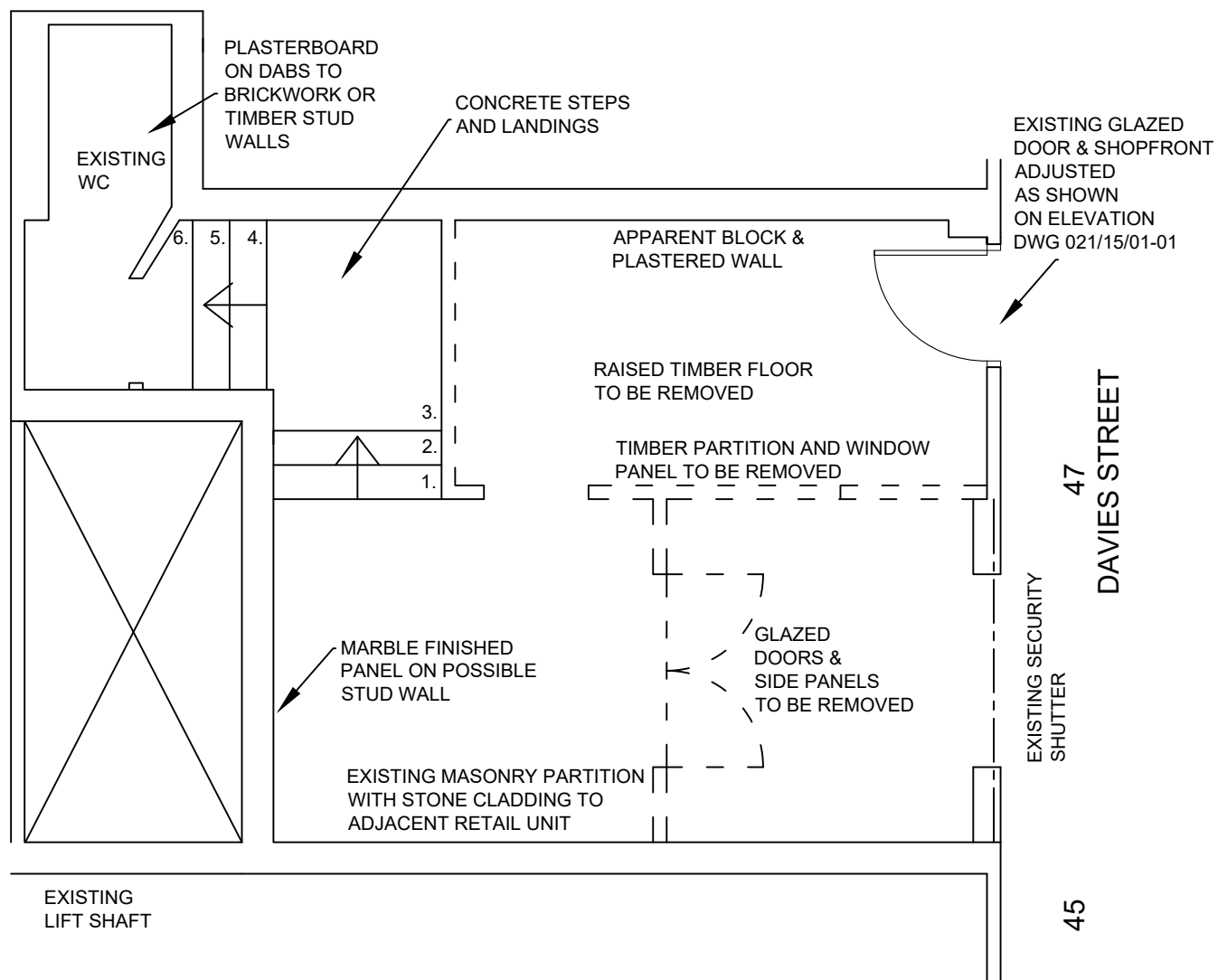

GROUND FLOOR PLAN
(SCALE 1:50)

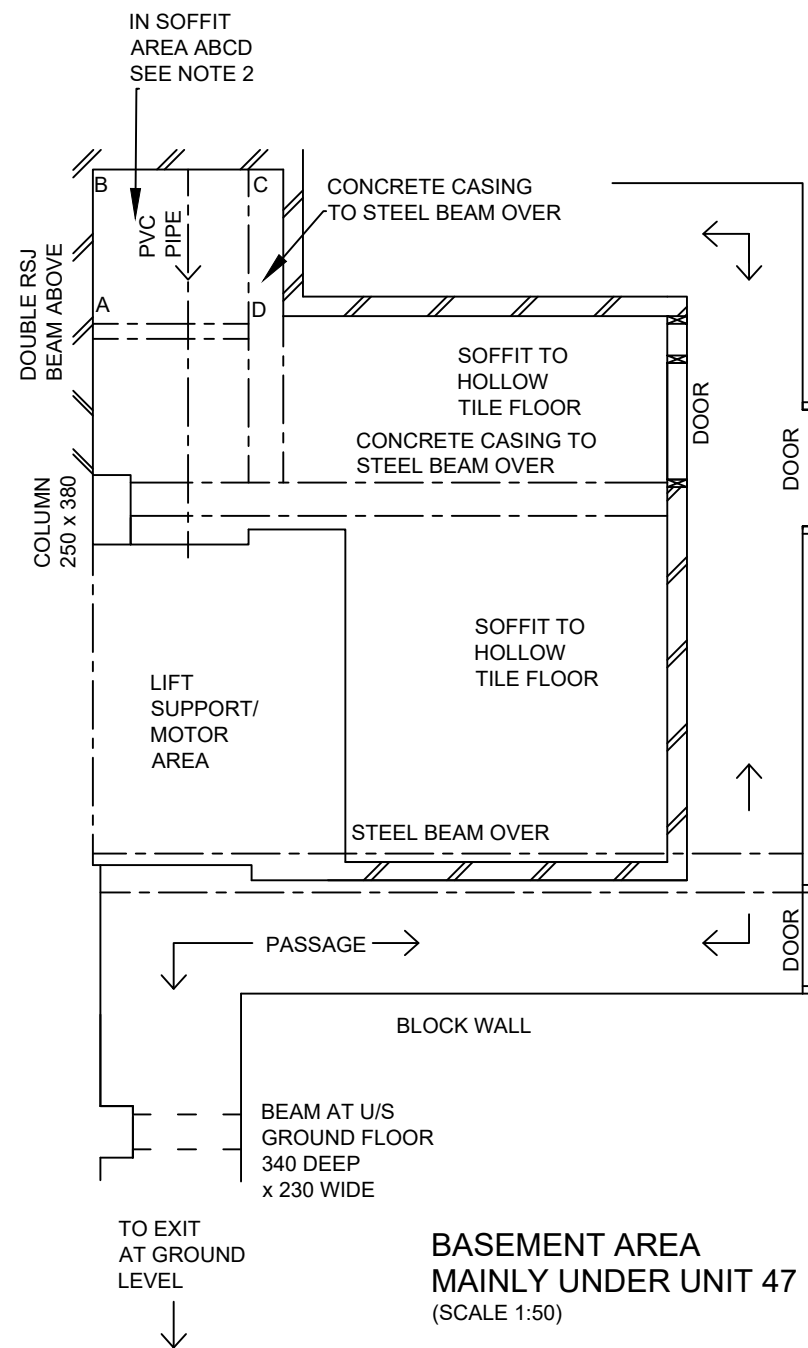

BASEMENT AREA
MAINLY UNDER UNIT 47
(SCALE 1:50)



1:50 Scale

REV.	DETAILS	BY	DATE
	Date: MAR 2021	Chk: MM	Scale: 1:50
	Drawn By: LR	Job No: 1913	Drawing No: 02
			REV

MACLAREN ROUGHTON

Civil and Structural Consulting Engineers
Regal House, 13 Albion Place, Maidstone Kent ME14 5DY
Telephone 01622 690540 e-mail: info@maclarenroughton.co.uk

CLIENT
MR NIALL BERMINGHAM

PROJECT
WILD THINGS FLOWERS, BROOK STREET HOUSE
47 DAVIES STREET, LONDON W1K 4LY
DRG TITLE
PART FLOOR PLANS - AS PROPOSED