

REV	DATE	DESCRIPTION

GENERAL NOTES

- All drawings to be read in conjunction with other consultants drawings & written specifications
- All structure to be in accordance with structural engineers drawings & written specification
- All works to comply with British standards requirements as noted within written documents
- All dimensions to be checked on site prior to the manufacture of any elements and major discrepancies to be reported to the architect

T.B.G. = To be confirmed
 C.O.S = Check on site
 S/O = Structural opening

COPYRIGHT
 Gilbert Gibson Designs

PROJECT DESCRIPTION:

Demolish existing rear POD bathroom and side storage.
 Erection of a two-storey side extension/part single-storey and single storey rear extension

PROJECT ADDRESS:
 9 Whitland Road - Sutton - SM5 1GX

CLIENTS: Mr and Mrs Teney

DRW TITLE: Proposed Ground and First Floor Plans

DRW No.: GGD-318-P05

DRWN BY: CG

DATE: March 2021

SCALE: 1:100/A3

GILBERT GIBSON DESIGNS

14 Evesham Green, Morden, Surrey, SM4 6PW
 Tel: 02086407038 mob: 07903937984
 E-mail: gilbert@gilbertgibsondesigns.com
 Website: www.gilbertgibsondesigns.com

RIBA & ARB Architects

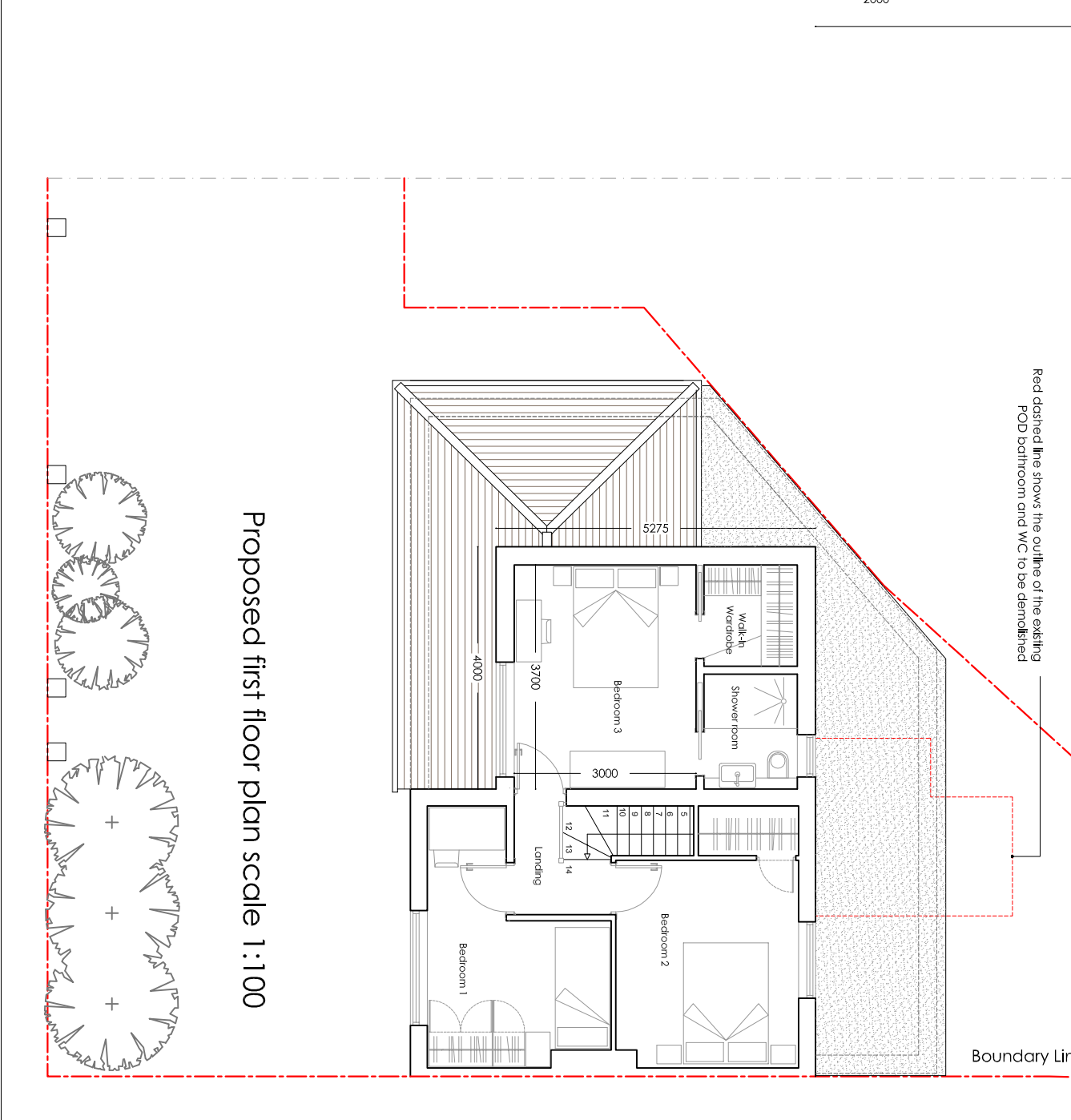
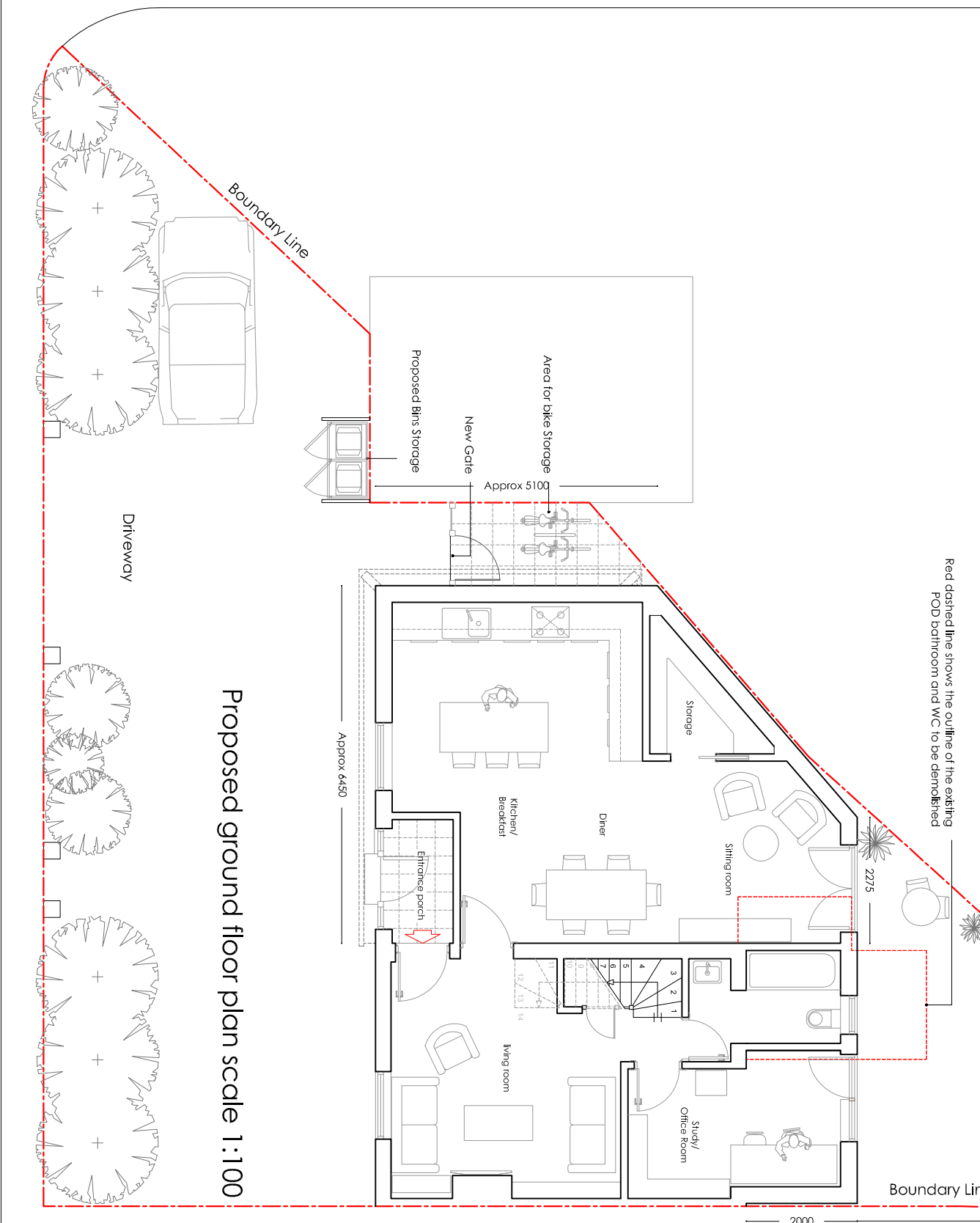
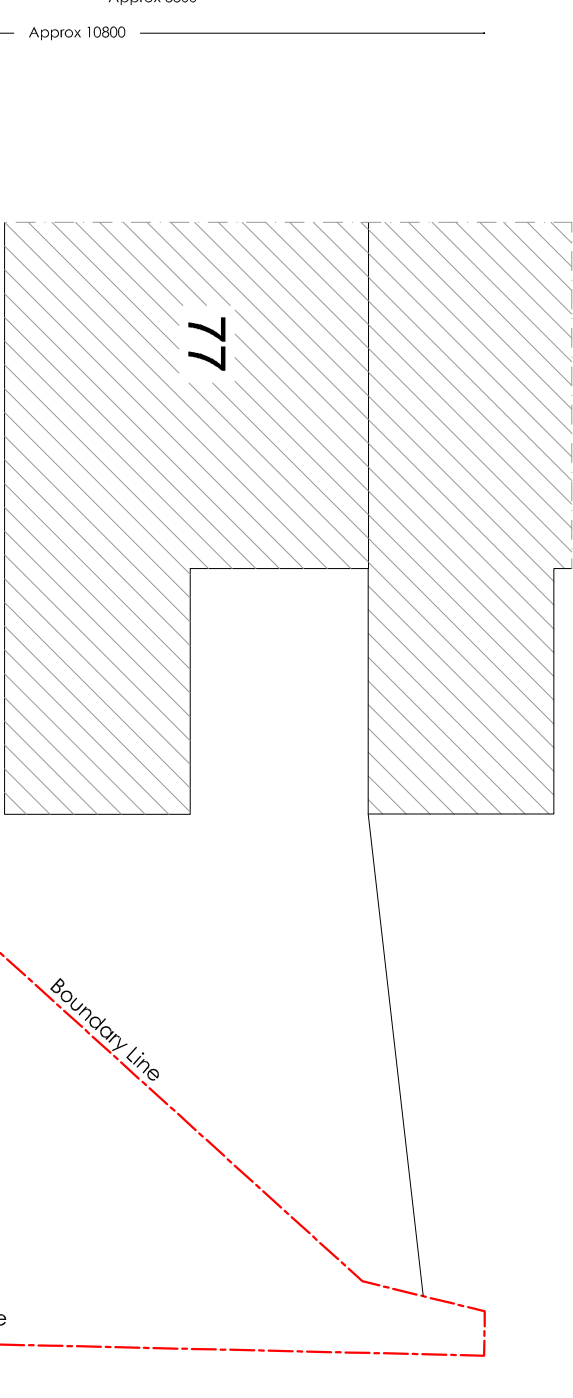
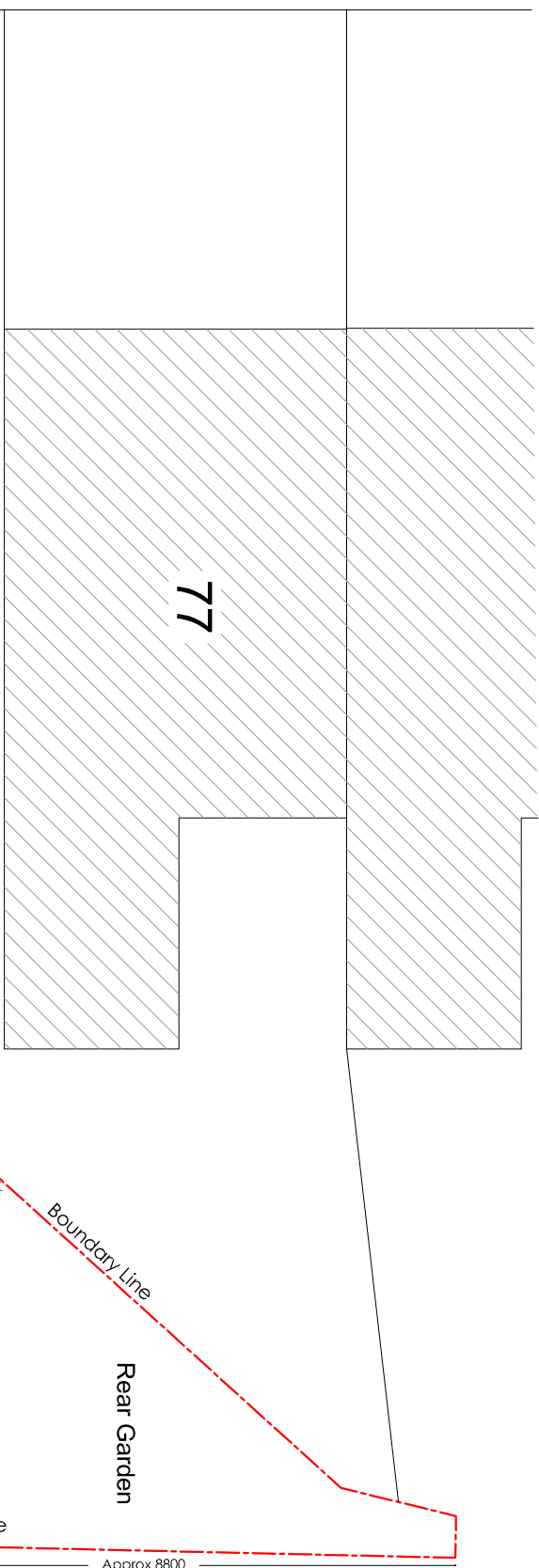

Red dashed line shows the outline of the existing POD bathroom and WC to be demolished

Red dashed line shows the outline of the existing POD bathroom and WC to be demolished