

London

Published 1850 - 1851

Source map scale - 1:5,280

The historical town plans shown derive from Ordnance Survey mapping from the early to mid 1850s. The 1:2640 scale was introduced in the early 1850s, to survey districts covered by the Local Boards of Health and for a map of the Osborne Estate of Queen Victoria. The general style is similar to that of the early 1:2500s published shortly afterwards.

1:5280 scale was surveyed shortly afterwards in the mid 1850s as general purpose mapping with a standard of content similar to the more contemporary 1:10,560 mapping. The scale was also used for a reduction of the 1:1056 'skeleton survey' of London that was undertaken between 1848 and 1850.

Please note: Due to the partial coverage of Historical Town Plans, it is possible that not all segments within an order will contain mapping. Only the segments that have Town Plan coverage will be generated.

Map Name(s) and Date(s)

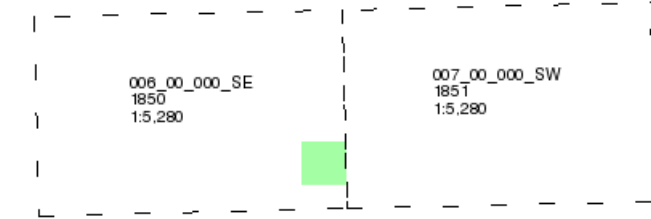

Historical Town Plan - Segment A13

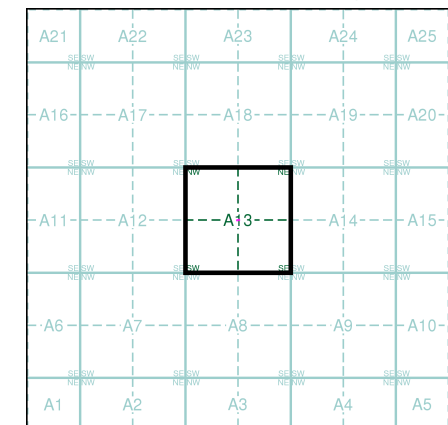

Order Details

Order Number: 271954135_1_1
 Customer Ref: 21/33098
 National Grid Reference: 527410, 179520
 Slice: A
 Site Area (Ha): 0.02
 Search Buffer (m): 0

Site Details

4, Montpelier Square, LONDON, SW7 1JT

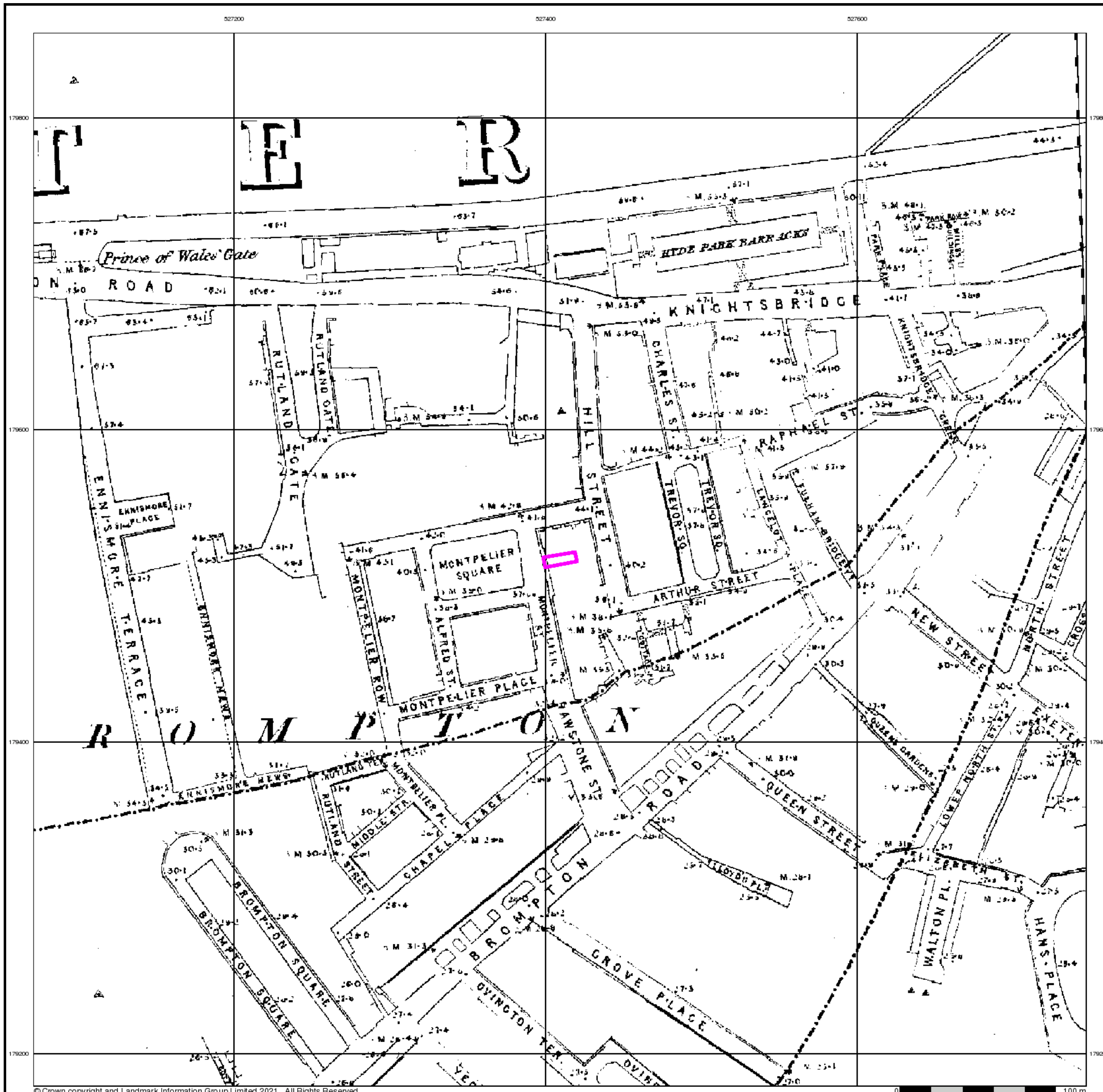

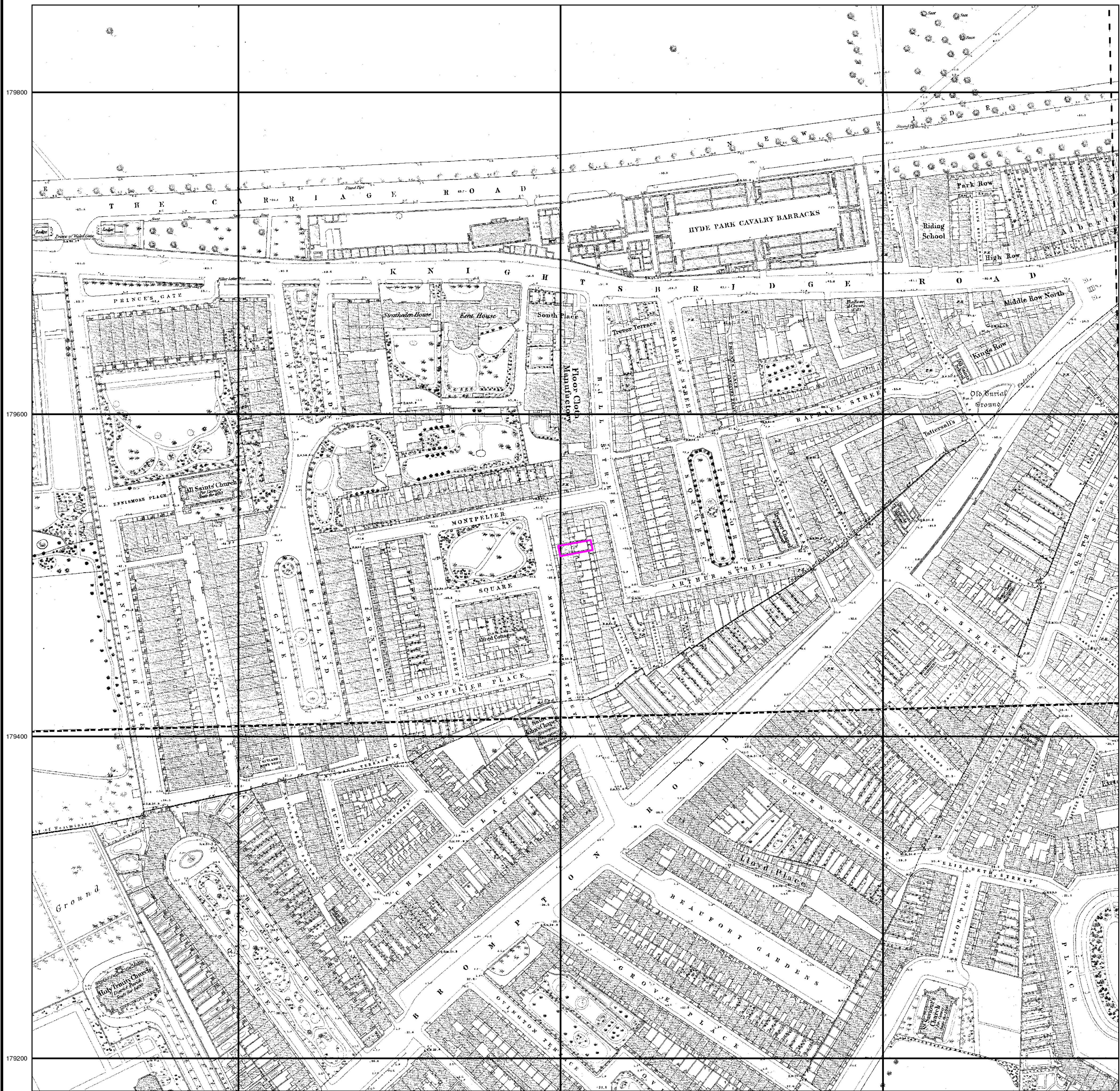

London
Published 1870 - 1872
Source map scale - 1:1,056

The 1:1056 scale of Ordnance Survey mapping was adopted from Ireland in 1848 and was used to survey towns with a population of over 4000, plus county towns of lesser population, in those counties mapped at the six-inch scale in 1841-55. The scale was the largest scale at which London was mapped by the Ordnance Survey and a 'skeleton' survey of the capital, showing little more than streets, street names, frontages and altitudes, was undertaken between 1848 and 1850. The majority of the 1:1056 surveys were later replaced by 1:500 surveys; although almost all the remainder were revised at this scale, sometimes more than once before 1895. The type of detail shown on the 1:1056 scale is broadly similar to that on 1:500; the apparent omission of minor details such as sewer access points and street lights may be as much a reflection of the generally earlier date of these plans, as of the specification of the map.

Please note: Due to the partial coverage of Historical Town Plans, it is possible that not all segments within an order will contain mapping. Only the segments that have Town Plan coverage will be generated.

Map Name(s) and Date(s)

006_00_090	007_00_081
1872	1870
1:1,056	1:1,056
006_00_100	
1872	
1:1,056	

Historical Town Plan - Segment A13

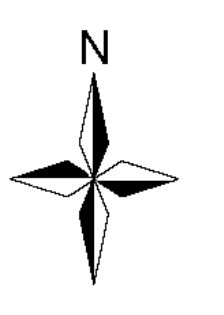
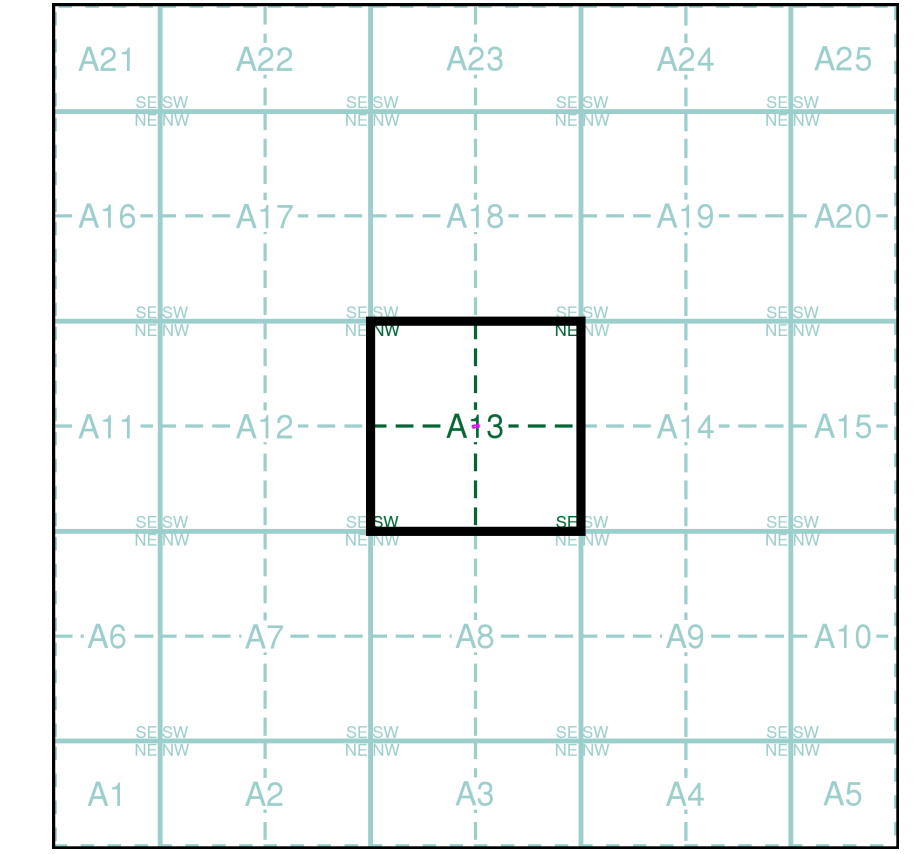

Order Details

Order Number: 271954135_1_1
 Customer Ref: 21/33098
 National Grid Reference: 527410, 179520
 Slice: A
 Site Area (Ha): 0.02
 Search Buffer (m): 0

Site Details

4, Montpelier Square, LONDON, SW7 1JT

London

Published 1895 - 1896

Source map scale - 1:1,056

The 1:1056 scale of Ordnance Survey mapping was adopted from Ireland in 1848 and was used to survey towns with a population of over 4000, plus county towns of lesser population, in those counties mapped at the six-inch scale in 1841-55. The scale was the largest scale at which London was mapped by the Ordnance Survey and a 'skeleton' survey of the capital, showing little more than streets, street names, frontages and altitudes, was undertaken between 1848 and 1850. The majority of the 1:1056 surveys were later replaced by 1:500 surveys; although almost all the remainder were revised at this scale, sometimes more than once before 1895. The type of detail shown on the 1:1056 scale is broadly similar to that on 1:500; the apparent omission of minor details such as sewer access points and street lights may be as much a reflection of the generally earlier date of these plans, as of the specification of the map.

Please note: Due to the partial coverage of Historical Town Plans, it is possible that not all segments within an order will contain mapping. Only the segments that have Town Plan coverage will be generated.

Map Name(s) and Date(s)

006_00_090	007_00_081
1895	1895
1:1,056	1:1,056
006_00_100	
1895	
1:1,056	

Historical Town Plan - Segment A13

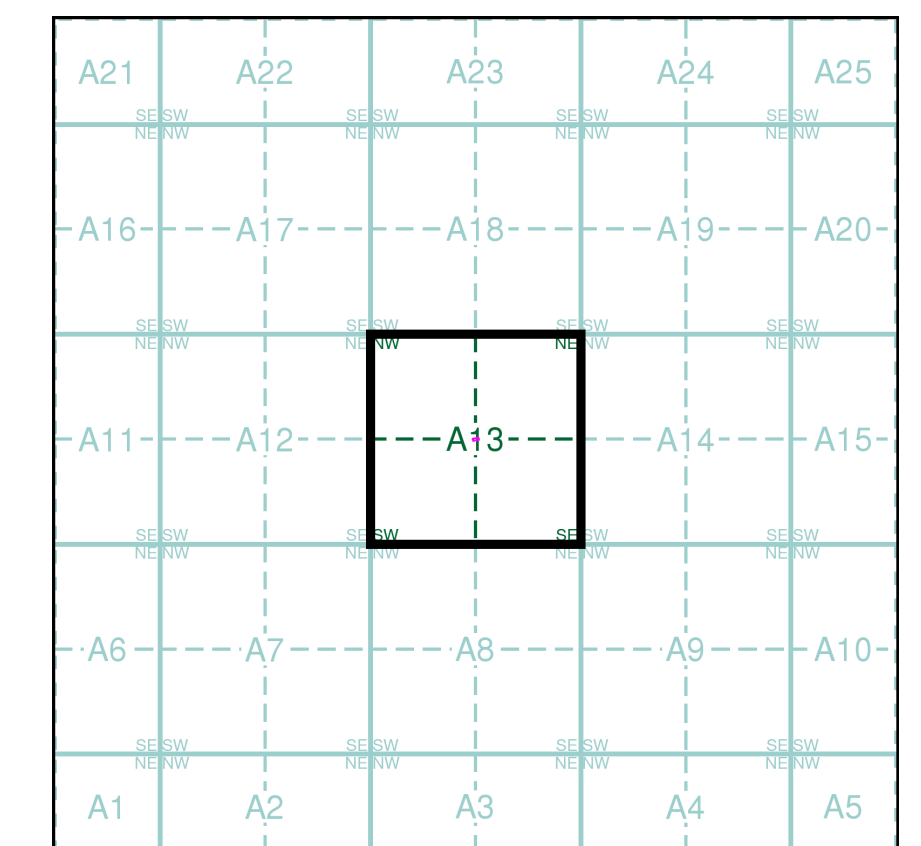

Order Details

Order Number: 271954135_1_1
 Customer Ref: 21/33098
 National Grid Reference: 527410, 179520
 Slice: A
 Site Area (Ha): 0.02
 Search Buffer (m): 0

Site Details

4, Montpelier Square, LONDON, SW7 1JT

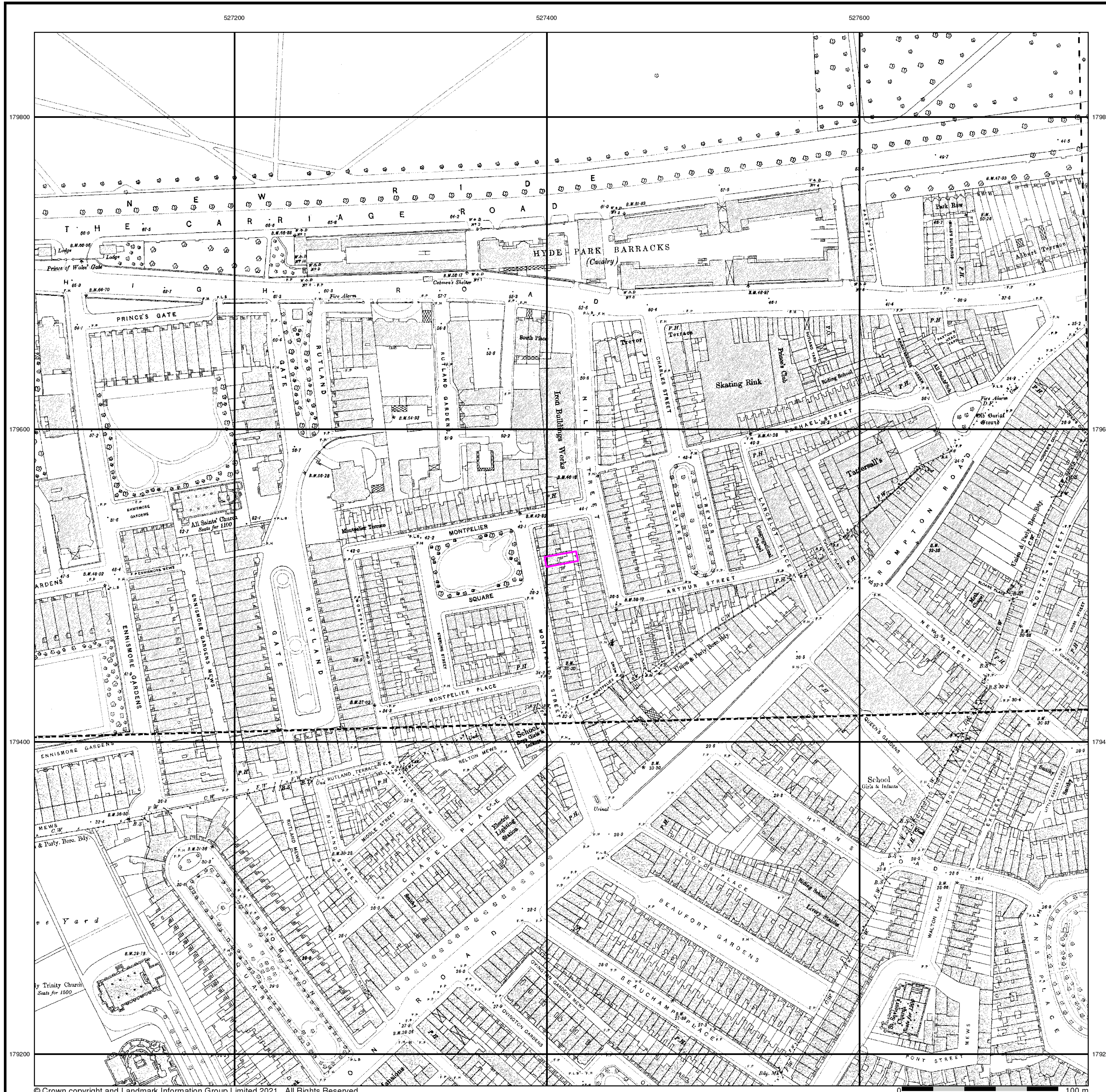

London

Published 1906 - 1915

Source map scale - 1:1,056

The 1:1056 scale of Ordnance Survey mapping was adopted from Ireland in 1848 and was used to survey towns with a population of over 4000, plus county towns of lesser population, in those counties mapped at the six-inch scale in 1841-55. The scale was the largest scale at which London was mapped by the Ordnance Survey and a 'skeleton' survey of the capital, showing little more than streets, street names, frontages and altitudes, was undertaken between 1848 and 1850. The majority of the 1:1056 surveys were later replaced by 1:500 surveys; although almost all the remainder were revised at this scale, sometimes more than once before 1895. The type of detail shown on the 1:1056 scale is broadly similar to that on 1:500; the apparent omission of minor details such as sewer access points and street lights may be as much a reflection of the generally earlier date of these plans, as of the specification of the map.

Please note: Due to the partial coverage of Historical Town Plans, it is possible that not all segments within an order will contain mapping. Only the segments that have Town Plan coverage will be generated.

Map Name(s) and Date(s)

006_00_090	1906	1:1,056
006_00_100	1915	1:1,056

Historical Town Plan - Segment A13

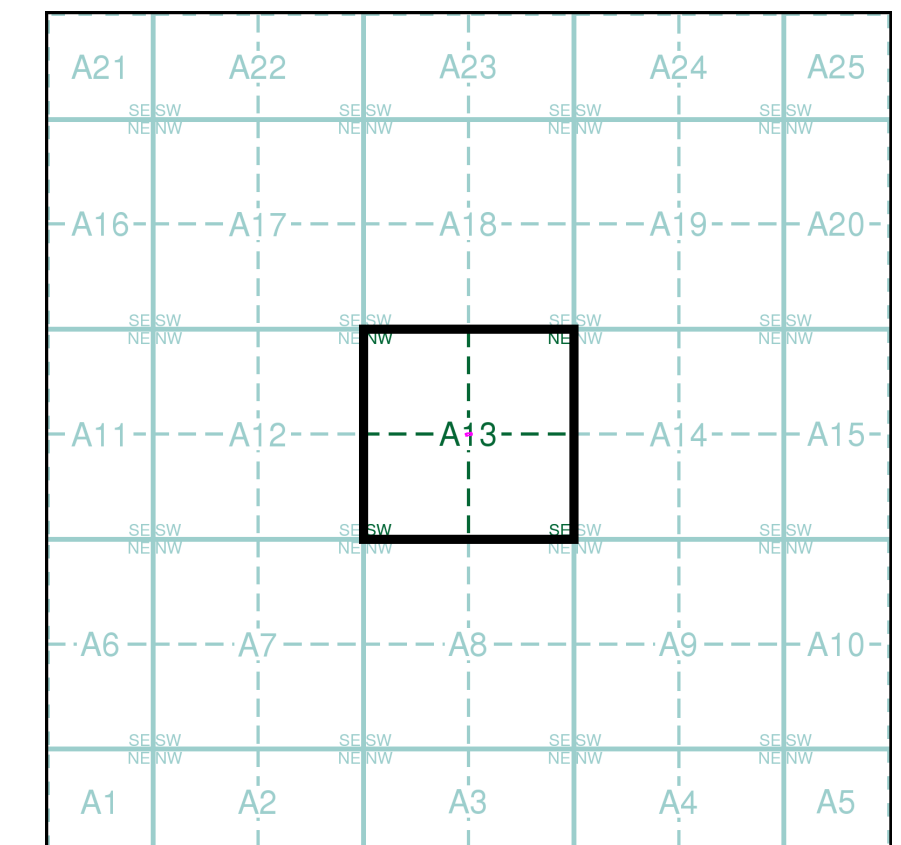

Order Details

Order Number: 271954135_1_1
 Customer Ref: 21/33098
 National Grid Reference: 527410, 179520
 Slice: A
 Site Area (Ha): 0.02
 Search Buffer (m): 0

Site Details

4, Montpelier Square, LONDON, SW7 1JT

