

- This drawing is the copyright of HNW Architects Ltd Registered No. 3589904
- All dimensions must be verified on site prior to construction.
- Do not scale this drawing except for Planning Application purposes.
- Ordnance Survey Licence No. 10000200
- Only PDF issues of this drawing are controlled. All other formats of this drawing (e.g. .dwg Autocad or .rvt Revit files) are un-controlled and are used at your own risk.
- This drawing must not be copied, transmitted or passed to a third party, without written consent.

Rev	Amendments	by	chkd	Date
P1	Planning issue	BR	AC	27/05/20

--- SITE BOUNDARY

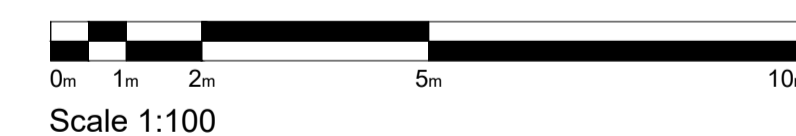
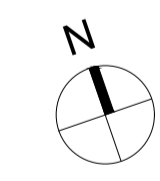
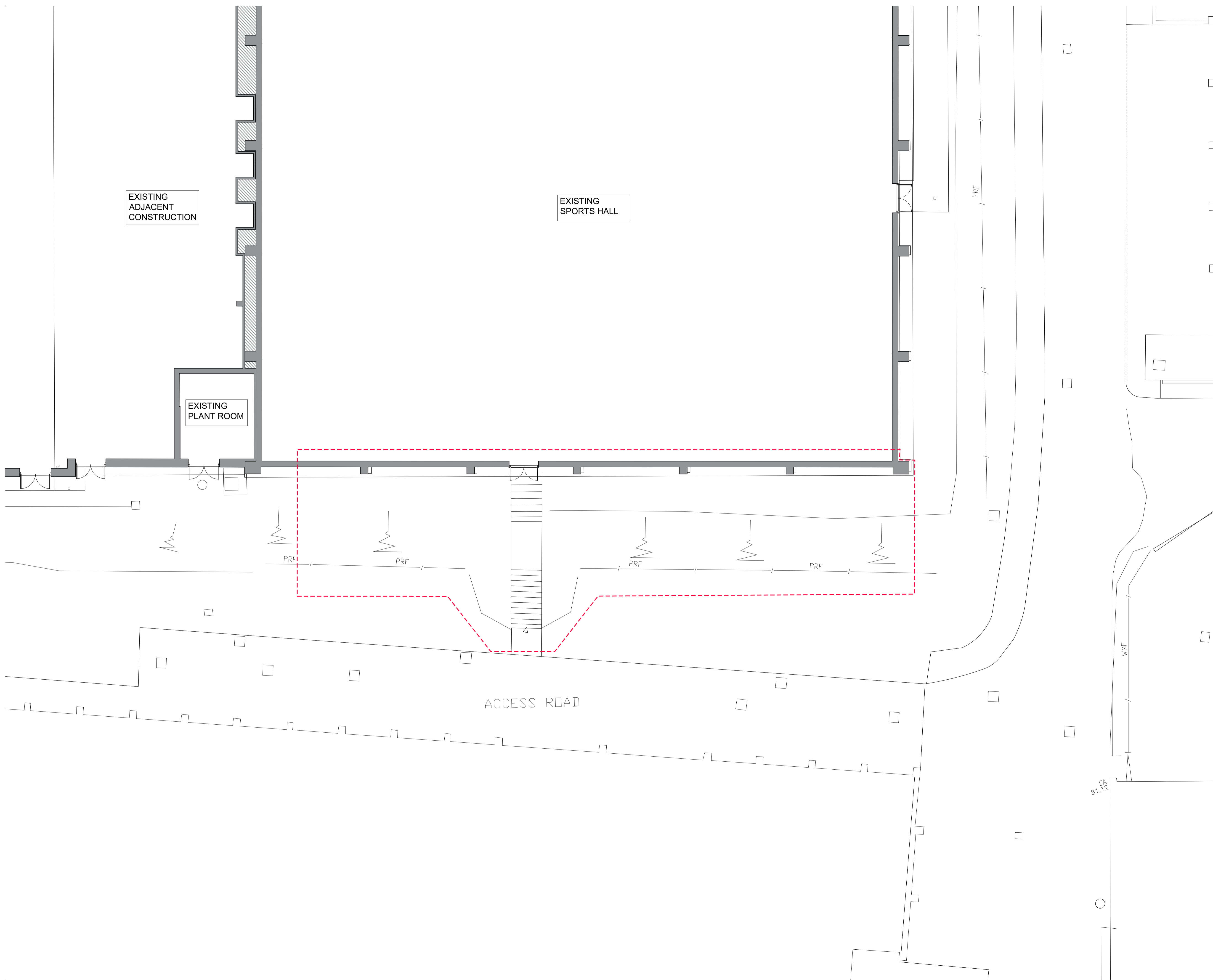

Project
SEAFORD COLLEGE
PETWORTH, WEST SUSSEX

Drawn By: **AJ** Checked By: **BR** HNW Project No. **19037** Date Created **DEC 2019**

Scale
A1- 1:100

Drawing Title
EXISTING GROUND
FLOOR PLAN

Drawing Status: **PRELIMINARY** Revision: **P1**

Drawing Number
19037-HNW-XX-00-DR-A-1200

61 North Street, Chichester, West Sussex, PO19 1JH

