

Existing Site Plan

CATEGORY AND DEFINITION

Trees unsuitable for retention	
Category U	Those in such condition that they cannot realistically be retained as living trees in the current land use for longer than 10 years
Trees to be considered for retention	
Category A	Trees of high quality with an estimated remaining life expectancy of at least 40 years
Category B	Trees of moderate quality with an estimated remaining life expectancy of at least 20 years
Category C	Trees of low quality with an estimated remaining life expectancy of at least 10 years, or young trees with a stem diameter below 150mm

	Existing Tree/Feature BS 5837:2012 Category A		Existing Tree/Feature BS 5837:2012 Category U
	Existing Tree/Feature BS 5837:2012 Category B		Line of Root Protection Area (RPA) - calculated following guidelines set in BS 5837:2012
	Existing Tree/Hedge to be crown lifted to allow for development		Existing Tree/Feature to be Removed BS 5837:2012 Category U
	Existing Tree/Feature BS 5837:2012 Category C		Line of proposed protective barrier BS 5837:2012 (Demolition phase)

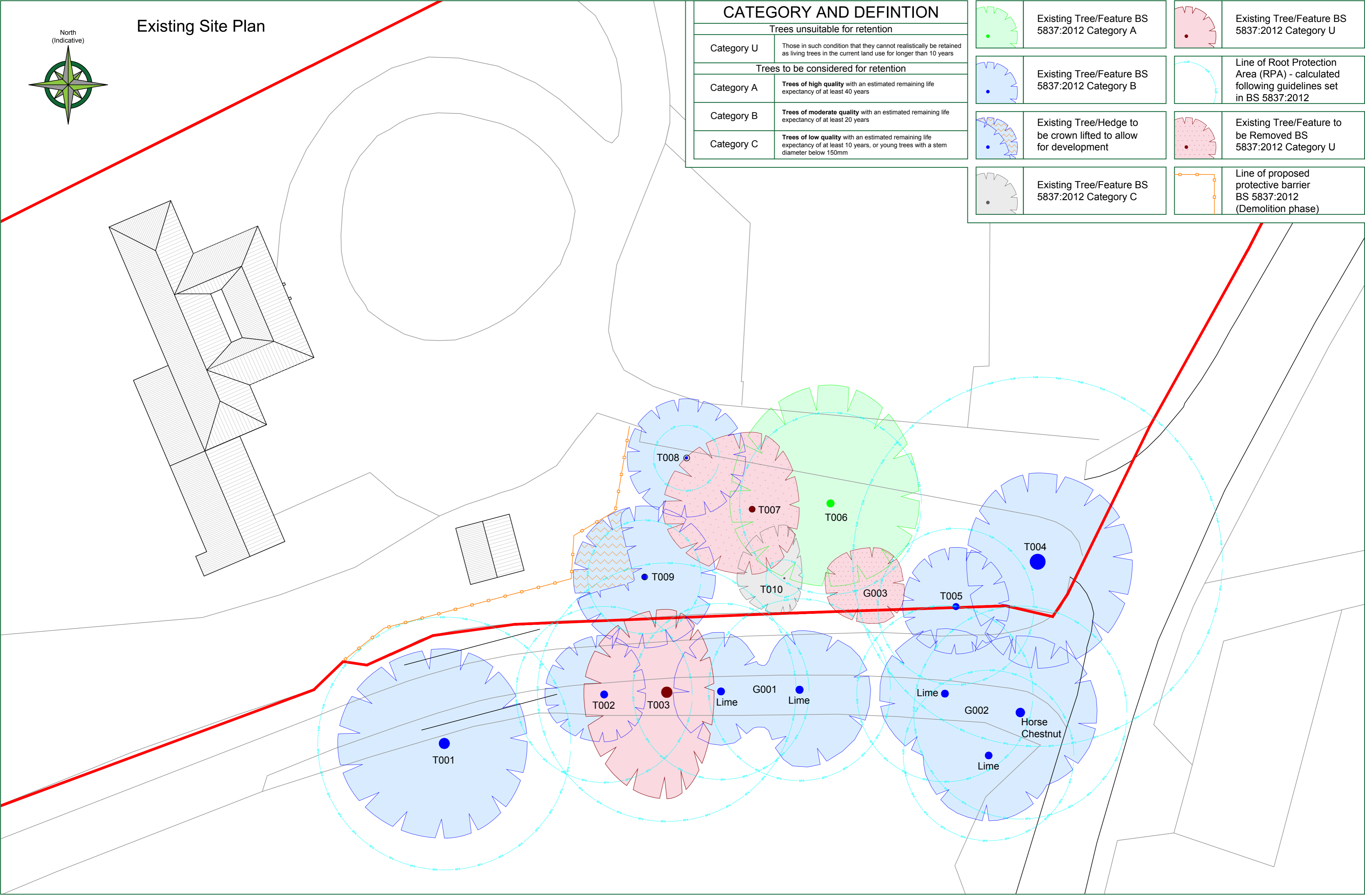

Proposed Site Plan

	Line of proposed temporary protective barrier
	Area of temporary Ground Protection
	Line of proposed Root Pruning

NOTE:

Hayden's Arboricultural Consultants were provided with a Block Plan which showed the position of the trees within the site. These positions along with GPS information have been used to position the surveyed trees. As such the position of the trees/landscape features should not be taken as exact but gives a fair distribution of their locations on site.

The position, condition, and dimensions of the trees are based on a site survey undertaken on 10/03/2021

"The original of this drawing was produced in colour - a monochrome copy should not be relied upon"

Scale 1:200

0m 4m 8m 12m 16m 20m

Rev.	Date	By	Revision
-	29/03/21	KFJ	Based on Peter Wells Architects Drawing: PW1141_PL04

