

0 5 10 m

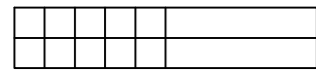

**Notes**

This drawing may not be reproduced without written consent. All copyrights reserved.

Based on drawings supplied by Boast Architects, Hertfordshire

The original of this drawing was produced in colour - a monochrome copy should not be relied upon.

The position of offsite trees is indicative where these were not included within the Topographical Survey.

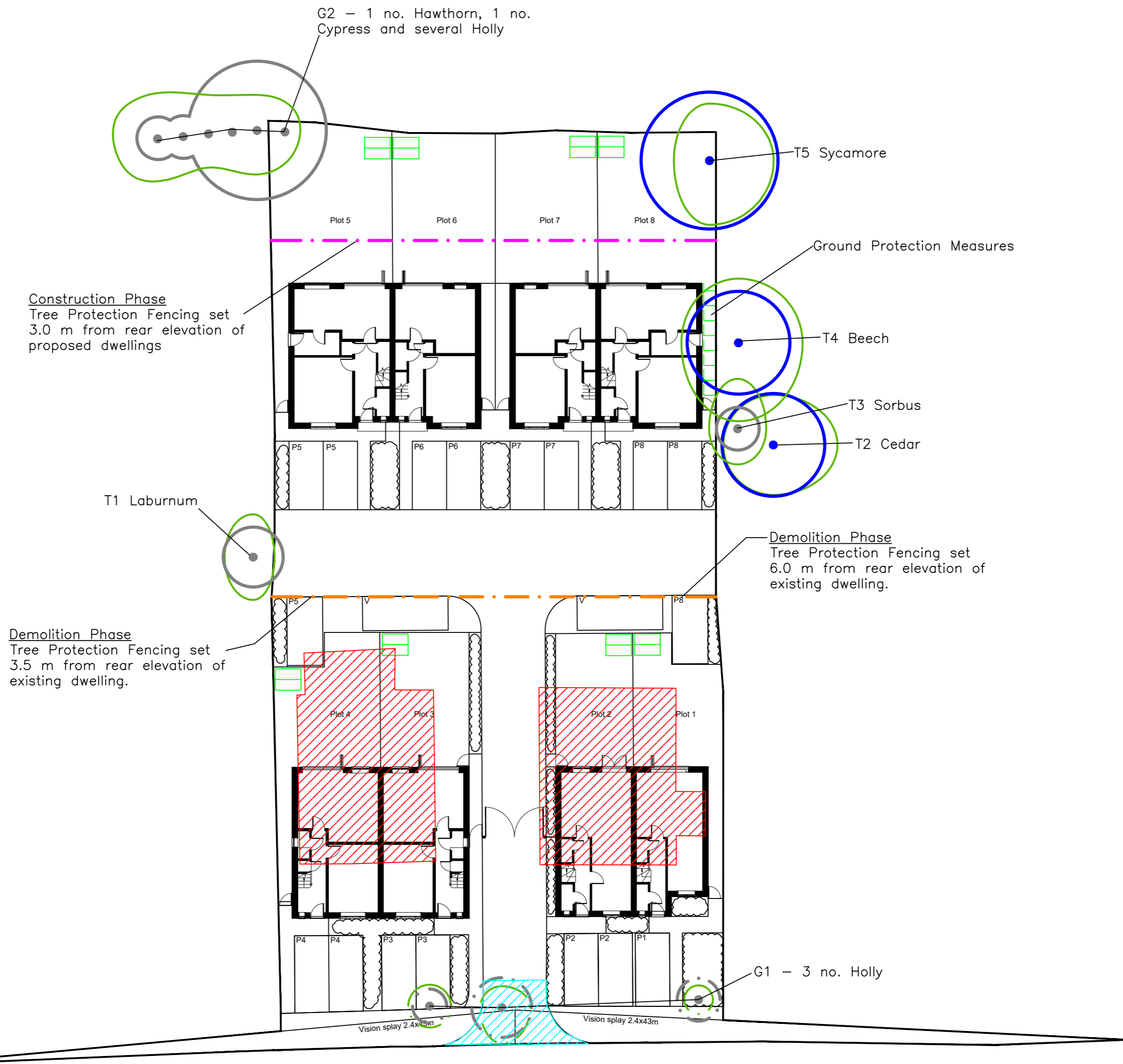

**KEY**

•	Tree (Trunk) Locations and Category Grading
○	Root Protection Areas and Category Grading (see below)
○	Tree Canopy Spreads - only part of the canopy may be shown.
○	Trees to be removed due to the implementation of the development.
▨	Construction Site Access and Ground Protection Measures
▨	Ground Protection Measures
▨	Footprints of buildings to be demolished
—	Tree Protection Fencing - Demolition Phase
—	Tree Protection Fencing - Construction Phase
Category Grading (See Arboricultural Survey - Appendix A)	
○	Category A
○	Category B
○	Category C
○	Category U

45 and 46 Chesham Road, Bovington Hertfordshire, HP3 0EA

Drawing Title:  
Tree Protection Plan

Drawing No:  
TPP/4546CRBH/  
010 A  
Client: Roger Fleet  
and Ron New  
Scale: 1:250 @ A2  
Drawn By: drc  
Date: February 2021

**DCCLA**

David Clarke BSc (Hons) PD Arb (RFS)  
CMLI M Arbor A  
Offices in Hertfordshire and Warwickshire  
Head Office: Willowbrook House, Church Lane, Fillongley, Warwickshire, CV7 8EW  
M: (07775) 650 835 or (01676) 541 833  
e.mail: info@dccla.co.uk