

Designed by: MS Checked by: JBF Project: 1922

Drawing name: Proposed low level services

Drawing reference: 014_FG Revision: -

Date: 03/03/21 Scale: @A3 1:100 Drawing Status: P

Filename: 014_FG_Proposed low level services

Revision: Description: Date:

PROPOSED KEY:

- Wall mounted IT rack 600x600
- Double power socket
- Double RJ45 outlet
- Single RJ45 @ high level for WI-FI
- Refrigeration/oven appliance power
- Appliance power
- Cleaners Socket @450
- Double power Socket + dual USB outlet
- 16 AMP commando
- Distribution board
- Exterior A/C condenser unit
- Hot water cylinder 550 x 550 x 933 mm h
- Panel heater
- 2 QTY 32mm copex to double back boxes + brush strip covers

- Helmet store
- Battery Charging station
- Hand dryer
- Hand sanitiser
- Paper towel
- Icy wave 500 x 510 x 1030H
- Insect killer
- Safe dose system
- Cleaners cupboard
- TV (Courier Room)

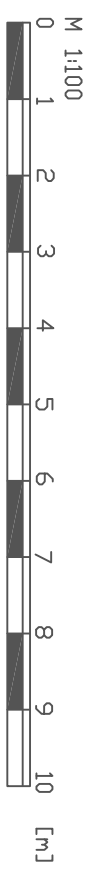
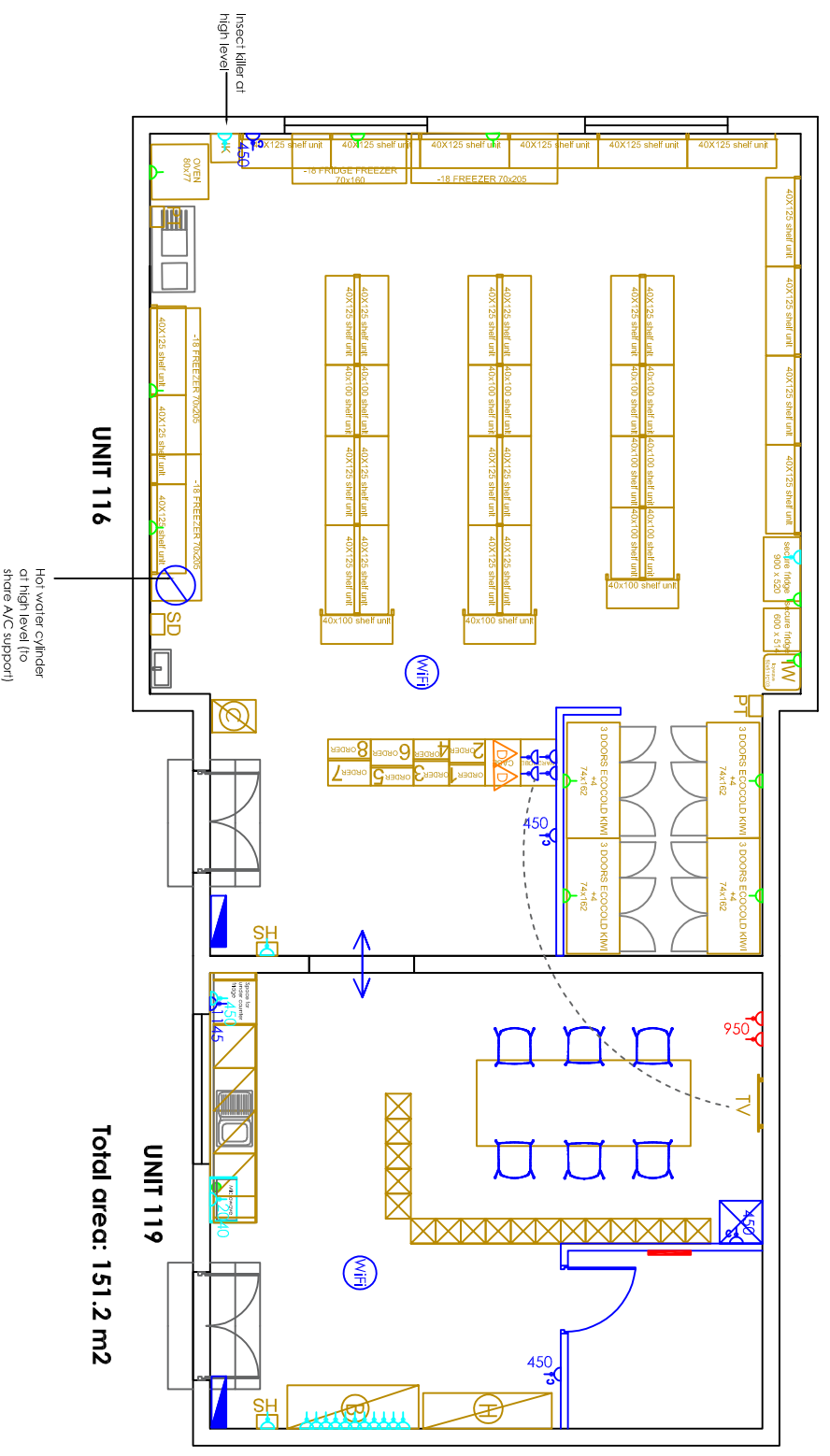
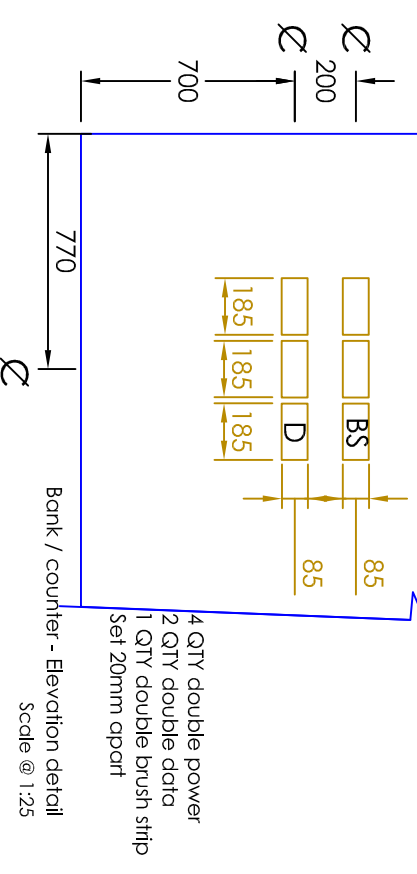

Do not scale from this drawing. All dimensions to be verified on site prior to the commencement of any work or the production of any shop drawing.

This drawing remains the property of Progress, and is not to be disclosed or discussed with any third party without prior written authorization from Progress. All rights reserved.