

All dimensions to be checked on site. Discrepancies, ambiguities and/or omissions between this drawing and information given elsewhere must be reported immediately to head office for clarification before proceeding.

**Legend**

- Site Boundary
- Amenity Grass using EG22 Strong Lawn Grass Mix by Emorgate Seeds or similar, sown at the recommended rate of 25g/m<sup>2</sup>
- Meadow Mix using MGS Meadow Mix by Scotia Seeds or similar, sown at the recommended rate of 3g/m<sup>2</sup>
- Basin - Seeding to sides of swales and basins using E16 Landscape and Embankment Mix by Barenbrug Ltd or similar, sown at the recommended rate of 25-50g/m<sup>2</sup>
- Grass - Coir Matting
- Proposed Trees - 1000x1000x1000mm topsoil
- Woodland Edge Mix - 450mm topsoil laid on 400mm subsoil
- Woodland Planting - 450mm topsoil laid on 400mm subsoil
- Princes Loch - Water Body
- Proposed Submerged Aquatic Mix - Refer to planting plans and schedule
- Proposed Marginal Planting - Refer to planting plans and schedule
- Proposed top and bottom of landform

**Bird Breeding Season and Vegetation Removal**  
It is recommended that vegetation which needs to be removed is done prior to the bird breeding season. [1st March - 31st August] If this is not possible within this period, the vegetation removal should be carried out under the supervision of an Ecologist.  
If birds are found to be breeding in the vegetation which needs to be removed then vegetation removal in the area surrounding the nest must be delayed until the eggs have hatched and the young birds have left the nest.

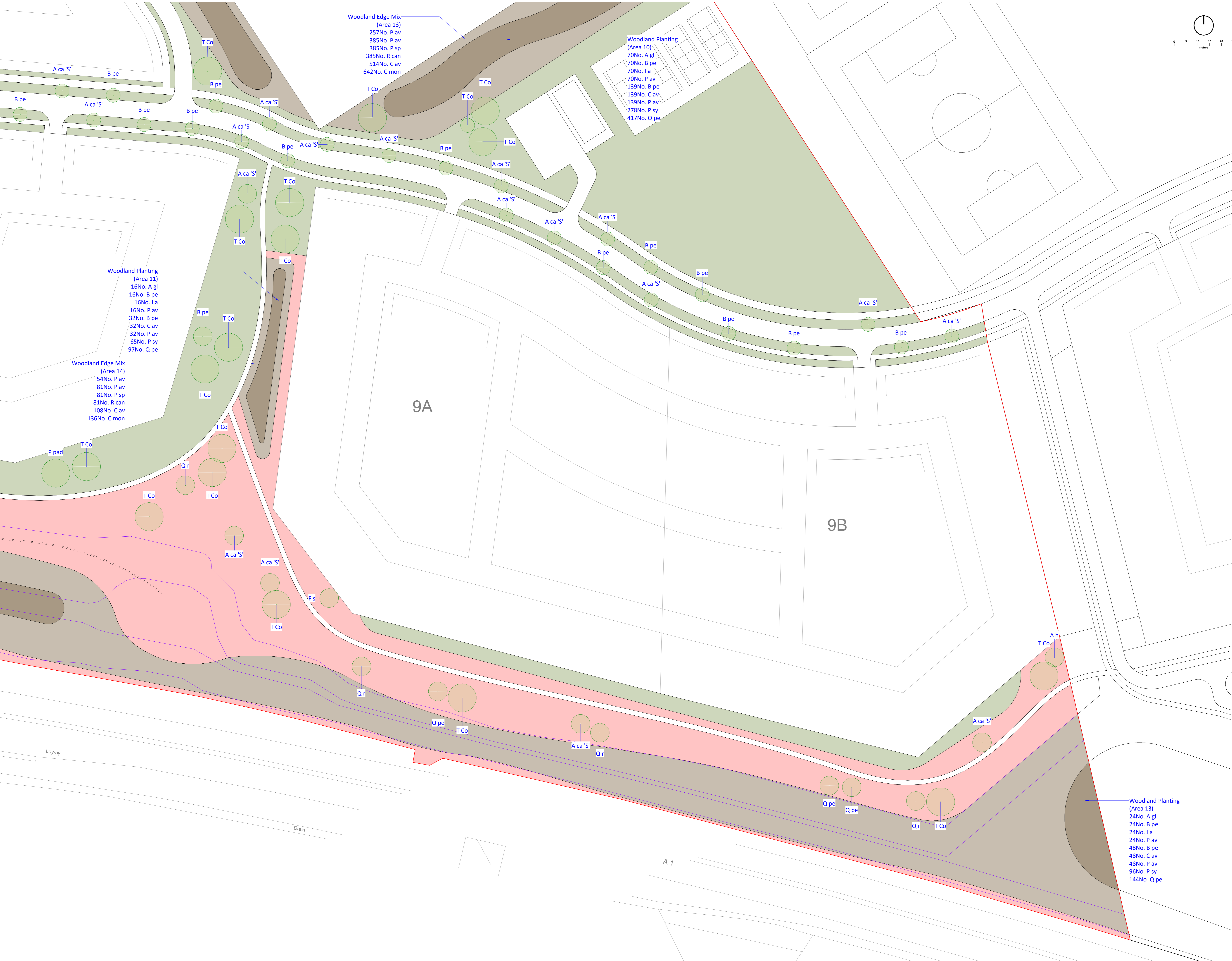

Woodland Edge Mix  
(Area 13)  
257No. P av  
385No. P av  
385No. P sp  
385No. R can  
514No. C av  
642No. C mon

Woodland Planting  
(Area 10)  
70No. A gl  
70No. B pe  
70No. I a  
70No. P av  
139No. B pe  
139No. C av  
139No. P av  
278No. P sy  
417No. Q pe

Woodland Planting  
(Area 11)  
16No. A gl  
16No. B pe  
16No. I a  
16No. P av  
32No. B pe  
32No. C av  
32No. P av  
65No. P sy  
97No. Q pe

Woodland Edge Mix  
(Area 14)  
54No. P av  
81No. P av  
81No. P sp  
81No. R can  
108No. C av  
136No. C mon

Woodland Planting  
(Area 13)  
24No. A gl  
24No. B pe  
24No. I a  
24No. P av  
48No. B pe  
48No. C av  
48No. P sy  
96No. P sy  
144No. Q pe

Revision	Issue	Author	Checked	Date
54	P07	CLO	EMC	26/03/21
54	P06	EMC	EMC	24/03/21
54	P05	DWR	EMC	26/02/21
54	P04	DWR	EMC	18/02/21
54	P03	DWR	EMC	15/02/21
54	P02	DWR	EMC	17/12/20
54	P01	DWR	EMC	15/12/20

**oobe**  
177 W George St, Blenheim Metropolitan Area  
QLD 4207  
www.oobe.co.uk e: info@oobe.co.uk

Client: Hargreaves Services (Blindwells) Ltd  
Project: Blindwells Phase 2

Title: Planting Plan  
Sheet 6

Dwg No: 5301-00B-02-00-DR-L-0008 Scale: 1:500 @ A0  
Revision: P07 Date: December 2020