

All dimensions to be checked on site. Discrepancies, ambiguities and/or omissions between this drawing and information given elsewhere must be reported immediately to head office for clarification before proceeding.

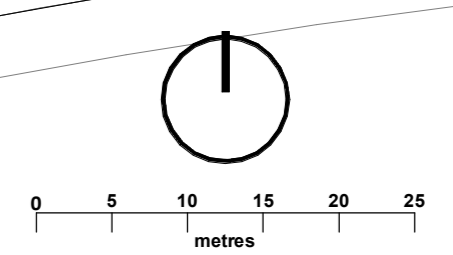

Legend

- Site Boundary
- Amenity Grass using EG22 Strong Lawn Grass Mix by Emargate Seeds or similar, sown at the recommended rate of 25g/m²
- Ornamental Planting
- Meadow Mix using MGS Meadow Mix by Scotia Seeds or similar, sown at the recommended rate of 3g/m²
- Basin - Seeding to sides of swales and basins using E16 Landscape and Embankment Mix by Barenbrug Ltd or similar, sown at the recommended rate of 25-50g/m²
- Grass - Coir Matting
- Proposed Trees - 100x100x1000mm topsoil
- Woodland Edge Mix - 450mm topsoil laid on 400mm subsoil
- Woodland Planting - 450mm topsoil laid on 400mm subsoil
- Princes Loch - Water Body
- Proposed Submerged Aquatic Mix - Refer to planting plans and schedule
- Proposed Marginal Planting - Refer to planting plans and schedule
- Proposed top and bottom of landform

Bird Breeding Season and Vegetation Removal

It is recommended that vegetation which needs to be removed is done prior to the bird breeding season. [1st March - 31st August] If this is not possible within this period, the vegetation removal should be carried out under the supervision of an Ecologist.

If birds are found to be breeding in the vegetation which needs to be removed then vegetation removal in the area surrounding the nest must be delayed until the eggs have hatched and the young birds have left the nest.

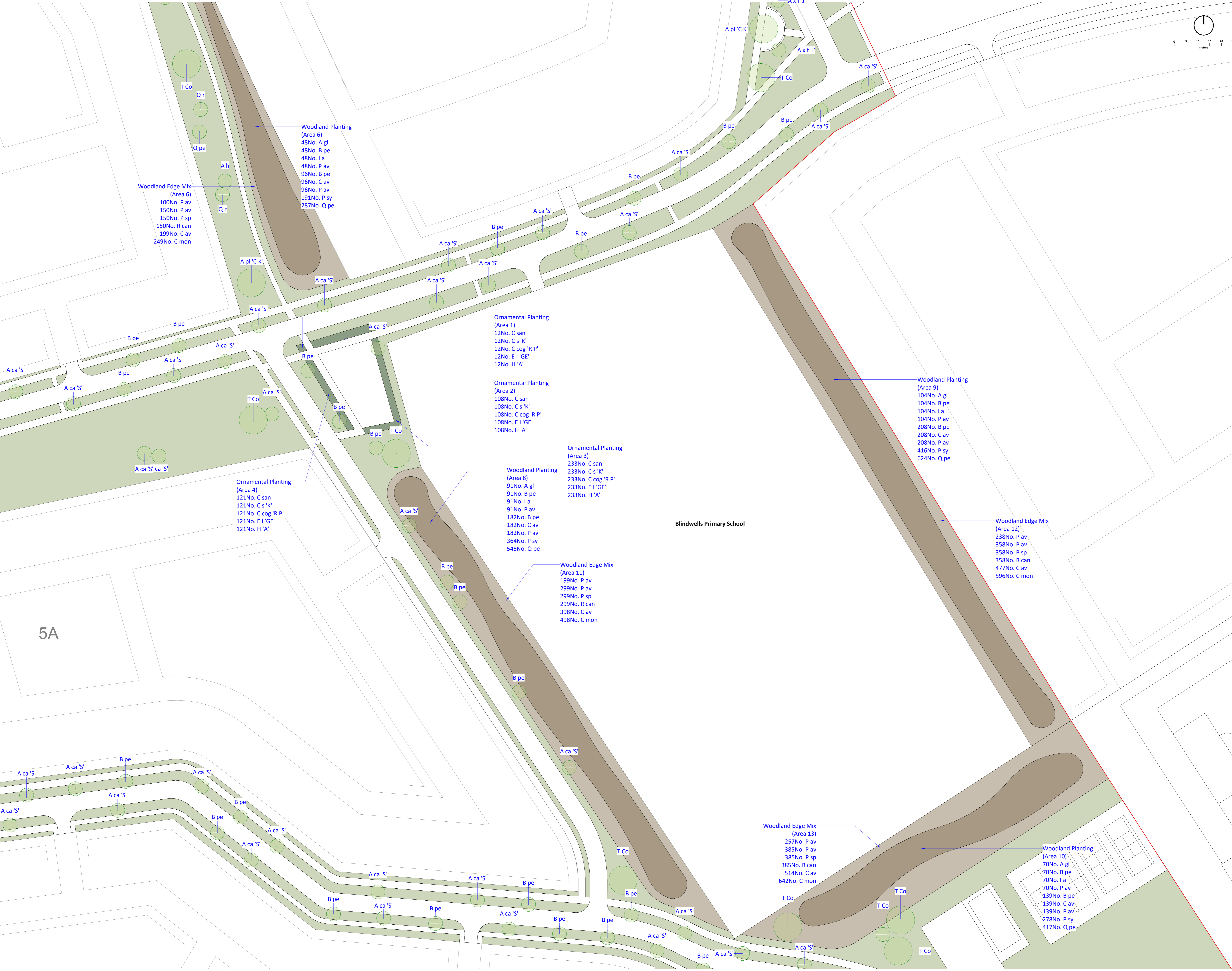

Woodland Planting (Area 6)
 48No. A gl
 48No. B pe
 48No. I a
 48No. P av
 96No. B pe
 96No. C av
 96No. P av
 191No. P sy
 287No. Q pe

Woodland Edge Mix (Area 6)
 100No. P av
 150No. P av
 150No. P sp
 150No. R can
 199No. C av
 249No. C mon

Ornamental Planting (Area 1)
 12No. C san
 12No. C s 'K'
 12No. C cog 'R P'
 12No. E I 'GE'
 12No. H 'A'

Ornamental Planting (Area 2)
 108No. C san
 108No. C s 'K'
 108No. C cog 'R P'
 108No. E I 'GE'
 108No. H 'A'

Ornamental Planting (Area 3)
 233No. C san
 233No. C s 'K'
 233No. C cog 'R P'
 233No. E I 'GE'
 233No. H 'A'

Woodland Planting (Area 8)
 91No. A gl
 91No. B pe
 91No. I a
 91No. P av
 182No. B pe
 182No. C av
 182No. P av
 364No. P sy
 545No. Q pe

Woodland Edge Mix (Area 11)
 199No. P av
 299No. P av
 299No. P sp
 299No. R can
 398No. C av
 498No. C mon

Woodland Planting (Area 9)
 104No. A gl
 104No. B pe
 104No. I a
 104No. P av
 208No. B pe
 208No. C av
 208No. P av
 416No. P sy
 624No. Q pe

Woodland Edge Mix (Area 12)
 238No. P av
 358No. P av
 358No. P sp
 358No. R can
 477No. C av
 596No. C mon

Woodland Edge Mix (Area 13)
 257No. P av
 385No. P av
 385No. P sp
 385No. R can
 514No. C av
 642No. C mon

Woodland Planting (Area 10)
 70No. A gl
 70No. B pe
 70No. I a
 70No. P av
 139No. B pe
 139No. C av
 139No. P av
 278No. P av
 417No. Q pe

5A

Blindwells Primary School

Road layout amended	S4	PO2	EMC	26/02/21	
Drainage shape amended	S4	PO2	EMC	26/02/21	
Path Removed	S4	PO4	DWR	EMC	26/02/21
Site boundary amended	S4	PO3	DWR	EMC	15/02/21
Issued for Planning	S4	PO2	DWR	EMC	11/12/20
Issued for Planning	S4	PO1	DWR	EMC	15/12/20



Client: Hargreaves Services (Blindwells) Ltd
 Project: Blindwells Phase 2
 Title: Planting Plan
 Sheet 4

Dwg No: 5301-00B-02-00-DR-L-0006 Scale: 1:500 @ A0
 Revision: P06 Date: December 2020

PLANNING