

3AB

3BB

5B

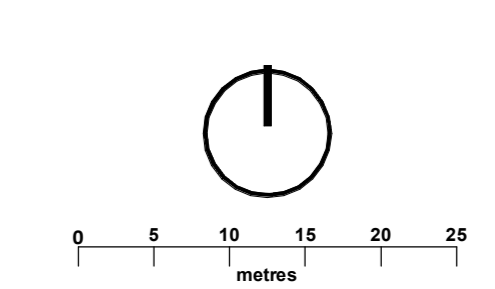

- All dimensions to be checked on site. Discrepancies, ambiguities and/or omissions between this drawing and information given elsewhere must be reported immediately to head office for clarification before proceeding.
- Legend**
- Site Boundary
 - Amenity Grass using EG22 Strong Lawn Grass Mix by Enmorgate Seeds or similar, sown at the recommended rate of 25g/m²
 - Meadow Mix using MGS Meadow Mix by Scotia Seeds or similar, sown at the recommended rate of 3g/m²
 - Seeding to sides of swales and basins using E16 Landscape and Embankment Mix by Barenbrug Ltd or similar, sown at the recommended rate of 25-50g/m²
 - Proposed Trees - 1000x1000x1000mm topsoil
 - Woodland Edge Mix - 450mm topsoil laid on 400mm subsoil
 - Woodland Planting - 450mm topsoil laid on 400mm subsoil
 - Princes Loch - Water Body
 - Proposed Submerged Aquatic Mix - Refer to planting plans and schedule
 - Proposed Marginal Planting - Refer to planting plans and schedule
 - Proposed top and bottom of landform

Bird Breeding Season and Vegetation Removal

It is recommended that vegetation which needs to be removed is done prior to the bird breeding season (1st March - 31st August) if this is not possible within this period, the vegetation removal should be carried out under the supervision of an Ecologist.

If birds are found to be breeding in the vegetation which needs to be removed then vegetation removal in the area surrounding the nest must be delayed until the eggs have hatched and the young birds have left the nest.

Woodland Planting (Area 11)
 16No. A gl
 16No. B pe
 16No. I a
 16No. P av
 32No. B pe
 32No. C av
 32No. P av
 65No. P sy
 97No. Q pe

Woodland Edge Mix (Area 14)
 54No. P av
 81No. P av
 81No. P sp
 108No. C av
 136No. C mon

Woodland Planting (Area 12)
 91No. A gl
 91No. B pe
 91No. I a
 91No. P av
 182No. B pe
 182No. C av
 182No. P av
 365No. P sy
 547No. Q pe

Woodland Edge Mix (Area 15)
 1646No. P av
 2469No. P av
 2469No. P sp
 2469No. R can
 3291No. C av
 4114No. C mon

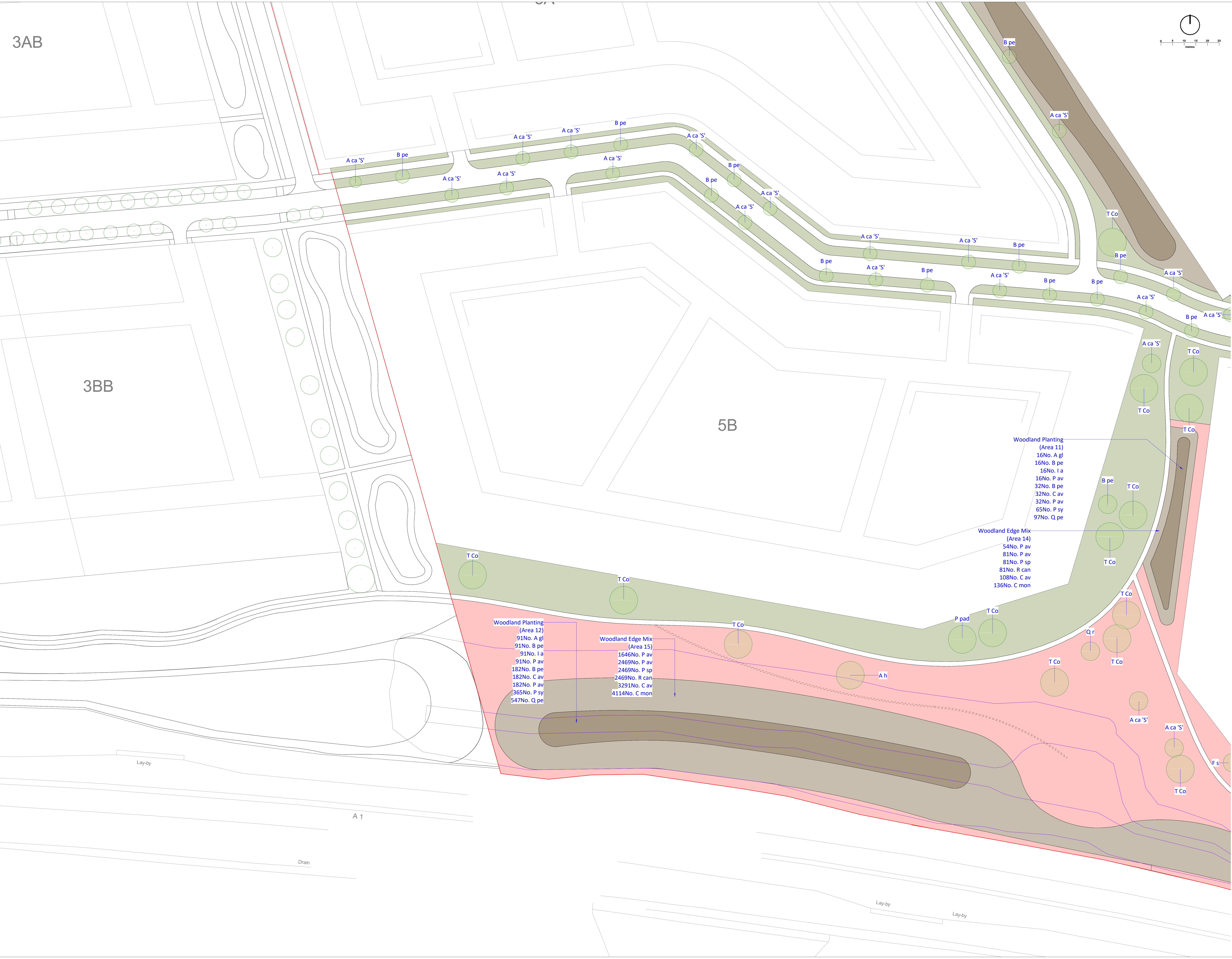

Path Removed	S4	PO4	DWR	EMC	24/02/21
Site Boundary amended	S4	PO3	DWR	EMC	15/02/21
Issued for Planning	S4	PO2	DWR	EMC	12/12/20
Issued for Planning	S4	PO1	DWR	EMC	15/12/20
Revision					

15th Floor, 1, Broadwalk Drive, London, W14 8JH
 Tel: +44 (0)20 875 3175
 Fax: +44 (0)20 875 3176
 Email: info@oobe.co.uk
 www.oobe.co.uk

Client: Hargreaves Services (Blindwells) Ltd
 Project: Blindwells Phase 2
 Title: Planting Plan Sheet 5
 Dwg No: 5301-OOB-02-00-DR-L-0007 Scale: 1:500@A0
 Revision: PO4 Date: December 2020