

3AB

3BB

5B

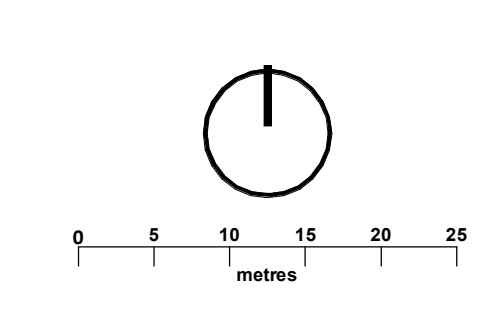

- All dimensions to be checked on site. Discrepancies, ambiguities and/or omissions between this drawing and information given elsewhere must be reported immediately to head office for clarification before proceeding.
- Legend**
- Site Boundary
  - Amenity Grass using EG22 Strong Lawn Grass Mix by Emorgate Seeds or similar, sown at the recommended rate of 25g/m<sup>2</sup>
  - Meadow Mix using MGS Meadow Mix by Scotia Seeds or similar, sown at the recommended rate of 3g/m<sup>2</sup>
  - Basin - Seeding to sides of swales and basins using E16 Landscape and Embankment Mix by Barenbrug Ltd or similar, sown at the recommended rate of 25-50g/m<sup>2</sup>
  - Grass - Coir Matting
  - Proposed Trees - 1000x1000x1000mm topsoil
  - Woodland Edge Mix - 450mm topsoil laid on 400mm subsoil
  - Woodland Planting - 450mm topsoil laid on 400mm subsoil
  - Princes Loch - Water Body
  - Proposed Submerged Aquatic Mix - Refer to planting plans and schedule
  - Proposed Marginal Planting - Refer to planting plans and schedule
  - Proposed top and bottom of landform

**Bird Breeding Season and Vegetation Removal**

It is recommended that vegetation which needs to be removed is done prior to the bird breeding season. [1st March - 31st August] If this is not possible within this period, the vegetation removal should be carried out under the supervision of an Ecologist.

If birds are found to be breeding in the vegetation which needs to be removed then vegetation removal in the area surrounding the nest must be delayed until the eggs have hatched and the young birds have left the nest.

Woodland Planting (Area 11)  
 16No. A gl  
 16No. B pe  
 16No. I a  
 16No. P av  
 32No. B pe  
 32No. C av  
 32No. P av  
 65No. P sy  
 97No. Q pe

Woodland Edge Mix (Area 14)  
 54No. P av  
 81No. P av  
 81No. P sp  
 81No. R can  
 108No. C av  
 136No. C mon

Woodland Planting (Area 12)  
 91No. A gl  
 91No. B pe  
 91No. I a  
 91No. P av  
 182No. B pe  
 182No. C av  
 182No. P av  
 365No. P sy  
 547No. Q pe

Woodland Edge Mix (Area 15)  
 1646No. P av  
 2469No. P av  
 2469No. P sp  
 2469No. R can  
 3291No. C av  
 4114No. C mon

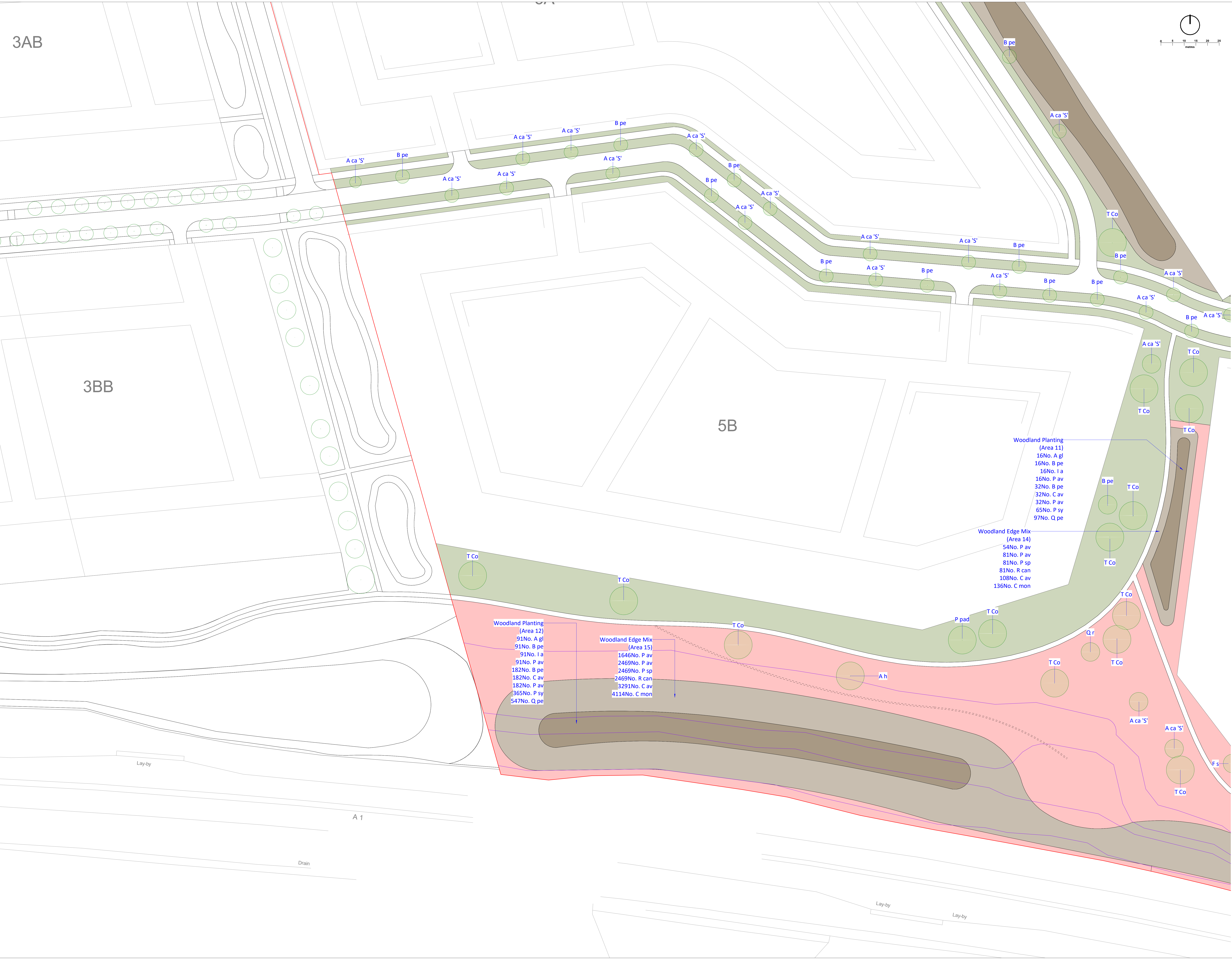

Revision	Date	By	Checked	Approved
Road layout amended	26/09/21	SA	PO6	CLO
Dry basin shape amended	26/09/21	SA	PO6	EMC
Path removed	26/09/21	SA	PO6	DWR
Site boundary amended	15/02/21	SA	PO3	DWR
Issued for Planning	13/12/20	SA	PO2	DWR
Issued for Planning	15/12/20	SA	PO1	DWR

Author	Designer	Checker	Approver
SA	PO6	CLO	EMC

oobe  
 177 George St, Edinburgh, Scotland  
 011 44 (0)20 479 2849  
 www.oobe.co.uk

Client: Hargreaves Services (Blindwells) Ltd  
 Project: Blindwells Phase 2  
 Title: Planting Plan Sheet 5  
 Dwg No: 5301-OOB-02-00-DR-L-0007 Scale: 1:500 @ A0  
 Revision: PO6 Date: December 2020