

**Heritage statement and justification to accompany Planning application for replacement windows**

**Cox Hill Cottage  
Cox Hill  
Boxford  
CO10 5HR**



Cox hill cottage is situated within the conservation area of Boxford. It is sited in the centre of a group of 3 detached cottages built around the same time. Estimated to be late C 19<sup>th</sup> Century. Each of the 3 cottages have had previous alterations which has resulted in the front facades all being different. Cox Hill Cottage is constructed with face brick (which has been painted) under an old clay pan tile roof.



The properties surrounding these 3 cottages are all modern development, along Brook Hall Road, which is opposite and various designs either side.



The homeowner would like to replace the windows within the cottage. The existing windows are timber with a double glazed units. These windows are not original to the house and look to be 1980's replacements. Although these windows have double glazed units the cavity is very small and offer little thermal benefit. The frames themselves are drafty and do not provide the modern security that the homeowner requires.

Consideration has been made to the current window design and that of the cottages either side. As all 3 are different, both in colour and design, the homeowner would like to make a small adjustment to the design (removing the small fanlight) and changing the colour.

The proposed windows are 'Smart Systems' Aluminium heritage windows, manufactured by Hadleigh Glass Ltd. The external colour required is 'Painswick Grey' which is RAL 7038



Ral 7038 Painswick



Existing bay windows



Existing dormer windows



## Proposed replacements

2 x bay windows on front ground floor

2 x dormer windows on front 1<sup>st</sup> floor

2 x casement windows on ground floor side passage (not visible from the front)

## Smarts heritage casement windows

Pos. 001, Quantity: 2  
Bed 2 & Bed 3  
Job: Caroline Wood - Windows  
System: SMA Alitherm Heritage Square (W20170)  
Exterior View

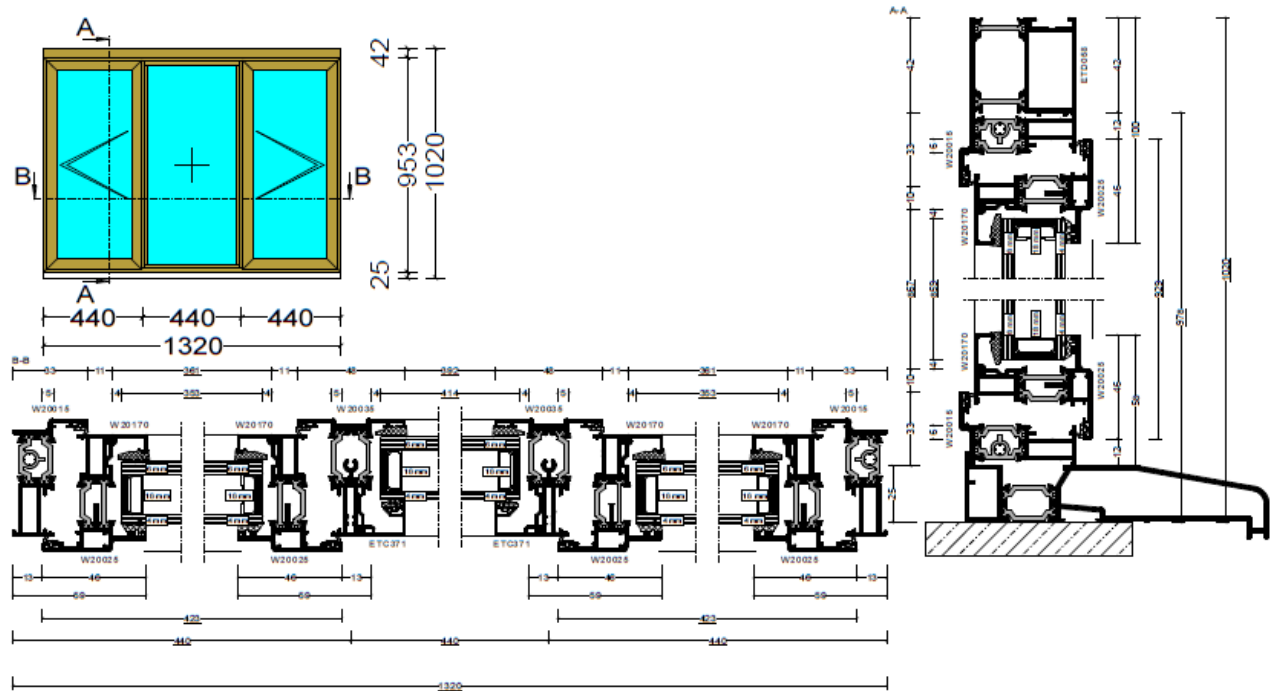

Pos. 003, Quantity: 4

Bay Returns

Job: Caroline Wood - Windows

System: SMA Allthem Heritage Square (W20170)

Exterior View

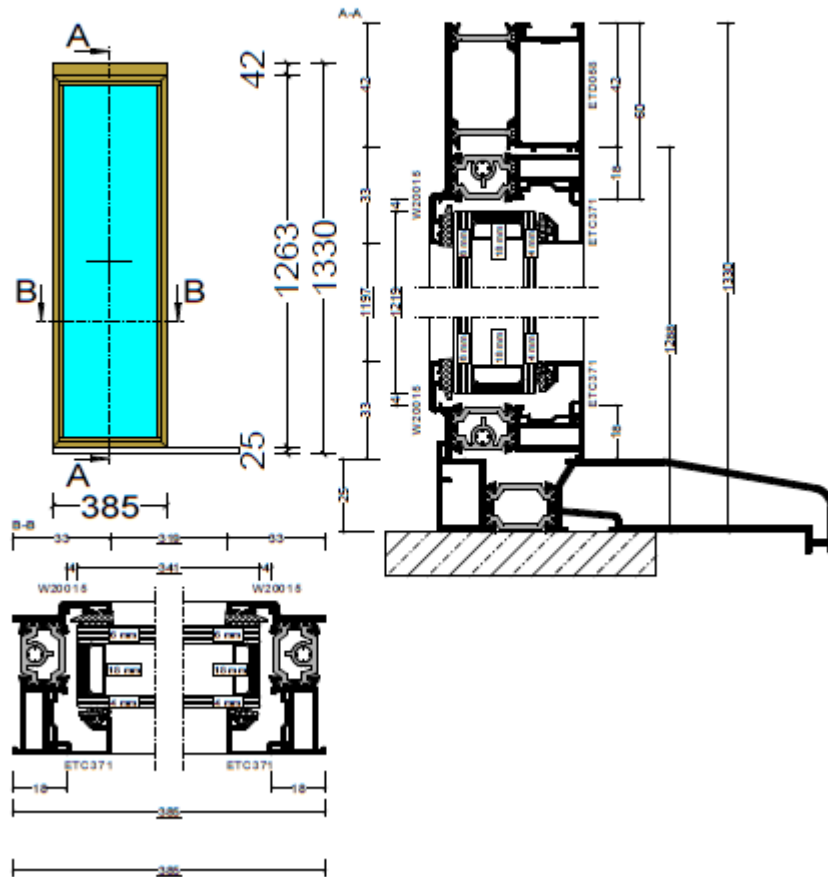

Technical drawing of a window frame showing front, side, and cross-section views with dimensions in mm.

**Front View:** The window frame is 620 mm wide and 910 mm high. It features a top sash with a triangular mullion and a bottom sash with a cross mullion. The frame is labeled with 'A' and 'B' at the corners.

**Side View:** The side view shows the frame's depth, with a total width of 101 mm. The top sash is 42 mm deep, and the bottom sash is 13 mm deep. The frame is labeled with 'A' and 'B' at the corners.

**Cross-sections:** The drawing includes several cross-sections of the frame, labeled with 'W20015', 'W20170', 'W20025', 'W20035', 'W20045', and 'W20055'. These sections show the internal structure, including the mullions and the frame's profile. The cross-sections are labeled with 'A' and 'B' at the corners.

**Dimensions:** The drawing includes various dimensions in mm, such as 620, 910, 455, 42, 13, 101, 25, 843, 11, 32, 33, 34, 35, 36, 37, 38, 39, 40, 41, 42, 43, 44, 45, 46, 47, 48, 49, 50, 51, 52, 53, 54, 55, 56, 57, 58, 59, 60, 61, 62, 63, 64, 65, 66, 67, 68, 69, 70, 71, 72, 73, 74, 75, 76, 77, 78, 79, 80, 81, 82, 83, 84, 85, 86, 87, 88, 89, 90, 91, 92, 93, 94, 95, 96, 97, 98, 99, 100, 101, 102, 103, 104, 105, 106, 107, 108, 109, 110, 111, 112, 113, 114, 115, 116, 117, 118, 119, 120, 121, 122, 123, 124, 125, 126, 127, 128, 129, 130, 131, 132, 133, 134, 135, 136, 137, 138, 139, 140, 141, 142, 143, 144, 145, 146, 147, 148, 149, 150, 151, 152, 153, 154, 155, 156, 157, 158, 159, 160, 161, 162, 163, 164, 165, 166, 167, 168, 169, 170, 171, 172, 173, 174, 175, 176, 177, 178, 179, 180, 181, 182, 183, 184, 185, 186, 187, 188, 189, 190, 191, 192, 193, 194, 195, 196, 197, 198, 199, 200, 201, 202, 203, 204, 205, 206, 207, 208, 209, 210, 211, 212, 213, 214, 215, 216, 217, 218, 219, 220, 221, 222, 223, 224, 225, 226, 227, 228, 229, 230, 231, 232, 233, 234, 235, 236, 237, 238, 239, 240, 241, 242, 243, 244, 245, 246, 247, 248, 249, 250, 251, 252, 253, 254, 255, 256, 257, 258, 259, 260, 261, 262, 263, 264, 265, 266, 267, 268, 269, 270, 271, 272, 273, 274, 275, 276, 277, 278, 279, 280, 281, 282, 283, 284, 285, 286, 287, 288, 289, 290, 291, 292, 293, 294, 295, 296, 297, 298, 299, 300, 301, 302, 303, 304, 305, 306, 307, 308, 309, 310, 311, 312, 313, 314, 315, 316, 317, 318, 319, 320, 321, 322, 323, 324, 325, 326, 327, 328, 329, 330, 331, 332, 333, 334, 335, 336, 337, 338, 339, 340, 341, 342, 343, 344, 345, 346, 347, 348, 349, 350, 351, 352, 353, 354, 355, 356, 357, 358, 359, 360, 361, 362, 363, 364, 365, 366, 367, 368, 369, 370, 371, 372, 373, 374, 375, 376, 377, 378, 379, 380, 381, 382, 383, 384, 385, 386, 387, 388, 389, 390, 391, 392, 393, 394, 395, 396, 397, 398, 399, 400, 401, 402, 403, 404, 405, 406, 407, 408, 409, 410, 411, 412, 413, 414, 415, 416, 417, 418, 419, 420, 421, 422, 423, 424, 425, 426, 427, 428, 429, 430, 431, 432, 433, 434, 435, 436, 437, 438, 439, 440, 441, 442, 443, 444, 445, 446, 447, 448, 449, 450, 451, 452, 453, 454, 455, 456, 457, 458, 459, 460, 461, 462, 463, 464, 465, 466, 467, 468, 469, 470, 471, 472, 473, 474, 475, 476, 477, 478, 479, 480, 481, 482, 483, 484, 485, 486, 487, 488, 489, 490, 491, 492, 493, 494, 495, 496, 497, 498, 499, 500, 501, 502, 503, 504, 505, 506, 507, 508, 509, 510, 511, 512, 513, 514, 515, 516, 517, 518, 519, 520, 521, 522, 523, 524, 525, 526, 527, 528, 529, 530, 531, 532, 533, 534, 535, 536, 537, 538, 539, 540, 541, 542, 543, 544, 545, 546, 547, 548, 549, 550, 551, 552, 553, 554, 555, 556, 557, 558, 559, 560, 561, 562, 563, 564, 565, 566, 567, 568, 569, 570, 571, 572, 573, 574, 575, 576, 577, 578, 579, 580, 581, 582, 583, 584, 585, 586, 587, 588, 589, 590, 591, 592, 593, 594, 595, 596, 597, 598, 599, 600, 601, 602, 603, 604, 605, 606, 607, 608, 609, 610, 611, 612, 613, 614, 615, 616, 617, 618, 619, 620, 621, 622, 623, 624, 625, 626, 627, 628, 629, 630, 631, 632, 633, 634, 635, 636, 637, 638, 639, 640, 641, 642, 643, 644, 645, 646, 647, 648, 649, 650, 651, 652, 653, 654, 655, 656, 657, 658, 659, 660, 661, 662, 663, 664, 665, 666, 667, 668, 669, 670, 671, 672, 673, 674, 675, 676, 677, 678, 679, 680, 681, 682, 683, 684, 685, 686, 687, 688, 689, 690, 691, 692, 693, 694, 695, 696, 697, 698, 699, 700, 701, 702, 703, 704, 705, 706, 707, 708, 709, 710, 711, 712, 713, 714, 715, 716, 717, 718, 719, 720, 721, 722, 723, 724, 725, 726, 727, 728, 729, 730, 731, 732, 733, 734, 735, 736, 737, 738, 739, 740, 741, 742, 743, 744, 745, 746, 747, 748, 749, 750, 751, 752, 753, 754, 755, 756, 757, 758, 759, 760, 761, 762, 763, 764, 765, 766, 767, 768, 769, 770, 771, 772, 773, 774, 775, 776, 777, 778, 779, 780, 781, 782, 783, 784, 785, 786, 787, 788, 789, 790, 791, 79

Pos. 004, Quantity: 2  
 Bay Fronts  
 Job: Caroline Wood - Windows  
 System: SMA Altherm Heritage Square (W20170)  
 Exterior View

