

Floor Assembly:
Existing drainage is 13.33 L/Sec. Proposed discharge to be 30% less than existing in order to comply with Brownfield development guidelines
New proposed discharge 9.30 L/Sec.

Proposed impermeable area 960m², same as existing area

Concrete bed and surround (150mm thick) to drain runs in trafficked areas with less than 1.2m cover.





Storage:
Existing drainage is 13.88 L/Sec. Proposed discharge to be 30% less than existing in order to comply with Brownfield development guidelines
New proposed discharge 9.71 L/Sec.

Proposed impermeable area 1000m², same as existing area

Concrete bed and surround (150mm thick) to drain runs in trafficked areas with less than 1.2m cover.

Notes-
This drawing is copyright and must not be copied in part or in whole unless agreed with Avie Consulting Ltd
All dimensions are in millimetres unless noted otherwise
DO NOT SCALE THIS DRAWING - IF IN DOUBT ASK

- All dimensions & levels to be checked by the contractor prior to commencement of work, any discrepancy shall be reported immediately to Avie Consulting Ltd
- All work shall be carried out in accordance with Local Authority, statutory authority, health & safety requirements and regulations.
- The drawings shall be read in accordance with all other contract documents relevant at that time of issue and during the period of the contract.
- The contractor must ensure the overall stability of the works is adequate at all stages of the construction.
- No allowance has been made for cutouts, holes, notches, etc. for services. All of these are to be agreed prior to the start of the works.

KEY:
 PROPOSED SURFACE WATER DRAIN
 PROPOSED FOUL WATER DRAIN
 EXISTING SW DRAIN
 EXISTING FOUL DRAIN
 EXISTING COMBINED DRAIN

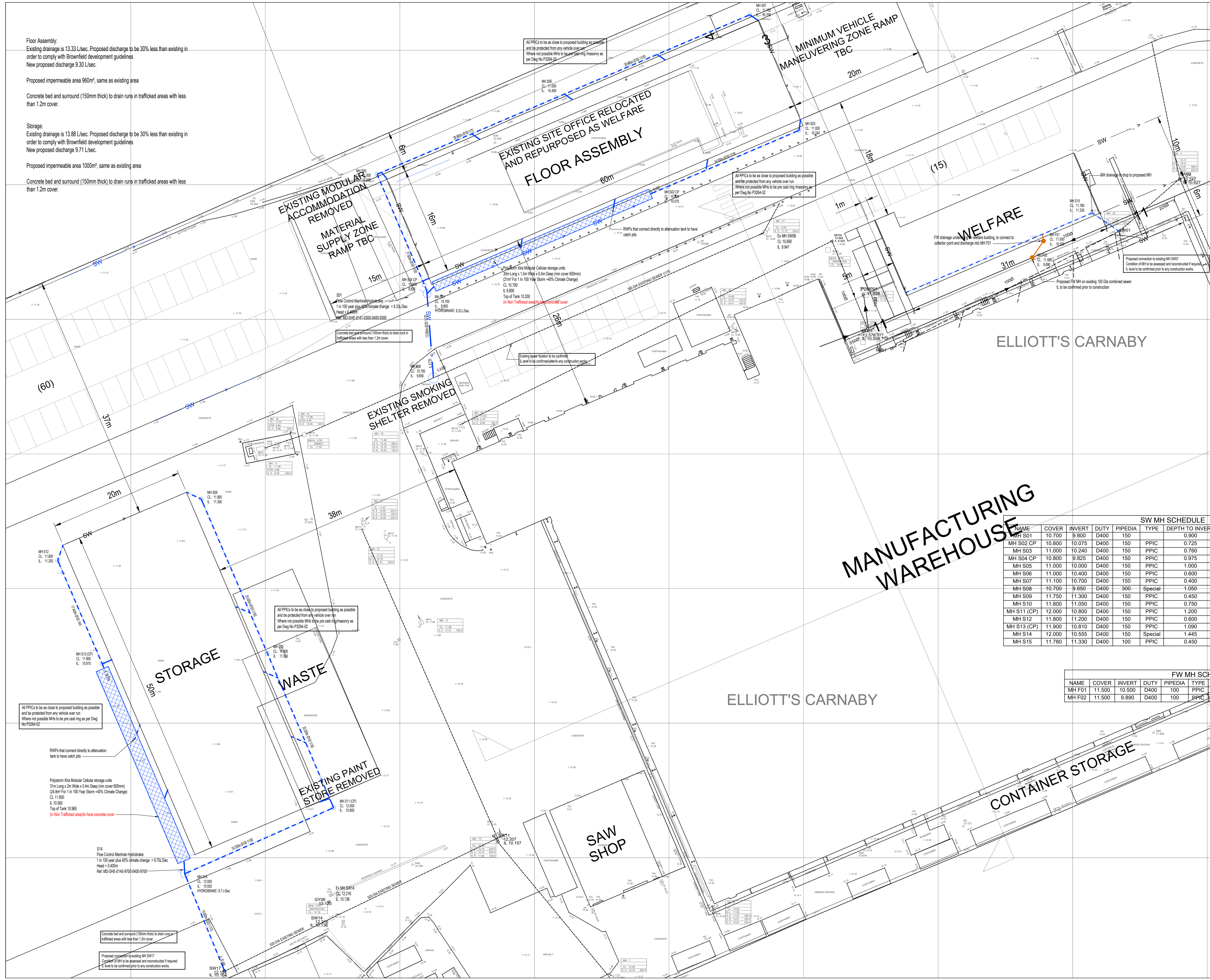

SW MH SCHEDULE

NAME	COVER	INVERT	DUTY	PIPEDIA	TYPE	DEPTH TO INVERT	DEPTH TO SOFFIT	Diameter	HYDROBRAKE
MH S01	10.700	9.800	D400	150	PPIC	0.900	0.750	1.200	9.33 L/Sec
MH S02 CP	10.800	10.075	D400	150	PPIC	0.725	0.575	0.600	
MH S03	11.000	10.240	D400	150	PPIC	0.760	0.610	0.600	
MH S04 CP	10.800	9.825	D400	150	PPIC	0.975	0.825	0.600	
MH S05	11.000	10.000	D400	150	PPIC	1.000	0.850	0.600	
MH S06	11.000	10.400	D400	150	PPIC	0.600	0.450	0.600	
MH S07	11.100	10.700	D400	150	PPIC	0.400	0.250	0.600	
MH S08	10.700	9.650	D400	300	Special	1.050	0.750	1.500	
MH S09	11.750	11.300	D400	150	PPIC	0.450	0.300	0.600	
MH S10	11.800	11.050	D400	150	PPIC	0.750	0.600	0.600	
MH S11 (CP)	12.000	10.800	D400	150	PPIC	1.200	1.050	0.600	
MH S12	11.800	11.200	D400	150	PPIC	0.600	0.450	0.600	
MH S13 (CP)	11.900	10.810	D400	150	PPIC	1.090	0.940	0.600	
MH S14	12.000	10.555	D400	150	Special	1.445	1.295	1.200	9.7 L/Sec
MH S15	11.780	11.330	D400	100	PPIC	0.450	0.350	0.600	

FW MH SCHEDULE

NAME	COVER	INVERT	DUTY	PIPEDIA	TYPE	DEPTH TO INVERT	DEPTH TO SOFFIT	Diameter
MH F01	11.500	10.500	D400	100	PPIC	1.000	0.900	0.600
MH F02	11.500	9.890	D400	100	PPIC	1.610	1.510	0.600

C01	Construction Issue	P.A.S.	P.A.S.	01/04/2021
B	Check dimensions added	P.A.S.	P.A.S.	31/03/2021
A	Updated and revised to match proposed building positions and sizes	P.A.S.	P.A.S.	30/03/2021
0	Initial issue	P.A.S.	P.A.S.	28/03/2021
Rev	Details	By	Chk	Date

6 Killingbeck Court,
Killingbeck Office Village,
Killingbeck Drive,
Leeds LS14 6FD.
Tel: 0113 249 7416
www.avie-consulting.co.uk



Client: Elliott Off-Site Solutions

Project: Carnaby Manufacturing Site Improvements

Title: Proposed Drainage Layout

Drawn: P.A.S. Checked: S.A.B. Date: Mar 2021 Scale: 1:250 Original Dwg size: A1

Drawing Number: FACT-AVE-ZZ-XX-DR-D-00001 Rev: C01