

PROPOSED BLOCK PLAN
1 : 200

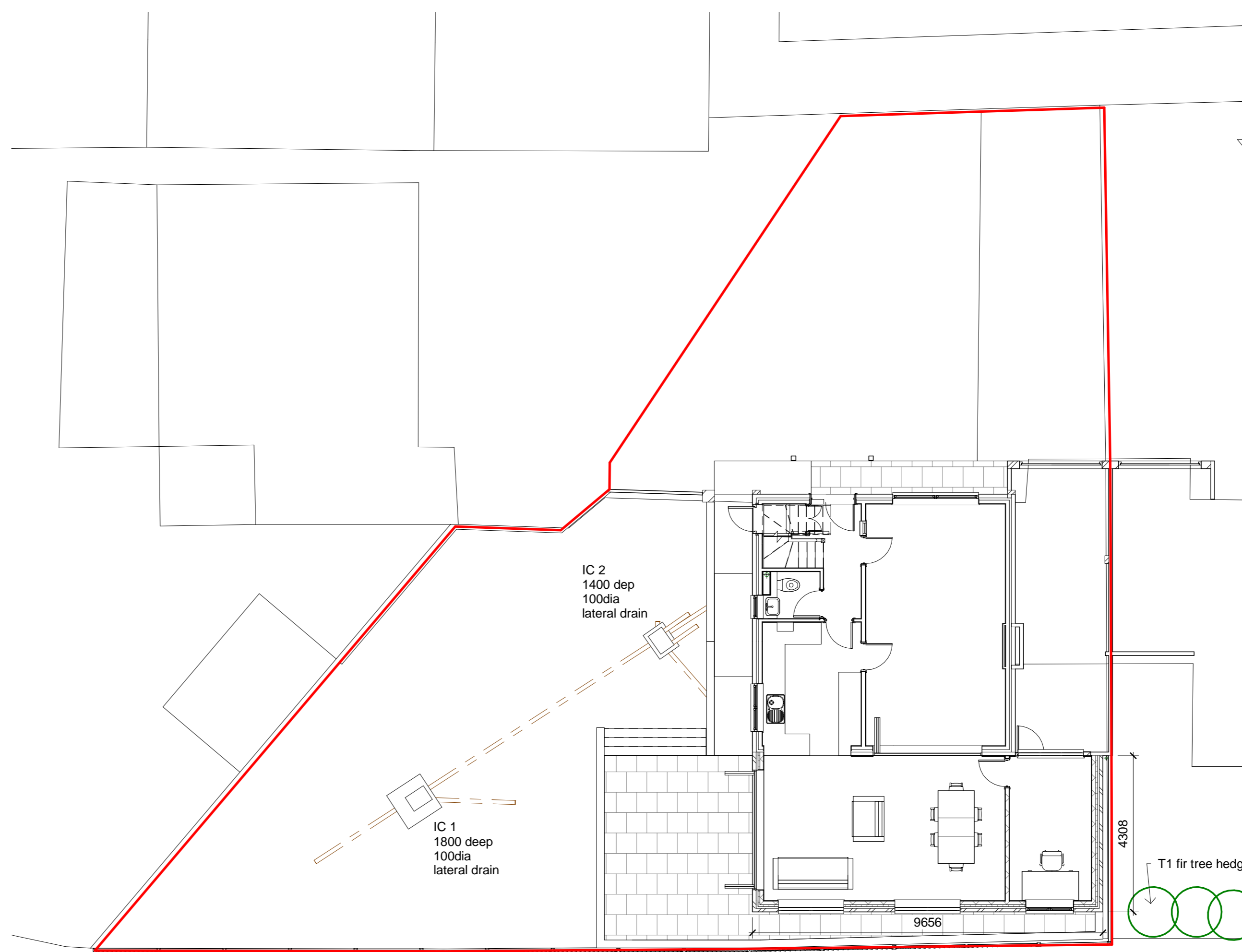

PROPOSED SITE PLAN
1 : 100

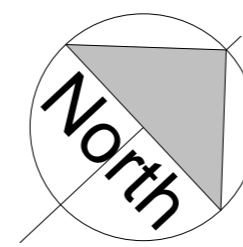
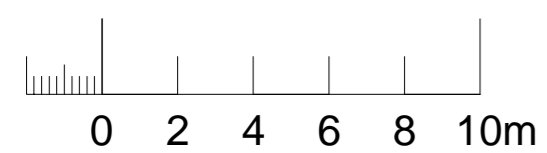
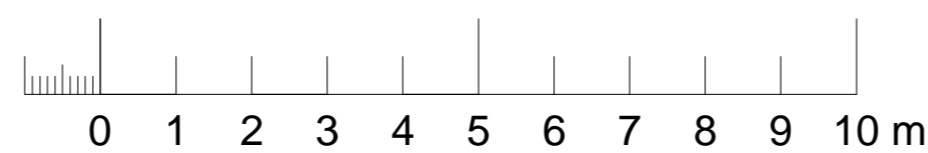

DO NOT SCALE FROM THIS DRAWING FOR CONSTRUCTION PURPOSES

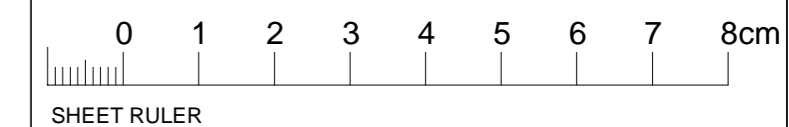

Rev	Date	Description
A	17/02/21	Revised in accordance with client meeting
B	06/04/21	Patio revised, bifolds and kitchen units updated

Rev	Date	Description
A	17/02/21	Revised in accordance with client meeting
B	06/04/21	Patio revised, bifolds and kitchen units updated

PROPOSED EXTENSION

71 NORWOOD ROAD
EFFINGHAM
LEATHERHEAD
KT24 5NU

**PROPOSED SITE AND
BLOCK PLANS**

DONOVAN HEWITT

chartered architects
The Theatre, 7 Church Street, Leatherhead
Surrey, KT22 8DN
tel: 01372 376236 fax: 01372 363058
email: donovan.hewitt@btconnect.com

Date	Status	Drawn by	Author	Checked by	Checker

Scale @ A1 As indicated

Project No	Drg No	Rev
1096-03-05		B