

REAR ELEVATION

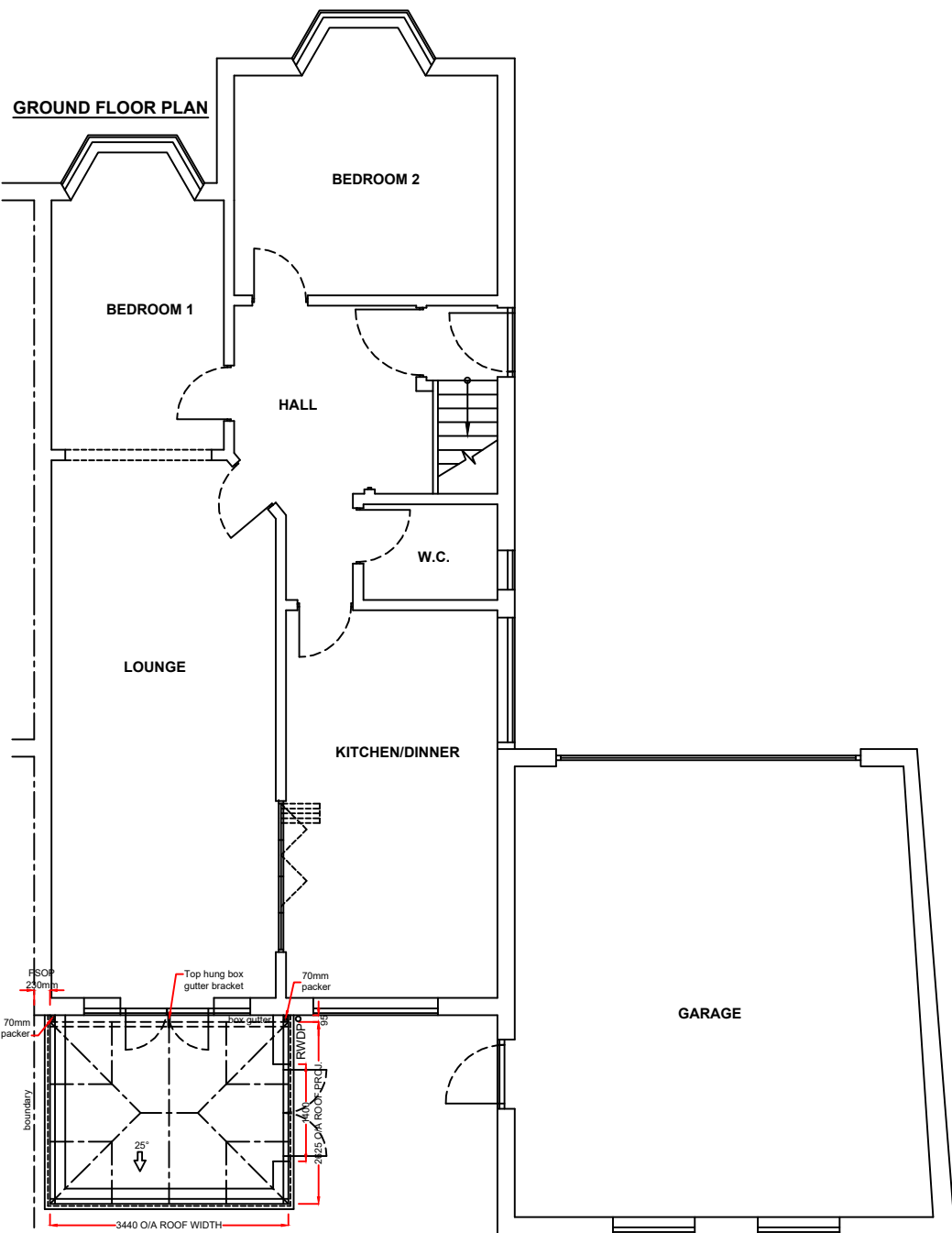

LEFT HAND SIDE ELEVATION

Overall double door walk-through  
1182mm, primary door walk-through  
556mm. These are approximate sizes.



GROUND FLOOR PLAN

**Product Specification:**

**Roof:**  
 Roof Type: **Aluminium Rafter with PVCu Capping**  
 Roof Glazing: Solarroof Glass  
 Obscure Glass: N/A  
 Roof external colour: **WHITE**  
 Roof Internal colour: **WHITE**

**Frames/Doors:**

Frame type: **High Impact PVCu Mainframe**  
 External Colour : **WHITE**  
 Internal Colour : **WHITE**

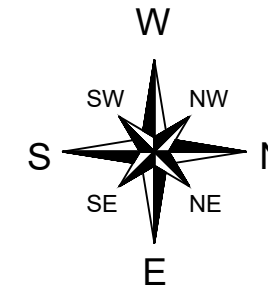

**Notes:**

Any drawings or plans depicted make no allowance for the provision of any tie bars within the roof of the proposed Living space. This can only be determined once the roof is put into manufacture.

Existing physical barrier to remain

These drawings are the property of Anglian Home Improvements and must not be used, distributed, loaned or copied without the express permission of Anglian Home Improvements.  
 All dimensions are in millimetres (mm) unless noted otherwise.  
 Do not use for base laying purposes

Produced on A3 paper

Rev.	Date	Description	Initials



Drawing title: <b>Proposed Plan and Elevations</b>		
Contract No. : <b>900-07424</b>	Page 2 of 2	
Proposed At:	<b>PVCu Conservatory</b> 96 LINKS WAY CROXLEY GREEN RICKMANSWORTH, HERTFORDSHIRE WD3 3RN	
Drawers initials: <b>A.S.</b>	Scale : <b>1:100</b>	Date: <b>31/03/21</b>

