

ELECTRICAL

Any sockets on the wall to be removed require to be re-located in the area of origin

If not already existing the minimum number of 13A socket outlets to be provided is as follows

- a) 4 within the dining area and
- b) 6 within the kitchen, at least 3 of which should be situated above worktop level in addition to any outlets provided for floor standing white goods or built in appliances

socket may be installed as single or double outlets, to give the recommended number of outlets in each space

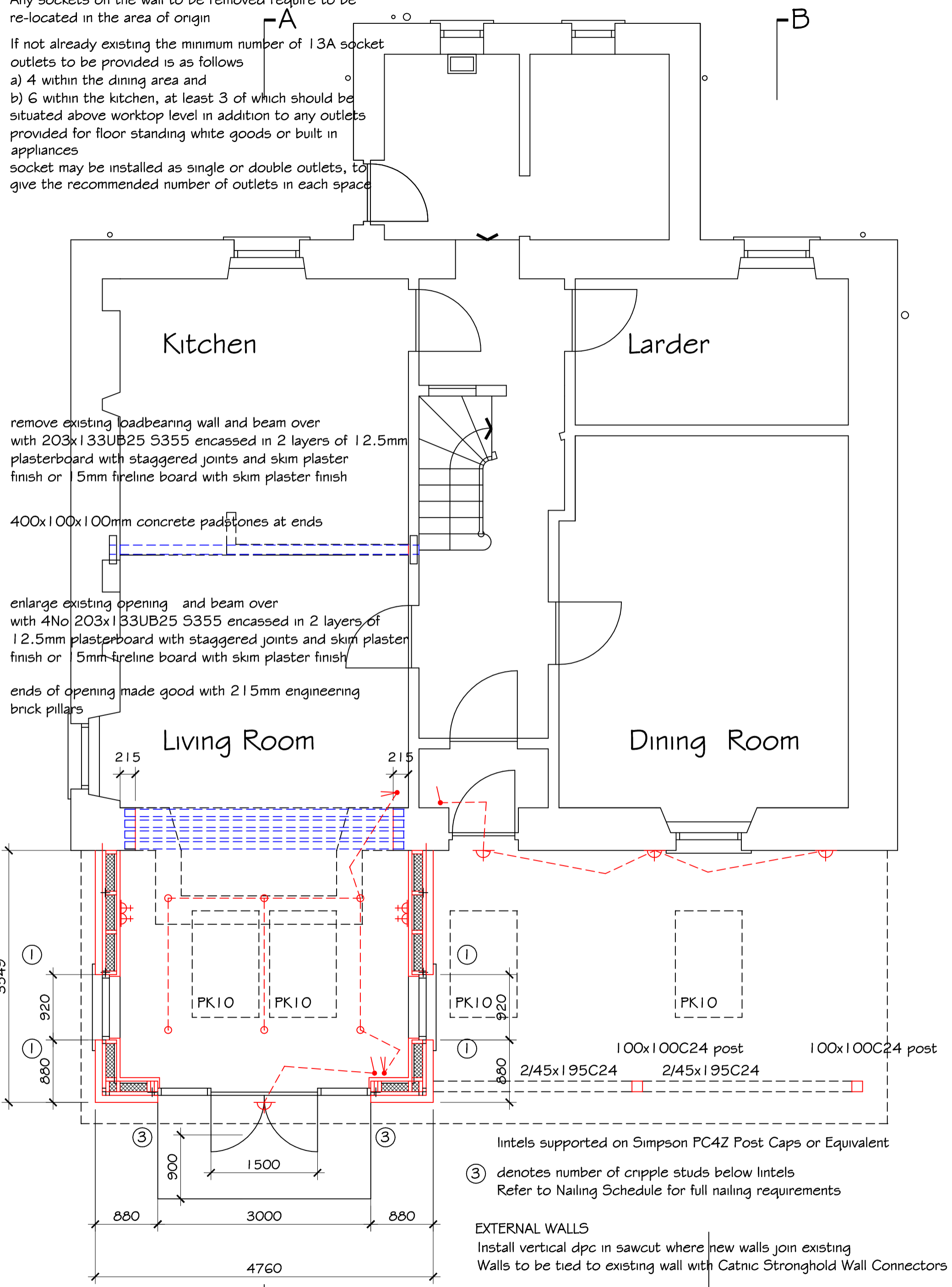

remove existing loadbearing wall and beam over with 203x133UB25 S355 encased in 2 layers of 12.5mm plasterboard with staggered joints and skim plaster finish or 15mm fireline board with skim plaster finish

400x100x100mm concrete padstones at ends

enlarge existing opening and beam over with 4No 203x133UB25 S355 encased in 2 layers of 12.5mm plasterboard with staggered joints and skim plaster finish or 15mm fireline board with skim plaster finish

ends of opening made good with 215mm engineering brick pillars

3549

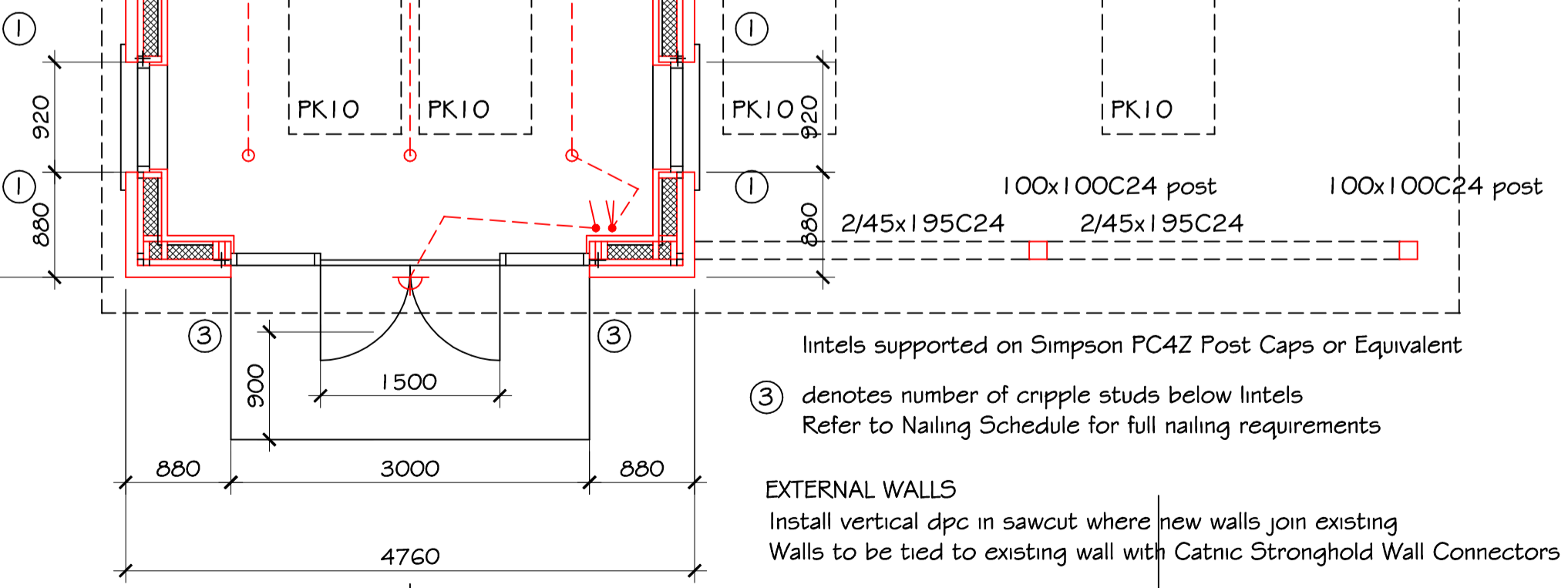

lintels supported on Simpson PC4Z Post Caps or Equivalent

③ denotes number of cripple studs below lintels Refer to Nailing Schedule for full nailing requirements

EXTERNAL WALLS
Install vertical dpc in sawcut where new walls join existing
Walls to be tied to existing wall with Catnic Stronghold Wall Connectors

DEMOLITIONS AND DOWNTAKINGS
Remove existing bay window arrangement

GROUND FLOOR PLAN 1:50

Drawing No AS-104
Wheatcroft Castle Douglas