

96.5m

95.6m

FERN WAY

FERN WAY

1 21011 - PROPOSED SITE PLAN  
 1 : 200

**KEY**  
 ■ EXISTING  
 ■ PROPOSED

**SCALE**  
 0m 2 4 10 20

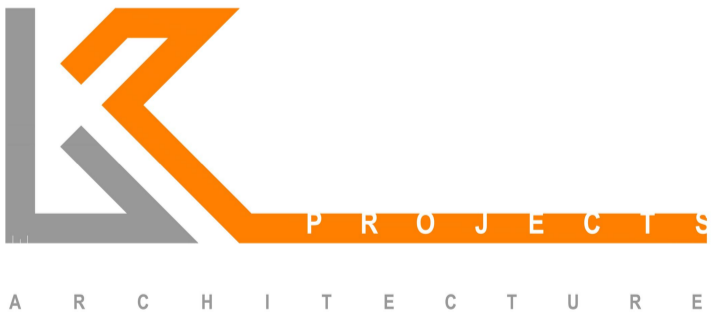

Client  
 RYAN DENHAM: 68 FERN WAY, WATFORD,  
 HERTFORDSHIRE, WD25 0HG  
 Project  
 FERN WAY WD25 0HG - WRAPAROUND EXTENSION  
 Drawing title  
 PROPOSED SITE PLAN

Scale of A1	Drawn by	Date drawn
1 : 200	WK	12/04/21
Date checked	Checked by	Date checked
PLANNING	WK	12/04/21
Project number	Drawing number	Revision
21011	100	-