

Appendix H Highway Mitigation Drawings

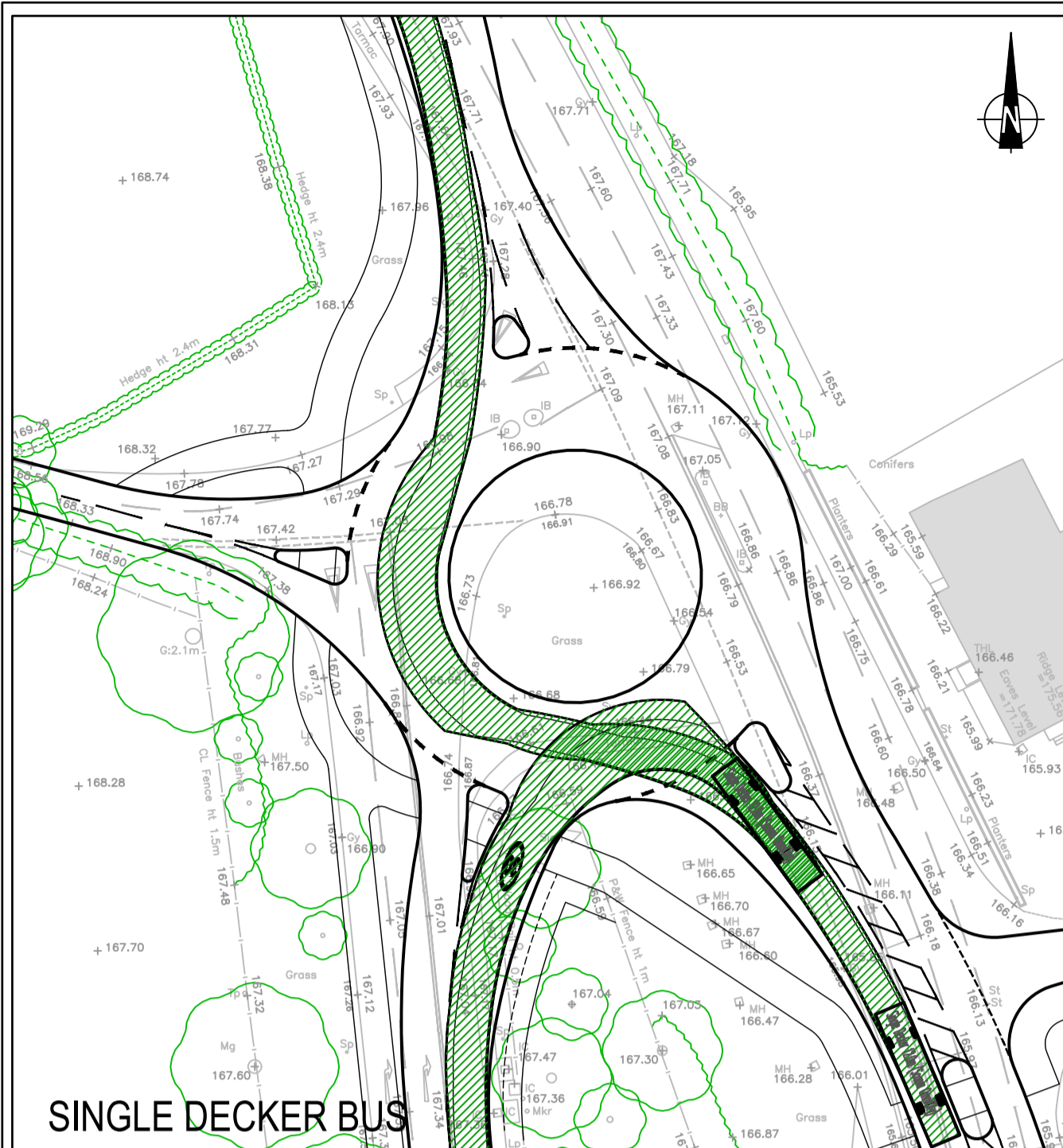

SINGLE DECKER BUS

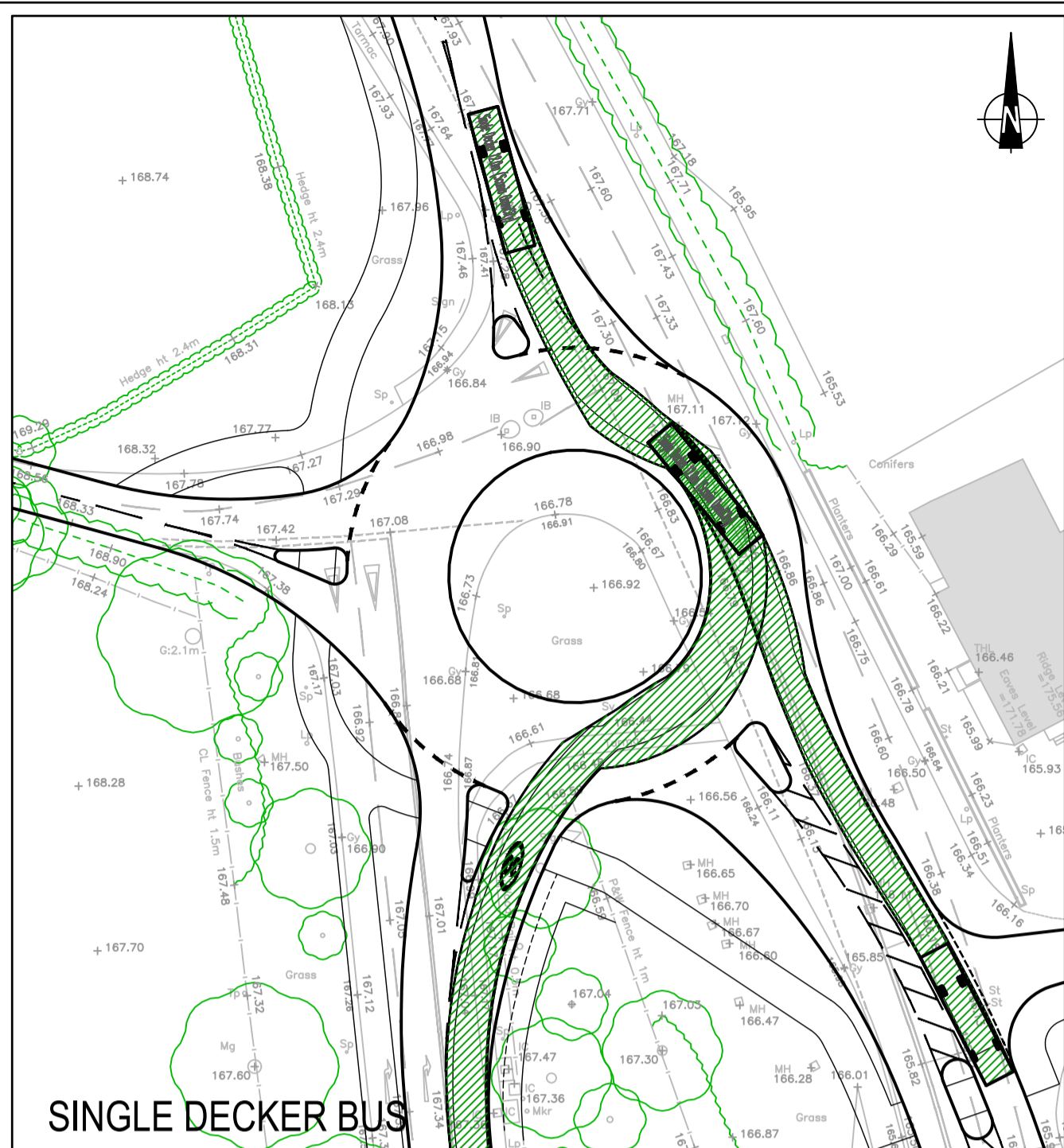

SINGLE DECKER BUS

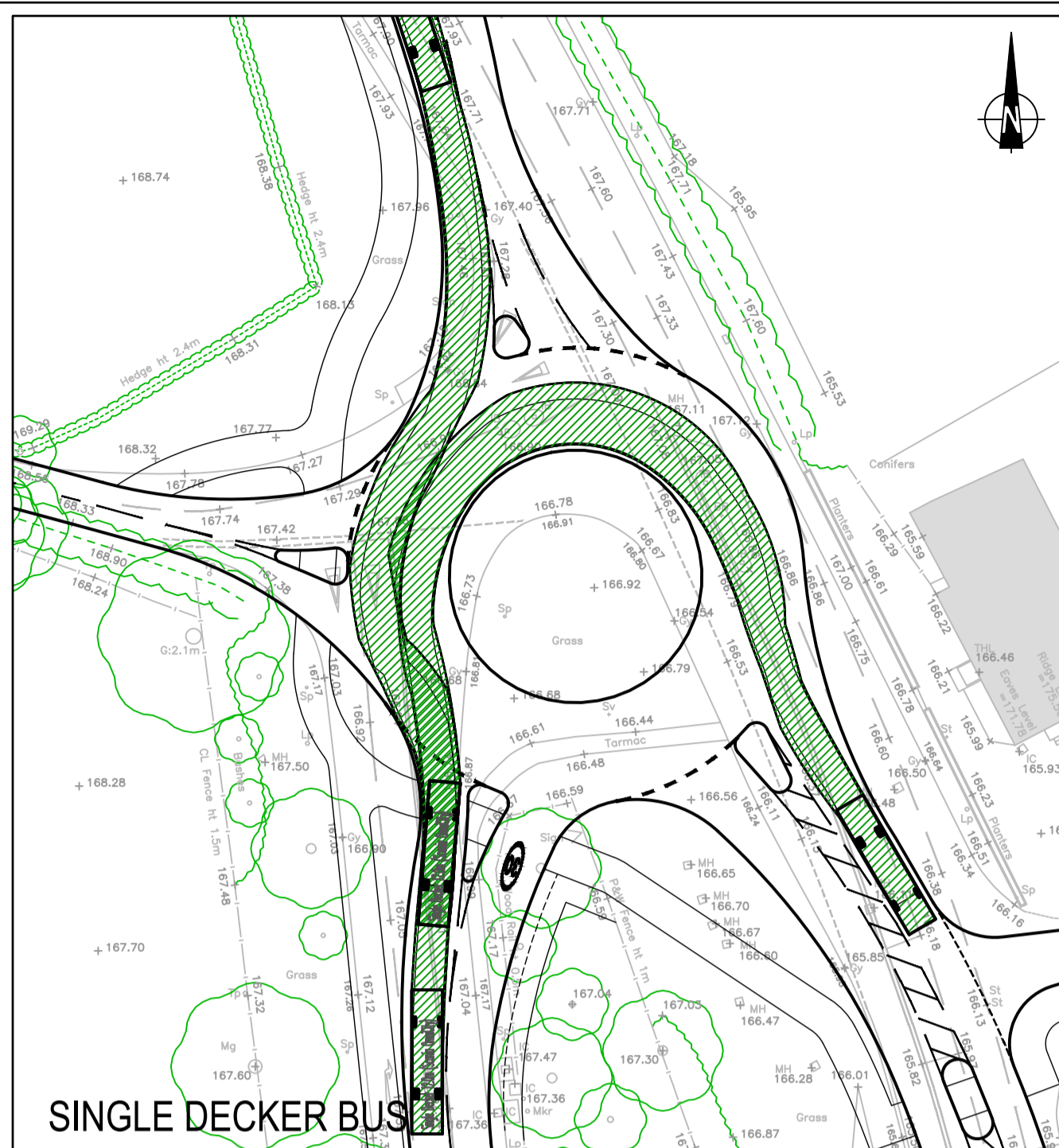

SINGLE DECKER BUS

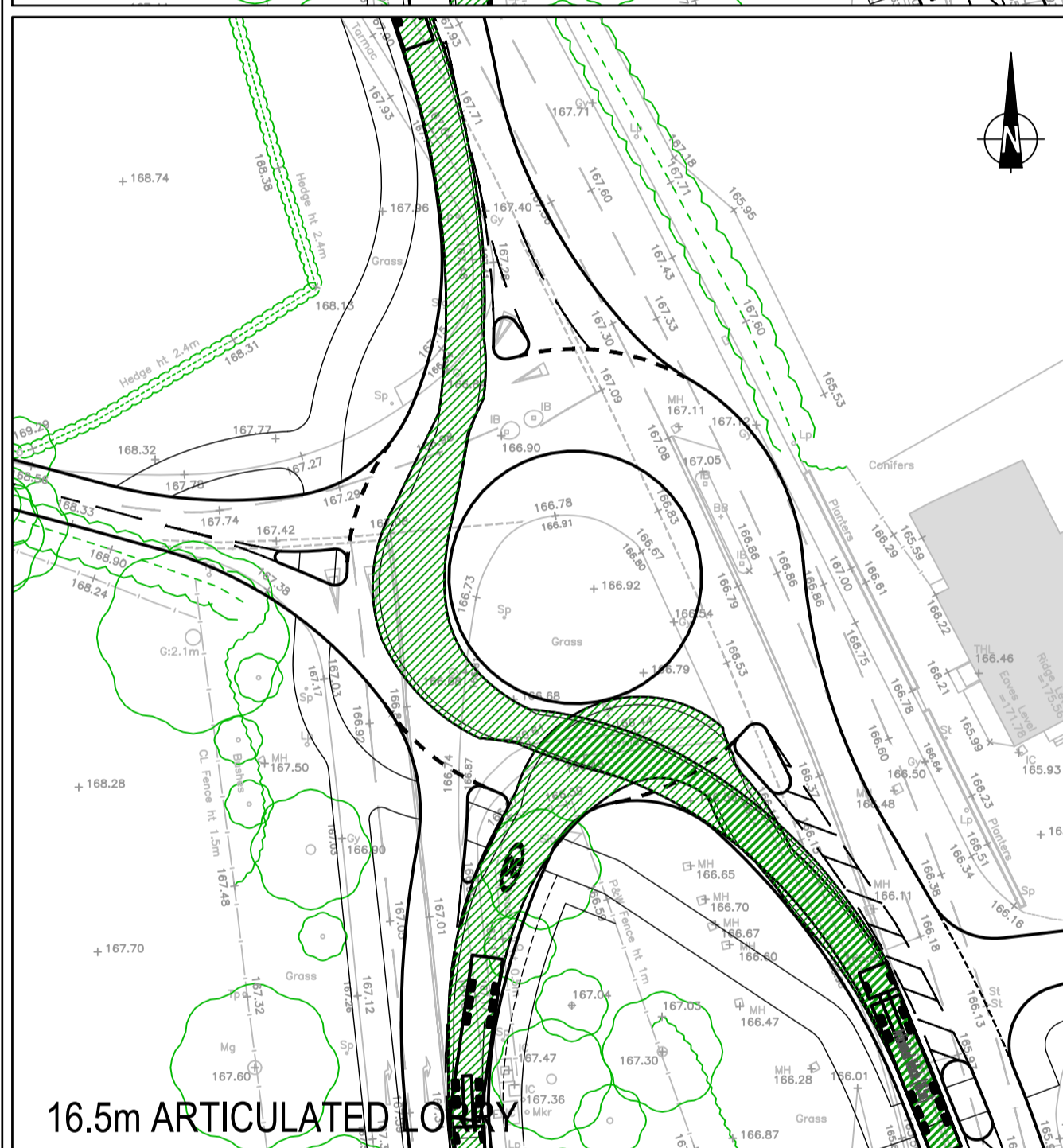
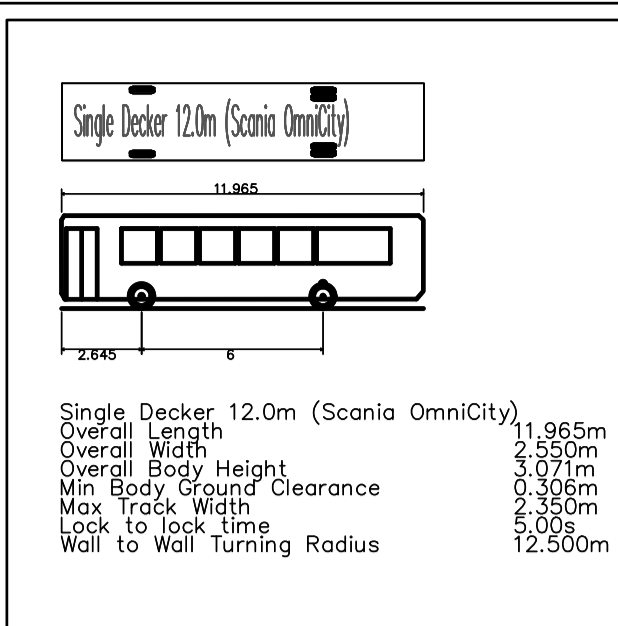

16.5m ARTICULATED LORRY

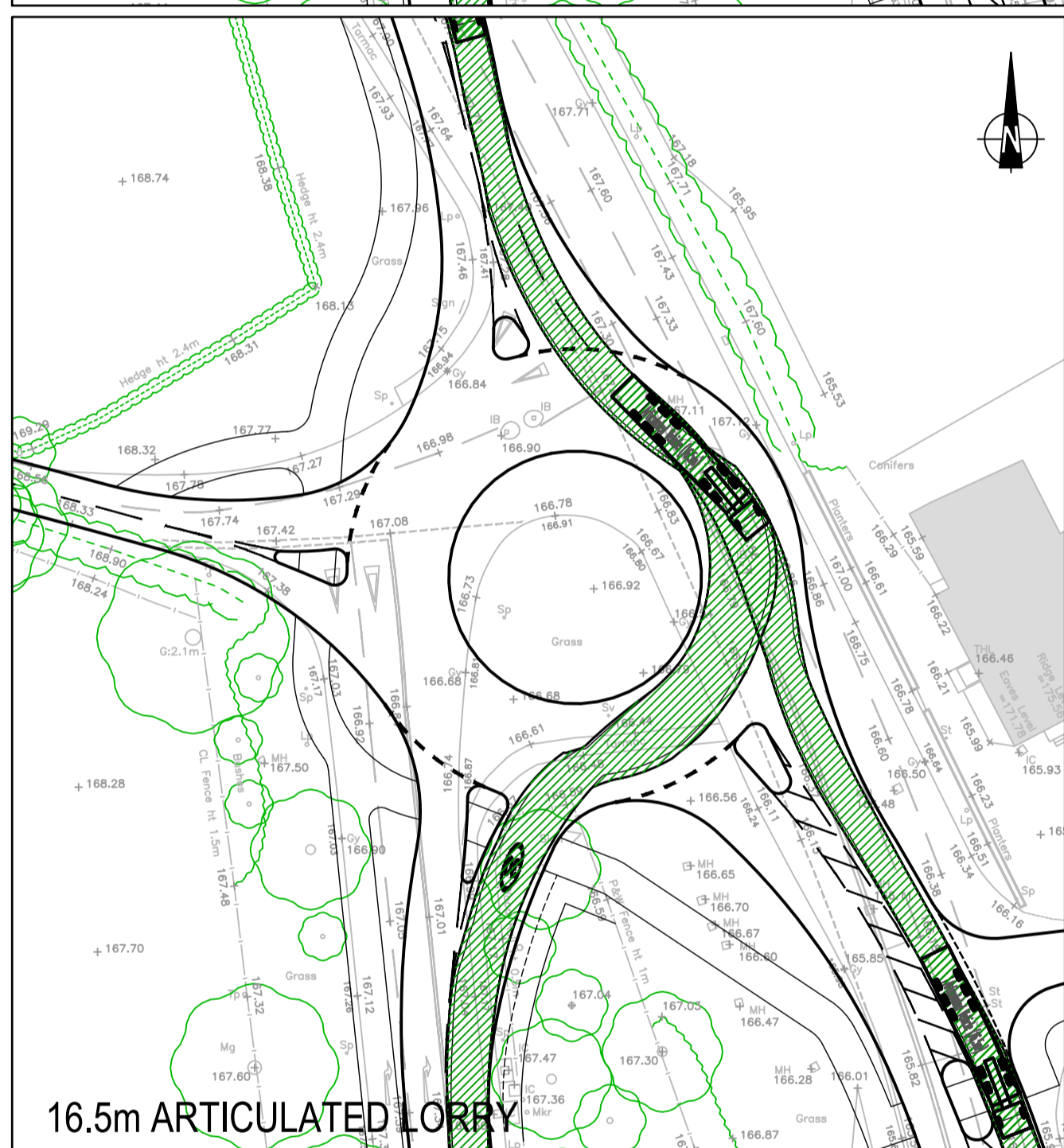

16.5m ARTICULATED LORRY

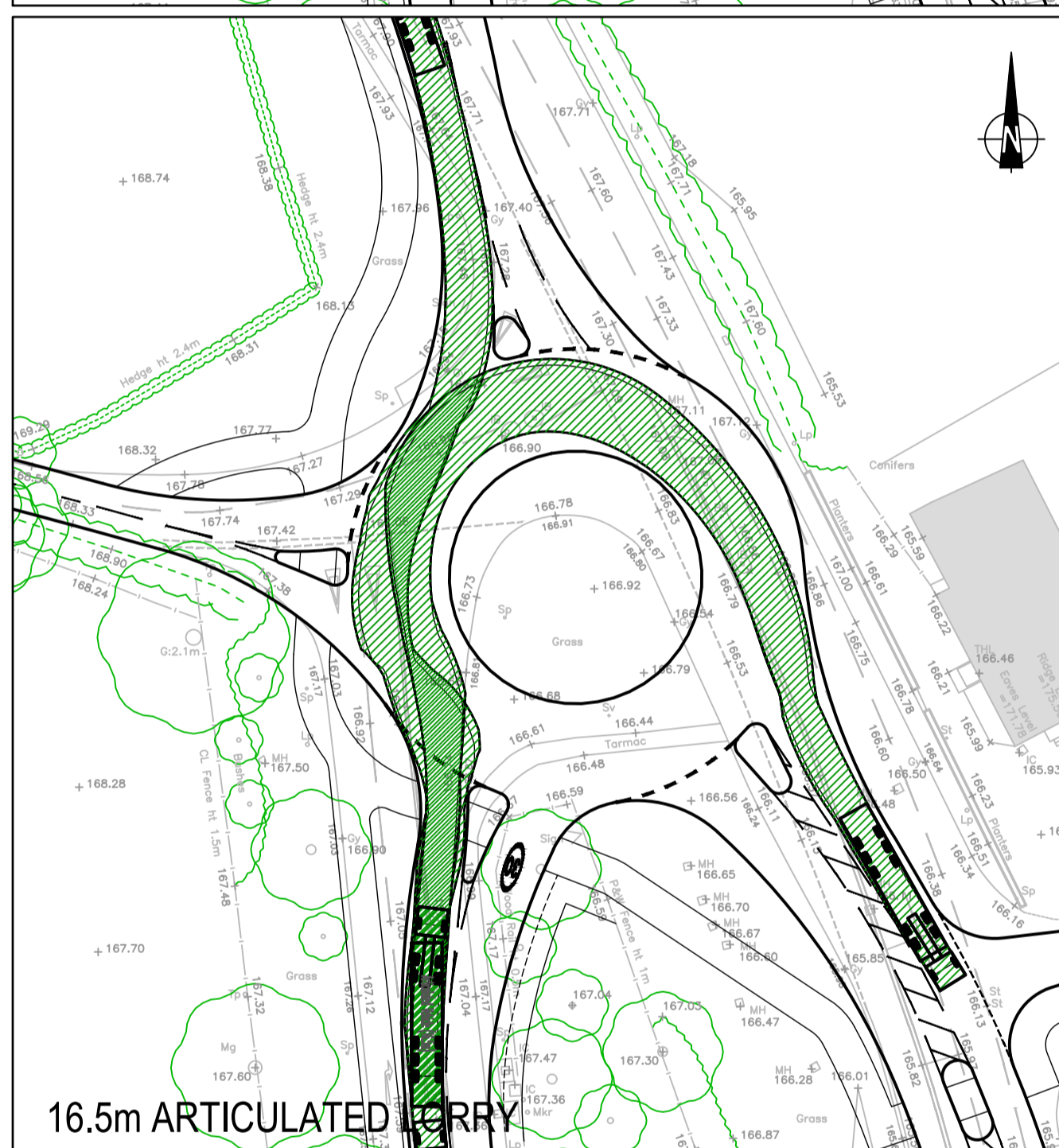

16.5m ARTICULATED LORRY

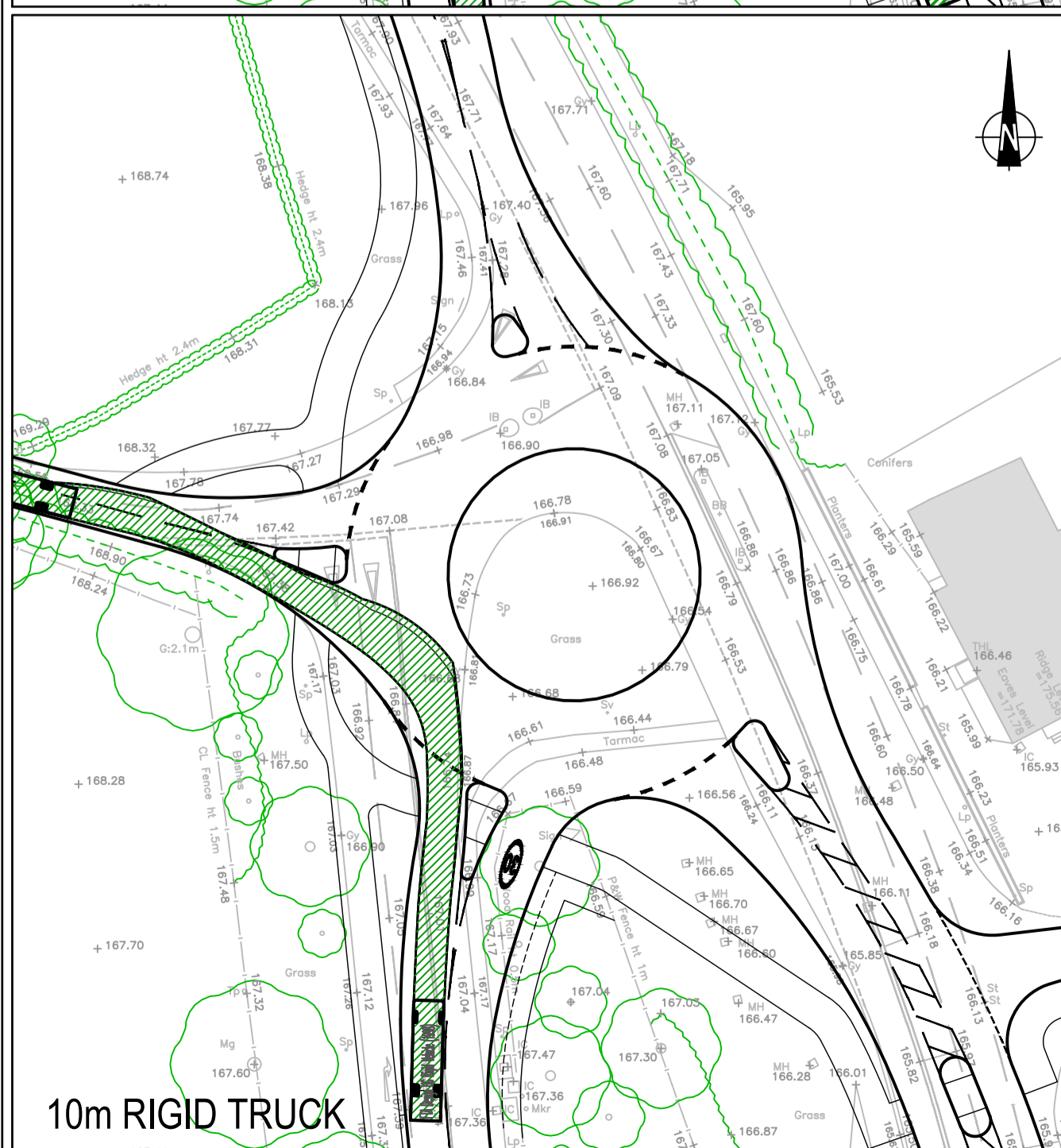
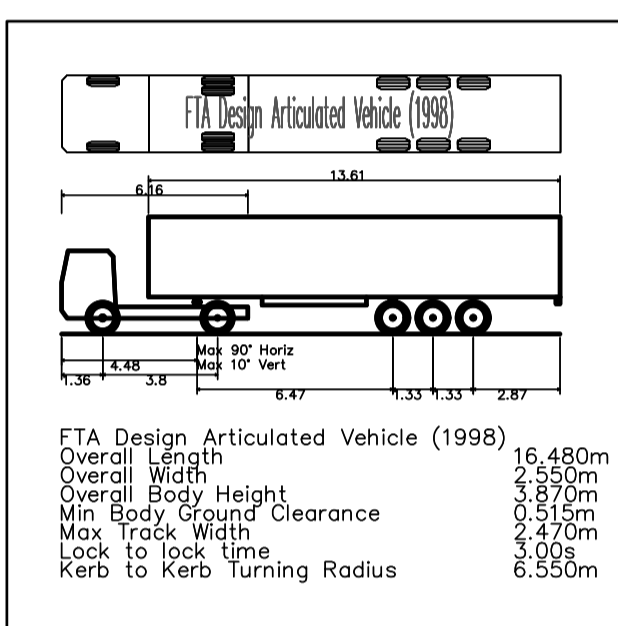

10m RIGID TRUCK

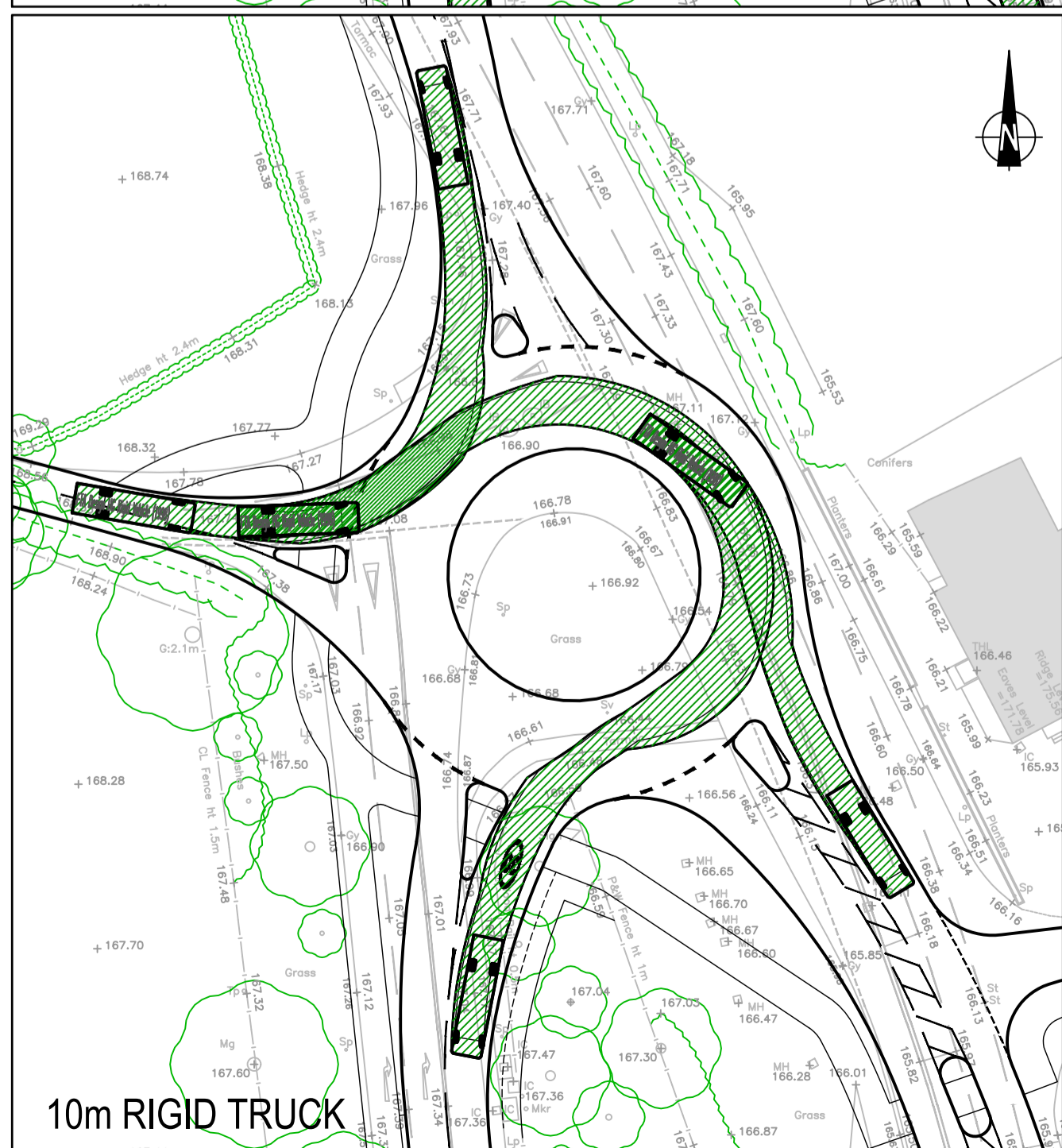

10m RIGID TRUCK

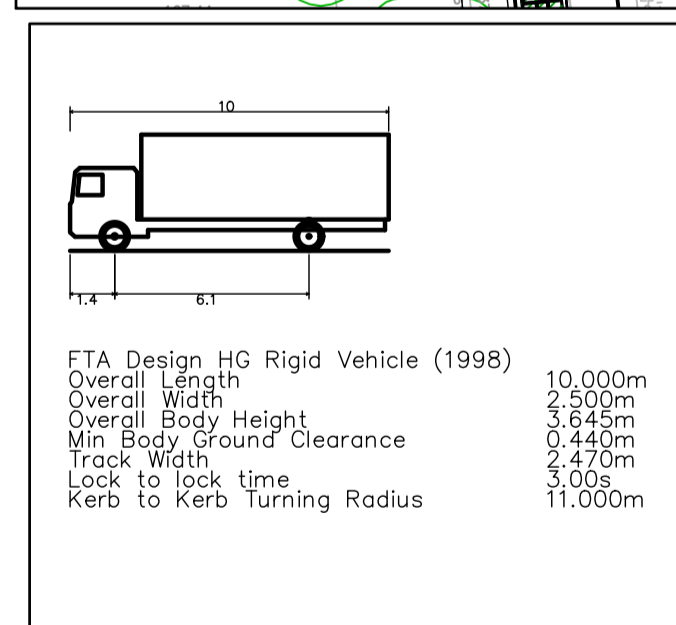

Mark	Revision	Date	Drawn	Chkd	Appd

SCALING NOTE: Do not scale from this drawing. If in doubt, ask.
 UTILITIES NOTE: The position of any existing public or private sewers, utility services, plant or apparatus shown on this drawing is believed to be correct, but no warranty to this is expressed or implied. Other such plant or apparatus may also be present but not shown. The Contractor is therefore advised to undertake his own investigation where the presence of any existing sewers, services, plant or apparatus may affect his operations.

Drawing Issue Status
DRAFT FOR COMMENT

FORT HALSTEAD, KENT
A224 POLHILL/ CROW DRIVE/ OTFORD LANE
ROUNDBOUT
VEHICLE SWEEP PATH ANALYSIS

Client MERSEYSIDE PENSION FUND			 Offices throughout the UK and Europe www.peterbrett.com © Peter Brett Associates LLP LONDON Tel: 020 7566 8600
Date of 1st Issue 02.08.2019	Designed -	Drawn HM	
A1 Scale 1:500	Checked AM	Approved AM	
Drawing Number 41290/5501/042	Revision -		

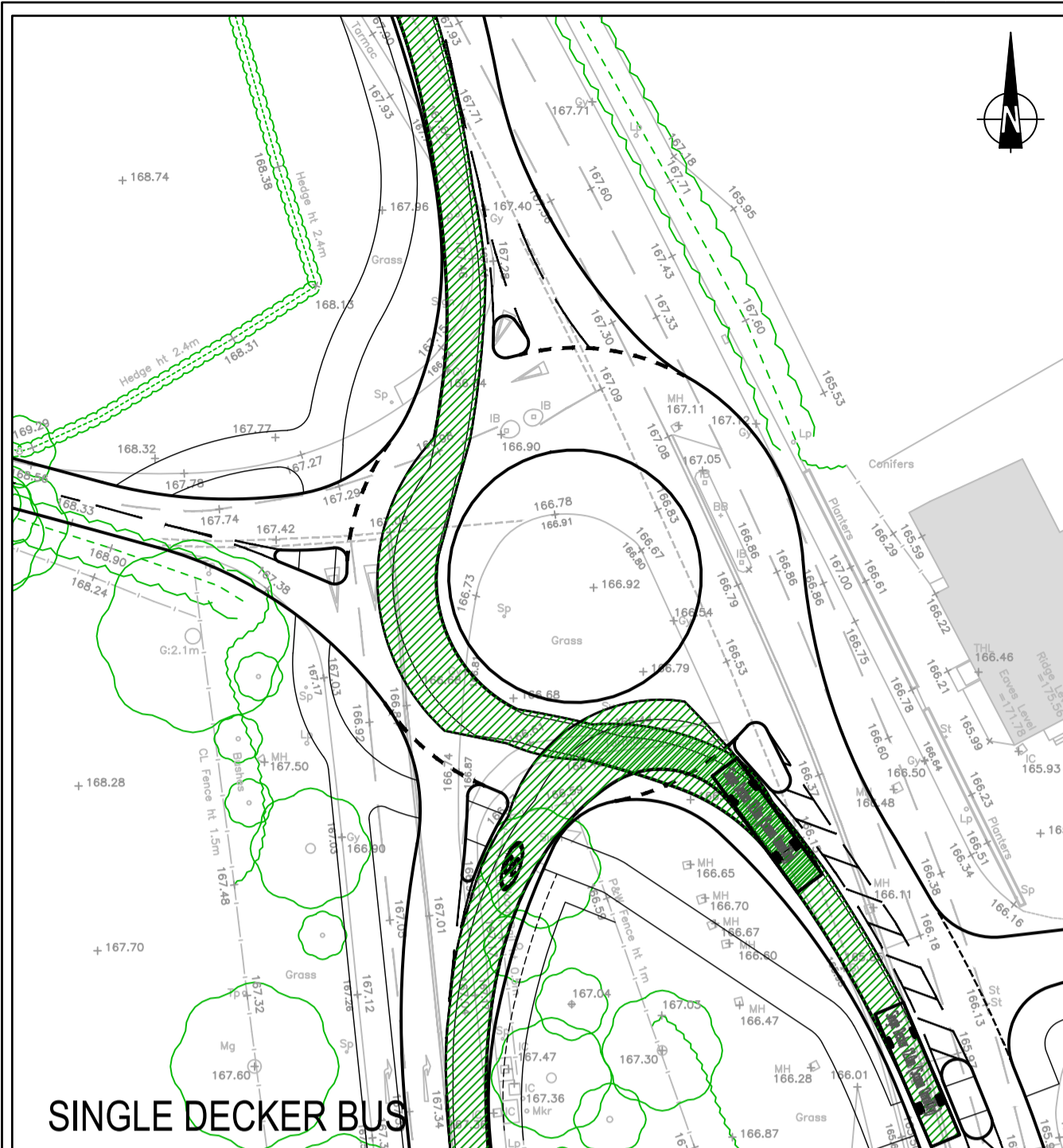

SINGLE DECKER BUS

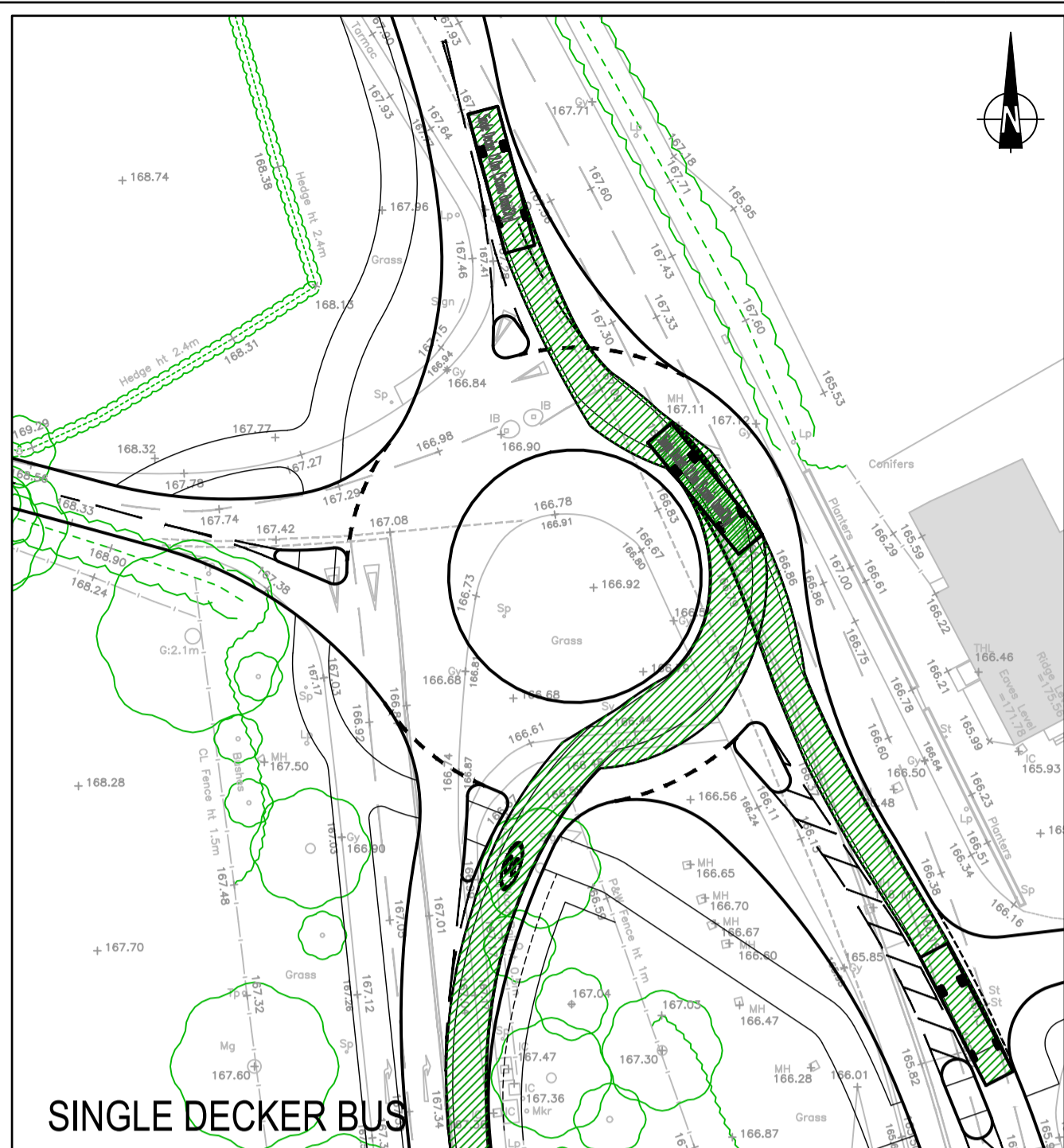

SINGLE DECKER BUS

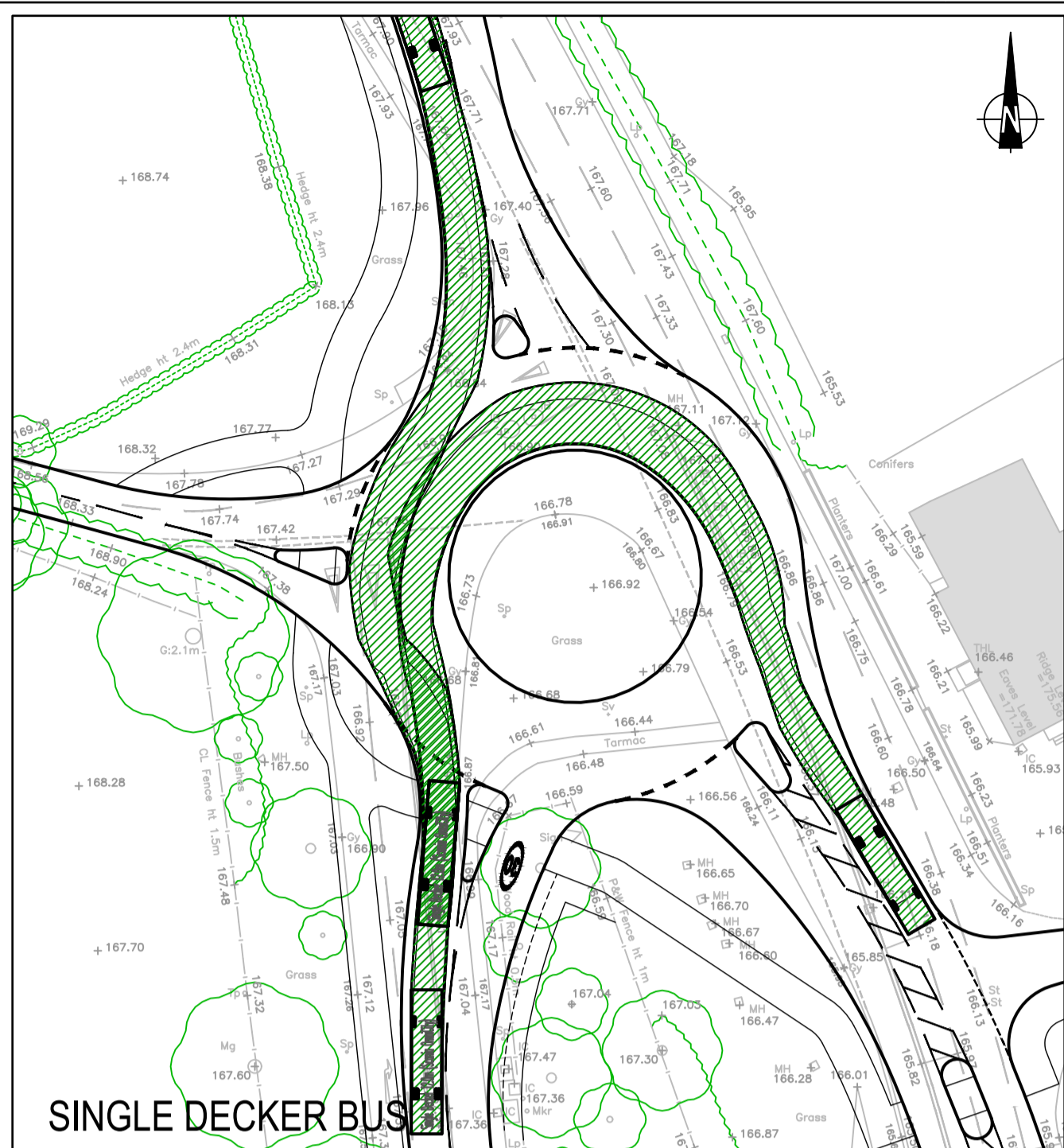

SINGLE DECKER BUS

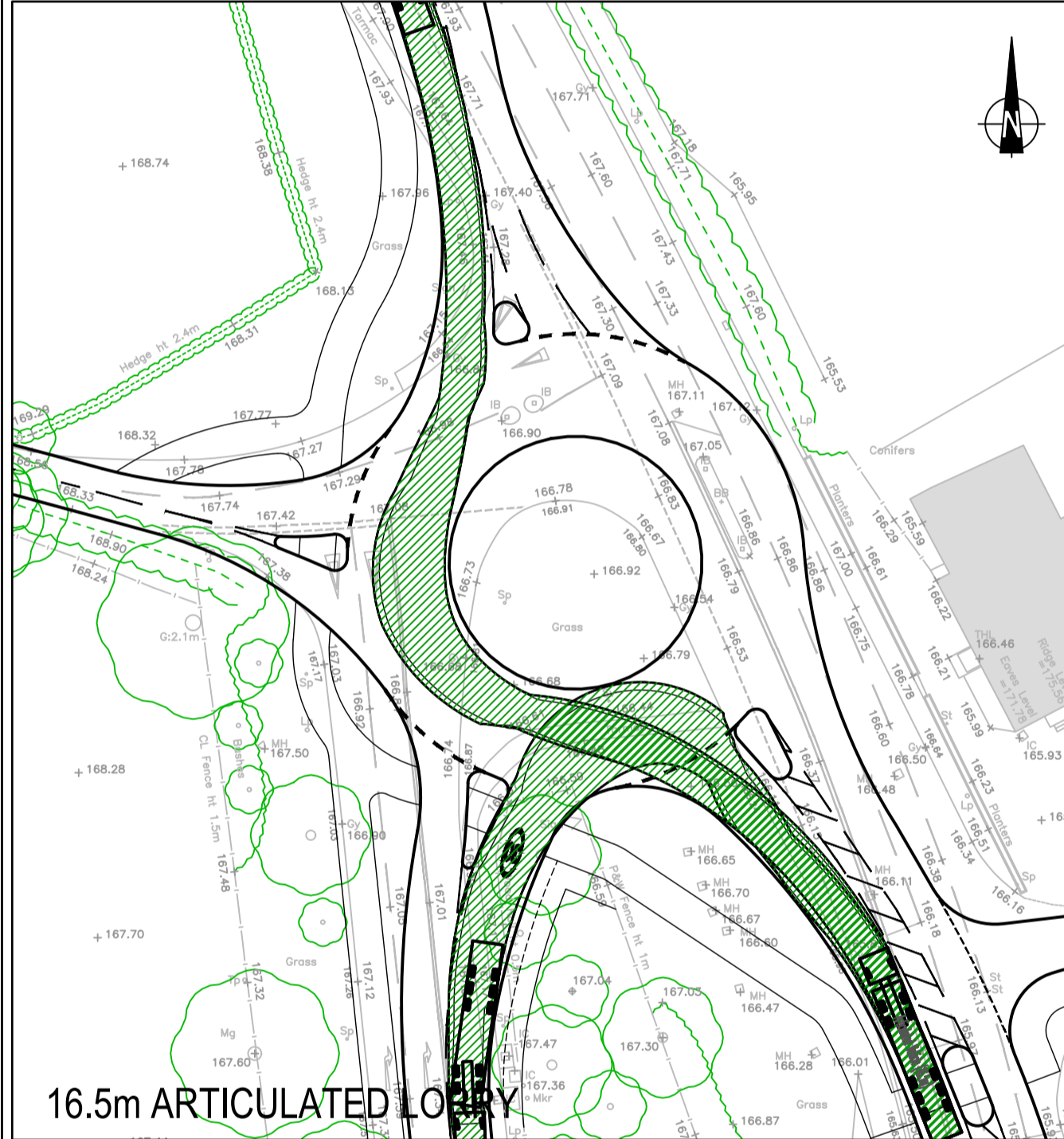
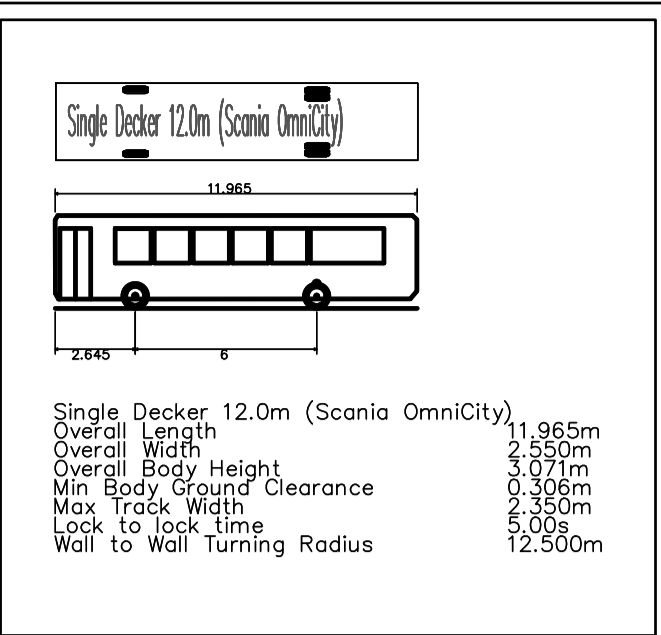

16.5m ARTICULATED LORRY

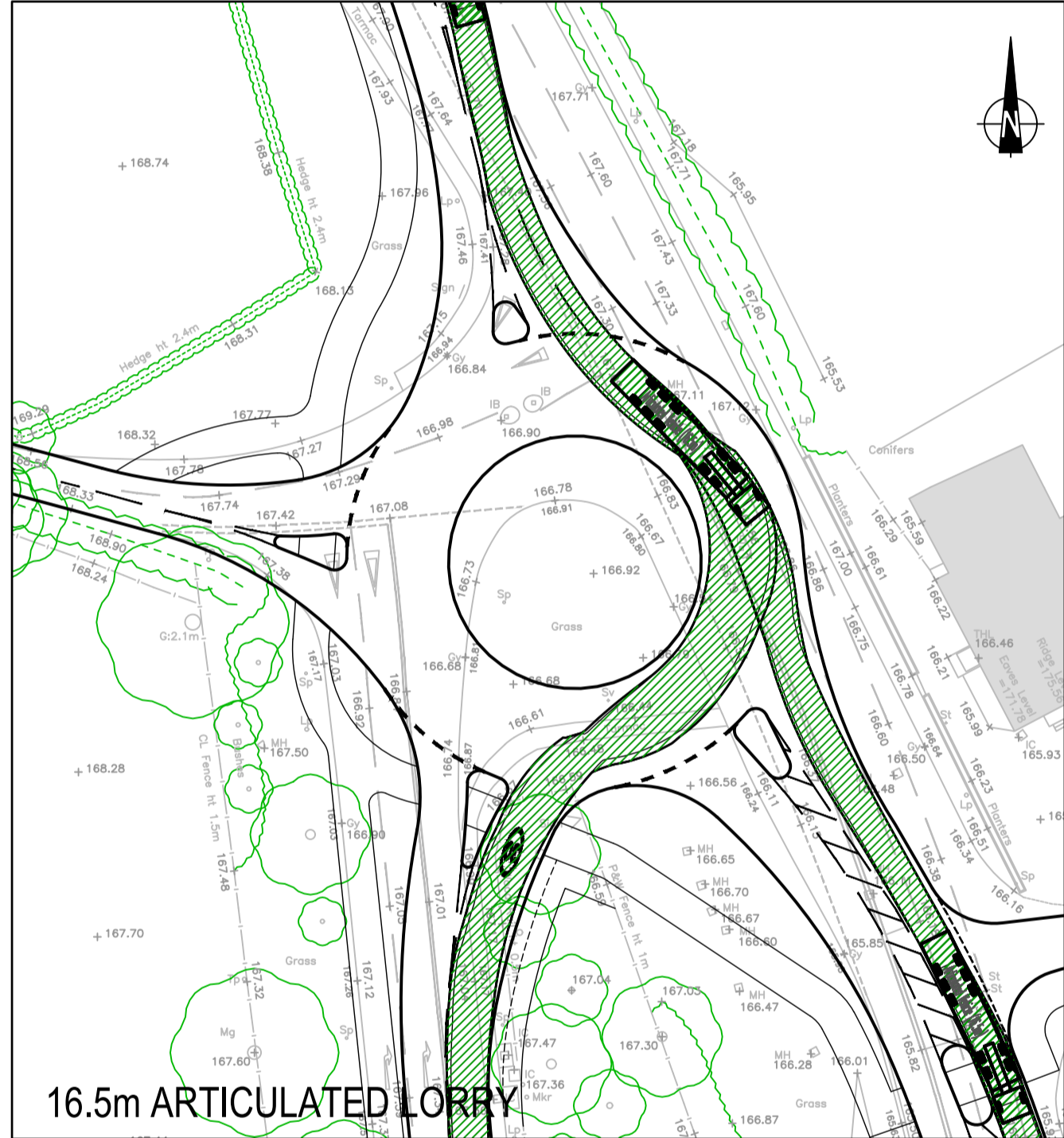

16.5m ARTICULATED LORRY

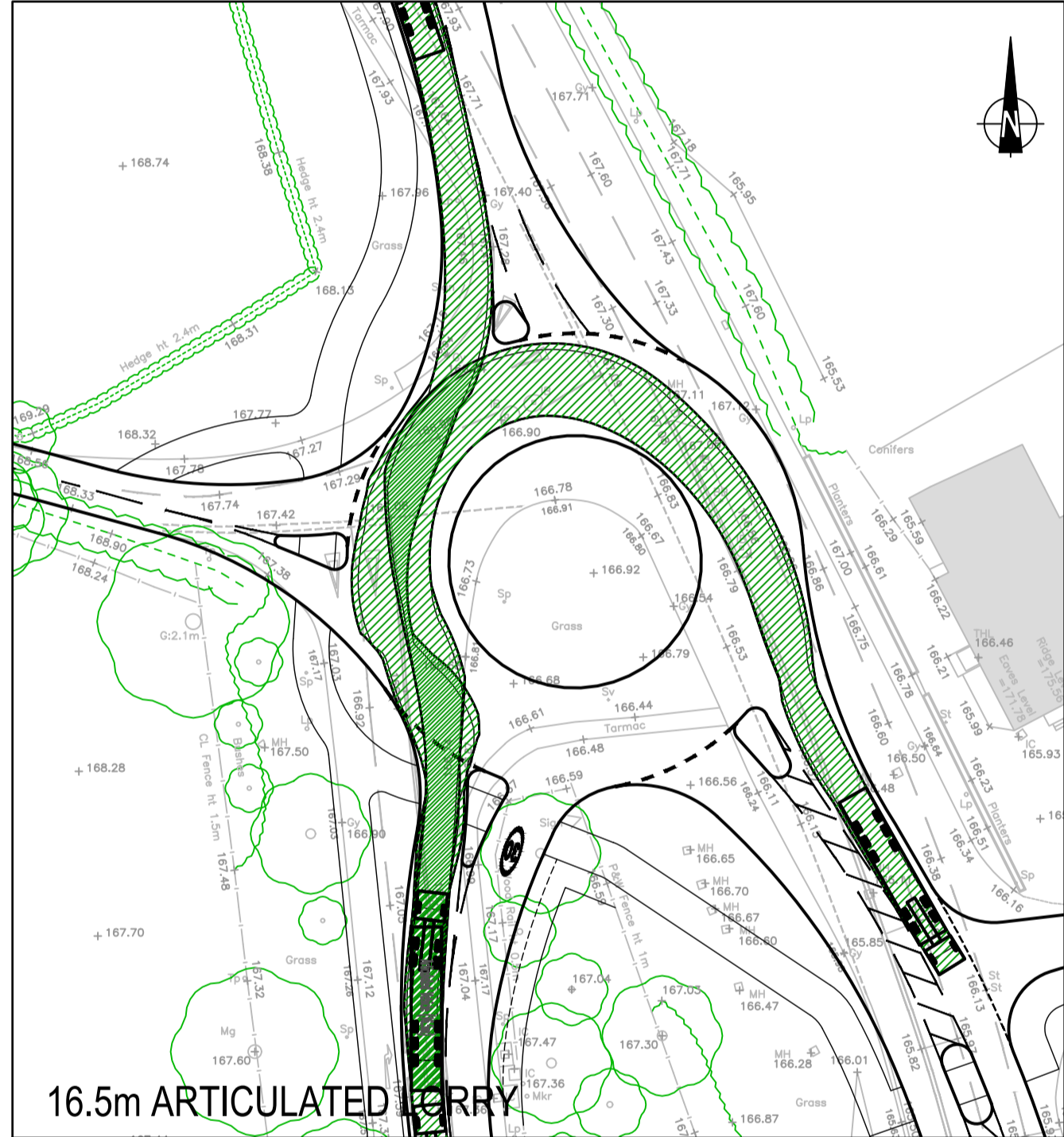

16.5m ARTICULATED LORRY

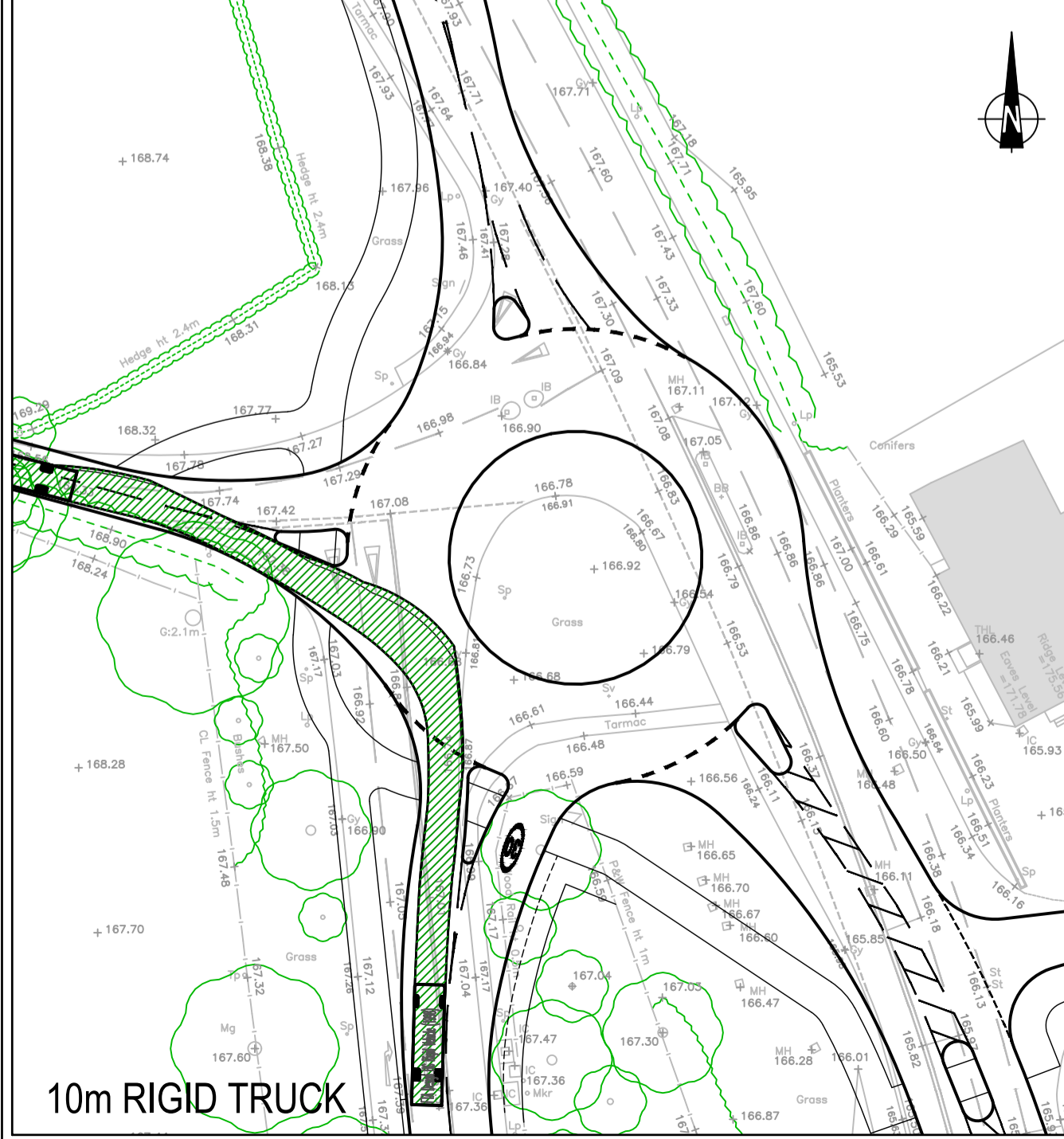
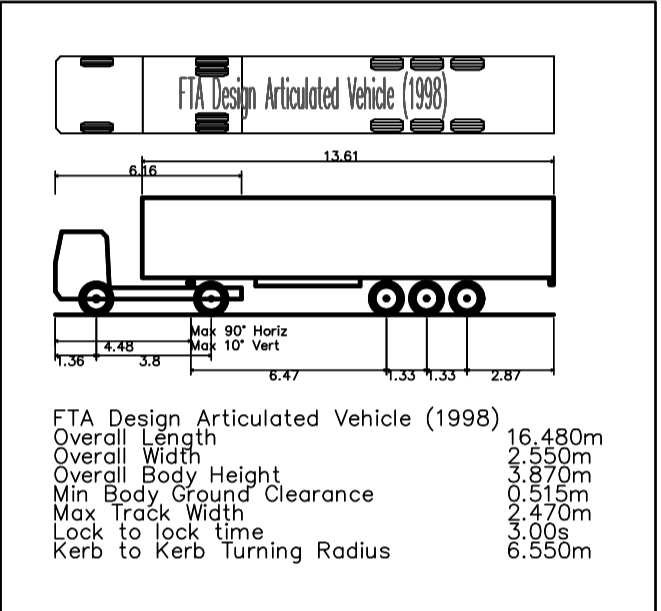

10m RIGID TRUCK

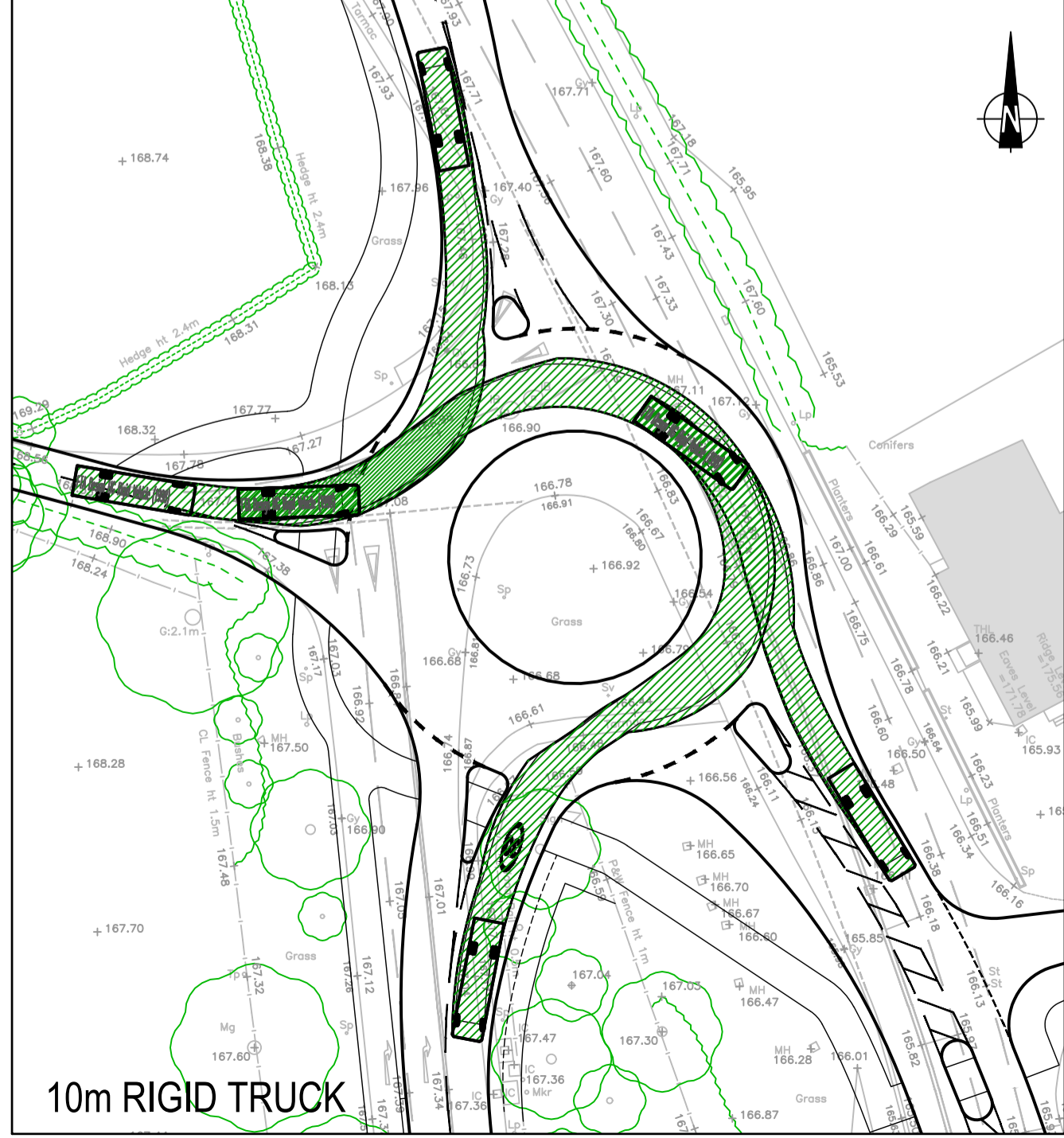

10m RIGID TRUCK

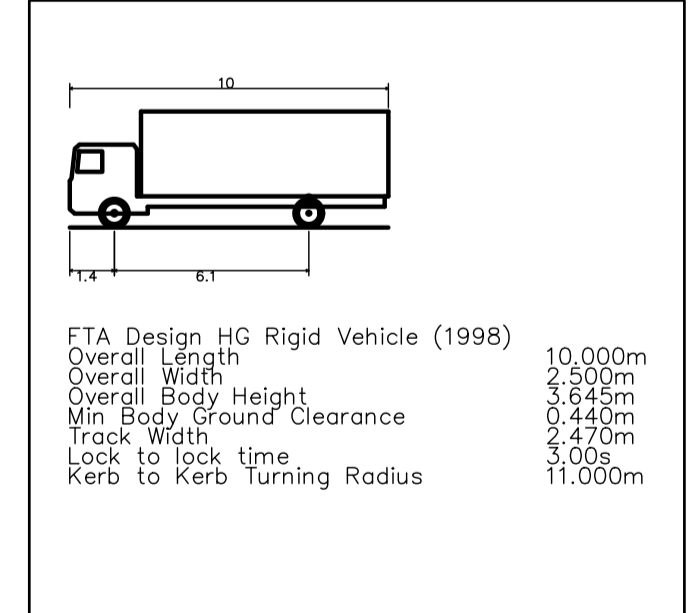

Mark	Revision	Date	Drawn	Chkd	Appd

SCALING NOTE: Do not scale from this drawing. If in doubt, ask.
 UTILITIES NOTE: The position of any existing public or private sewers, utility services, plant or apparatus shown on this drawing is believed to be correct, but no warranty to this is expressed or implied. Other such plant or apparatus may also be present but not shown. The Contractor is therefore advised to undertake his own investigation where the presence of any existing sewers, services, plant or apparatus may affect his operations.

Drawing Issue Status
DRAFT FOR COMMENT

**FORT HALSTEAD, KENT
 A224 POLHILL/ CROW DRIVE/ OTFORD LANE
 ROUNDABOUT
 VEHICLE SWEEP PATH ANALYSIS**

Client MERSEYSIDE PENSION FUND			 Offices throughout the UK and Europe www.peterbrett.com © Peter Brett Associates LLP LONDON Tel: 020 7566 8600
Date of 1st Issue 02.08.2019	Designed -	Drawn HM	
A1 Scale 1:500	Checked AM	Approved AM	Revision -
Drawing Number 41290/5501/043			

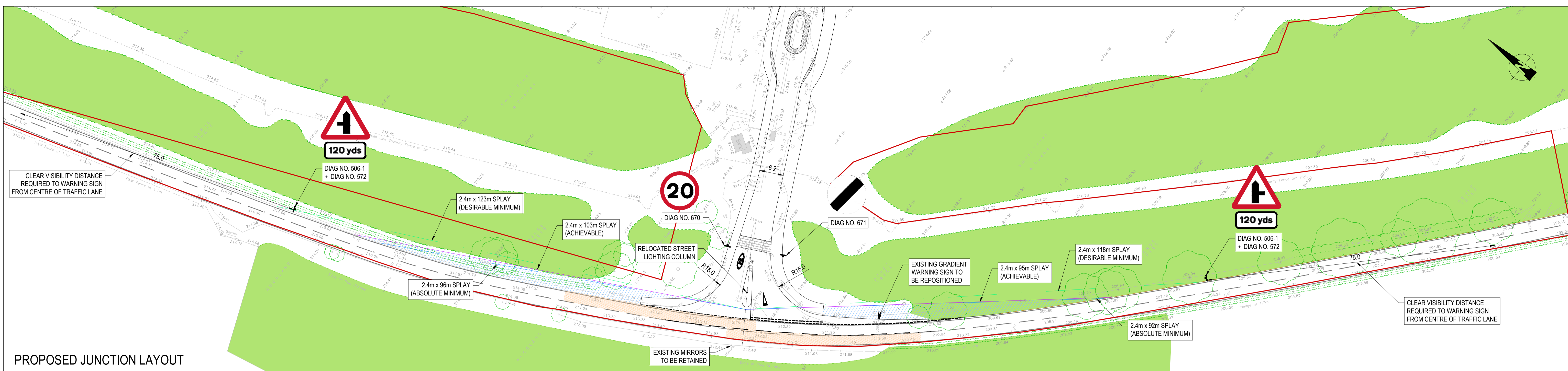

NOTES:

1. THE SPEED LIMIT ON THIS SECTION IS UNRESTRICTED THEREFORE SPEEDS UP TO 60 MPH ARE PERMITTED. HOWEVER, DESIGN SPEEDS HAVE BEEN CHOSEN BASED UPON MEAN AND 85TH PERCENTILE SPEEDS ACTUALLY RECORDED ON THIS SECTION.
2. VISIBILITY SPLAYS HAVE BEEN USED BASED UPON THE PARAMETERS AND FORMULAS GIVEN IN CHAPTER10 OF MANUAL FOR STREETS 2.
3. DUE TO THE IMPACT THAT THE PROVISION OF VISIBILITY AT THE DESIABLE MINIMUM VALUES WOULD HAVE ON THE WOODLAND AREAS ADJACENT TO THE JUNCTION, IT IS PROPOSED THAT THE ACTUAL ACHIEVABLE SPLAYS ARE PROVIDED INSTEAD.

KEY:

- RED LINE PLANNING BOUNDARY
- ▨ AREA OF LAND WHERE FOLIAGE TO BE CUT BACK AND TREE CANOPIES RAISED (WHERE PRACTICAL).
- HIGH FRICTION SURFACING (50 METRES MINIMUM)
- VISIBILITY SPLAY - ABSOLUTE MINIMUM (SEE TABLE)
- VISIBILITY SPLAY - DESIRABLE MINIMUM (SEE TABLE)
- VISIBILITY SPLAY - ACTUALLY ACHIEVABLE (SEE TABLE)

VISIBILITY SPLAYS		
	Northbound	Southbound
Recorded speeds from surveys	45.9 mph	47.2 mph
Design speeds (with 4 kph wet weather adjustment)	43.4 mph	44.7 mph
Visibility - absolute minimum	2.4m x 92m	2.4m x 96m
Visibility - desirable minimum	2.4m x 118m	2.4m x 123m
Visibility - existing achievable	2.4m x 96m	2.4m x 102m
Visibility - proposed achievable	2.4m x 95m	2.4m x 103m

Mark	Revision	Date	Drawn	Chkd	Appd

SCALING NOTE: Do not scale from this drawing. If in doubt, ask.
 UTILITIES NOTE: The position of any existing public or private sewers, utility services, plant or apparatus shown on this drawing is believed to be correct, but no warranty to this is expressed or implied. Other such plant or apparatus may also be present but not shown. The Contractor is therefore advised to undertake his own investigation where the presence of any existing sewers, services, plant or apparatus may affect his operations.

Drawing Issue Status
DRAFT FOR COMMENT

**FORT HALSTEAD, KENT
 PROPOSED HIGHWAY LAYOUT
 STAR HILL ROAD JUNCTION**

Client
**MERSEYSIDE
 PENSION FUND**

Date of 1st Issue 25.07.2019	Designed -	Drawn REM
A1 Scale 1:500	Checked BK	Approved JSL

Drawing Number
41290/5501/044

Offices throughout the UK and Europe
www.peterbrett.com
 © Peter Brett Associates LLP
 LONDON
 Tel: 020 7566 8600

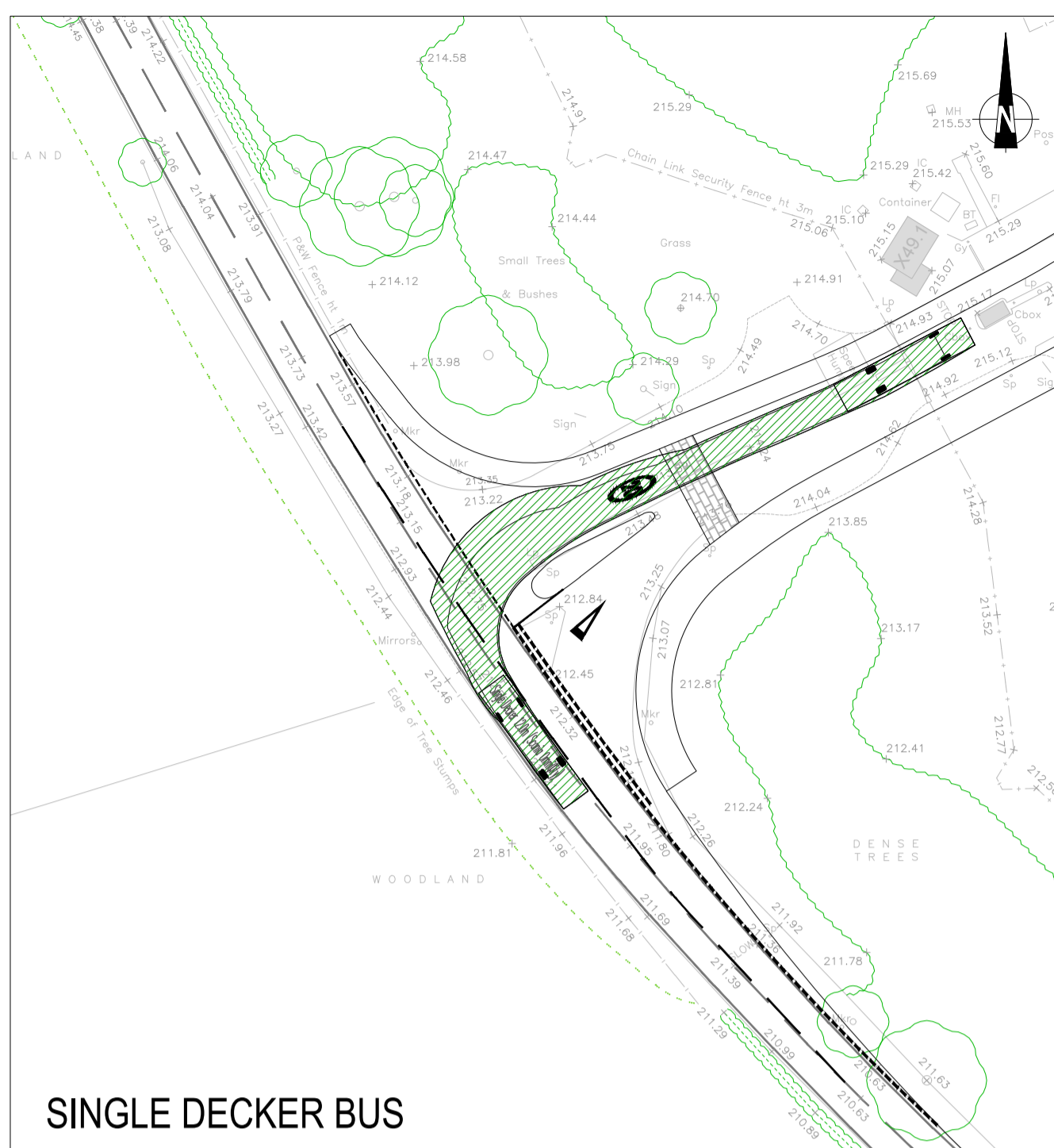

SINGLE DECKER BUS

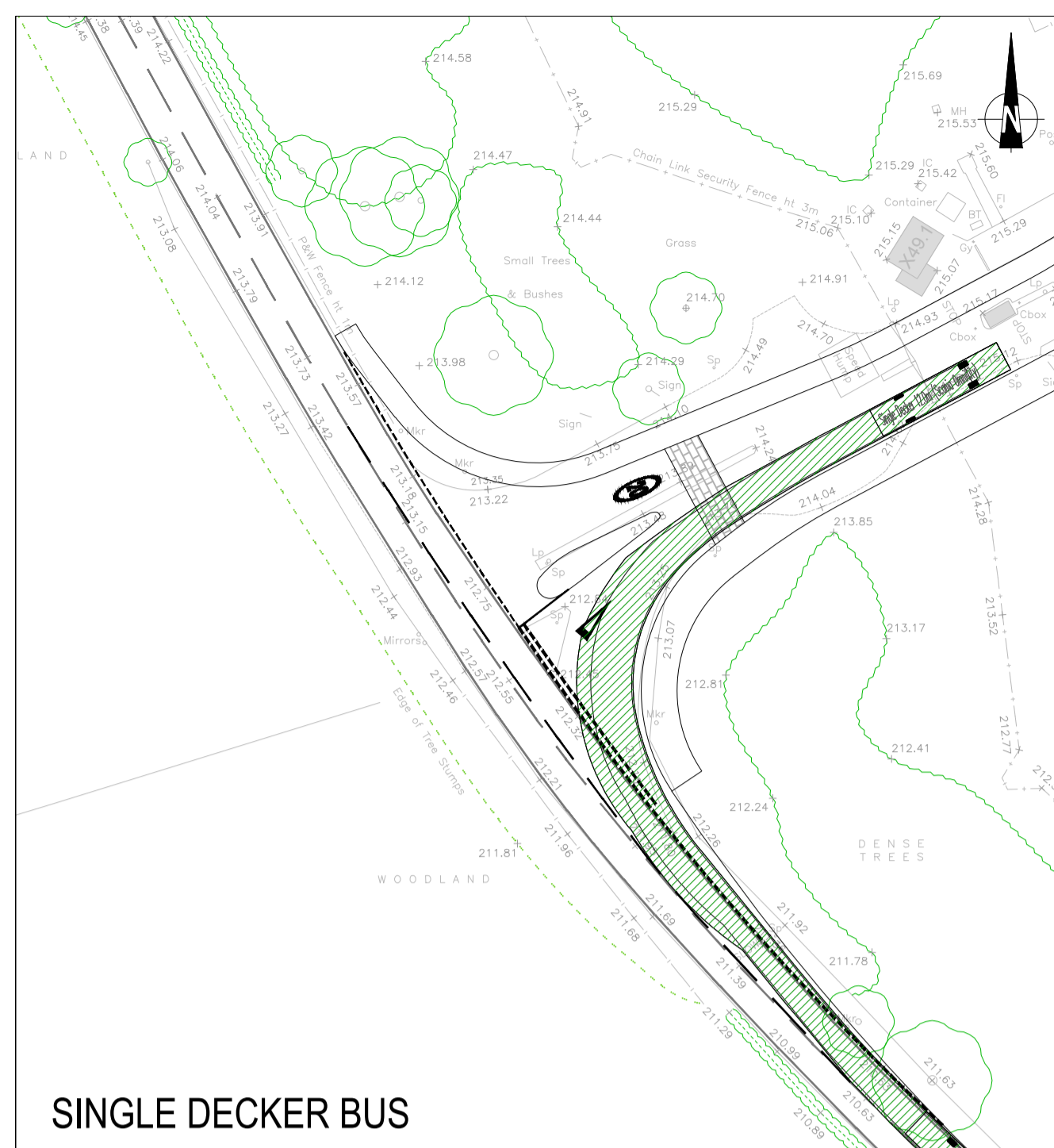

SINGLE DECKER BUS

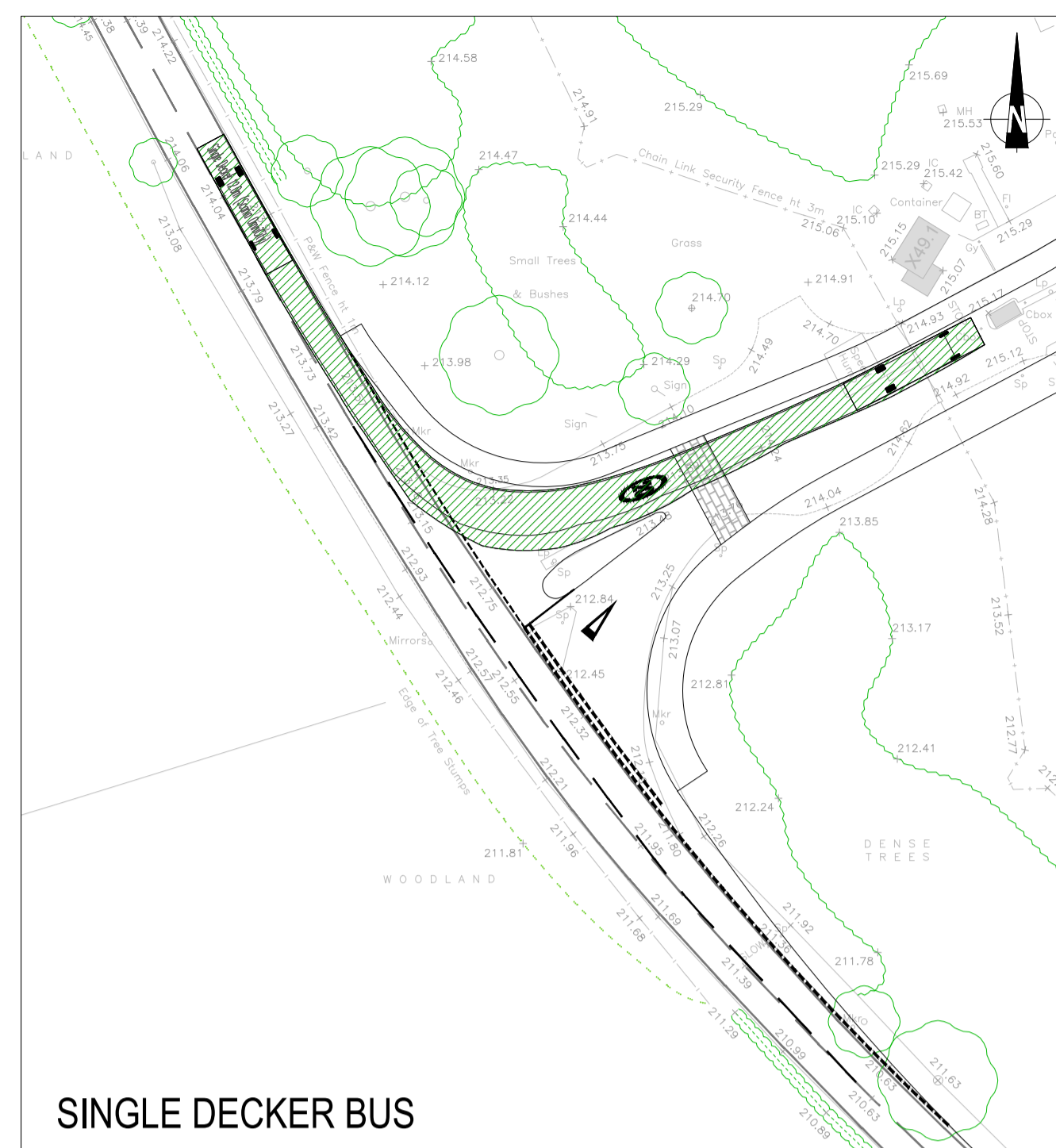

SINGLE DECKER BUS

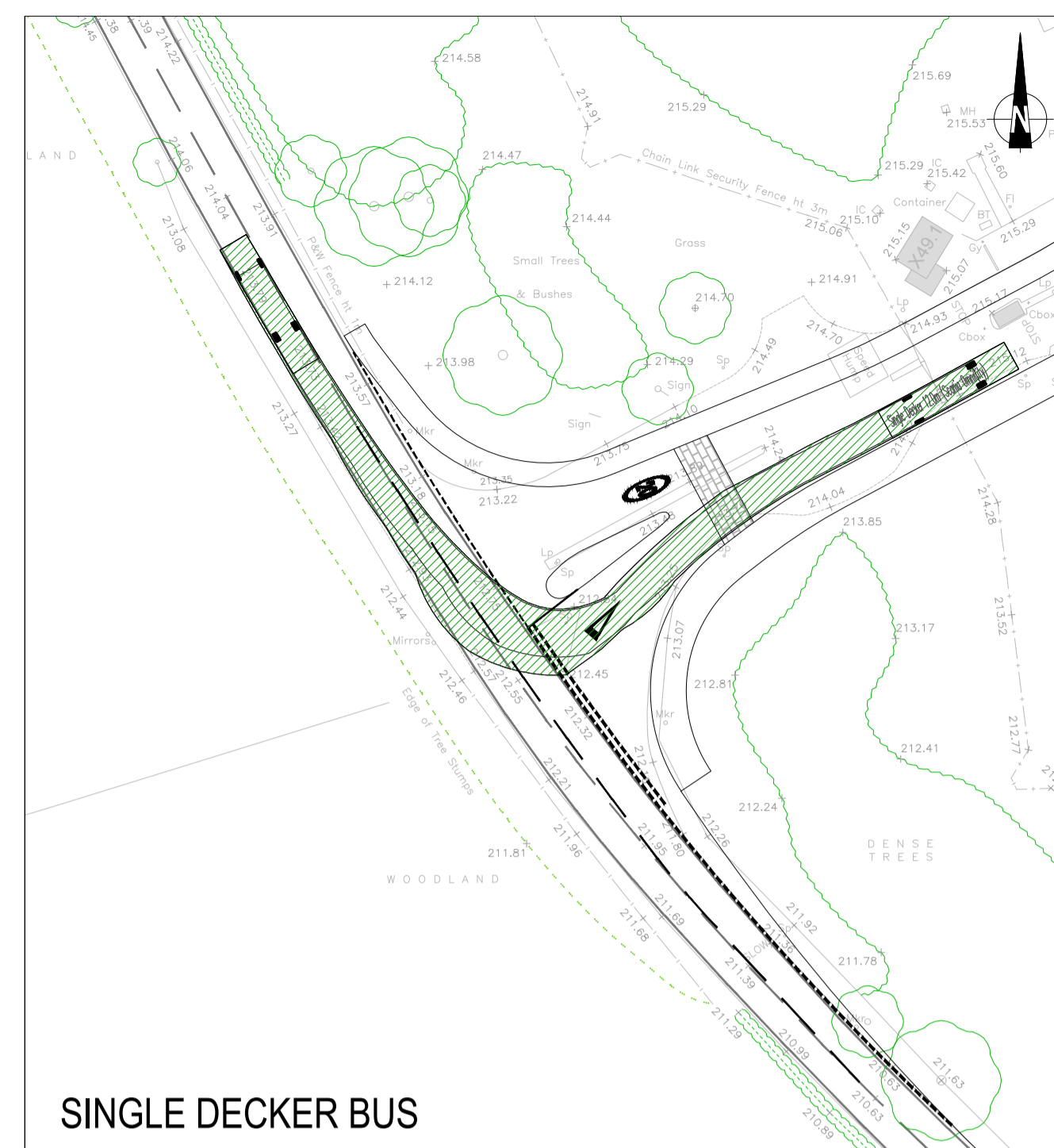

SINGLE DECKER BUS

Single Decker 12.0m (Scania OmniCity)

Overall Length 11.965m
 Overall Width 2.550m
 Overall Body Height 3.071m
 Min Body Ground Clearance 0.306m
 Max Track Width 2.350m
 Lock to lock time 5.00s
 Wall to Wall Turning Radius 12.500m

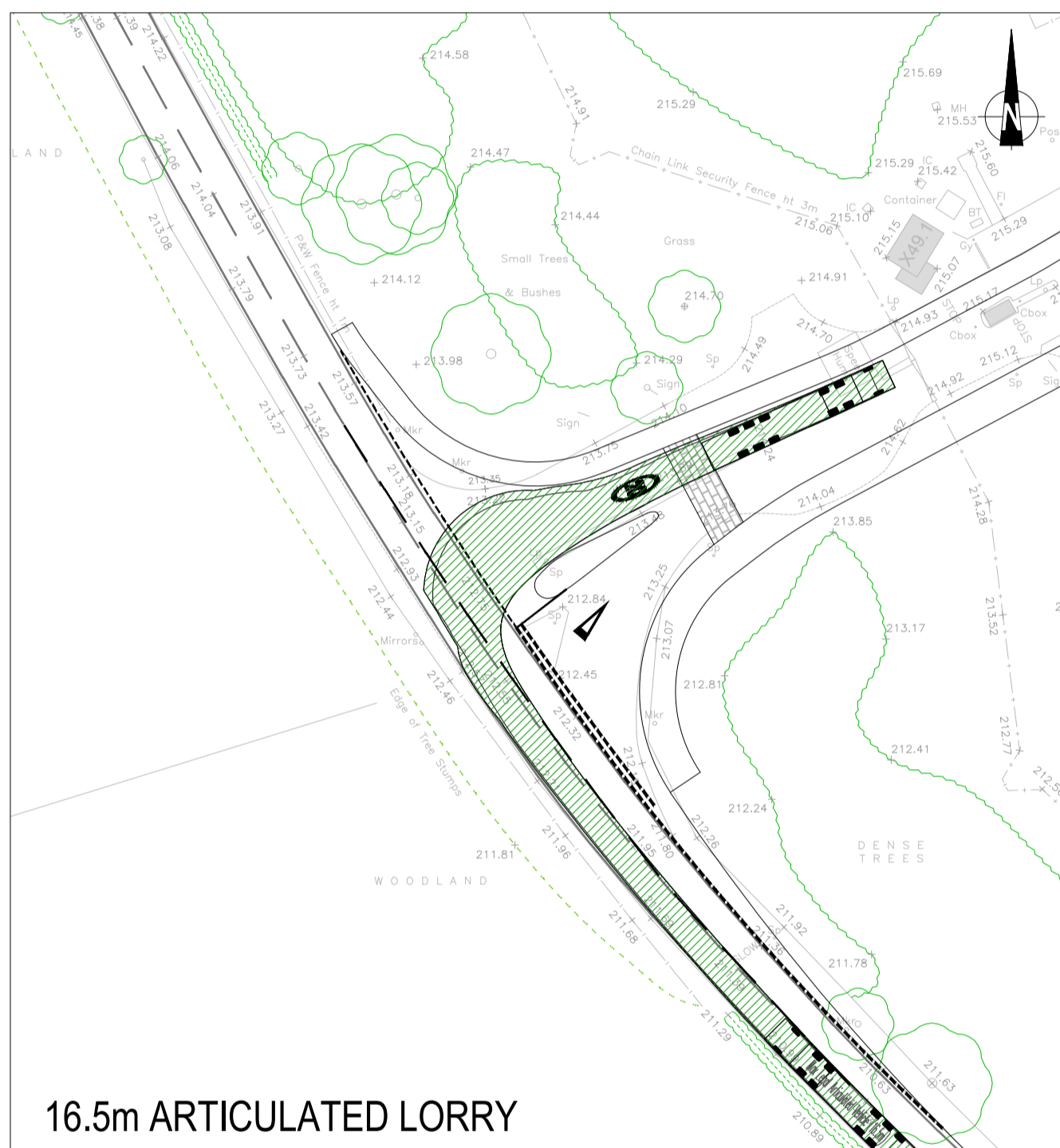

16.5m ARTICULATED LORRY

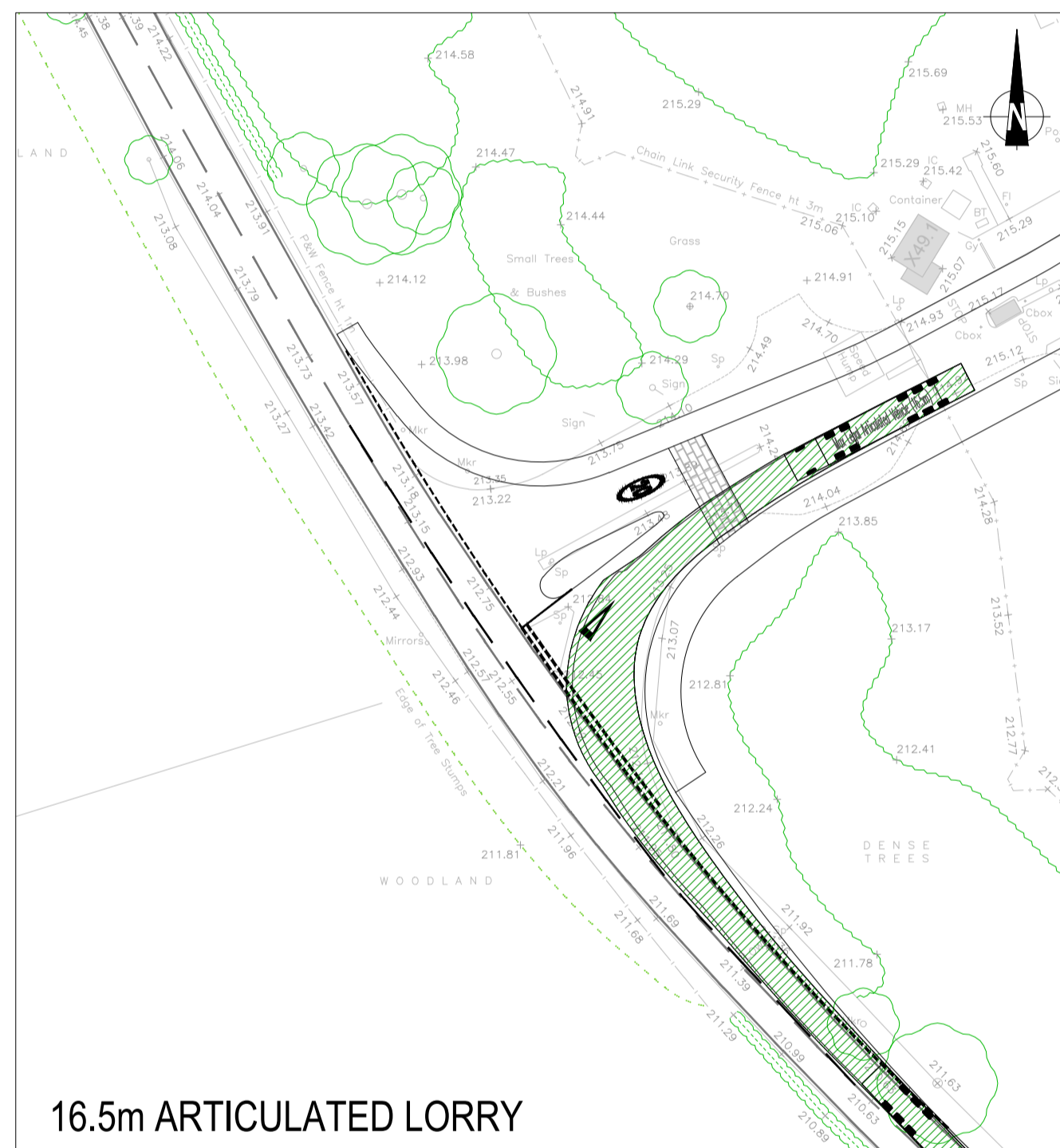

16.5m ARTICULATED LORRY

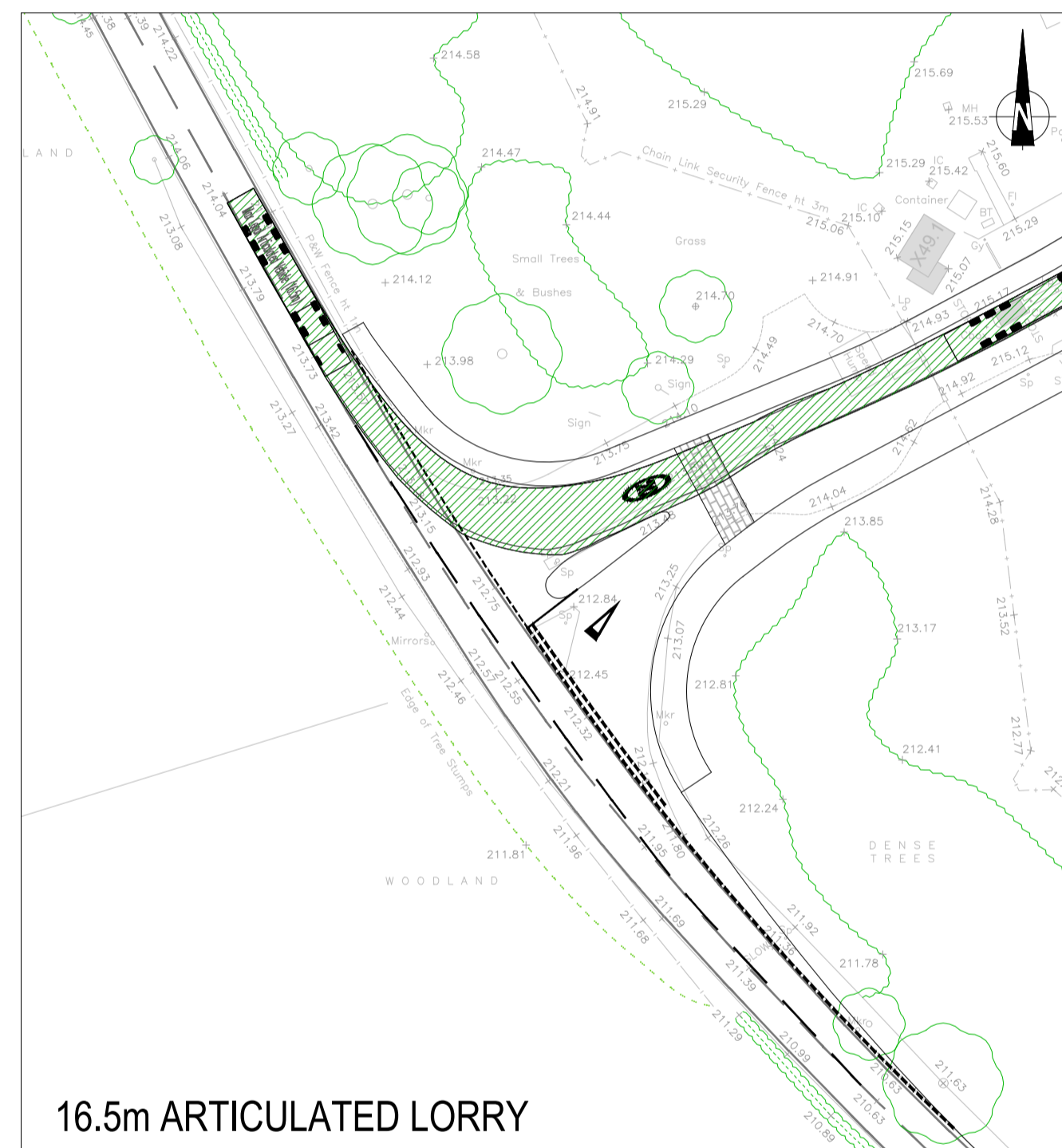

16.5m ARTICULATED LORRY

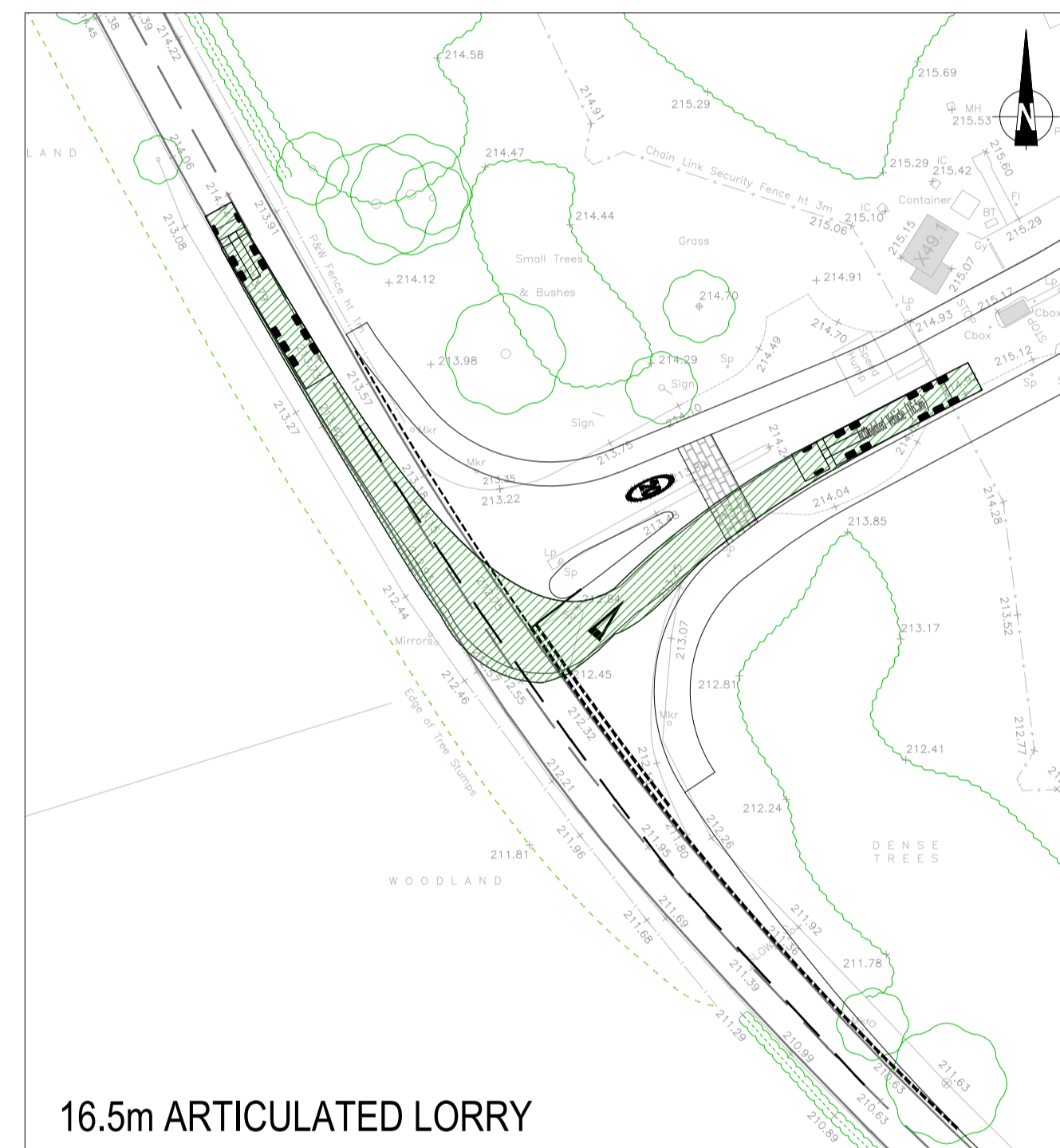

16.5m ARTICULATED LORRY

FTA Design Articulated Vehicle (1998)

Overall Length 16.450m
 Overall Width 2.550m
 Overall Body Height 3.870m
 Min Body Ground Clearance 0.515m
 Max Track Width 2.470m
 Lock to lock time 3.00s
 Kerb to Kerb Turning Radius 6.550m

Mark	Revision	Date	Drawn	Chkd	Appd

SCALING NOTE: Do not scale from this drawing. If in doubt, ask.
 UTILITIES NOTE: The position of any existing public or private sewers, utility services, plant or apparatus shown on this drawing is believed to be correct, but no warranty to this is expressed or implied. Other such plant or apparatus may also be present but not shown. The Contractor is therefore advised to undertake his own investigation where the presence of any existing sewers, services, plant or apparatus may affect his operations.

Drawing Issue Status
DRAFT FOR COMMENT

**FORT HALSTEAD, KENT
 STAR HILL ROAD JUNCTION
 VEHICLE SWEEP PATH ANALYSIS**

Client
**MERSEYSIDE
 PENSION FUND**

Date of 1st Issue 02.08.2019	Designed -	Drawn REM
A1 Scale 1:500	Checked AM	Approved AM

Drawing Number
41290/5501/045

pba
 peterbrett

Offices throughout
 the UK and Europe
www.peterbrett.com
 © Peter Brett Associates LLP
 LONDON
 Tel: 020 7566 8600